

© 2005 TFH ARCHITECTS

CHESTNUT STREET LOFTS
 URBAN REVITALIZATION PROJECT
 BY CHESTNUT STREET LLC.
 PORTLAND, MAINE

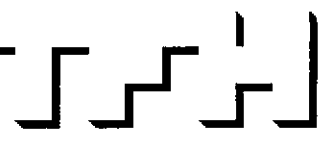

TFH ARCHITECTS
 100 COMMERCIAL STREET
 PORTLAND MAINE 04101
 TELEPHONE 207 775 6141
 ARCHITECTURE PLANNING

CONSULTANTS:

CIVIL:
 Lead Use Consultants
 96 Riverside Street
 Portland, ME 04101
 207-478-3313

STRUCTURAL:
 Structural Design Consulting
 22 Oakmont Drive
 264 Orchard Beach, ME 04054
 207-454-8038

MECHANICAL:
 Whitney Engineering
 10 Danforth Street
 Portland, ME 04101
 207-474-7449

ELECTRICAL:
 Bennett Engineering
 7 Bennett Road
 Presque, ME 04032
 207-463-5475

REVISIONS:

Re-issued by Addendum #1
 01-20-06

100% Construction Documents
 02-24-06

DATE: February 24, 2006

PROJECT No. 0422

DRAWN BY: RPW

CHECKED BY: RPW

SCALE: AS NOTED

SHEET TITLE:
**MECHANICAL
 ROOF PLAN**

M1.5

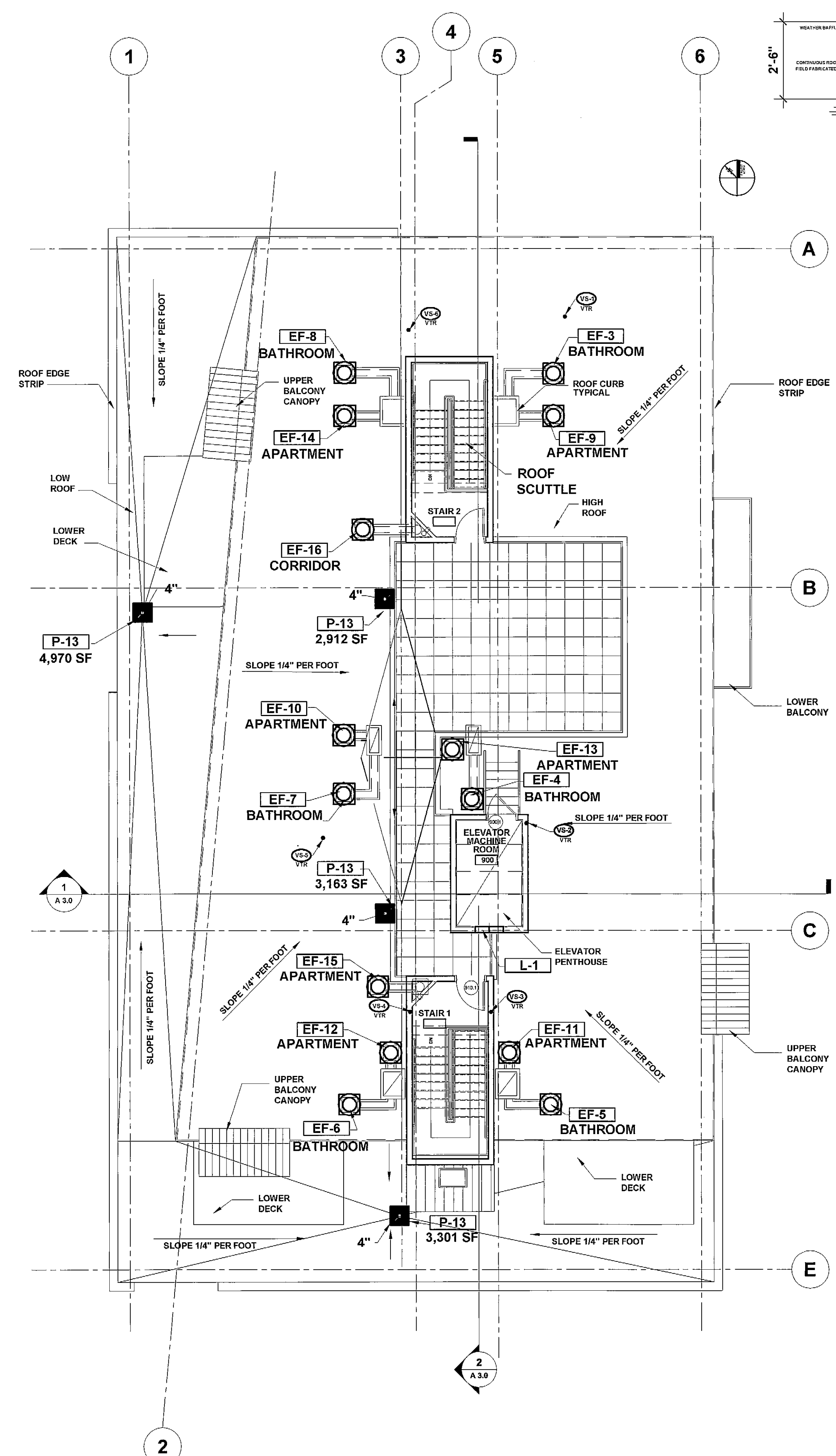

1
A1.5 ROOF MECHANICAL PLAN
 1/8" = 1'-0"

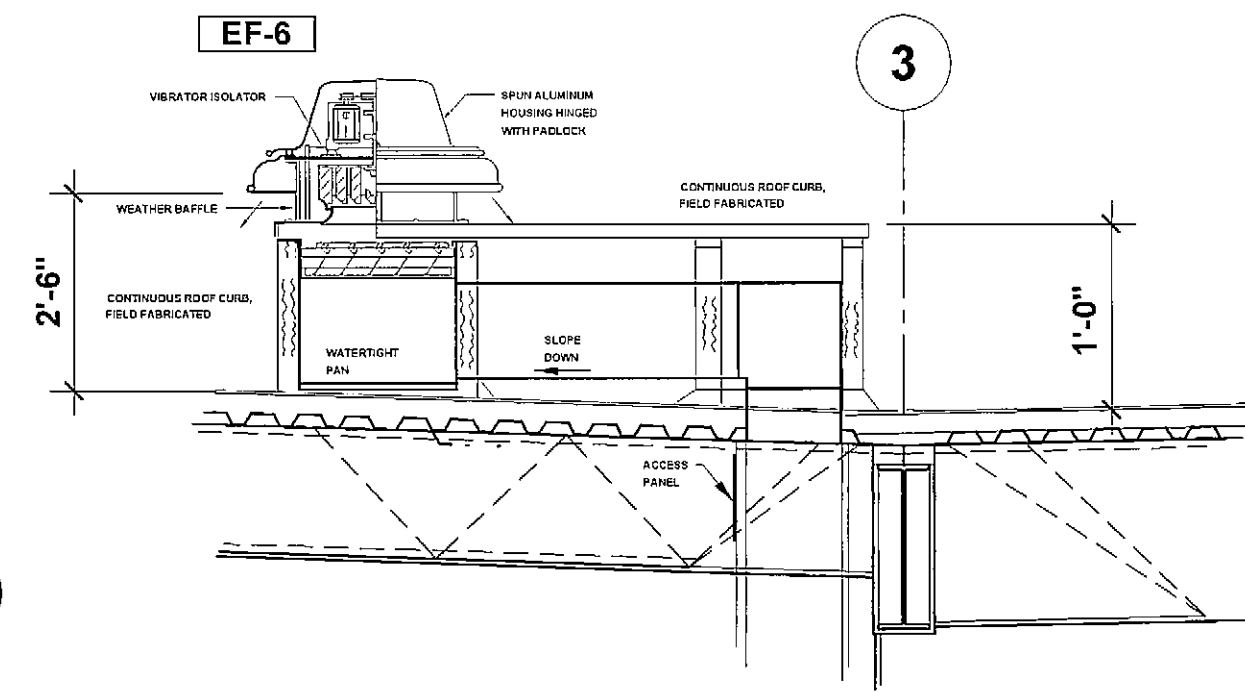

ROOF FAN DETAIL
 NOT TO SCALE

HEATING AND VENTILATING GENERAL NOTES:

- COORDINATE HVAC WORK WITH OTHER TRADES
- ALL DUCTWORK AND PIPING SHALL BE CONCEALED AND LOCATED ON WARM SIDE OF BUILDING INSULATION
- ALL DUCTWORK AND PIPING IS SHOWN DIAGRAMMATICALLY. EXACT LOCATIONS ARE TO BE DETERMINED IN THE FIELD IN COORDINATION WITH OTHER TRADES.
- ALL DUCT SIZES SHOWN ARE OUTSIDE DIMENSIONS.
- REFER TO REFLECTED CEILING PLAN FOR EXACT LOCATION OF ALL AIR TERMINAL DEVICES.
- DUCT RUN BELOW JOISTS MUST BE LOCATED TO AVOID INTERFERENCE WITH LIGHT FIXTURES.
- ALL RECTANGULAR ELBOWS TO HAVE TURNING VANES. FRICTION LOSS THROUGH ELBOW TO EQUAL THAT OF SMOOTH RADIUS ELBOW.
- ALL HORIZONTAL PIPING AND DUCT RUNS MUST RUN IN FLOOR JOISTS OF BUILDING.

TAG	EF-1	EF-2	EF-3 THRU EF-8	EF-9 THRU EF-14	EF-15 & EF-16
LOCATION	KITCHEN	BATHROOM	PLUMBING	HV AIR	CORRIDOR
SERVICE	AREA EXHAUST	EXHAUST	AIR SHAFT	SHAFT	VENTILATION
MAKE	CEILING	CEILING	CRV	CRV	CRV
COOK MODEL	GC-240	GC-220	18CRV	18CRV	18CRV
C.F.M.	100	73	350	700	770
BLOWER DATA	S.P.	0.25	0.25	0.500	0.500
TYPE	FC	FC	FC	FC	FC
DRIVE	DIRECT	DIRECT	BELT	BELT	BELT
H.P. OR WATTS	58 W	32 W	1/6 HP	1/6 HP	1/4 HP
R.P.M. (FAN)	1,200	1,050	641	708	719
VOLTS	115	115	115	115	115
PHASE	60	60	60	60	60
HZ	1	1	1	1	1
MAX. SONES	1.5	1.3	4.5	6.3	6.6

UNIT TAG	HVAC-1	HVAC-2	HVAC-3
LOCATION	BASEMENT	BASEMENT	BASEMENT
SERVICE	COMMERCIAL 101 NORTH	COMMERCIAL 101 SOUTH	OWNER'S SPACES
MAKE	MAGICAIRE	MAGICAIRE	MAGICAIRE
MODEL	48-BVX	60-BVX	48-BVX
C.F.M.	1,500	2,000	1,500
EXT. S.P. IN W.C.	0.75	0.75	0.75
ENT. AIR DB °F	80	80	80
TEMP. WB °F	67	67	67
EVAP. TEMP °F	45	45	45
COOL CAP SENSIBLE	40,000	51,500	40,000
BTUH TOTAL	55,000	72,000	55,000
HEATING GPM	4.0	6.0	4.0
HEATING OUTPUT MBH	64.0	82.0	64.0
FUEL/Firing Rate GPH	N/A	N/A	N/A
MOTOR HP	1	1-1/2	1
POWER	208/60/3	208/60/3	208/60/3
CONTROL AMPS	N/A	N/A	N/A
FAN MOTOR AMPS	4.6	6.6	4.6
FUSE MAX	N/A	N/A	N/A
MIN. O.A. CFM	200	200	200
DRIVE	BELT	BELT	BELT
WT. LBS.	275	230	275
MIN. SEER	N/A	N/A	N/A
MIN. AFUE %	N/A	N/A	N/A

NOTES:
 1. APPROVED EQUAL FROM CARRIER, TRANE, BRYANT, MCQUAY

UNIT TAG	HVAC-1	HVAC-2	HVAC-3
LOCATION	EXTERIOR	EXTERIOR	EXTERIOR
SERVICE	HVAC-1	HVAC-2	HVAC-3
MAKE	BRYANT	BRYANT	BRYANT
MODEL	552A-048	552A-060	552A-048
TYPE	AIR COOLED	AIR COOLED	AIR COOLED
COOL CAP SENSIBLE	NOTE 2	NOTE 2	NOTE 2
BTUH TOTAL	NOTE 2	NOTE 2	NOTE 2
AMBIENT AIR F	95	95	95
EER/SEER MINIMUM	10.65/12.0	10.65/12.0	10.65/12.0
VOLTAGE	208/230	208/230	208/230
HERTZ	60	60	60
PHASE	3	3	3
MCA	28.7	48.7	28.7
FUSE MAX AMPS	40	60	40
LOW AMBIENT	0F	0F	0F
WT LBS.	215	250	215

REMARKS:
 1. APPROVED EQUAL FROM CARRIER, TRANE OR MCQUAY
 2. MATCH CAPACITY OF INDOOR HVAC UNIT

TAG	EF-1	EF-2	EF-3 THRU EF-8	EF-9 THRU EF-14	EF-15 & EF-16
LOCATION	KITCHEN	BATHROOM	PLUMBING	HV AIR	CORRIDOR
SERVICE	AREA EXHAUST	EXHAUST	AIR SHAFT	SHAFT	VENTILATION
TYPE	CEILING	CEILING	CRV	CRV	CRV
MANUFACTURER	BROAN	BROAN	COOK	COOK	COOK
BROAN MODEL	#676	#676	18CRV	18CRV	18CRV
C.F.M.	100	73	350	700	770
S.P.	0.25	0.25	0.500	0.500	0.500
TYPE	FC	FC	FC	FC	FC
DRIVE	DIRECT	DIRECT	BELT	BELT	BELT
H.P. OR WATTS	140W	140W	1/6 HP	1/6 HP	1/4 HP
R.P.M. (FAN)	1,200	1,050	641	708	719
VOLTS	115	115	115	115	115
PHASE	60	60	60	60	60
HZ	1	1	1	1	1
MAX. SONES	4.0	4.0	4.5	6.3	6.6
SPEED CONTROL	YES	YES	NO	NO	NO

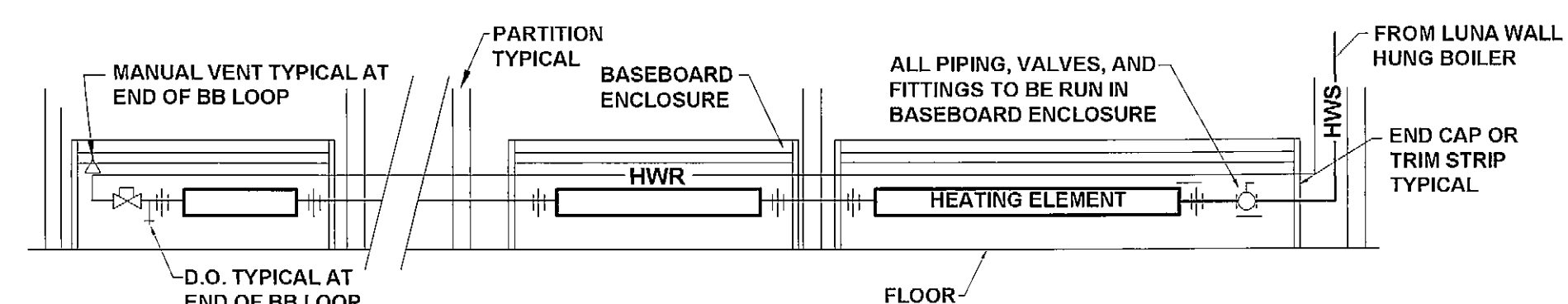

BASEBOARD PIPING DETAIL
 NTS

- NOTES:
- BASEBOARD: PETITE 7 WITH A CAPACITY OF 570 BTUHALF @ 180F AVERAGE WATER TEMPERATURE, 1 GPM
 - EACH APARTMENT SHALL BE SINGLE ZONE WITH BASEBOARD ARRANGED IN A SERIES LOOP
 - FIELD MEASURE BASEBOARD FOR END CAPS, TRIM STRIPS AND PILASTER ASSEMBLIES

**100% CONSTRUCTION
 DOCUMENTS 02-24-06**