

© 2005 TFH ARCHITECTS

CHESTNUT STREET LOFTS

URBAN REVITALIZATION PROJECT
BY CHESTNUT STREET LLC,
PORTLAND, MAINE

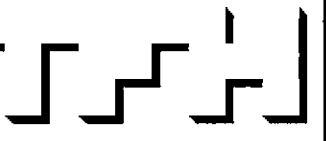

TFH ARCHITECTS
100 COMMERCIAL STREET
PORTLAND MAINE 04101
TELEPHONE 207 775 6141
ARCHITECTURE PLANNING

CONSULTANTS:

- CIVIL:** Land Use Consultants
655 Riverside Street
Portland, ME 04103
207-878-3310
- STRUCTURAL:** Structural Design Consulting
22 Colburn Drive
Old Orchard Beach, ME 04054
207-994-9090
- Mechanical:** Whitney Engineering
10 Danforth Street
Portland, ME 04101
207-874-7449
- ELECTRICAL:** Bennett Engineering
7 Bennett Road
Fresno, ME 04032
207-855-9475

REVISIONS:

- 2 80% CONSTRUCTION DOCUMENTS
02.24.05

DATE:

PROJECT No. 0422

DRAWN BY: RJS

CHECKED BY: TST

SCALE: AS NOTED

SHEET TITLE:
THIRD AND
FOURTH FLOOR
REFLECTED
CEILING PLANS

A1.8

REFLECTED CEILING PLAN NOTES AND LEGEND

GENERAL RCP NOTES:

- 1) BS = BOTTOM OF SOFFIT
- 2) BD = BOTTOM OF SUSPENDED GWS CEILING
- 3) LIGHT FIXTURES SHOWN
- 4) STRUCTURAL BEAM DEPTHS VARY BY LOCATION SOFFITS TO BE BUILT TO ELEVATIONS AS INDICATED ON REFLECTED CEILING PLANS

GWS SOFFIT

- NOTE:**
SUSPENDED GYP CEILINGS TO BE:
3/4" GYP BOARD
SUSPENDED METAL GRID
5" BATT INSULATION
WIRE/NEOPRENE VIBRATION ISOLATOR HANGER

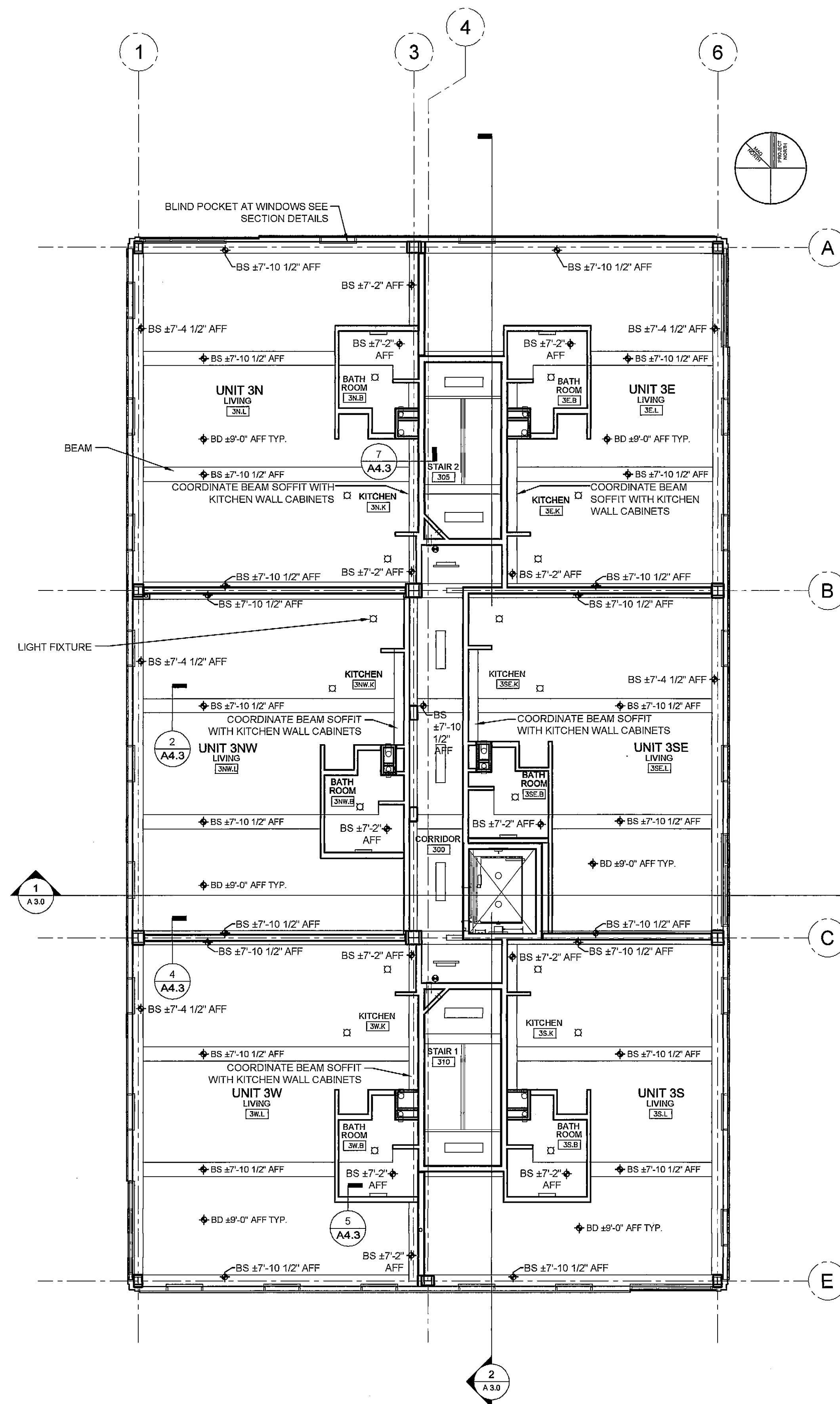

1 THIRD FLOOR REFLECTED CEILING PLAN
A1.8 1/8" = 1'-0"

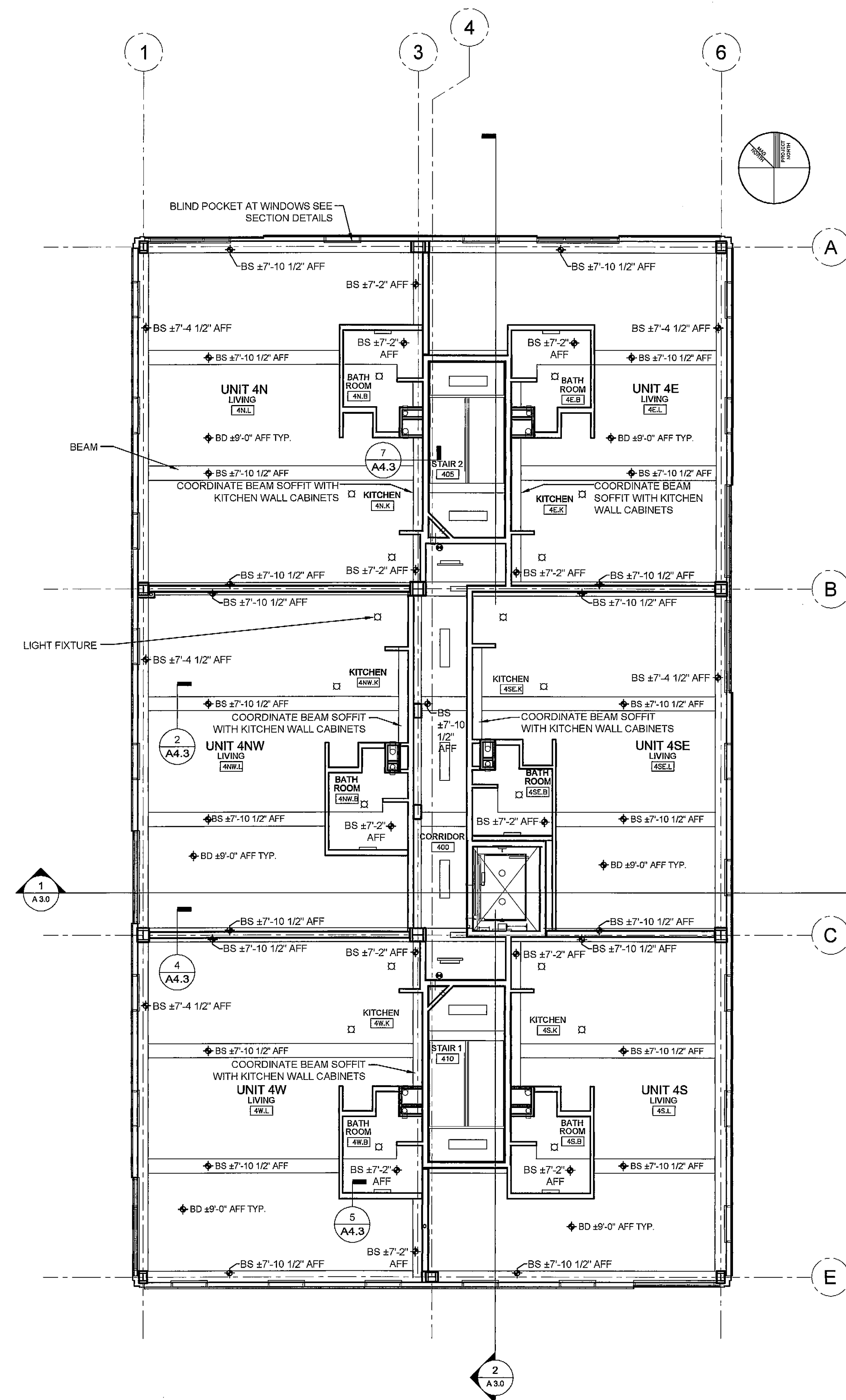

2 FOURTH FLOOR REFLECTED CEILING PLAN
A1.8 1/8" = 1'-0"

T:\00_TFH Projects\0422_Chestnut Street\Construction Documents\01-Floor Plans\0422 - 03-04 Third and Fourth Floor Plans.dwg, 2/23/2005 2:08:34 PM, HP DesignJet 750C Plus (E_A4).p3