

UNIT 001

Cumberland

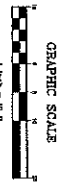
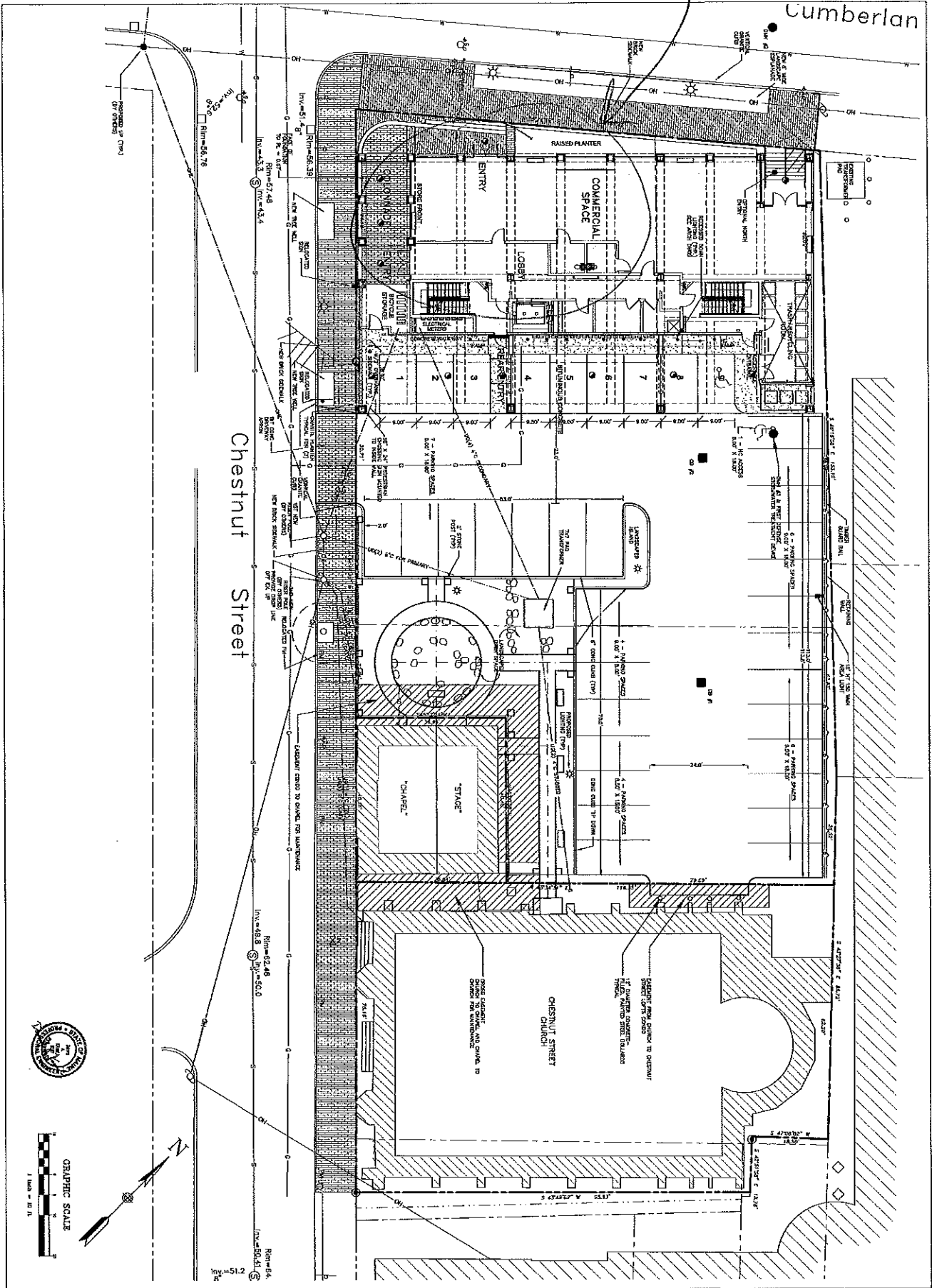

LAYOUT PLAN

C-2

DESIGNED	FLC/INE
DRAWN	CAM
CHECKED	DAK
SCALE	1" = 10'
DATE	6-1-05

Revision	Date
1. REVISED FOR PERMITS	05/25/05
2. REVISED BUILDING FOOTPRINT	06/06/05
3. REVISED FOR CONSTRUCTION	06/06/05

CHESTNUT STREET LOFTS
 23 CHESTNUT ST, PORTLAND, ME 04101
 PREPARED FOR
 CHESTNUT STREET LOFTS, LLC
 ONE INDIA STREET
 PORTLAND, ME 04101

TFI LUC
 17TH ARCHITECTS
 100 COMMERCIAL STREET
 PORTLAND, MAINE 04101
 TELEPHONE 207 773 5141
 ARCHITECTURE PLANNING

ALL RIGHTS RESERVED
 PORTLAND, MAINE 04101
 TEL: 207 773 5141
 FAX: 207 773 5142
 WWW.TFIARCHITECTS.COM

SITE PLAN