

**City of Portland, Maine - Building or Use Permit Application**

389 Congress Street, 04101 Tel: (207) 874-8703, Fax: (207) 874-8716

Permit No: 02-0864	Issue Date: <b>SEP 24 2002</b>	CBL 027 B005001
-----------------------	-----------------------------------	--------------------

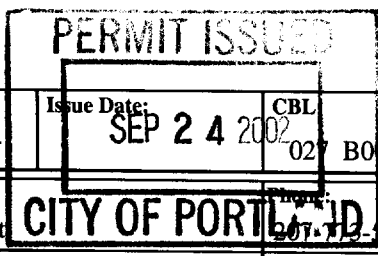

Location of Construction: 423 Congress St	Owner Name: First Parish In Portland	Owner Address: 427 Congress St	Phone: 207-742-747
Business Name:	Contractor Name: Woodward Thompson/Tom Thoms	Contractor Address: 50 Danforth Street Portland	Phone: 2077749298
Lessee/Buyer's Name	Phone:	Permit Type: Additions - Commercial	Zone: <b>B-3</b>

Past Use: Church	Proposed Use: Church w/temporary access stairs	Permit Fee: \$51.00	Cost of Work: \$3,500.00	CEO District: 1
---------------------	---	------------------------	-----------------------------	--------------------

FIRE DEPT: <input checked="" type="checkbox"/> Approved <input type="checkbox"/> Denied	INSPECTION: Use Group: <b>A</b> Type: <b>N/A</b>
---	--

Proposed Project Description:  
Build temporary access stairs to Parish House - *Going over the top of the existing steps (sidewalk too steep)*

Signature: *[Signature]* Signature: *[Signature]*  
 PEDESTRIAN ACTIVITIES DISTRICT (P.A.D.)  
 Action:  Approved  Approved w/Conditions  Denied  
 Signature: \_\_\_\_\_ Date: \_\_\_\_\_

Permit Taken By: jmy	Date Applied For: 08/01/2002	<b>Zoning Approval</b>
-------------------------	---------------------------------	------------------------

1. This permit application does not preclude the Applicant(s) from meeting applicable State and Federal Rules. 2. Building permits do not include plumbing, septic or electrical work. 3. Building permits are void if work is not started within six (6) months of the date of issuance. False information may invalidate a building permit and stop all work..	<b>Special Zone or Reviews</b> <input type="checkbox"/> Shoreland <input type="checkbox"/> Wetland <input type="checkbox"/> Flood Zone <input type="checkbox"/> Subdivision <input type="checkbox"/> Site Plan Maj <input type="checkbox"/> Minor <input type="checkbox"/> MM <input type="checkbox"/> Date: _____	<b>Zoning Appeal</b> <input type="checkbox"/> Variance <input type="checkbox"/> Miscellaneous <input type="checkbox"/> Conditional Use <input type="checkbox"/> Interpretation <input type="checkbox"/> Approved <input type="checkbox"/> Denied Date: _____	<b>Historic Preservation</b> <input type="checkbox"/> Not in District or Landmark <input type="checkbox"/> Does Not Require Review <input type="checkbox"/> Requires Review <input checked="" type="checkbox"/> Approved <input type="checkbox"/> Approved w/Conditions <input type="checkbox"/> Denied Date: <b>8/2/02</b>
--	---	---	--

*on temporary basis -*  
*to D.A*  
*not to exceed 2 years*

**CERTIFICATION**

I hereby certify that I am the owner of record of the named property, or that the proposed work is authorized by the owner of record and that I have been authorized by the owner to make this application as his authorized agent and I agree to conform to all applicable laws of this jurisdiction. In addition, if a permit for work described in the application is issued, I certify that the code official's authorized representative shall have the authority to enter all areas covered by such permit at any reasonable hour to enforce the provision of the code(s) applicable to such permit.

SIGNATURE OF APPLICANT	ADDRESS	DATE	PHONE
RESPONSIBLE PERSON IN CHARGE OF WORK, TITLE		DATE	PHONE

City of Portland  
02-0864

# All Purpose Building Permit Application

If you or the property owner owes real estate or personal property taxes or user charges on any property within the City, payment arrangements must be made before permits of any kind are accepted.

Location/Address of Construction: First Parish Church, 425 Congress Street, Portland		
Total Square Footage of Proposed Structure 89 SF plus or minus	Square Footage of Lot unknown	
Tax Assessor's Chart, Block & Lot Chart# 027 Block# B Lot# 005	Owner: First Parish Unitarian Church	Telephone: 773 5747
Lessee/Buyer's Name (if Applicable) N.A.	Applicant name, address & telephone: Woodward Thomsen Co., Inc. Portland, Maine 774 9298	Cost Of Work: \$ 3,500.00 Fee: \$
Current use: Church		
If the location is currently vacant, what was prior use: N.A.		
Approximately how long has it been vacant: N.A.		
Proposed use: Church. No change in use.		
Project description: Build temporary access stairs to Parish House. Plans attach'd.		
Contractor's name, address & telephone: Woodward Thomsen Co., Inc. Portland, ME		
Who should we contact when the permit is ready: Tom Thomsen @ Woodward Thomsen Co.		
Mailing address: Woodward Thomsen Co., Inc. P. O. Box 10359 Portland, ME 04104		
We will contact you by phone when the permit is ready. You must come in and pick up the permit and review the requirements before starting any work, with a Plan Reviewer. A stop work order will be issued and a \$100.00 fee if any work starts before the permit is picked up. PHONE: 774 9298		

**IF THE REQUIRED INFORMATION IS NOT INCLUDED IN THE SUBMISSIONS THE PERMIT WILL BE AUTOMATICALLY DENIED AT THE DISCRETION OF THE BUILDING/PLANNING DEPARTMENT, WE MAY REQUIRE ADDITIONAL INFORMATION IN ORDER TO APPROVE THIS PERMIT.**

I hereby certify that I am the Owner of record of the named property, or that the owner of record authorizes the proposed work and that I have been authorized by the owner to make this application as his/her authorized agent. I agree to conform to all applicable laws of this jurisdiction. In addition, if a permit for work described in this application is issued, I certify that the Code Official's authorized representative shall have the authority to enter all areas covered by this permit at any reasonable hour to enforce the provisions of the codes applicable to this permit.

CONTRACTOR J.W. Thomsen

Signature of applicant: J.R. Wilson *Wilson* Date: July 31 2002

FIRST PARISH CHURCH

This is NOT a permit, you may not commence ANY work until the permit is issued.  
If you are in a Historic District you may be subject to additional permitting  
Planning Department on the 4th floor of City Hall

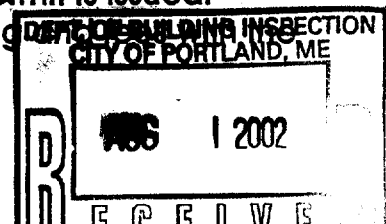

DISPLAY THIS CARD ON PRINCIPAL FRONTAGE OF WORK PERMIT ISSUED

CITY OF PORTLAND

BUILDING DEPARTMENT

PERMIT

SEP 24 2002  
Permit Number: 020864  
CITY OF PORTLAND

Please Read Application And Notes, If Any, Attached

This is to certify that First Parish In Portland/Woodward Thompson Thompson  
has permission to Build temporary access stairs Parish House  
AT 423 Congress St Portland, OR 97201 027 B005001

provided that the person or persons, firm or corporation accepting this permit shall comply with all of the provisions of the Statutes of Maine and of the ordinances of the City of Portland regulating the construction, maintenance and use of buildings and structures, and of the application on file in this department.

Notification of inspection must be given and when permission is procured before this building or part thereof is altered or closed-in. 24 HOUR NOTICE IS REQUIRED.

Apply to Public Works for street line and grade if nature of work requires such information.

A certificate of occupancy must be procured by owner before this building or part thereof is occupied.

OTHER REQUIRED APPROVALS

Fire Dept. [Signature]  
Health Dept. \_\_\_\_\_  
Appeal Board \_\_\_\_\_  
Other \_\_\_\_\_  
Department Name \_\_\_\_\_

[Signature] 8/9/02  
Director - Building & Inspection Services

PENALTY FOR REMOVING THIS CARD

Application ID Number: 2-0864

Delete Save Close

Department: Fire

Status: Approved with Conditions

Reviewer: Lt. McDougall

Comments:

Approval Date: 08/06/2002

Given On Date:

OK to Issue Permit Name: Lt. McDougall Date: 08/06/2002 Date 2:

Conditions Section:

Add New Condition From

Add New Condition

Delete Condition

Guards shall be installed so that a 4" sphere can past thru them.



Create Date: 08/01/2002 By: jimy Update Date: 08/06/2002 By: gg

Application ID Number: 2-0864

Delete Save Close

Department: Building Status: Approved with Conditions Reviewer: Mike Nugent

Comments:

Approval Date: 09/17/2002

Given On Date: 08/08/2002

OK to Issue Permit Name: Mike Nugent Date: 09/17/2002 Date 2:

Conditions Section: Add New Condition From Add New Condition Delete Condition

Ok per Section 3406.1 (Historic Exemption), to be constructed over existing stairs, mirroring the current treads risers and guards. MJN



Create Date: 08/01/2002 By: jmy Update Date: 09/24/2002 By: mjn

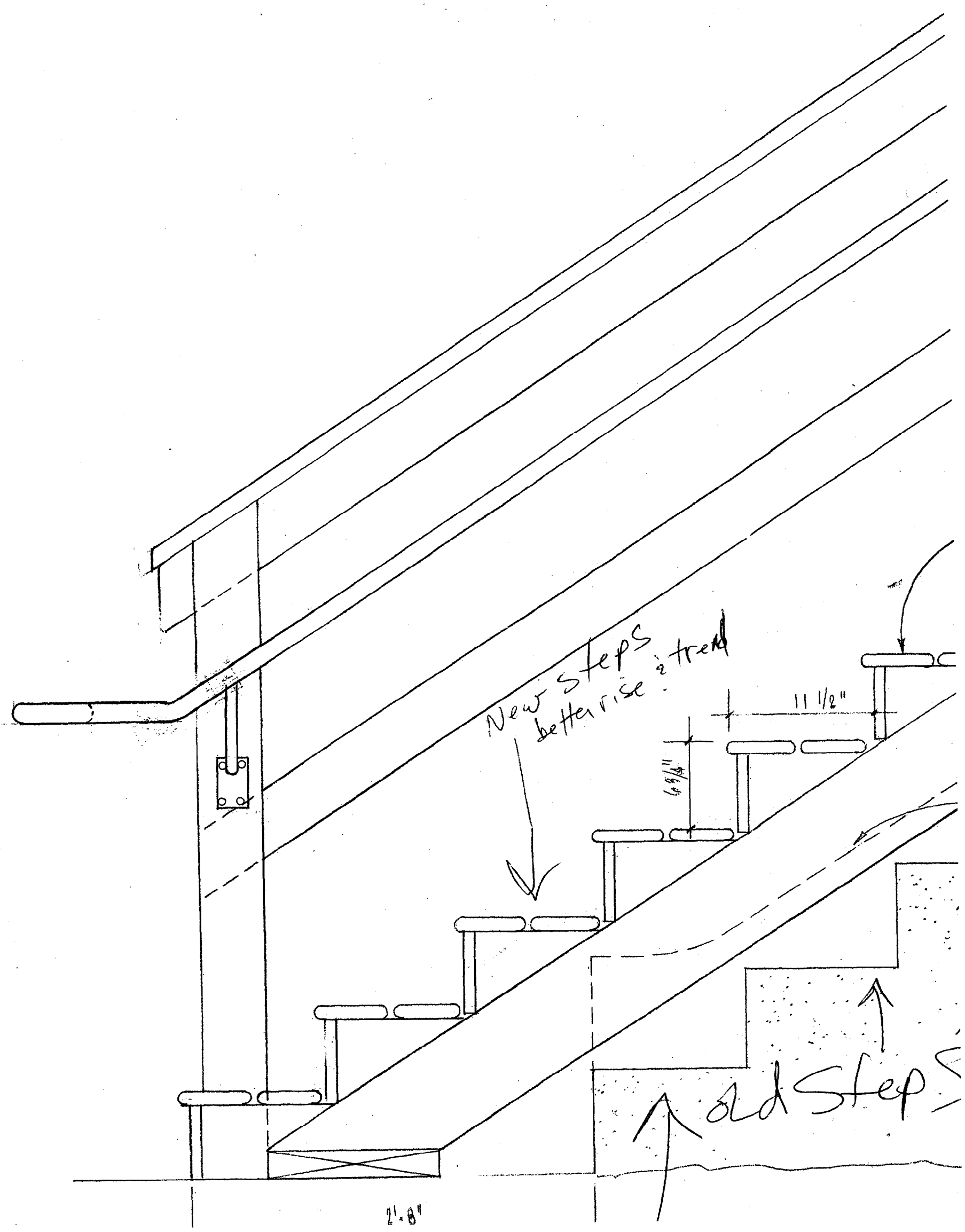
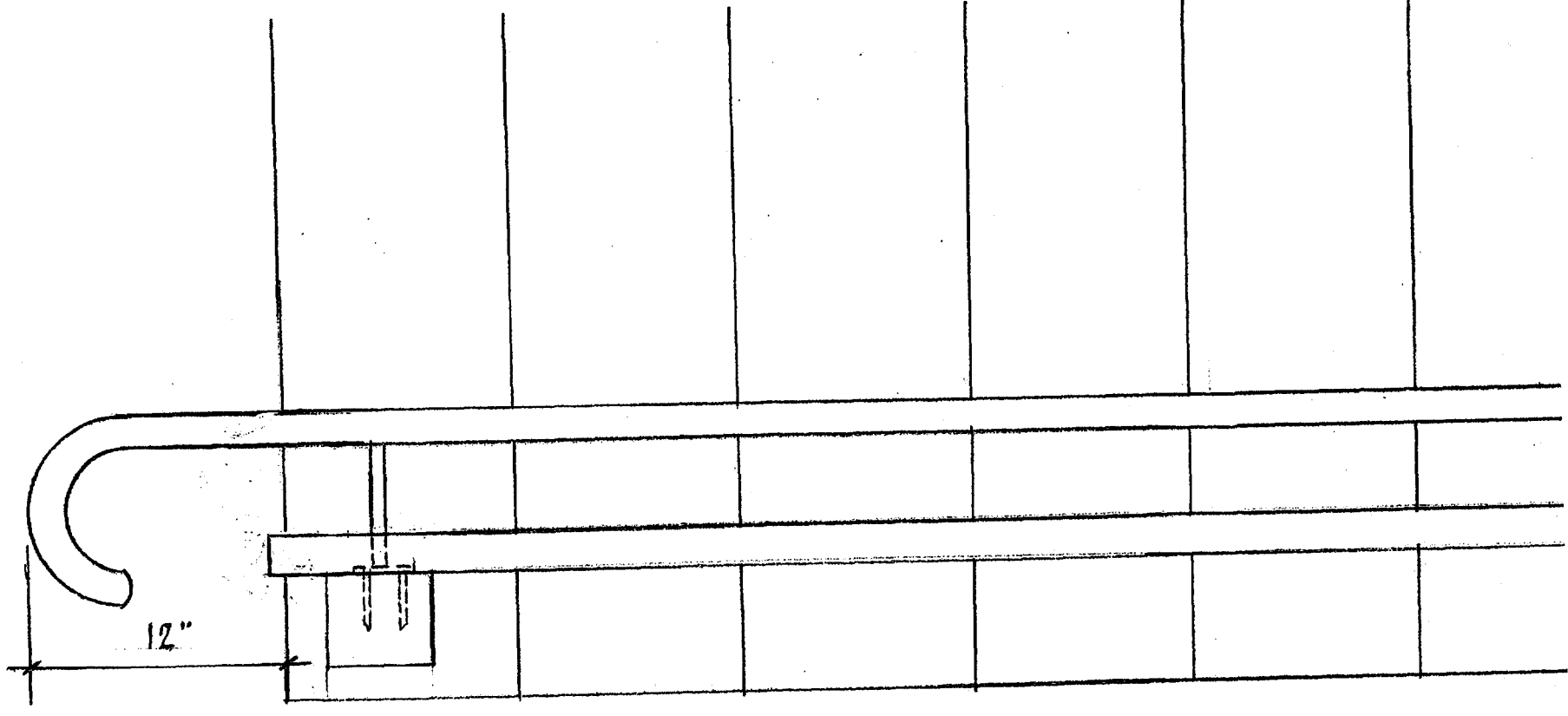

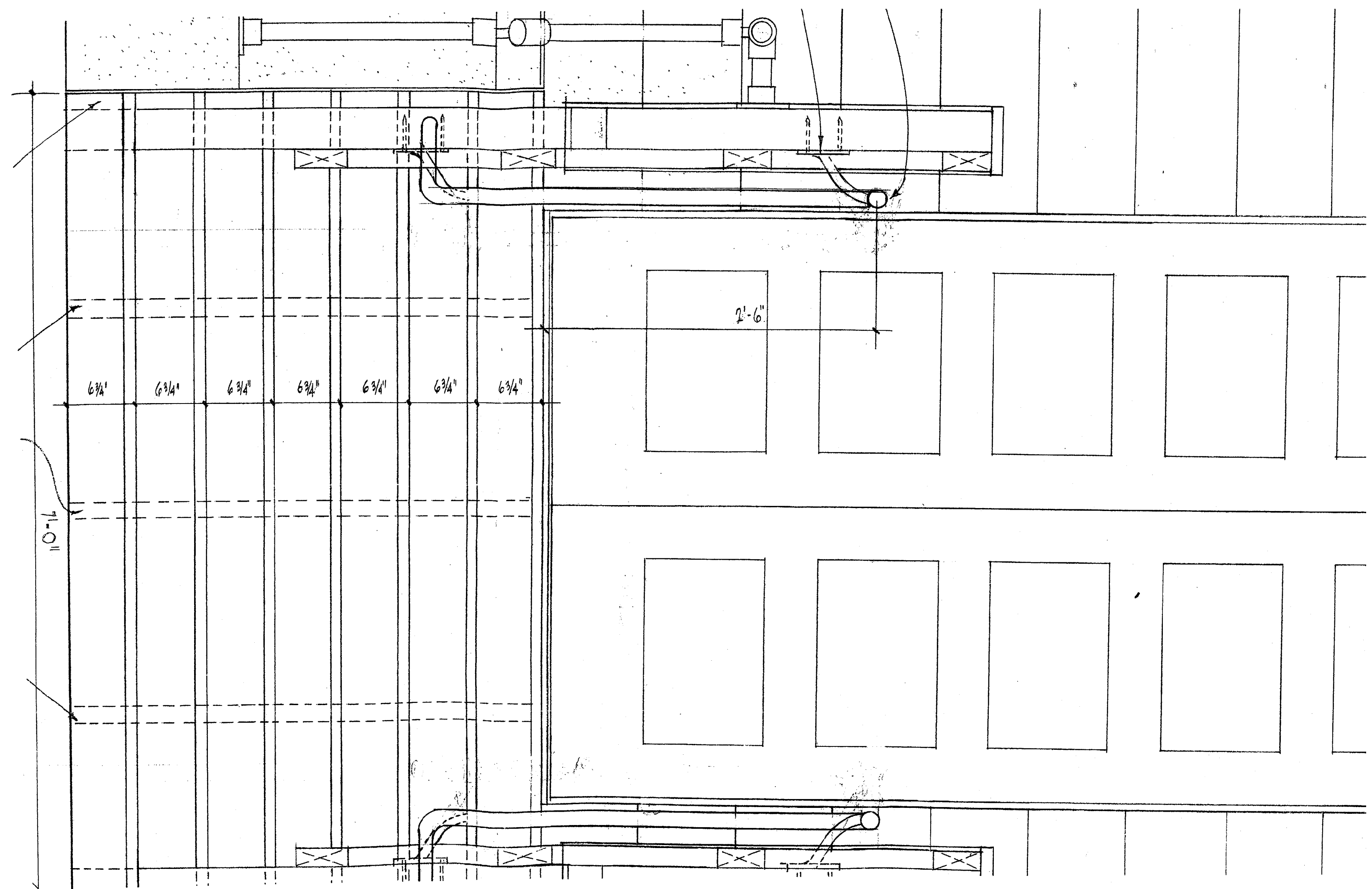

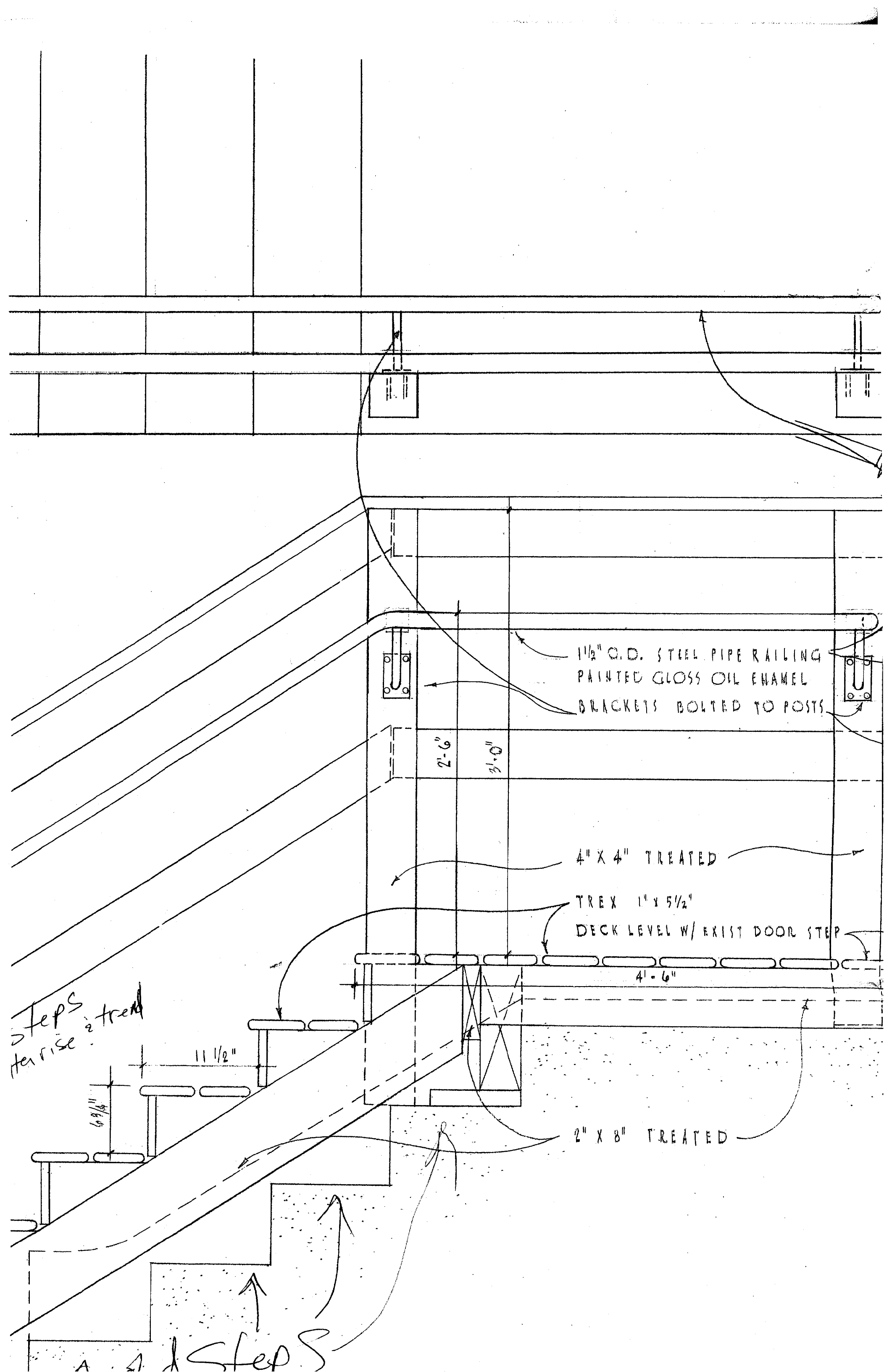

1 1/2" O.D. STEEL PIPE RAILING  
PAINTED GLOSS OIL ENAMEL  
BRACKETS BOLTED TO POSTS

2'-6"  
3'-0"

4" X 4" TREATED

TREX 1" X 5 1/2"  
DECK LEVEL W/ EXIST DOOR STEP

4'-6"

2" X 8" TREATED

Steps  
1/2" rise 2" tread

11 1/2"

6 9/16"

A A Steps