

(2) LAYERS OF 5/8" GWB ON CEILING DECK ABOVE
 LIGHT ABOVE DOOR TO BE REMOVED AND A NEW LIGHT TO BE CENTERED ON BRICK WALL SEE ELECTRICAL DRAWINGS

CLOSE OFF PERMEABLE WALL SURFACES TO DECK ABOVE

1 | CEILING PLAN
 SCALE: 1/4"=1'-0"

NOTES:
 FOR FIXTURE INFORMATION REFER TO ELECTRICAL DRAWINGS
 PATCH ALL HOLES IN EXISTING PLASTER CEILING AT BOTTOM OF FLOOR DECK ABOVE

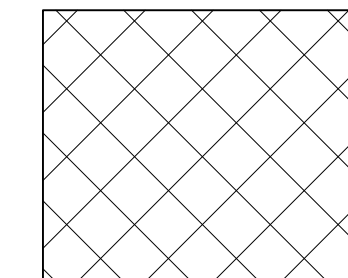

INDICATES SAFB INSULATION ABOVE CEILING- REFER TO DETAIL A

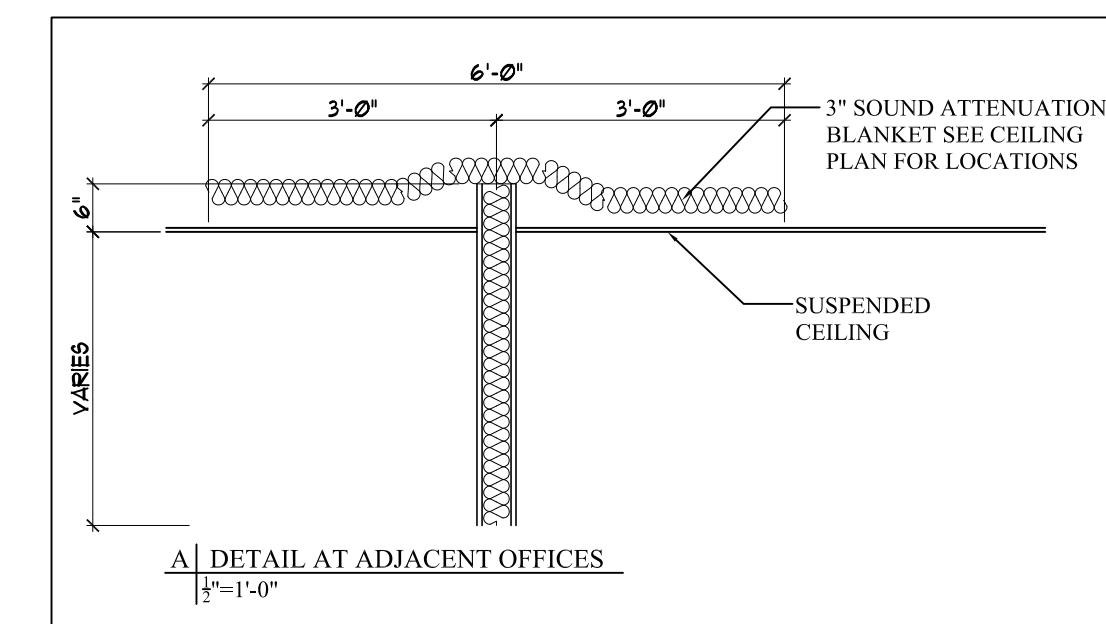

Prepared For:	
Consulting Engineer:	
Architect:	ARCHETYPE architects 48 Union Wharf Portland, Maine 04101 (207) 772-6022 Fax (207) 772-4056
Project:	CHAMBER OF COMMERCE 443 CONGRESS STREET PORTLAND, MAINE
Revisions:	
Date:	10 June 2011
Scale:	1/4" = 1'-0"
CEILING PLAN	
A1.02	