

6/16/2015 9:43 PM I:\401-1100\401100-PORTLAND HIGH SCHOOL FIRE ALARM SYSTEM\2 DESIGN\WORKSHEETS\BIDDING\PORTLAND SCHOOL EXISTING DRAWINGS\SHEETS\FD101B GROUND FLOOR - SEG. B FIRE ALARM REMOVALS PLAN.DWG FILE:MAHAR

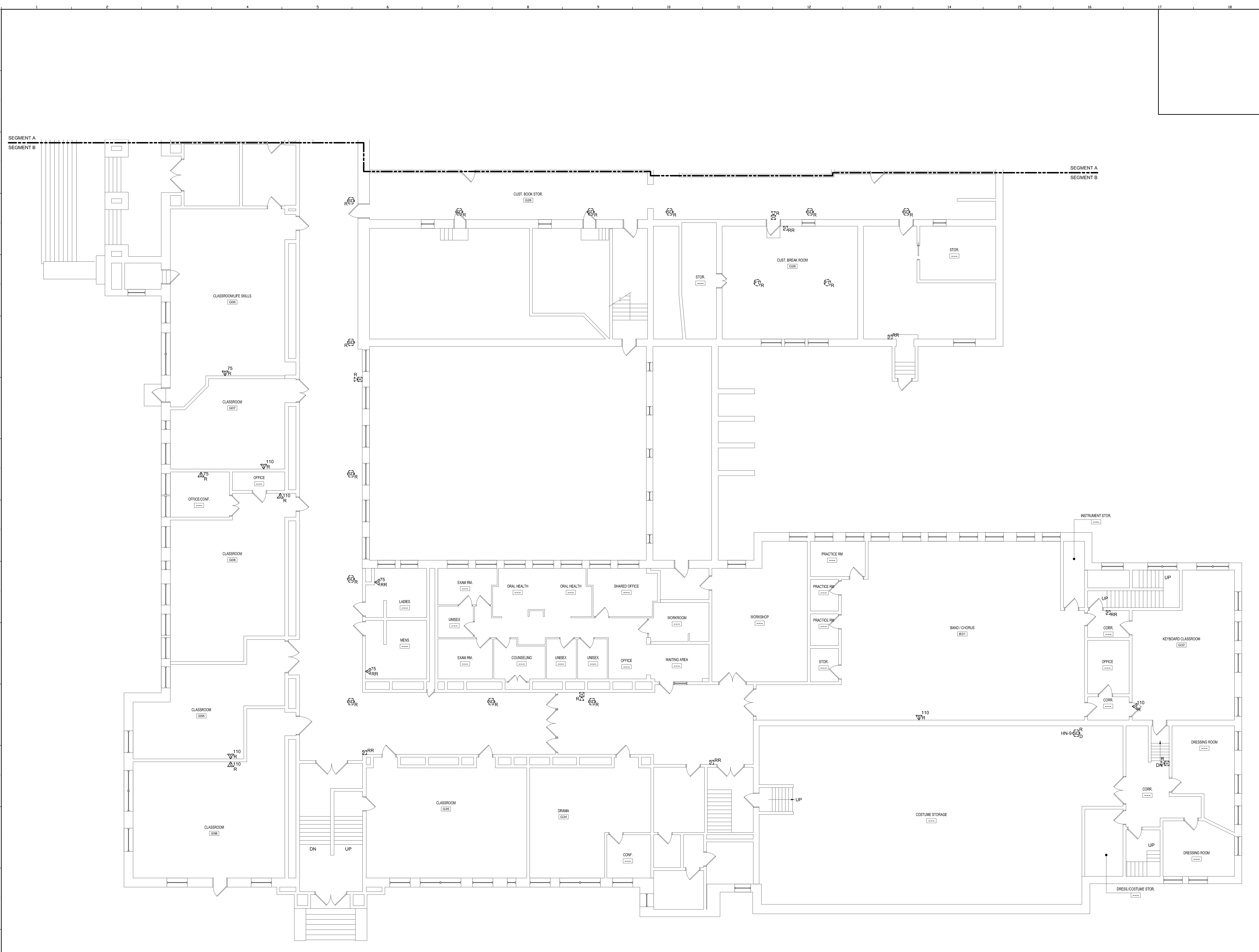

TECHNICAL NOTES:
 ① DUCT SMOKE DETECTORS ARE SHOWN DIAGRAMMATICALLY WITHIN THIS ROOM. CONTRACTOR SHALL FIELD LOCATE EACH DETECTOR AND REMOVE AS NOTED.

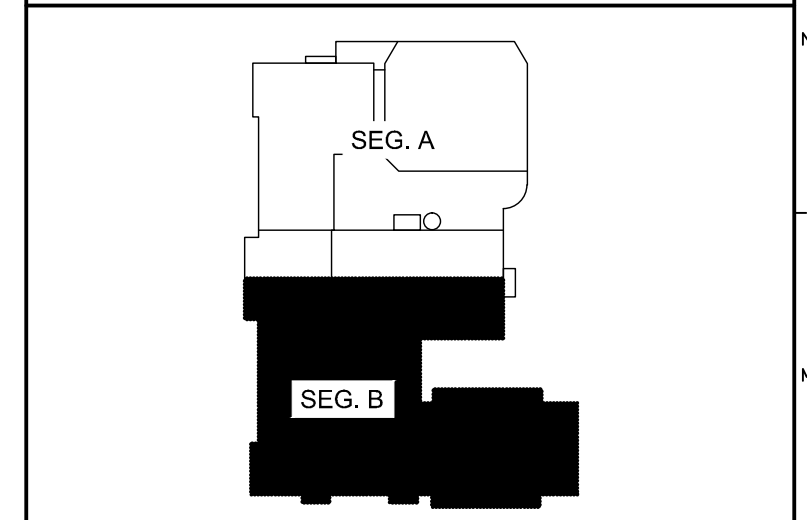

KEY PLAN

- LEGEND:**
- E EXISTING TO REMAIN
 - FIR EXISTING RELOCATED
 - NR NEW TO REPLACE EXISTING IN EXISTING LOCATION
 - RR EXISTING TO BE REMOVED
 - RR REMOVE & RELOCATE EXISTING
 - 🔊 FIRE ALARM HORN / LIGHT
 - 🔊 MULTI-CANDELA STROBE
 - 🔊 MULTI-CANDELA SPEAKER/STROBE
 - 🔊 CEILING MOUNTED MULTI-CANDELA SPEAKER/STROBE
 - 🔊 FIRE ALARM SYSTEM CEILING MOUNTED HEAT DETECTOR - 'EL' FOR ELEVATOR SHUNT TRIP
 - 🔊 FIRE ALARM SYSTEM CEILING MOUNTED SMOKE DETECTOR - 'EL' FOR ELEVATOR RECALL
 - 🔊 WALL MOUNTED FIRE ALARM SYSTEM MANUAL PULL STATION
 - 🔊 KNOX BOX
 - 🔊 JUNCTION BOX
 - 🔊 DOOR HOLD-OPEN DEVICE CONNECTION
 - 🔊 FIRE ALARM SYSTEM/SPRINKLER SYSTEM PRESSURE SWITCH
 - 🔊 FIRE ALARM SYSTEM/SPRINKLER SYSTEM FLOW SWITCH
 - 🔊 FIRE ALARM SYSTEM/SPRINKLER SYSTEM TAMPER SWITCH
 - 🔊 FIRE ALARM SYSTEM DUCT MOUNTED SMOKE DETECTOR
 - 🔊 FIRE ALARM SYSTEM CONTROL PANEL
 - 🔊 FIRE ALARM ANNUNCIATOR
 - 🔊 GAS SHUT-OFF
 - 🔊 RADIO TRANSMITTER BOX
 - 🔊 MONITOR MODULE
 - 🔊 TEST STATION
 - 🔊 RELAY MODULE
 - 🔊 ANSUL GAS TANK
 - 🔊 FIRE ALARM AMPLIFIER

REV.	DESCRIPTION	DATE
0	ISSUED FOR BID	06.12.15

ISSUED FOR BID
 06.12.15

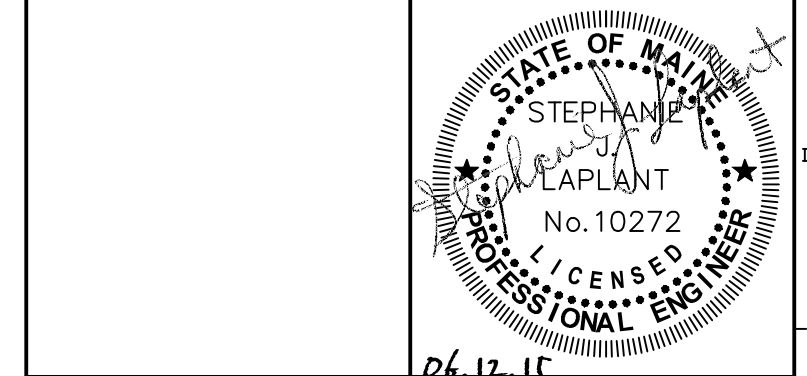

WBRC
 ARCHITECTS • ENGINEERS
 WWW.WBRC.COM
 BANGOR, MAINE 207-647-4511
 PORTLAND, MAINE 207-828-4511
 SUWANEEVILLE, FLORIDA 904-556-0075

**PORTLAND HIGH SCHOOL
 FIRE ALARM UPGRADES**

PROJECT: PORTLAND, ME
**GROUND FLOOR - SEG. B FIRE
 ALARM REMOVALS PLAN**

SHEET TITLE:	404100 - FD101B
WBRC CAD FILE:	404100 GRAPHIC SCALE: 0"
PROJECT No.:	AS NOTED
SCALE:	S/JL
PROJECT MANAGER:	KRM
DRAWN BY:	S/JL
CHECKED BY:	S/JL

A1 GROUND FLOOR - SEG. B FIRE ALARM REMOVALS PLAN

1/8" = 1'-0"