

GENERAL NOTES

- 1. DRAWING NOTES: CONTRACTOR TO FURNISH AND INSTALL ALL NOTED LABOR AND MATERIALS UNLESS OTHERWISE NOTED.
2. CODE COMPLIANCE: ALL WORK SHALL CONFORM TO THE LATEST EDITION OF STATE, LOCAL AND OTHER CODES WHICH APPLY TO THIS PROJECT OR HAVE JURISDICTION.
3. COORDINATION: IT IS THE RESPONSIBILITY OF THE CONTRACTOR TO COORDINATE ALL DISCIPLINES AND TRADES SO THAT ALL BUILDING SYSTEMS AND COMPONENTS CAN BE ASSEMBLED WITHOUT CONFLICTS.
4. DISCREPANCIES & CLARIFICATIONS: IT IS THE RESPONSIBILITY OF THE CONTRACTOR TO BRING TO THE ARCHITECTS ATTENTION, IN WRITING, ANY DISCREPANCIES OR AMBIGUITIES IN THE DRAWINGS AND/OR SPECIFICATIONS.
5. LAYOUT: UNLESS INDICATED OTHERWISE, CENTER WALL FRAMING AND PARTITION FRAMING ON COLUMN LINES.
6. CENTERING: UNLESS INDICATED OTHERWISE, CENTER BUILDING ELEMENTS WITHIN OR BETWEEN OTHER BUILDING ELEMENTS WHEN CONDITIONS OR THE DRAWINGS INDICATE OR IMPLY THAT SUCH IS THE INTENT, WHETHER OR NOT DIMENSIONS ARE INCLUDED.
7. SYMMETRY: WHERE CONDITIONS OR THE DRAWINGS INDICATE OR IMPLY THAT SYMMETRY IS INTENDED, INFORMATION PROVIDED AT ONE SIDE APPLIES EQUALLY TO BOTH SIDES, UNLESS CONDITIONS CLEARLY PRECLUDE SUCH APPLICATION.
8. ACCESSIBILITY: ALL HANDICAPPED ACCESSIBLE BATHROOMS, GRAB BARS, AND DOOR OPENINGS SHALL COMPLY WITH THE MAINE HUMAN RIGHTS COMMISSION 94-348, CHAPTER 5 OF THE MAINE HUMAN RIGHTS COMMISSION TITLE LATEST EDITION & THE DEPARTMENT OF JUSTICE ADA STANDARDS FOR ACCESSIBLE DESIGN.
9. DRAWING SCALES: WORK FROM THE GIVEN DIMENSIONS ONLY. SCALE IS INDICATED ON THE DRAWINGS FOR CONVENIENCE ONLY.
10. WATER-RESISTANT GWB: INSTALL WATER-RESISTANT GYPSUM WALL BOARD IN ALL REST ROOMS & TOILET ROOMS OR AT ANY WALL WITH PLUMBING FIXTURES.
10A. HIGH IMPACT GWB: INSTALL HIGH IMPACT GYPSUM WALL BOARD IN ALL STAIRWELLS
11. INTERIOR ELEVATIONS: INTERIOR ELEVATIONS MAY BE REVERSED FROM AND/OR SIMILAR TO ACTUAL CONDITIONS.
12. BUILDING INSULATION: PROVIDE AS INDICATED IN WALL SECTIONS AND IN ACCORDANCE WITH PARTITION TYPES, WHETHER OR NOT SHOWN IN DETAILS AND OTHER DRAWINGS.
13. BLOCKING: INSTALL BLOCKING BEHIND ALL SURFACE-APPLIED FIXTURES TRIM, CASEWORK, SHELVES, BRACKETS, TOILET ACCESSORIES, CHAIR RAILS, PICTURE RAILS, GRAB BARS, BASE MOLDINGS, AND AS OTHERWISE REQUIRED, WHEN SUCH ITEMS ARE APPLIED ON STUD WALLS.
14. PENETRATIONS AT STRUCTURAL MEMBERS: BEFORE PENETRATING JOISTS, BEAMS OR OTHER STRUCTURAL MEMBERS, CONSULT WITH THE ARCHITECT.
15. DAMAGED WORK: BUILDING OR SITE COMPONENTS WHICH ARE AFFECTED BY NEW WORK, DEMOLITION, OR WHICH MAY BE DAMAGED BY THE GENERAL CONTRACTOR OR ANY SUB-CONTRACTOR SHALL BE REPLACED OR RESTORED TO ORIGINAL CONDITION AND COLOR TO MEET THE APPROVAL OF THE ARCHITECT.
16. UTILITIES: VERIFY THE SIZE AND LOCATION OF ALL UNDERGROUND UTILITIES AND REPORT ANY DISCREPANCIES TO THE ARCHITECT IN WRITING.
17. RATED CONSTRUCTION: PROVIDE RATED CONSTRUCTION AS REQUIRED BY CODE, AS SPECIFIED, AND AS INDICATED ON DRAWINGS.
18. SHOP DRAWINGS: SUBMIT SHOP DRAWINGS TO THE ARCHITECT FOR REVIEW PRIOR TO FABRICATIONS.
19. PERMITS: THE GENERAL CONTRACTOR SHALL OBTAIN AND PAY FOR ANY BUILDING PERMITS REQUIRED AND CARRY ANY INSURANCE COVERAGES REQUIRED.
20. INTERIOR FINISHES: ALL INTERIOR FINISHES AND FURNISHINGS ARE TO BE CLASS 'A' FIRE-RATED AND ARE TO COMPLY WITH SECTION 920.0 BOCA (INTERIOR FLAME SPREAD).
21. ELECTRICAL DESIGN: REFER TO ELECTRICAL DRAWINGS AND SPECIFICATIONS.
22. WASTE REMOVAL: THE GENERAL CONTRACTOR SHALL DISPOSE OF ALL WASTE AND DEBRIS OFF THE PREMISES.
23. TEMPORARY FACILITIES: PROVIDE ALL TEMPORARY FACILITIES AND SERVICES, CONSTRUCTION AND SUPPORT FACILITIES, AND SECURITY AND PROTECTION AS NEEDED TO PROTECT NEW AND EXISTING CONSTRUCTION FOR THE DURATION OF A COMPLETE INSTALLATION.
24. FINAL CLEANING: EMPLOY EXPERIENCED WORKERS FOR FINAL CLEANING. CLEAN EACH SURFACE TO THE CONDITION EXPECTED IN A COMMERCIAL BUILDING CLEANING PROGRAM.
25. MANUFACTURERS INSTRUCTIONS: ALL MATERIALS & EQUIPMENT SHALL BE INSTALLED ACCORDING TO MANUFACTURER'S SPECIFICATIONS.
26. GUARANTEE: ALL MATERIALS AND WORKSMANSHIP SHALL BE GUARANTEED FOR A PERIOD OF ONE YEAR FROM THE DATE OF FINAL ACCEPTANCE UNLESS OTHERWISE SPECIFIED FOR A LONGER PERIOD OF TIME ON A CERTAIN ITEM.
27. ASBESTOS: ALL MATERIAL USED FOR THE CONSTRUCTION OF THIS PROJECT, WHETHER BUILDING MATERIALS OR APPURTENANCES, SHALL BE NON-ASBESTOS CONTAINING MATERIAL.
28. HAZARDOUS FUMES: THE GENERAL CONTRACTOR SHALL CONFIRM THAT ALL MATERIAL AND FINISHES SPECIFIED AND THEIR FABRICATION OR INSTALLATION WILL NOT RELEASE FUMES OR AROMAS DURING CONSTRUCTION WHICH MAY BE A HAZARD OR NUISANCE TO PERSONNEL.
29. PEST CONTROL: SEAL AND CALK AROUND ALL PENETRATIONS, CRACKS AND CREVICES AND ANY OPENINGS CAPABLE OF HARBORING INSECTS/RODENTS.
30. EXPOSED UTILITIES: ALL EXPOSED UTILITY WIRES AND PIPES (ELECTRICAL, PLUMBING, ETC.) SHALL BE INSTALLED IN A WAY THAT DOES NOT OBSTRUCT OR PREVENT THE CLEANING OF FLOORS, WALLS, AND CEILING AREAS.
31. OWNER SUPPLIED EQUIPMENT: EQUIPMENT SUPPLIED BY THE OWNER AND INSTALLED BY THE GENERAL CONTRACTOR.
32. GAUGE: GALVANIZED GRAB BAR
33. GENERAL CONTRACTOR: GROUND FAULT INTERRUPTER
34. GLASS: GLASS/LAMINATED WOOD GROUND GYPSUM WALL BOARD
35. HOSE BIB: HANDICAP HOLLOW METAL HORIZONTAL HORSE POWER/HIGH POINT/HEAT PUMP HOUR
36. HOT WATER HEATING VENTILATION AIR CONDITIONING UNIT
37. INSIDE DIMENSION/INSIDE DIAMETER
38. INFORMATION
39. INSULATION
40. JOIST
41. JOINT
42. KLN-DRIED 1000 POUNDS
43. LABORATORY
44. LAMINATED
45. LB POUND
46. LEFT HAND
47. LEAD COATED COPPER
48. MACHINE
49. MASONRY
50. MATERIAL
51. MAXIMUM
52. MDO MEDIUM-DENSITY OVERLAY
53. MECH MECHANICAL
54. MEMB MEMBRANE
55. MET METAL
56. MEZ MEZZANINE
57. MFR MANUFACTURER
58. MIN MINIMUM
59. MISC MISCELLANEOUS
60. MO MOUNTED
61. MTD METAL
62. MTB MARKER BOARD
63. N
64. NORTH
65. # NUMBER
66. NIC NOT IN CONTACT
67. NOM NOMINAL DIMENSION
68. NTS NOT TO SCALE
69. ON/OVER OR CONTRASTER
70. OD OUTSIDE DIAMETER/OUTSIDE DIMENSION
71. OFF OFF
72. OPNG OPENING
73. OPH OPPOSITE HAND
74. OPH OPPPOSITE HAND
75. OSB ORIENTED STRAND BOARD
76. OUNCE
77. PURCHASED BY OWNER INSTALLED BY CONTRACTOR
78. PRECAST
79. PL PLATE
80. PLAM PLASTIC LAMINATE
81. PR PAIR
82. PRF PREFABRICATE
83. PRIV PRIVACY
84. PRIM PRIMED
85. PSF POUNDS PER SQUARE FOOT
86. PSI POUNDS PER SQUARE INCH
87. PTD PAINTED
88. PTN PARTITION
89. POL POLYVINYL CHLORIDE
90. PWD PLYWOOD
91. PRT PRESSURE TREATED PERFORATED
92. QUARTER TILE
93. QTR QUARTER
94. RISER/RADIUS
95. RAD RADIUS
96. RUB RUBBER BASE
97. RCP REFLECTED CEILING PLAN
98. RD ROOF DRAIN
99. REBAR REINFORCING BAR
100. REF REFRIGERATOR
101. REIN REINFORCED
102. REQ REQUIRED
103. RES RESILIENT
104. REV REVERSE
105. RM ROOM
106. RO ROUGH OPENING
107. ROW RIGHT OF WAY
108. SOUTH
109. SCHED SCHEDULE
110. SF SQUARE FEET
111. SIM SIMILAR
112. SPEC SPECIFICATION
113. SQ SQUARE
114. SST STAINLESS STEEL
115. SOUND TRANSMISSION CLASS
116. STD STANDARD
117. STC STEEL
118. STOR STORAGE
119. STRUCT STRUCTURE/STRUCTURAL SUSPENSION
120. T&G TONGUE&GROOVE
121. TEL TELEPHONE
122. THK THICK
123. TOP OF DECK
124. TOS TOP OF STEEL
125. TYP TYPICAL
126. TV TELEVISION
127. TB TACK BOARD
128. TOC TOP OF CONCRETE
129. UNDERWRITERS LABORATORIES, INC. UNIT VENTILATOR
130. VCT VINYL COMPOSITION TILE
131. VERT VERTICAL
132. VIF VERIFY IN FIELD
133. VOL VOLUME
134. WEST
135. W/O WITHOUT
136. W/ WITH
137. WOOD
138. WF WIDE FLANGE
139. WP WORK POINT
140. WT WEIGHT

ABBREVIATIONS

- AIR CONDITIONING
ACUSTICAL CEILING TILE
AREA DRAIN
AMERICANS WITH DISABILITIES ACT ACCESSIBILITY'S GUIDELINES
ADDENDUM
AFF ABOVE FINISHED FLOOR
AHU AIR-HANDLING UNIT
AL ALUMINUM
ARCH ARCHITECTURE/ARCHITECTURAL
AWP ACOUSTIC WALL PANEL
BACK-TO-BACK ANGLES
BASE BUILDING GENERAL CONTRACTOR
BUILDING LINE
BLDG BUILDING
BLKG BLOCKING
BSMT BASEMENT
BTWN BETWEEN
BO BY OTHERS
COURSE (MASONRY)
CERAMIC
CORNER GUARD
CH COAT HOOK
CJ CONTROL JOINT
CL CENTER LINE
CLG CEILING
CONJ CONNECTION MASONRY UNIT
CO CLEAN OUT
COLU COLUMN
CONC CONCRETE
COND CONDITION
CONN CONNECTION
CONST CONSTRUCTION
CONT CONTINUOUS
CORR CORRIDOR
CERAMIC TILE
CABINET UNIT HEATER
DOUBLE
DRINKING FOUNTAIN
DIA DIAMETER
DIFF DIFFUSER
DIM DIMENSION
DOWN
DR DOOR
DRY DRY STAND PIPE
DWG DRAWING
EAST
EA EACH
EL ELEVATION
ELEC ELECTRICAL
ELEV ELEVATOR
ENTR ENTRANCE
EQ EQUAL
EQUIP EQUIPMENT
EXP EXPANSION
EXPB EXPANSION BOLT
EXPJ EXPANSION JOINT
EXT EXTERIOR
ELEM ELEMENT
EWC ELECTRIC WATER COOLER
FAHRENHEIT
FB FLAT BAR
FC FIRE EXTINGUISHER AND CABINET
FD FLOOR DRAIN
FE FIRE EXTINGUISHER
FEC FIRE EXTINGUISHER CABINET
FWD FIRE TREATED WOOD
FIN FINISH
FL FLOOR
FBR FACE OF BRICK
FOC FACE OF CONCRETE
FOF FACE OF FINISH
FOS FACE OF STUDS
FOW FACE OF WALL
FSS FIRE SUPPRESSION SYSTEM
FT FOOT
FTG FOOTING
FRC FIBER REINFORCED GYPSUM
FTR FIN TUBE RADIATION
FUM FUME HOOD
GAUGE
GALVANIZED GRAB BAR
GENERAL CONTRACTOR
GROUND FAULT INTERRUPTER
GLASS/GLAZING/GLAZED GLUE-LAMINATED WOOD
GROUND
GWB GYPSUM WALL BOARD
HOSE BIB
HANDICAP
HOLLOW METAL
HORIZONTAL
HORSE POWER/HIGH POINT/HEAT PUMP
HOUR
HOT WATER HEATING VENTILATION AIR CONDITIONING UNIT
INSIDE DIMENSION/INSIDE DIAMETER
INCHES
INFORMATION
INSULATION
JOIST
JOINT
KLN-DRIED 1000 POUNDS
LABORATORY
LAMINATED
LB POUND
LEFT HAND
LEAD COATED COPPER
MACHINE
MASONRY
MATERIAL
MAXIMUM
MDO MEDIUM-DENSITY OVERLAY
MECH MECHANICAL
MEMB MEMBRANE
MET METAL
MEZ MEZZANINE
MFR MANUFACTURER
MIN MINIMUM
MISC MISCELLANEOUS
MO MOUNTED
MTD METAL
MTB MARKER BOARD
NORTH
NUMBER
NIC NOT IN CONTACT
NOM NOMINAL DIMENSION
NTS NOT TO SCALE
ON/OVER OR CONTRASTER
OD OUTSIDE DIAMETER/OUTSIDE DIMENSION
OFF OFF
OPNG OPENING
OPH OPPOSITE HAND
OPH OPPPOSITE HAND
OSB ORIENTED STRAND BOARD
OUNCE
PURCHASED BY OWNER INSTALLED BY CONTRACTOR
PRECAST
PL PLATE
PLAM PLASTIC LAMINATE
PR PAIR
PRF PREFABRICATE
PRIV PRIVACY
PRIM PRIMED
PSF POUNDS PER SQUARE FOOT
PSI POUNDS PER SQUARE INCH
PTD PAINTED
PTN PARTITION
POL POLYVINYL CHLORIDE
PWD PLYWOOD
PRT PRESSURE TREATED PERFORATED
QUARTER TILE
QTR QUARTER
RISER/RADIUS
RAD RADIUS
RUB RUBBER BASE
RCP REFLECTED CEILING PLAN
RD ROOF DRAIN
REBAR REINFORCING BAR
REF REFRIGERATOR
REIN REINFORCED
REQ REQUIRED
RES RESILIENT
REV REVERSE
RM ROOM
RO ROUGH OPENING
ROW RIGHT OF WAY
SOUTH
SCHED SCHEDULE
SF SQUARE FEET
SIM SIMILAR
SPEC SPECIFICATION
SQ SQUARE
SST STAINLESS STEEL
SOUND TRANSMISSION CLASS
STD STANDARD
STC STEEL
STOR STORAGE
STRUCT STRUCTURE/STRUCTURAL SUSPENSION
T&G TONGUE&GROOVE
TEL TELEPHONE
THK THICK
TOP OF DECK
TOS TOP OF STEEL
TYP TYPICAL
TV TELEVISION
TB TACK BOARD
TOC TOP OF CONCRETE
UNDERWRITERS LABORATORIES, INC. UNIT VENTILATOR
VCT VINYL COMPOSITION TILE
VERT VERTICAL
VIF VERIFY IN FIELD
VOL VOLUME
WEST
W/O WITHOUT
W/ WITH
WOOD
WF WIDE FLANGE
WP WORK POINT
WT WEIGHT

ABBREVIATIONS

- AIR CONDITIONING
ACUSTICAL CEILING TILE
AREA DRAIN
AMERICANS WITH DISABILITIES ACT ACCESSIBILITY'S GUIDELINES
ADDENDUM
AFF ABOVE FINISHED FLOOR
AHU AIR-HANDLING UNIT
AL ALUMINUM
ARCH ARCHITECTURE/ARCHITECTURAL
AWP ACOUSTIC WALL PANEL
BACK-TO-BACK ANGLES
BASE BUILDING GENERAL CONTRACTOR
BUILDING LINE
BLDG BUILDING
BLKG BLOCKING
BSMT BASEMENT
BTWN BETWEEN
BO BY OTHERS
COURSE (MASONRY)
CERAMIC
CORNER GUARD
CH COAT HOOK
CJ CONTROL JOINT
CL CENTER LINE
CLG CEILING
CONJ CONNECTION MASONRY UNIT
CO CLEAN OUT
COLU COLUMN
CONC CONCRETE
COND CONDITION
CONN CONNECTION
CONST CONSTRUCTION
CONT CONTINUOUS
CORR CORRIDOR
CERAMIC TILE
CABINET UNIT HEATER
DOUBLE
DRINKING FOUNTAIN
DIA DIAMETER
DIFF DIFFUSER
DIM DIMENSION
DOWN
DR DOOR
DRY DRY STAND PIPE
DWG DRAWING
EAST
EA EACH
EL ELEVATION
ELEC ELECTRICAL
ELEV ELEVATOR
ENTR ENTRANCE
EQ EQUAL
EQUIP EQUIPMENT
EXP EXPANSION
EXPB EXPANSION BOLT
EXPJ EXPANSION JOINT
EXT EXTERIOR
ELEM ELEMENT
EWC ELECTRIC WATER COOLER
FAHRENHEIT
FB FLAT BAR
FC FIRE EXTINGUISHER AND CABINET
FD FLOOR DRAIN
FE FIRE EXTINGUISHER
FEC FIRE EXTINGUISHER CABINET
FWD FIRE TREATED WOOD
FIN FINISH
FL FLOOR
FBR FACE OF BRICK
FOC FACE OF CONCRETE
FOF FACE OF FINISH
FOS FACE OF STUDS
FOW FACE OF WALL
FSS FIRE SUPPRESSION SYSTEM
FT FOOT
FTG FOOTING
FRC FIBER REINFORCED GYPSUM
FTR FIN TUBE RADIATION
FUM FUME HOOD
GAUGE
GALVANIZED GRAB BAR
GENERAL CONTRACTOR
GROUND FAULT INTERRUPTER
GLASS/GLAZING/GLAZED GLUE-LAMINATED WOOD
GROUND
GWB GYPSUM WALL BOARD
HOSE BIB
HANDICAP
HOLLOW METAL
HORIZONTAL
HORSE POWER/HIGH POINT/HEAT PUMP
HOUR
HOT WATER HEATING VENTILATION AIR CONDITIONING UNIT
INSIDE DIMENSION/INSIDE DIAMETER
INCHES
INFORMATION
INSULATION
JOIST
JOINT
KLN-DRIED 1000 POUNDS
LABORATORY
LAMINATED
LB POUND
LEFT HAND
LEAD COATED COPPER
MACHINE
MASONRY
MATERIAL
MAXIMUM
MDO MEDIUM-DENSITY OVERLAY
MECH MECHANICAL
MEMB MEMBRANE
MET METAL
MEZ MEZZANINE
MFR MANUFACTURER
MIN MINIMUM
MISC MISCELLANEOUS
MO MOUNTED
MTD METAL
MTB MARKER BOARD
NORTH
NUMBER
NIC NOT IN CONTACT
NOM NOMINAL DIMENSION
NTS NOT TO SCALE
ON/OVER OR CONTRASTER
OD OUTSIDE DIAMETER/OUTSIDE DIMENSION
OFF OFF
OPNG OPENING
OPH OPPOSITE HAND
OPH OPPPOSITE HAND
OSB ORIENTED STRAND BOARD
OUNCE
PURCHASED BY OWNER INSTALLED BY CONTRACTOR
PRECAST
PL PLATE
PLAM PLASTIC LAMINATE
PR PAIR
PRF PREFABRICATE
PRIV PRIVACY
PRIM PRIMED
PSF POUNDS PER SQUARE FOOT
PSI POUNDS PER SQUARE INCH
PTD PAINTED
PTN PARTITION
POL POLYVINYL CHLORIDE
PWD PLYWOOD
PRT PRESSURE TREATED PERFORATED
QUARTER TILE
QTR QUARTER
RISER/RADIUS
RAD RADIUS
RUB RUBBER BASE
RCP REFLECTED CEILING PLAN
RD ROOF DRAIN
REBAR REINFORCING BAR
REF REFRIGERATOR
REIN REINFORCED
REQ REQUIRED
RES RESILIENT
REV REVERSE
RM ROOM
RO ROUGH OPENING
ROW RIGHT OF WAY
SOUTH
SCHED SCHEDULE
SF SQUARE FEET
SIM SIMILAR
SPEC SPECIFICATION
SQ SQUARE
SST STAINLESS STEEL
SOUND TRANSMISSION CLASS
STD STANDARD
STC STEEL
STOR STORAGE
STRUCT STRUCTURE/STRUCTURAL SUSPENSION
T&G TONGUE&GROOVE
TEL TELEPHONE
THK THICK
TOP OF DECK
TOS TOP OF STEEL
TYP TYPICAL
TV TELEVISION
TB TACK BOARD
TOC TOP OF CONCRETE
UNDERWRITERS LABORATORIES, INC. UNIT VENTILATOR
VCT VINYL COMPOSITION TILE
VERT VERTICAL
VIF VERIFY IN FIELD
VOL VOLUME
WEST
W/O WITHOUT
W/ WITH
WOOD
WF WIDE FLANGE
WP WORK POINT
WT WEIGHT

FIRESTOPPING DETAILS

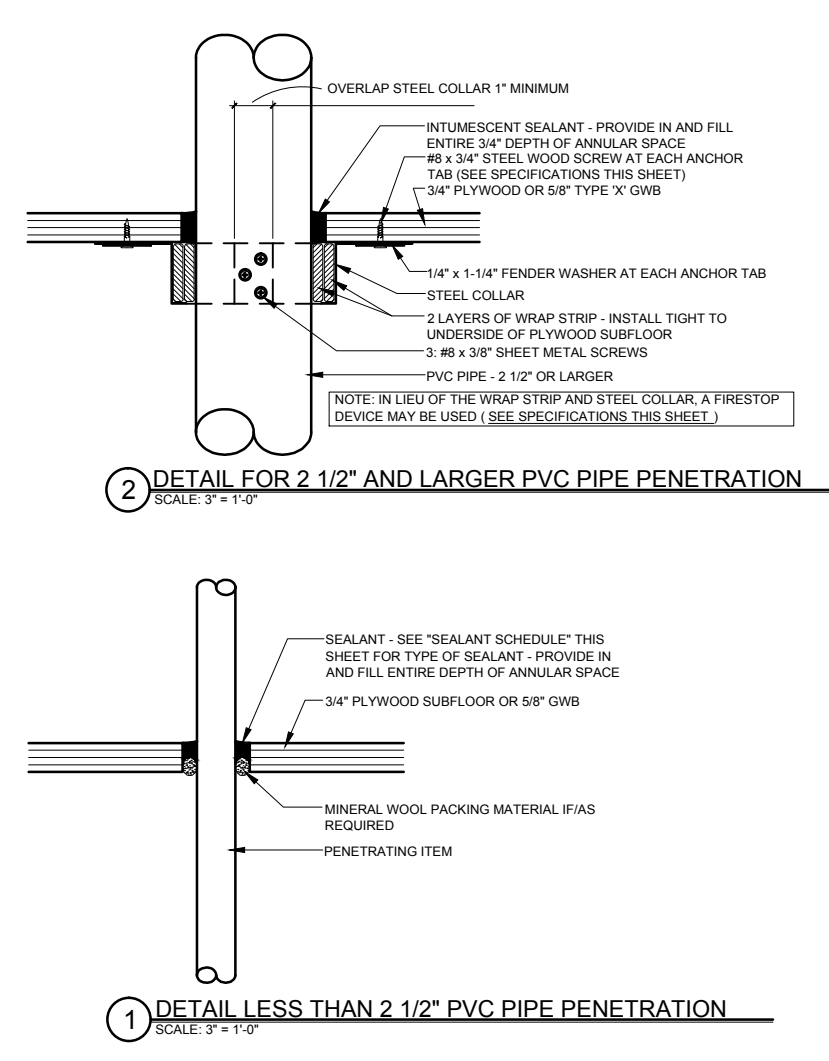

SPECIFICATIONS

WRAP STRIP: 1/4" THICK X 1 1/2" MINIMUM WIDTH INTUMESCENT MATERIAL WITH PLASTIC FILM FACING BOTH SIDES. TEMPORARILY SECURE WITH MASKING TAPE. SPECIFIED TECHNOLOGIES INC. (STI) "SpecSeal RED Wrap Strip" OR "SpecSeal BLU Wrap Strip" OR EQUAL.
STEEL COLLAR: WRAP STRIP MANUFACTURER'S STEEL COLLAR, FABRICATED FROM .016 INCH THICK GALVANIZED SHEET STEEL, WIDTH TO MATCH WRAP STRIP (1 1/2" MINIMUM), WITH 1 INCH X 2 INCH ANCHOR TABS AND RETAINER TABS. ANCHOR TABS TO BE SYMMETRICALLY OPPOSED AROUND COLLAR. PROVIDE 3 TABS FOR 2 1/2" AND 3" PIPE; PROVIDE 4 TABS FOR 4" PIPE.
INTUMESCENT SEALANT: ONE-PART, INTUMESCENT, LATEX ELASTOMER TESTED TO ASTM E 814. MINIMUM EXPANSION OF 3x AT 1000°F. 3M "FIRE BARRIER SEALANT CP 25WB" OR EQUAL.
FIRESTOP SEALANT: SINGLE COMPONENT NONCOMBUSTIBLE FIRE RATED SEALANT TESTED TO ASTM E 814. TESTED TO 3000°F. "BOSS 136 FIRESTOP/DRAFT SEALANT" MANUFACTURED BY ACCUMETRIC, LLC. OR EQUAL.
SEALANT SCHEDULE: INTUMESCENT SEALANT: PROVIDE AT ALL PENETRATIONS THROUGH RATED CONSTRUCTION FOR PENETRATING ITEMS INCLUDING BUT NOT LIMITED TO: PVC PIPE; ROOF LEADER PIPES; GAS PIPES & LINES; SPRINKLER PIPES; ELECTRICAL & COMMUNICATIONS CABLES & WIRES; AND ALARM SYSTEM WIRES. DO NOT USE INTUMESCENT SEALANT AT DOMESTIC HOT WATER OR HYDRONIC HEATING SYSTEM PIPES.
FIRESTOP SEALANT: PROVIDE AT ALL PENETRATIONS THROUGH RATED CONSTRUCTION FOR PENETRATING ITEMS INCLUDING DOMESTIC HOT AND COLD WATER PIPES AND HYDRONIC HEATING SYSTEM PIPES.
NOTE: FOR LOCATIONS OF RATED CONSTRUCTION, SEE ARCHITECTURAL FLOOR PLANS AND SECTIONS

DRAWING LEGEND

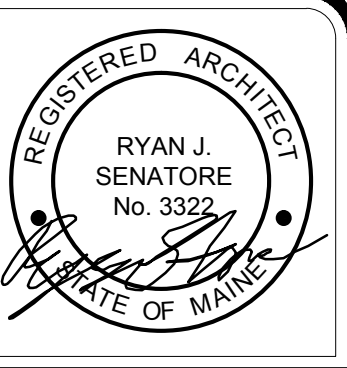
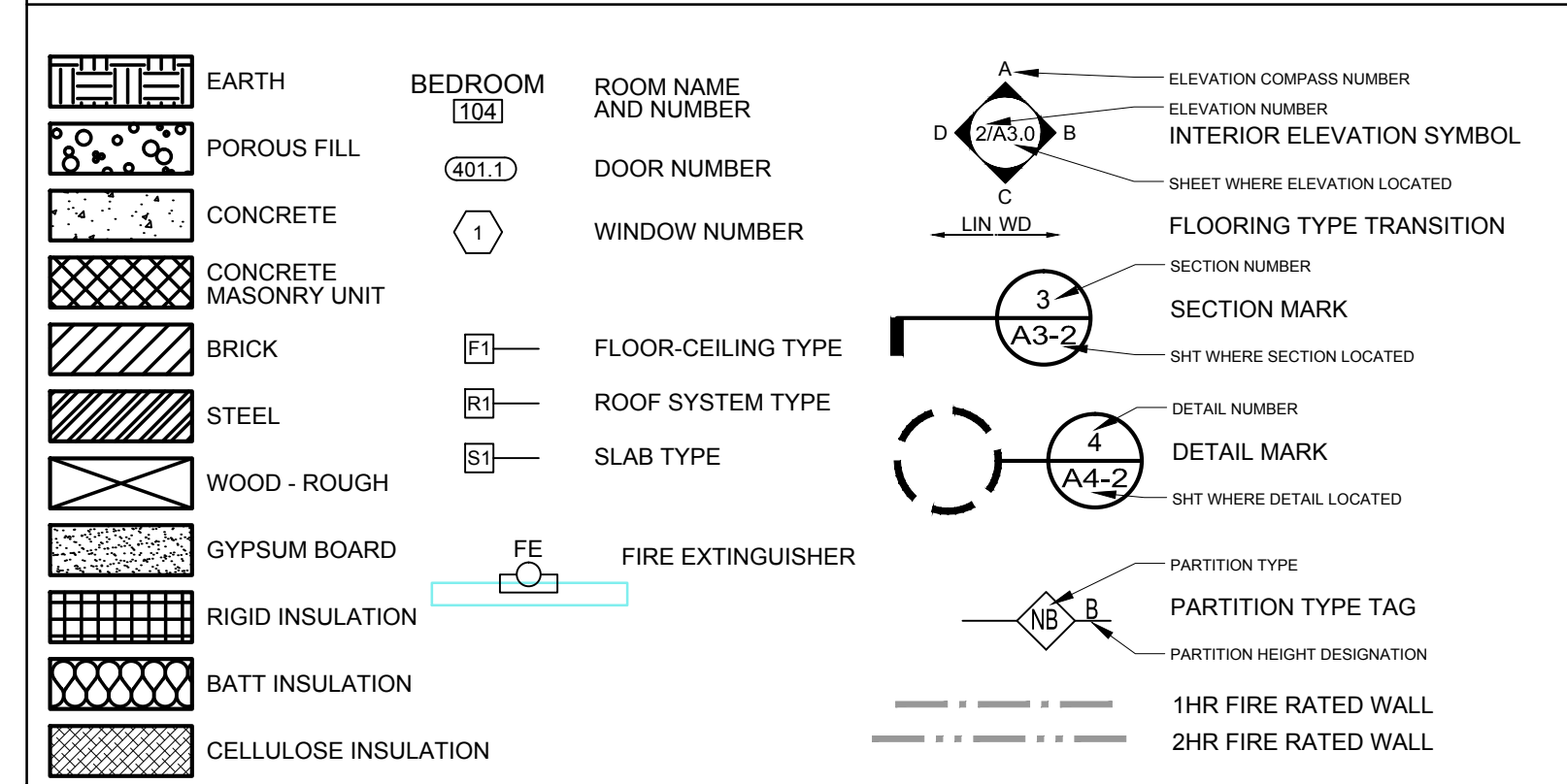

© 2016 RYAN SENATORE ARCHITECTURE

OFFICE RENOVATION
465 CONGRESS STREET, 7TH FLOOR, SUITE 702
PORTLAND, MAINE



RYAN SENATORE ARCHITECTURE
965 CONGRESS STREET
PORTLAND, MAINE 04101
207-650-6414
senatorearchitecture.com

CONSULTANTS:

REVISIONS:

DATE: 27 JULY 2016

PROJECT No. 1636

DRAWN BY: RRT

CHECKED BY: RJS

SCALE: AS NOTED

SHEET TITLE: GENERAL NOTES AND ABBREVIATIONS

G1-0