

© 2016 RYAN SENATORE ARCHITECTURE

OFFICE RENOVATION
 465 CONGRESS STREET, 7TH FLOOR, SUITE 702
 PORTLAND, MAINE



RYAN SENATORE ARCHITECTURE
 565 CONGRESS STREET
 PORTLAND, MAINE 04101
 207-650-6414
 senatorearchitecture.com

CONSULTANTS:

REVISIONS:

DATE: 27 JULY 2016

PROJECT No. 1636

DRAWN BY: RRT

CHECKED BY: RJS

SCALE: AS NOTED

SHEET TITLE:
 TELEPHONE / DATA PLAN

A1-2

LEGEND	TELECOMMUNICATIONS / DATA PLAN
⊗	TO 6TH FLOOR - REMOVE
Ⓟ	REMOVE EXISTING POWER AND DATA OUTLET
Ⓢ	NEW POWER AND DATA OUTLET
Ⓠ	USE EXISTING POWER AND DATA OUTLET

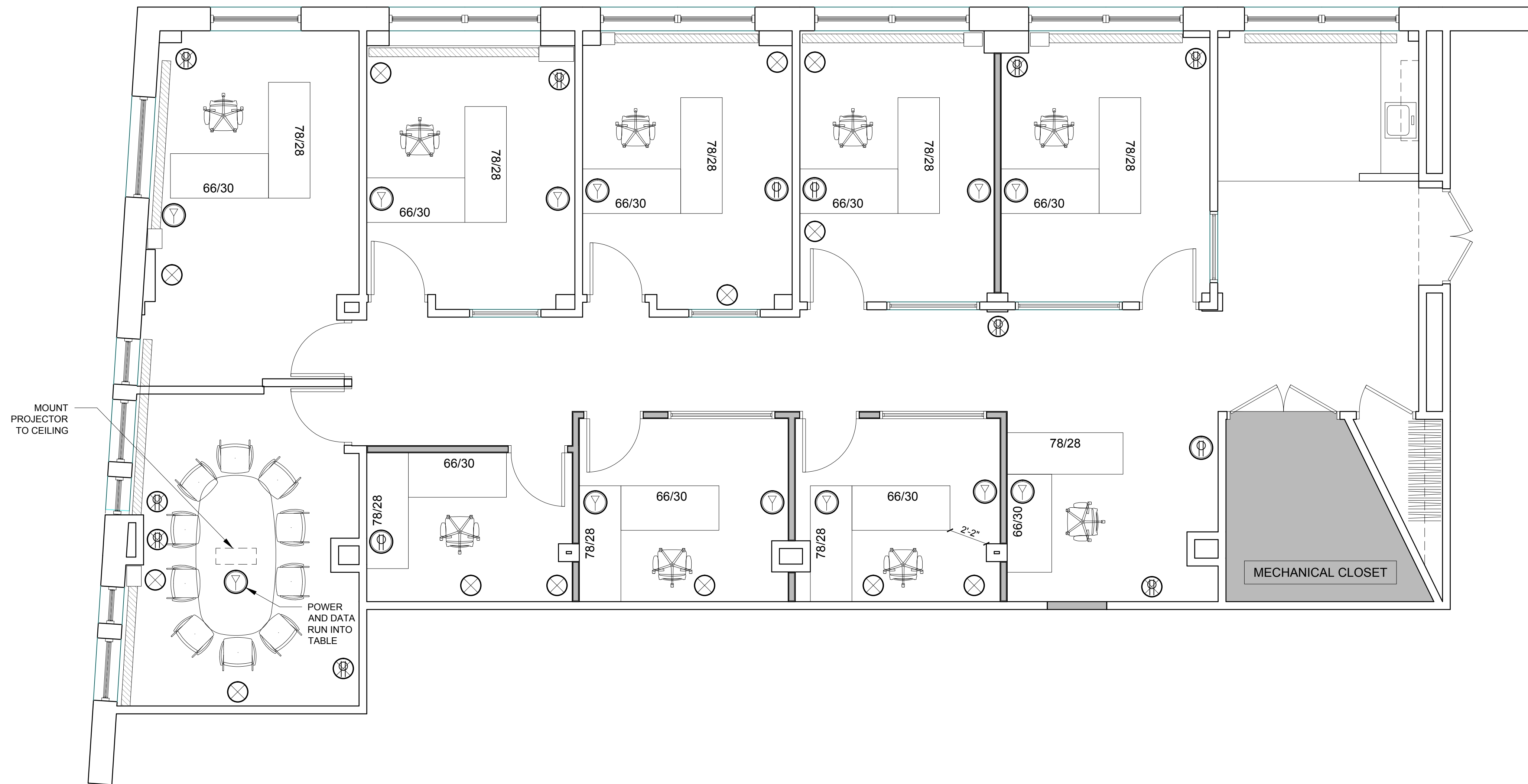

1 TELEPHONE / DATA PLAN
 1/4" = 1'-0"