

© 2016 RYAN SENATORE ARCHITECTURE

OFFICE RENOVATION
 465 CONGRESS STREET, 7TH FLOOR, SUITE 702
 PORTLAND, MAINE



RYAN SENATORE ARCHITECTURE
 565 CONGRESS STREET
 PORTLAND, MAINE 04101
 207-650-6414
 senatorearchitecture.com

CONSULTANTS:

REVISIONS:

DATE: 27 JULY 2016

PROJECT No. 1636

DRAWN BY: RRT

CHECKED BY: RJS

SCALE: AS NOTED

SHEET TITLE:
REFLECTED CEILING PLAN

A1-1

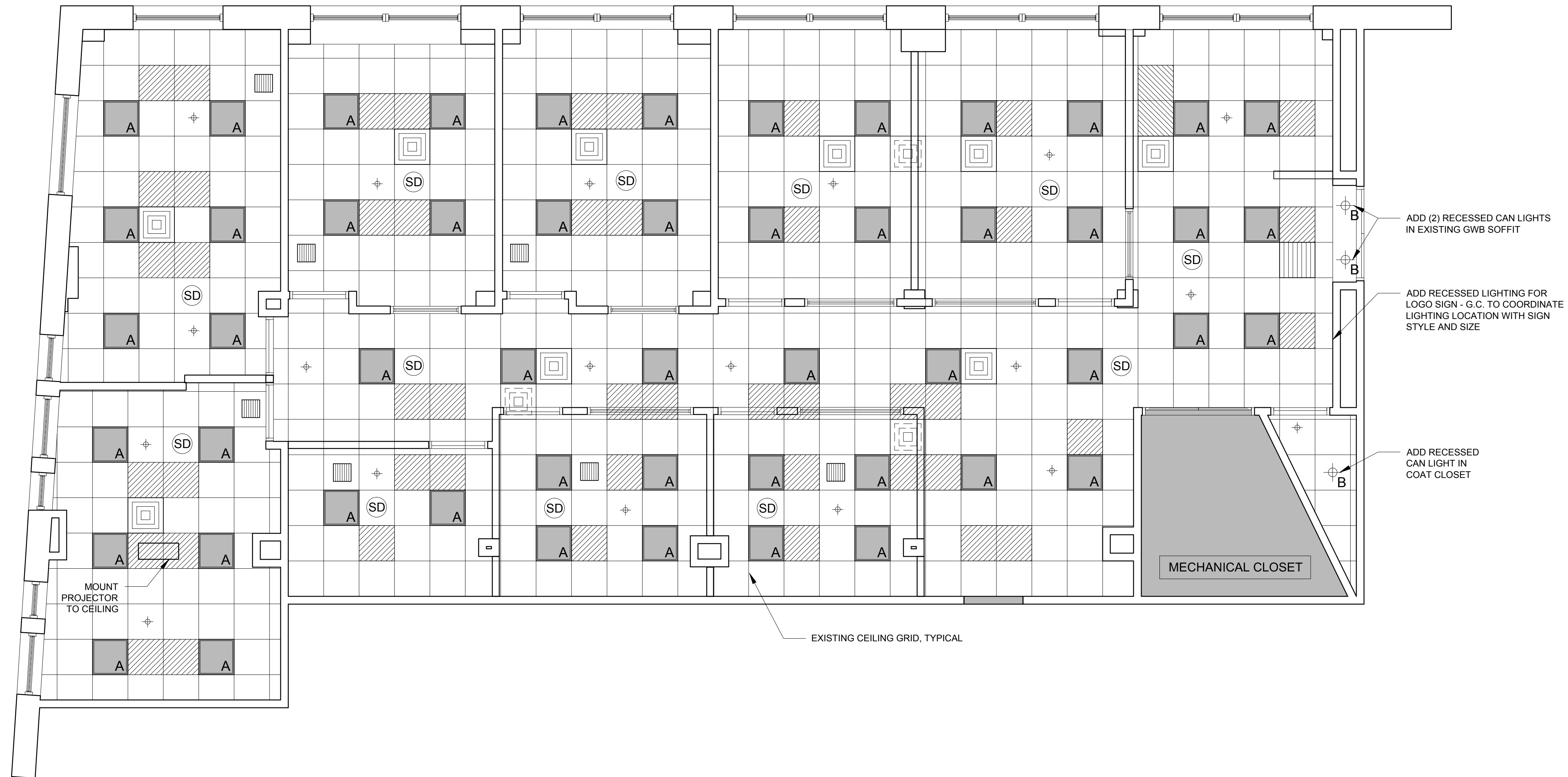

- GENERAL NOTES:**
- 1.) RELOCATE SPRINKLER HEADS AS REQUIRED
 - 2.) RELOCATE CEILING VENTS AS REQUIRED
 - 3.) RELOCATE SMOKE DETECTORS AS REQUIRED
 - 4.) RELOCATE EMERGENCY LIGHTING AS REQUIRED
 - 5.) ALL NEW LIGHTING TO BE INDIRECT LED
 - 6.) EMERGENCY LIGHTING IS SHOWN FOR GRAPHIC PURPOSES ONLY. DESIGN / BUILD ELECTRICAL CONTRACTOR TO BE RESPONSIBLE FOR FINAL LOCATIONS AND CODE COMPLIANCE.

LEGEND	NEW REFLECTED CEILING PLAN
	EXISTING / NEW 2' X 2' GRILL IN CEILING
	REMOVED 2' X 2' GRILL IN CEILING
	REMOVED 2' X 4' LIGHT
	REMOVED EXISTING 2' X 2' LIGHT
	NEW 4" RECESSED LIGHT
	NEW 2' X 2' INDIRECT LED LIGHTING
	NEW OR MOVED 2' X 2' GRILL
	NEW OR MOVED 1' X 1' GRILL
	NEW OR MOVED SMOKE DETECTOR
	NEW OR MOVED SPRINKLER HEAD

1 REFLECTED CEILING PLAN
 1/4" = 1'-0"