

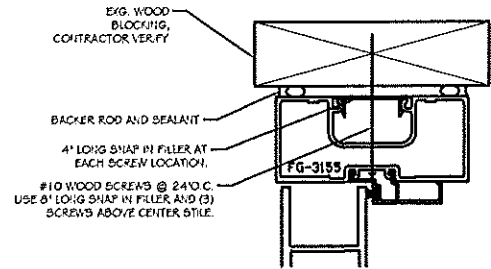

B3 PHOTO - EXTERIOR OF ENTRANCE

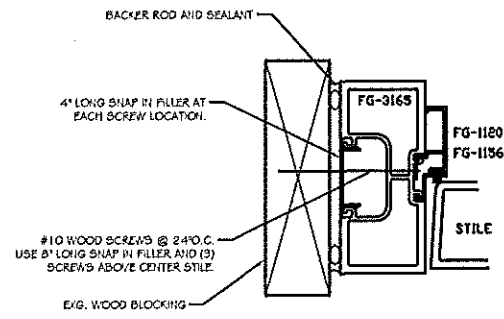

④ HEAD ATTACHMENT



⑤ JAMB ATTACHMENT

- NOTES:
1. CONTRACTOR TO PROVIDE SHOP DRAWINGS WITH MANUFACTURER APPROVED INSTALLATION DETAILS PRIOR TO CONSTRUCTION.
  2. DOOR FINISH TO BE DARK ANODIZED BRONZE (MATCH EXISTING).
  3. DOOR HARDWARE TO INCLUDE: 1 1/2 PAIR OF BUTT HINGES, HORTON 1604 SURFACE MOUNTED CLOSER, M-D RAIL, CVR PANYC HARDWARE, OFFSET PULLS, SWEEPS AND 1/2\"/>
  - 4. DOOR, DOOR FRAME, GLASS, AND FASTENERS TO BE DESIGNED AND INSTALLED TO SATISFY THE WIND LOADING REQUIREMENTS OF IBC 2009 AND ASCE 7-05:
  - 4.1.  $V=85$  MPH,  $P_s=25$  PSF (EQE 4)
  - 5. ALUMINUM ELEMENTS AND FASTENERS TO BE DESIGNED PER AAMA ALUMINUM DESIGN MANUAL 2010 ED.
  - 6. MAX MULTION DEFLECTION IS SPAN/175.
  - 7. MAX GLASS DEFLECTION IS SPAN/50.

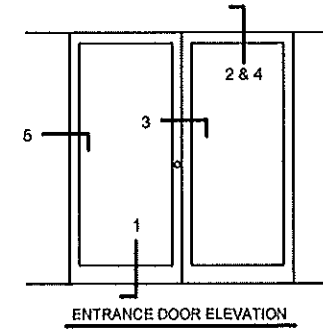

ENTRANCE DOOR ELEVATION

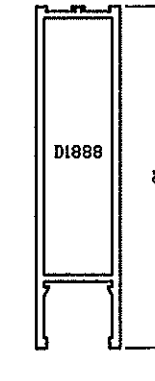

① TYPICAL BOTTOM RAIL

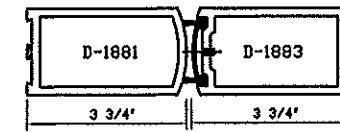

③ MEDIUM STILE

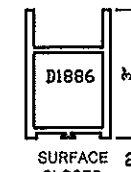

② SURFACE CLOSER TOP RAILS



ASSOCIATED DESIGN PARTNERS INC.

80 Leighton Road  
Portland, Maine 04105  
Office: (207) 878-1751  
Fax: (207) 878-1788  
E-Mail: [adp@designpartnersinc.com](mailto:adp@designpartnersinc.com)

THIS DOCUMENT IS THE PROPERTY OF ASSOCIATED DESIGN PARTNERS INC. IT IS TO BE USED ONLY FOR THE PROJECT AND SITE SPECIFICALLY IDENTIFIED HEREON. IT IS NOT TO BE REPRODUCED OR TRANSMITTED IN ANY FORM OR BY ANY MEANS, ELECTRONIC OR MECHANICAL, WITHOUT THE WRITTEN PERMISSION OF ASSOCIATED DESIGN PARTNERS INC.

PROJECT: PEOPLE'S UNITED BANK  
465 CONGRESS ST., PORTLAND  
FOR: JACK GOGLIN  
SHEET TITLE: ENTRANCE DOOR REPLACEMENT AND DETAILS ISSUED FOR PERMITTING

NO.	BY	REVISIONS DESCRIPTION	DATE

DATE: 3-9-12  
SCALE: AS NOTED  
DESIGN BY: ASW  
DRAWN BY: RSO  
FILE # 12063-1101.dwg  
PROJECT NUMBER: 12063  
SHEET NO: A101



A3 PHOTO - INTERIOR LOOKING TOWARD ENTRYWAY



A2 PHOTO - INTERIOR OF VESTIBULE

- NOTES:
1. ALL DIMENSIONS ARE APPROXIMATE, CONTRACTOR TO FIELD VERIFY.
  2. THE WORK COMPLIES WITH THE 2009 INTERNATIONAL EXISTING BUILDING CODE, CHAPTER 5. REPAIRS BASED ON INTERPRETATION OF THE FOLLOWING:
  - 2.1. SECTION 501.2 - "THE WORK SHALL NOT MAKE THE BUILDING LESS CONFORMING THAN IT WAS BEFORE THE REPAIR WAS UNDERTAKEN"
  - 2.2. SECTION 504.1 "REPAIRS SHALL BE DONE IN A MANNER THAT MAINTAINS THE LEVEL OF PROTECTION PROVIDED FOR THE MEANS OF EGRESS"
  - 2.3. SECTION 505.1 "REPAIRS SHALL BE DONE IN A MANNER THAT MAINTAINS THE LEVEL OF ACCESSIBILITY PROVIDED"
  3. IT IS THE DESIGN PROFESSIONAL'S OPINION THAT THE REMOVAL AND REPLACEMENT OF THE DAMAGED DOOR COMPLIES WITH THE PROVISIONS OF CHAPTER 5 OF THE 2009 IBC.

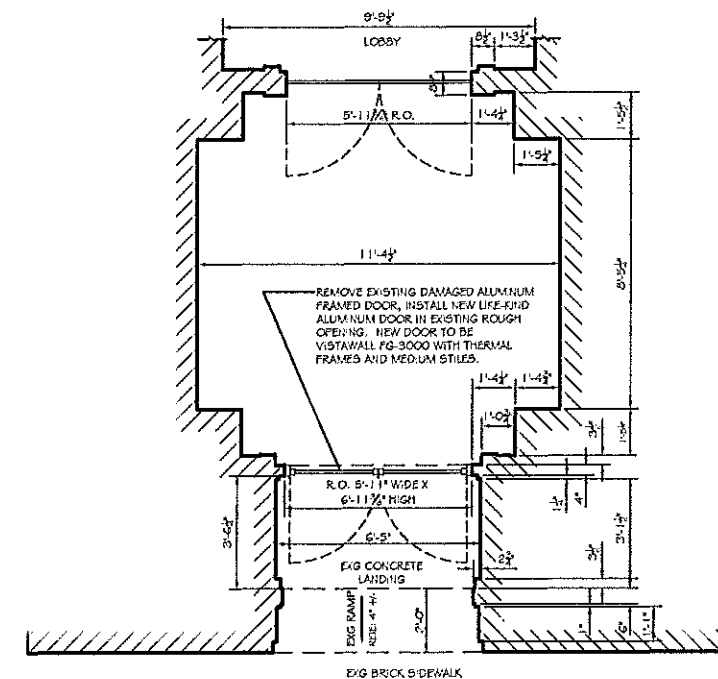

EXG. ENTRY PLAN

A1 EXG. ENTRY PLAN  
SCALE: 3/8"=1'-0"



B3 PHOTO - EXTERIOR OF ENTRANCE

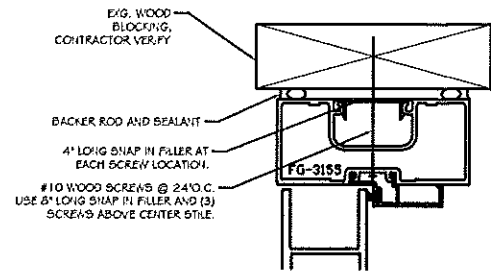

④ HEAD ATTACHMENT

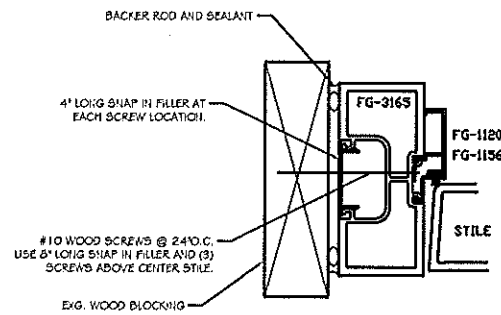

⑤ JAMB ATTACHMENT

- NOTES:
1. CONTRACTOR TO PROVIDE SHOP DRAWINGS WITH MANUFACTURER APPROVED INSTALLATION DETAILS PRIOR TO CONSTRUCTION.
  2. DOOR FINISH TO BE DARK ANODIZED BRONZE (MATCH EXISTING).
  3. DOOR HARDWARE TO INCLUDE: 1 1/2 PAIR OF BUTT HINGES, HORTON 1604 SURFACE MOUNTED CLOSER, M/D RAIL, CVR PATIC HARDWARE, OFFSET PULLS, SWEETS AND 1/2" THRESHOLD. THE DOORS WILL BE GLAZED WITH 1" CLEAR INSULATED GLASS.
  4. DOOR, DOOR FRAME, GLASS, AND FASTENERS TO BE DESIGNED AND INSTALLED TO SATISFY THE WIND LOADING REQUIREMENTS OF IBC 2009 AND ASCE 7-05:
    1. V=95 MPH, P<sub>w</sub>=25 PSF (ZONE 4)
  5. ALUMINUM ELEMENTS AND FASTENERS TO BE DESIGNED PER AAMA ALUMINUM DESIGN MANUAL 2010 ED.
  6. MAX MULTIPLY DEFLECTION IS SPAN/175.
  7. MAX GLASS DEFLECTION IS SPAN/250.

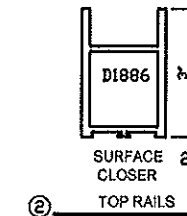
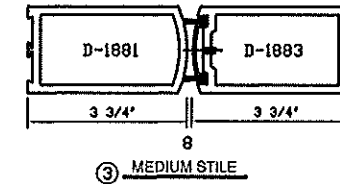
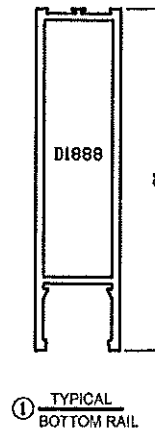
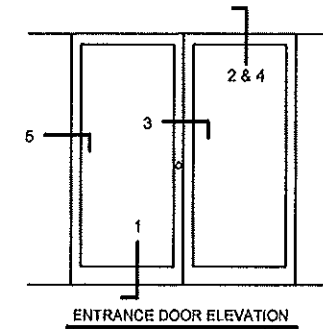

B2 DOOR DETAILS

SCALE: NTS



A3 PHOTO - INTERIOR LOOKING TOWARD ENTRYWAY



A2 PHOTO - INTERIOR OF VESTIBULE

- NOTES:
1. ALL DIMENSIONS ARE APPROXIMATE, CONTRACTOR TO FIELD VERIFY.
  2. THE WORK COMPLIES WITH THE 2009 INTERNATIONAL EXISTING BUILDING CODE, CHAPTER 5-REPAIRS BASED ON INTERPRETATION OF THE FOLLOWING:
    - 2.1. SECTION 501.2 - "THE WORK SHALL NOT MAKE THE BUILDING LESS CONFORMING THAN IT WAS BEFORE THE REPAIR WAS UNDERTAKEN."
    - 2.2. SECTION 504.1 "REPAIRS SHALL BE DONE IN A MANNER THAT MAINTAINS THE LEVEL OF PROTECTION PROVIDED FOR THE MEANS OF EGRESS."
    - 2.3. SECTION 505.1 "REPAIRS SHALL BE DONE IN A MANNER THAT MAINTAINS THE LEVEL OF ACCESSIBILITY PROVIDED."
  3. IT IS THE DESIGN PROFESSIONAL'S OPINION THAT THE REMOVAL AND REPLACEMENT OF THE DAMAGED DOOR COMPLIES WITH THE PROVISIONS OF CHAPTER 5 OF THE 2009 IBC.

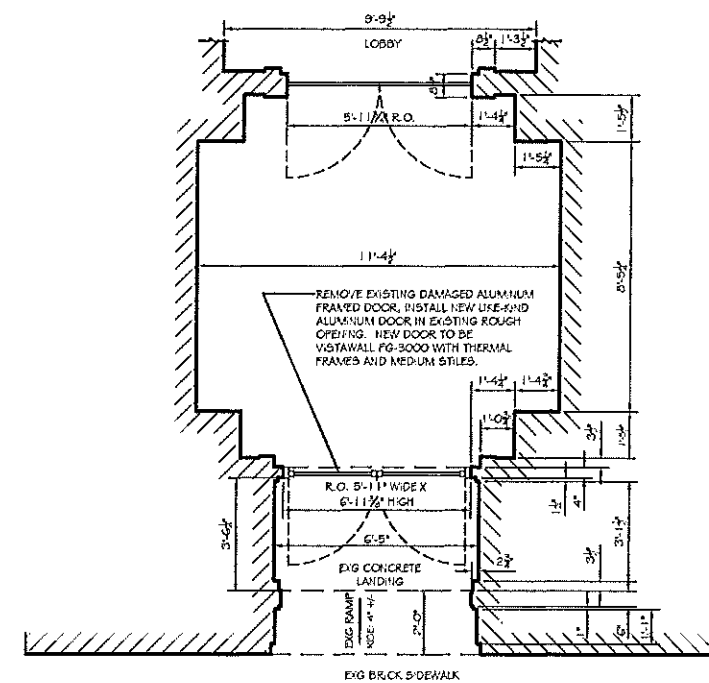

A1 EXG. ENTRY PLAN  
SCALE: 3/8"=1'-0"



**ASSOCIATED DESIGN PARTNERS INC.**

Office: (207) 878-1751  
Fax: (207) 878-1788  
E-Mail: asd@designpartnersinc.com

80 Lightfoot Road  
Falmouth, Maine 04105

NO DESIGN, CONSTRUCTION, OR REPAIRS SHALL BE PERMITTED WITHOUT THE SIGNATURE OF THE REGISTERED DESIGN PROFESSIONAL.

PROJECT: **PEOPLE'S UNITED BANK**  
465 CONGRESS ST., PORTLAND  
FOR: JACK COGLIN

SHEET TITLE: **ENTRANCE DOOR REPLACEMENT AND DETAILS ISSUED FOR PERMITTING**

NO.	BY	REVISIONS	DESCRIPTION	DATE

DATE: 3-9-12  
SCALE: AS NOTED  
DESIGN BY: ASW  
DRAWN BY: RSO  
FILE # 12063-1101.dwg  
PROJECT NUMBER:  
**12063**  
SHEET NO:  
**A101**



B3 PHOTO - EXTERIOR OF ENTRANCE

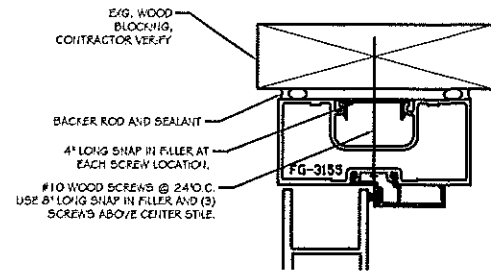

4 HEAD ATTACHMENT

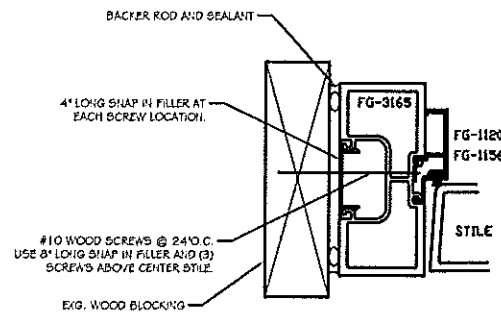

5 JAMB ATTACHMENT

- NOTES:
1. CONTRACTOR TO PROVIDE SHOP DRAWINGS WITH MANUFACTURER APPROVED INSTALLATION DETAILS PRIOR TO CONSTRUCTION.
  2. DOOR FINISH TO BE DARK ANODIZED BRONZE (MATCH EXST'G).
  3. DOOR HARDWARE TO INCLUDE: 1 1/2 PAIR OF BUTT HINGES, HORTON 1004 SURFACE MOUNTED CLOSER, MD RAIL, CVR PANG HARDWARE, OFFSET PULLS, STIFFS AND 1/2\"/>
  - 4. DOOR, DOOR FRAME, GLASS, AND FASTENERS TO BE DESIGNED AND INSTALLED TO SATISFY THE WIND LOADING REQUIREMENTS OF IBC 2009 AND ASCE 7-05:
    1. V=95 MPH, P<sub>s</sub>=25 PSF (ZONE 4).
  - 5. ALUMINUM ELEMENTS AND FASTENERS TO BE DESIGNED PER AAMA ALUMINUM DESIGN MANUAL 2010 ED.
  - 6. MAX MULTION DEFLECTION IS SPAN/75.
  - 7. MAX GLASS DEFLECTION IS SPAN/50.

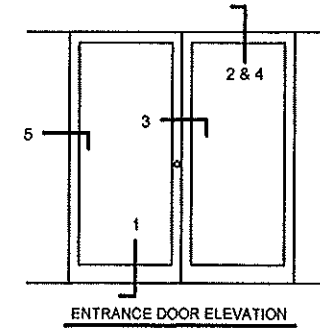

ENTRANCE DOOR ELEVATION

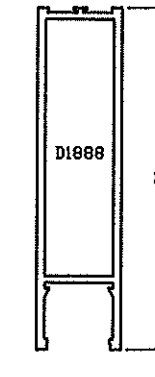

1 TYPICAL BOTTOM RAIL

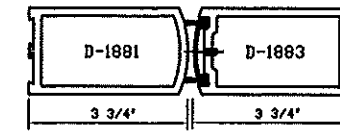

3 MEDIUM STILE

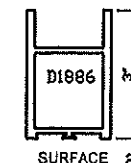

2 SURFACE CLOSER TOP RAILS

B2 DOOR DETAILS

SCALE: NTS



A3 PHOTO - INTERIOR LOOKING TOWARD ENTRYWAY



A2 PHOTO - INTERIOR OF VESTIBULE

- NOTES:
1. ALL DIMENSIONS ARE APPROXIMATE, CONTRACTOR TO FIELD VERIFY.
  2. THE WORK COMPLIES WITH THE 2009 INTERNATIONAL EXISTING BUILDING CODE, CHAPTER 5 REPAIRS BASED ON INTERPRETATION OF THE FOLLOWING:
    1. SECTION 501.2 - "THE WORK SHALL NOT MAKE THE BUILDING LESS CONFORMING THAN IT WAS BEFORE THE REPAIR WAS UNDERTAKEN"
    2. SECTION 504.1 "REPAIRS SHALL BE DONE IN A MANNER THAT MAINTAINS THE LEVEL OF PROTECTION PROVIDED FOR THE MEANS OF EGRESS"
    3. SECTION 505.1 "REPAIRS SHALL BE DONE IN A MANNER THAT MAINTAINS THE LEVEL OF ACCESSIBILITY PROVIDED"
  3. IT IS THE DESIGN PROFESSIONAL'S OPINION THAT THE REMOVAL AND REPLACEMENT OF THE DAMAGED DOOR COMPLIES WITH THE PROVISIONS OF CHAPTER 5 OF THE 2009 IBC.

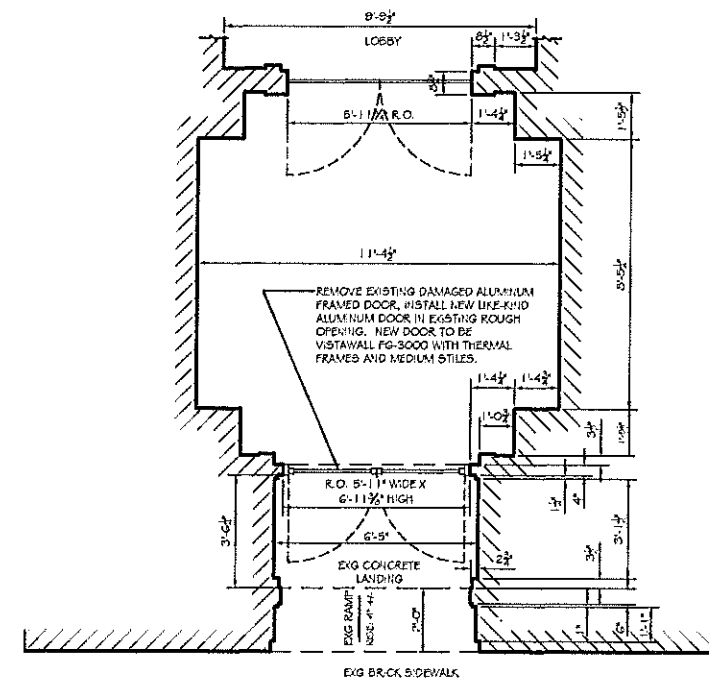

A1 EXG. ENTRY PLAN  
SCALE: 3/8" = 1'-0"



**ASSOCIATED DESIGN PARTNERS INC.**  
 Office: (207) 878-1751  
 Fax: (207) 878-1788  
 E-Mail: adp@adpengineering.com  
 80 Lightfoot Road  
 Falmouth, Maine 04105

THIS DRAWING, DESIGN AND ALL INFORMATION HEREON IS THE PROPERTY OF ASSOCIATED DESIGN PARTNERS, INC. NO REPRODUCTION, COPIES OR ANY OTHER USE OF THIS DOCUMENT WITHOUT WRITTEN CONSENT IS PROHIBITED.

PROJECT: **PEOPLE'S UNITED BANK**  
**465 CONGRESS ST., PORTLAND**  
 FOR: JACK COGGIN  
 SHEET TITLE: **ENTRANCE DOOR REPLACEMENT AND DETAILS**  
 ISSUED FOR PERMITTING

NO.	BY	REVISIONS	DATE

DATE: 3-9-12  
 SCALE: AS NOTED  
 DESIGN BY: ASW  
 DRAWN BY: RSO  
 FILE #12063-A101.dwg  
 PROJECT NUMBER:  
**12063**  
 SHEET NO:  
**A101**