

KEYPLAN

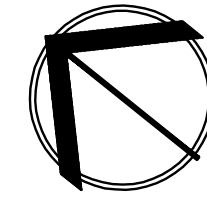

- NOTES:
1. CIRCUIT DESIGNATIONS LOCATED IN PLAN AREA C REFER TO PANEL P3.
 2. VOICE/DATA WIRING FROM OUTLETS SHALL BE EXTENDED TO NETWORK SWITCHES LOCATED IN THE CEILING SPACE BETWEEN THE FIRST FLOOR AND THE MEZZANINE. NETWORK SWITCHES TO BE PROVIDED BY OWNER'S CONSULTANT. COORDINATE AS REQUIRED.
 3. WORKSTATIONS LOCATED IN PLAN AREA C SHALL BE CIRCUITED TO PANEL P3.
 4. SEE SHEET E1.1 FOR FURNITURE PARTITION WIRING KEY.
 5. SEE SHEET E1.4 FOR SKYLIGHT AWNING WINDOW ELECTRIC OPERATOR WIRING DIAGRAM.
 6. PROVIDE A 30A/2P UNFUSED DISCONNECT SWITCH AT ALL AH UNITS AND AT ALL BCC UNITS.
 7. PROVIDE A 120V, 20AMP CIRCUIT CONSISTING OF #12 AWG CONDUCTORS IN 3/4" CDT TO SERVE EXISTING PERIMETER WINDOW SHADE CONTROLLERS. CONNECT THE CIRCUIT TO PANEL P3 #34. EXTEND THE CIRCUIT WIRING TO SERVE BOTH EXISTING WINDOW SHADE CONTROL UNITS AS WELL AS NEW WIRELESS WINDOW SHADE RECEIVERS TO BE PROVIDED UNDER THIS CONTRACT FOR EACH 6FT WIDE WINDOW PANEL LOCATED BETWEEN COLUMN LINES S4 AND S3 AND BETWEEN W11.6 AND W10.6 (4 TOTAL PANELS). EXISTING WINDOW SHADE CONTROLLERS AND NEW WINDOW SHADE WIRELESS RECEIVERS SHALL BE MOUNTED ABOVE THE TOP OF THE WINDOWS (VERIFY EXACT LOCATIONS WITH ARCHITECT PRIOR TO ROUGH-IN).
 8. DISCONNECT AND REMOVE CIRCUIT TO EXISTING RECEPTACLE LOCATED AT BENCH OUTSIDE VEST 143A. PROVIDE A BLANK PLATE AT RECEPTACLE BOX.

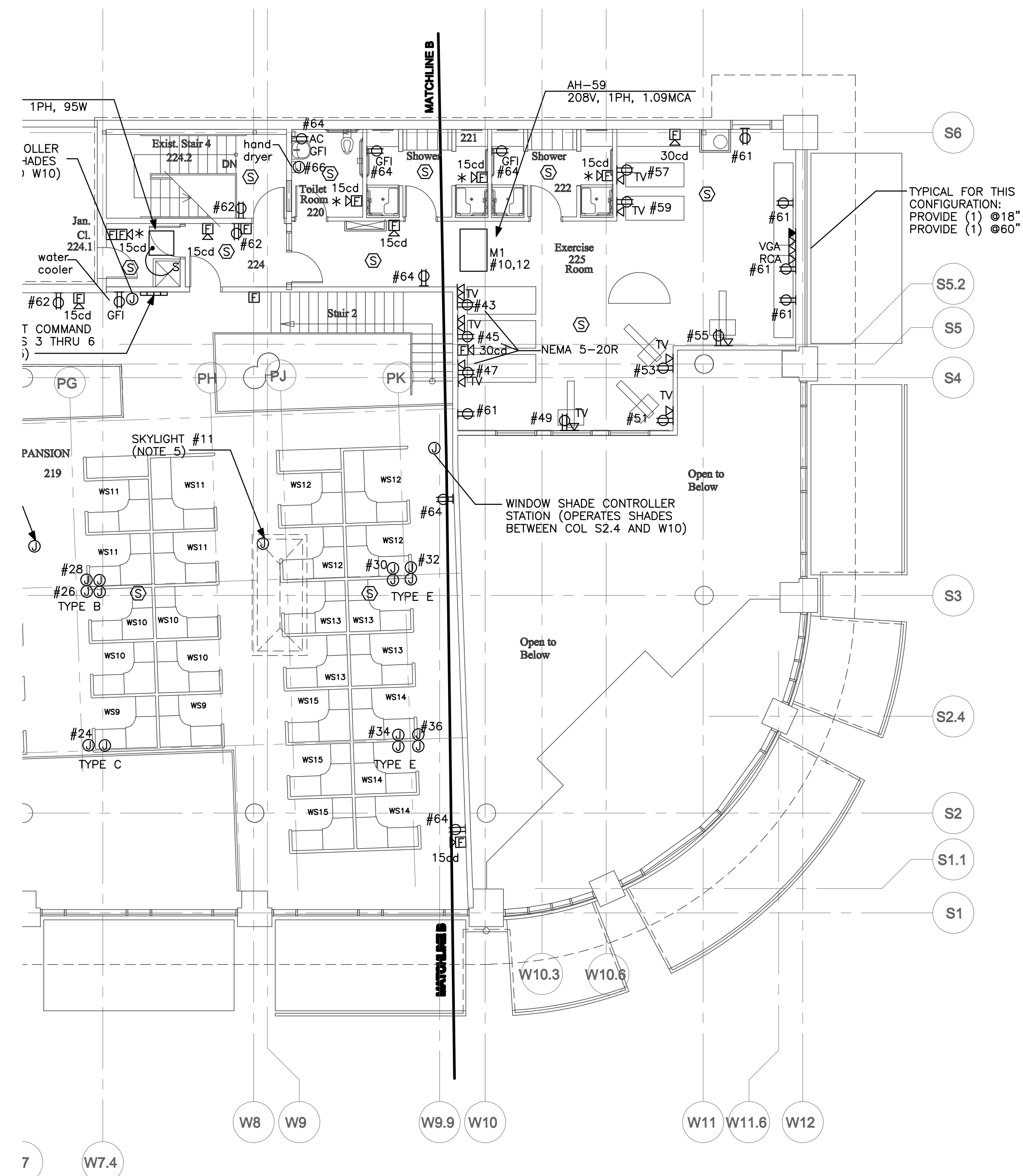

1
E1.6 SECOND FLOOR POWER PLAN - PART C
1/8" = 1'-0"

**POWERPAY
OFFICE FIT
UP**

**Winton Scott
Architects**
5 Milk Street
Portland, ME 04101

**Wright Ryan
Construction, Inc.**
10 Danforth Street
Portland, ME 04101

**Becker Structural
Engineers, Inc.**
75 York Street
Portland, Maine 04101

**Mechanical Systems
Engineers**
10 Royal River Center
Yarmouth, Maine 04096

Bartlett Design
942 Washington St.
Bath, Maine 04530

Fore Solutions
386 Fore Street
Portland, Maine 04101

**SECOND FLOOR
POWER
PLAN-PART C**

E1.6

Includes all revisions and changed up
to and including 10-28-09

Scale: 1/8" = 1'-0" Date: 03-20-09