

Lawrence E. Bartlett

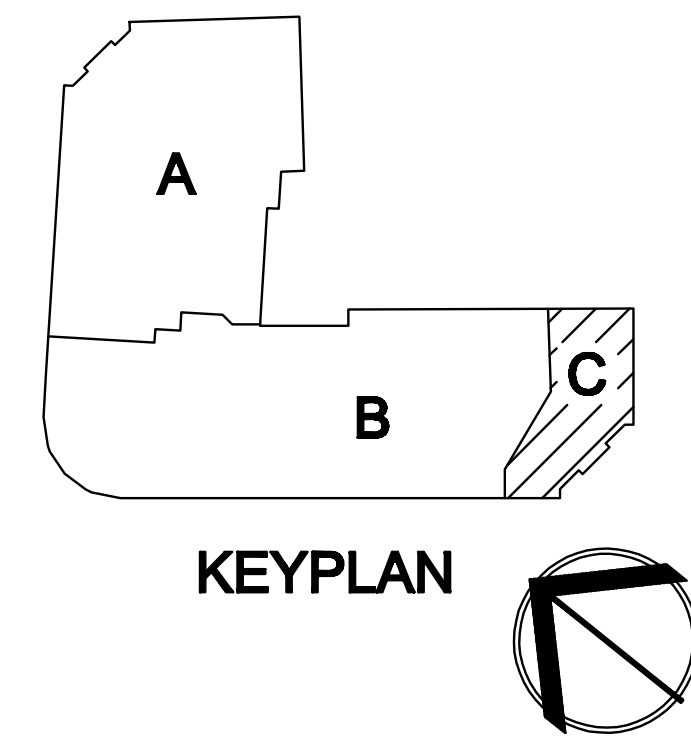

- NOTES:
1. INTERIOR LIGHTS WITH SHADED PATTERNS WILL BE CIRCUITED TO PANEL P-EL1. ALL OTHER INTERIOR LIGHTS IN AREA C SHALL BE CIRCUITED TO PANEL P2.
 2. LIGHT SWITCHES INDICATED BY So15, So17, So18, & So19 SHALL BE LOW VOLTAGE CONTROL SWITCHES WIRED TO TO THE LIGHTING CONTROL PANEL LOCATED IN ELEC/DATA CLOSET 135.

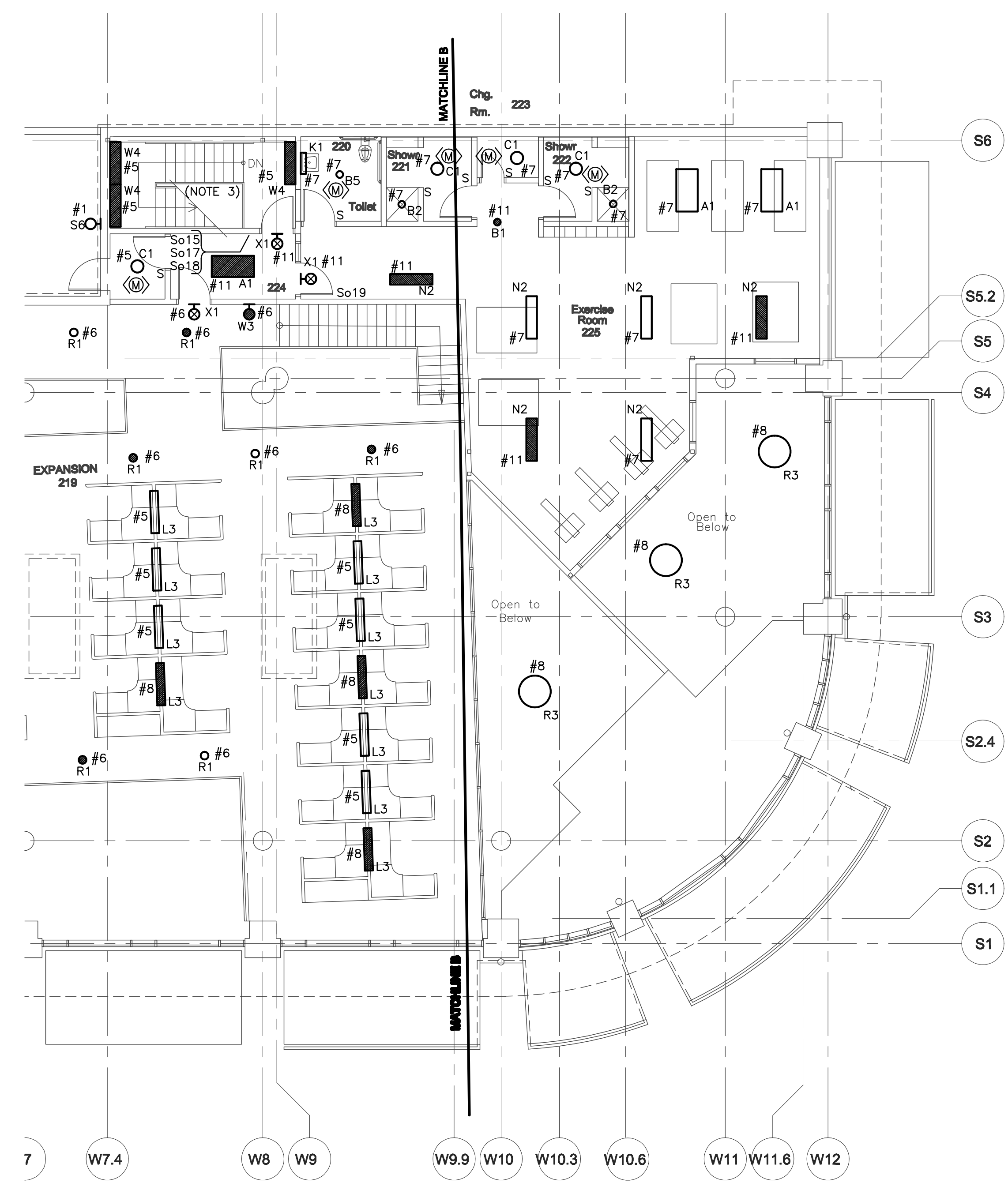

1 SECOND FLOOR LIGHTING PLAN - PART C
E2.6 1/8" = 1'-0"

**POWERPAY
OFFICE FIT
UP**

**Winton Scott
Architects**
5 Milk Street
Portland, ME 04101

**Wright Ryan
Construction, Inc.**
10 Danforth Street
Portland, ME 04101

**Becker Structural
Engineers, Inc.**
75 York Street
Portland, Maine 04101

**Mechanical Systems
Engineers**
10 Royal River Center
Yarmouth, Maine 04096

Bartlett Design
942 Washington St.
Bath, Maine 04530

Fore Solutions
386 Fore Street
Portland, Maine 04101

**SECOND FLOOR
LIGHTING
PLAN-PART C**

E2.6