

# POWERPAY OFFICE FIT UP

**Winton Scott  
Architects**  
5 Milk Street  
Portland, ME 04101

**Wright Ryan  
Construction, Inc.**  
10 Danforth Street  
Portland, ME 04101

**Becker Structural  
Engineers, Inc.**  
75 York Street  
Portland, Maine 04101

**Mechanical Systems  
Engineers**  
10 Royal River Center  
Yarmouth, Maine 04096

**Bartlett Design**  
942 Washington St.  
Bath, Maine 04530

**Fore Solutions**  
386 Fore Street  
Portland, Maine 04101

## SECOND FLOOR POWER PLAN-PART A

# E1.4

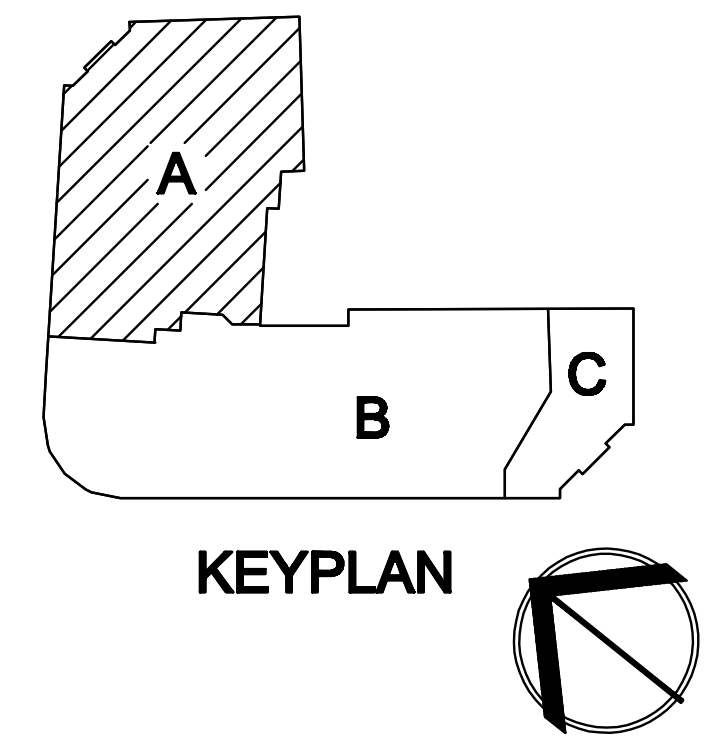

- NOTES:
1. CIRCUIT DESIGNATIONS LOCATED IN PLAN AREA A REFER TO PANEL P2.
  2. VOICE/DATA WIRING FROM OUTLETS SHALL BE EXTENDED TO NETWORK SWITCHES LOCATED IN THE CEILING SPACE BETWEEN THE FIRST FLOOR AND THE MEZZANINE. SEE SHEET E1.3 FOR KEY PLANS DESIGNATING BUILDING AREA GROUPS AND THEIR ASSOCIATED NETWORK SWITCHES AS WELL AS CIRCUITING INFORMATION FOR NETWORK SWITCHES.
  3. WORKSTATIONS LOCATED IN PLAN AREA A SHALL BE CIRCUITED TO PANEL P2.
  4. SEE SHEET E1.1 FOR FURNITURE PARTITION WIRING KEY.
  5. SEE THIS SHEET FOR SKYLIGHT AWNING WINDOW ELECTRIC OPERATOR WIRING DIAGRAM.
  6. PROVIDE HANDICAP DOOR CONTROLS, DOOR ACCESS CARD READER, DOOR REQUEST-TO-EXIT DEVICE, DOOR POSITION SWITCH, AND DOOR INTERCOM STATION AT DOOR BETWEEN PARKING GARAGE AND CONNECTOR BRIDGE.

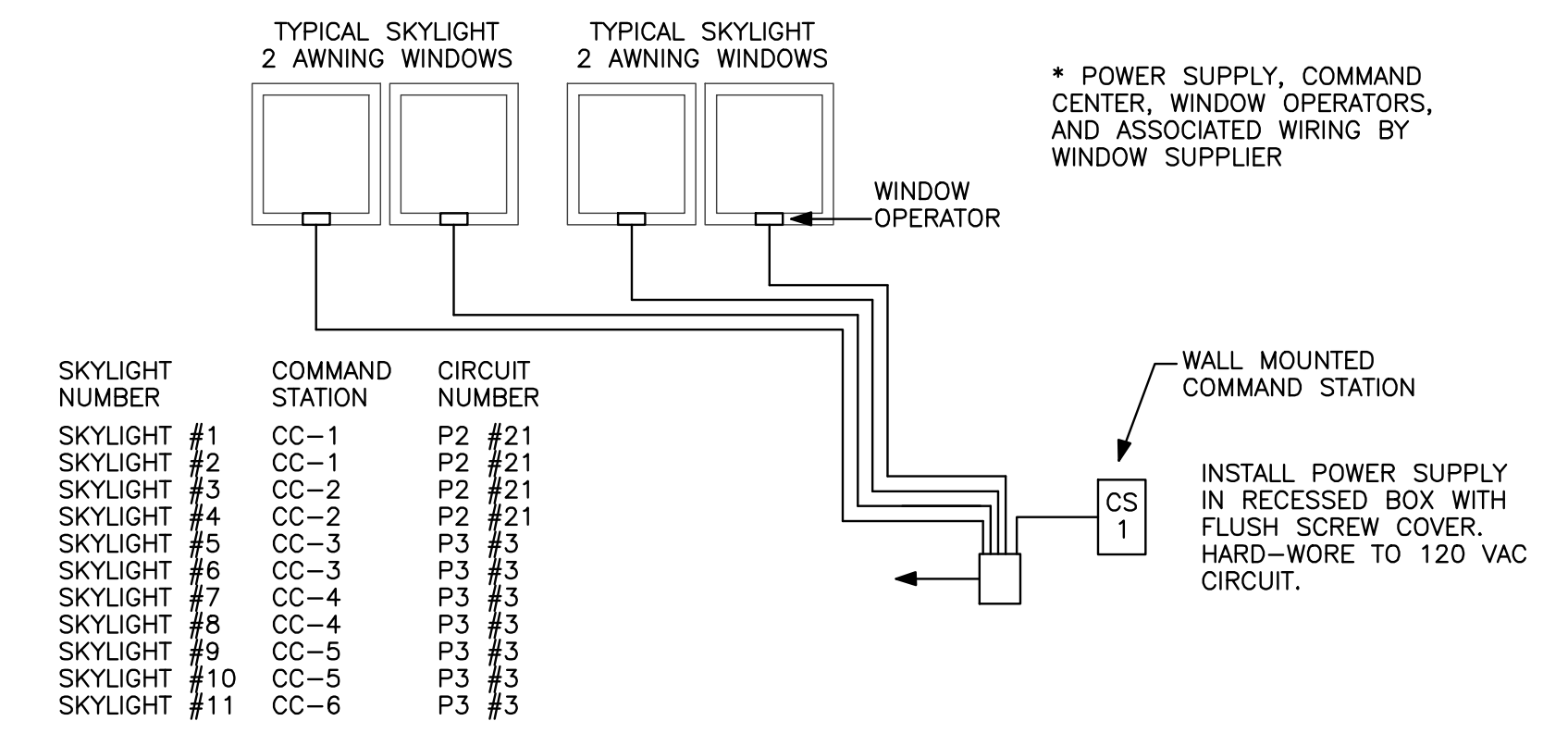

2  
E1.4 TYPICAL SKYLIGHT AWNING WINDOW CONTROL WIRING DIAGRAM  
NOT TO SCALE

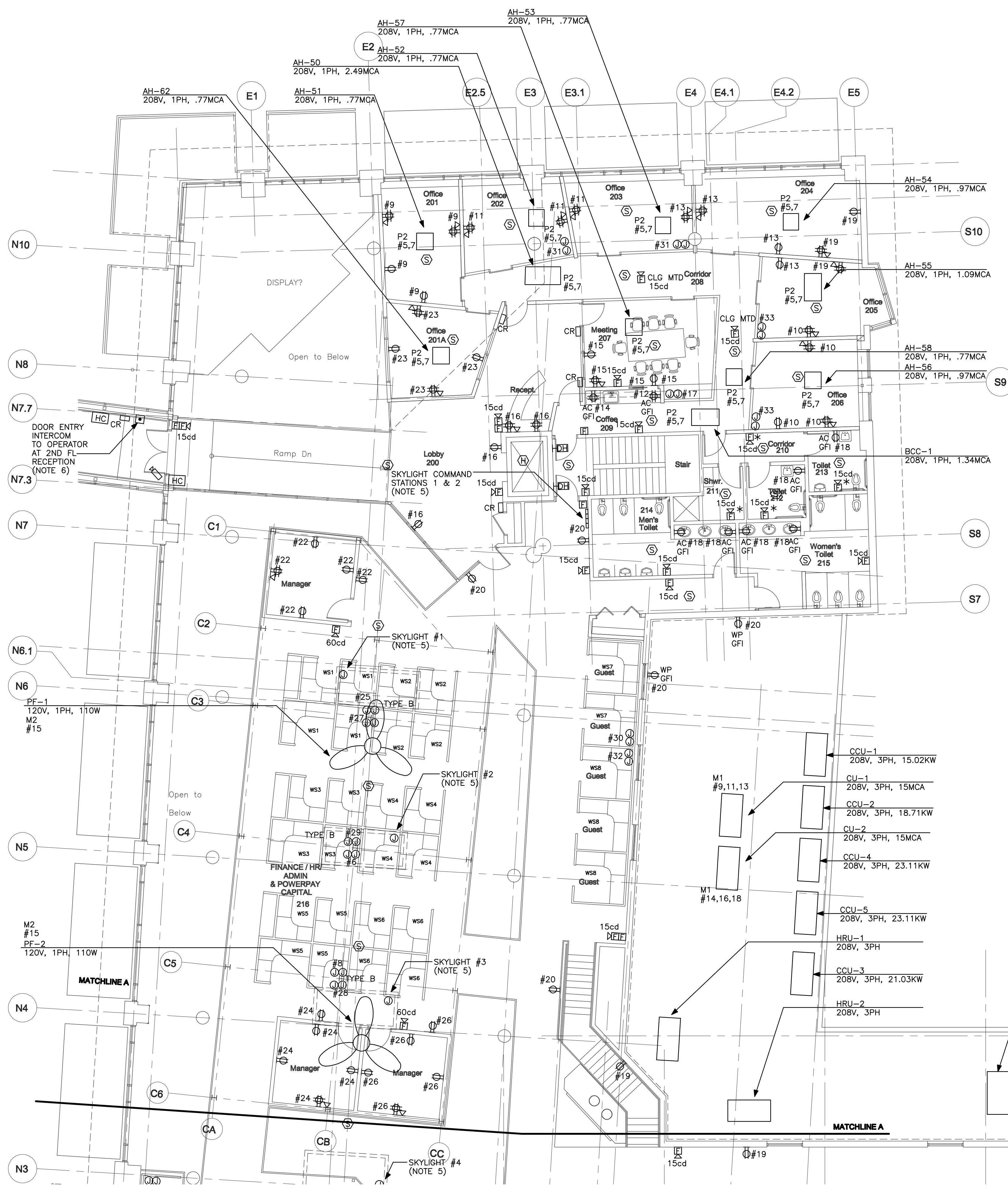

1  
E1.4 SECOND FLOOR POWER PLAN - PART A  
1/8" = 1'-0"