

**POWERPAY
OFFICE FIT
UP**

**Winton Scott
Architects
5 Milk Street
Portland, ME 04101**

**Wright Ryan
Construction, Inc.
10 Danforth Street
Portland, ME 04101**

**Becker Structural
Engineers, Inc.
75 York Street
Portland, Maine 04101**

**Mechanical Systems
Engineers
10 Royal River Center
Yarmouth, Maine 04096**

**Bartlett Design
942 Washington St.
Bath, Maine 04530**

**Fore Solutions
386 Fore Street
Portland, Maine 04101**

**FIRST FLOOR
POWER
PLAN-PART B**

E1.2

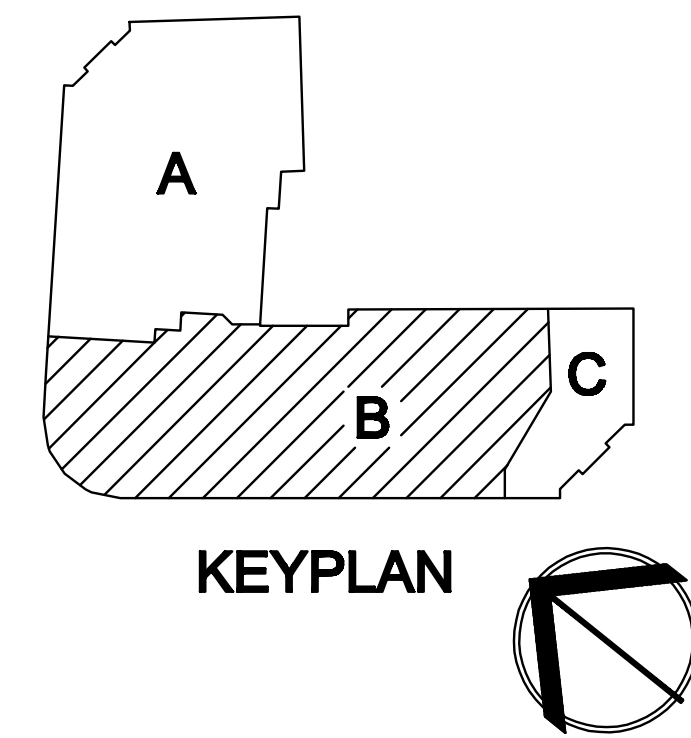

- NOTES:
1. CIRCUIT DESIGNATIONS LOCATED IN PLAN AREA B REFER TO PANEL P1.
 2. VOICE/DATA WIRING FROM OUTLETS SHALL BE EXTENDED TO NETWORK SWITCHES LOCATED IN THE CEILING SPACE BETWEEN THE FIRST FLOOR AND THE MEZZANINE. SEE SHEET E1.3 FOR KEY PLANS DESIGNATING SHOWING BUILDING AREA GROUPS AND THEIR ASSOCIATED NETWORK SWITCHES AS WELL AS CIRCUITING INFORMATION FOR NETWORK SWITCHES.
 3. WORKSTATIONS 1 THROUGH 10 IN AREA B SHALL BE CIRCUITED TO PANEL P1. WORKSTATIONS 11 THROUGH 20 IN AREA B SHALL BE CIRCUITED TO PANEL P3.
 4. SEE SHEET E1.1 FOR FURNITURE PARTITION WIRING KEY.

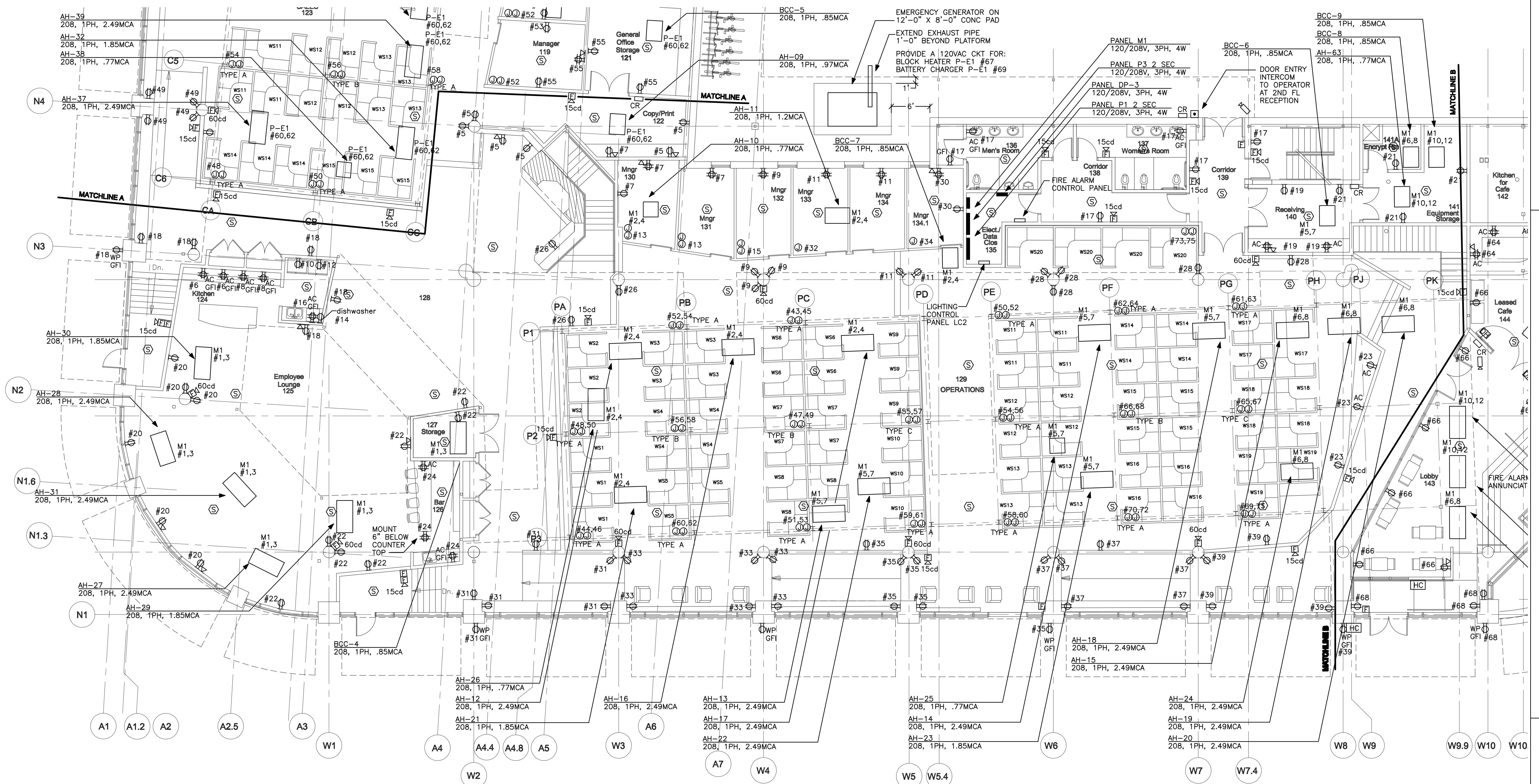

1
E1.2 FIRST FLOOR POWER PLAN - PART B
1/8" = 1'-0"