

POWERPAY OFFICE FIT UP

**Winton Scott
Architects**
5 Milk Street
Portland, ME 04101

**Wright Ryan
Construction, Inc.**
10 Danforth Street
Portland, ME 04101

**Becker Structural
Engineers, Inc.**
75 York Street
Portland, Maine 04101

**Mechanical
Systems
Engineers**
10 Royal River Center
Yarmouth, Maine 04096

Bartlett Design
942 Washington Ave.
Bath, Maine 04530

Fore Solutions
386 Fore Street
Portland, Maine 04101

FIRST FLOOR CEILING PLAN

A8.1

CEILING LEGEND

- Indicates ceiling finish
Indicates ceiling height elevation
(Mezzanine Floor is EL. 77'-0")
- Acoustical Ceiling Tile
- Supply Air Diffuser
- Return Air Grille
- E.J. Expansion Joint Assembly

LIGHTING LEGEND

See Lighting / Electrical drawings for specifications and details

- 2'x4' recessed light fixture
- 1'x4' recessed light fixture
- Recessed downlight
- Surface mounted fixture
- Under cabinet task light
- Pendant light fixture
- Pendant Light Fixture
- Wall sconce
- Wall mounted decorative light fixture

See Lighting / Electrical drawings for specifications, details & other lighting elements such as exit signs, emergency lighting, and motion detectors

CEILING TYPES

- C1 EXISTING CEILING TO REMAIN-REPAIR
- C2 EXISTING CLR. FINISH WOOD CEILING TO REMAIN
- C3 SUSPENDED 2X2 ACT
- C4 SUSPENDED MOISTURE RESISTANT 2 X 2 ACT
- C5 PTD. 5/8" GWB SOFFIT
- C6 PAINTED GWB 1-HOUR FIRE RATED ASSEMBLY ON SUSPENSION SYSTEM. INSTALL 1 LAYER OF 5/8" GWB TYPE X ON SUSPENSION SYSTEM
- C7 PTD. 5/8" MOISTURE RESISTANT GWB ON SUSPENSION SYSTEM
- C8 PTD. 5/8" GWB ON SUSPENSION SYSTEM
- C9 MOISTURE RESISTANT GWB SOFFIT. COORDINATE HEIGHT W/ SHOWER MANUFACTURER
- C10 EXPOSED STRUCTURE - ALL EXPOSED STEEL TO BE PAINTED.

NOTES

1. IN INSTANCES WHERE ELECTRICAL LIGHTING PLANS AND REFLECTED CEILING PLANS ARE NOT IN AGREEMENT IN TERMS OF NUMBER OF FIXTURES, THE PLAN SHOWING THE MOST FIXTURES PREVAILS.
2. IN INSTANCES WHERE ELECTRICAL LIGHTING PLANS AND CEILING PLANS ARE NOT IN AGREEMENT IN TERMS OF FIXTURE LOCATIONS, CONSULT ARCHITECT.

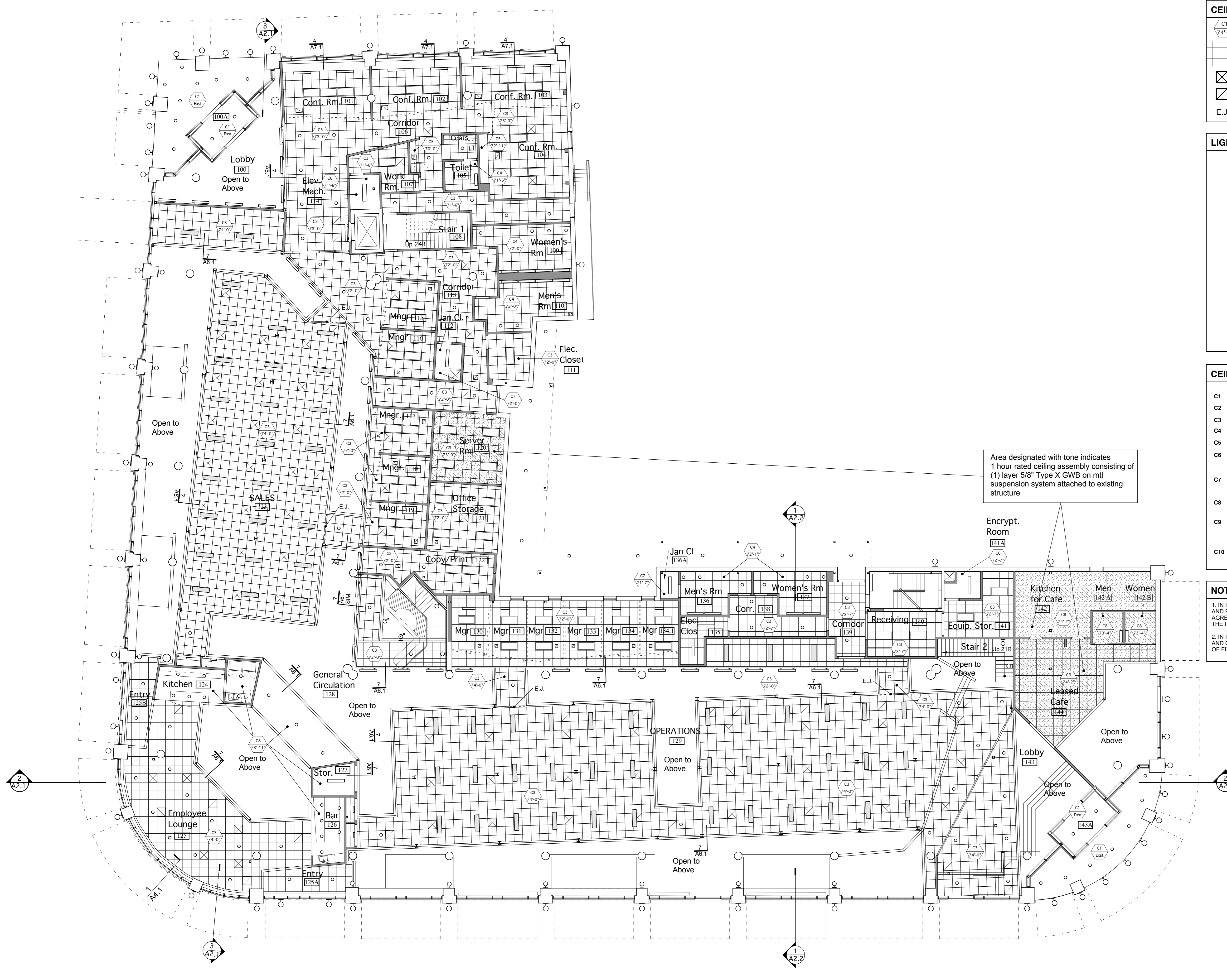

Area designated with tone indicates 1 hour rated ceiling assembly consisting of (1) layer 5/8" Type X GWB on mtl suspension system attached to existing structure

