

POWERPAY OFFICE FIT UP

Winton Scott
Architects
5 Milk Street
Portland, ME 04101

Wright Ryan
Construction, Inc.
10 Danforth Street
Portland, ME 04101

Becker Structural
Engineers, Inc.
75 York Street
Portland, Maine 04101

Mechanical
Systems
Engineers
10 Royal River Center
Yarmouth, Maine 04096

Bartlett Design
942 Washington Ave.
Bath, Maine 04530

Fore Solutions
386 Fore Street
Portland, Maine 04101

FLOOR FINISH PLANS

A7.2



1 FLOOR FINISH AT LOBBY 100
SCALE: 1 1/2" = 1'-0"

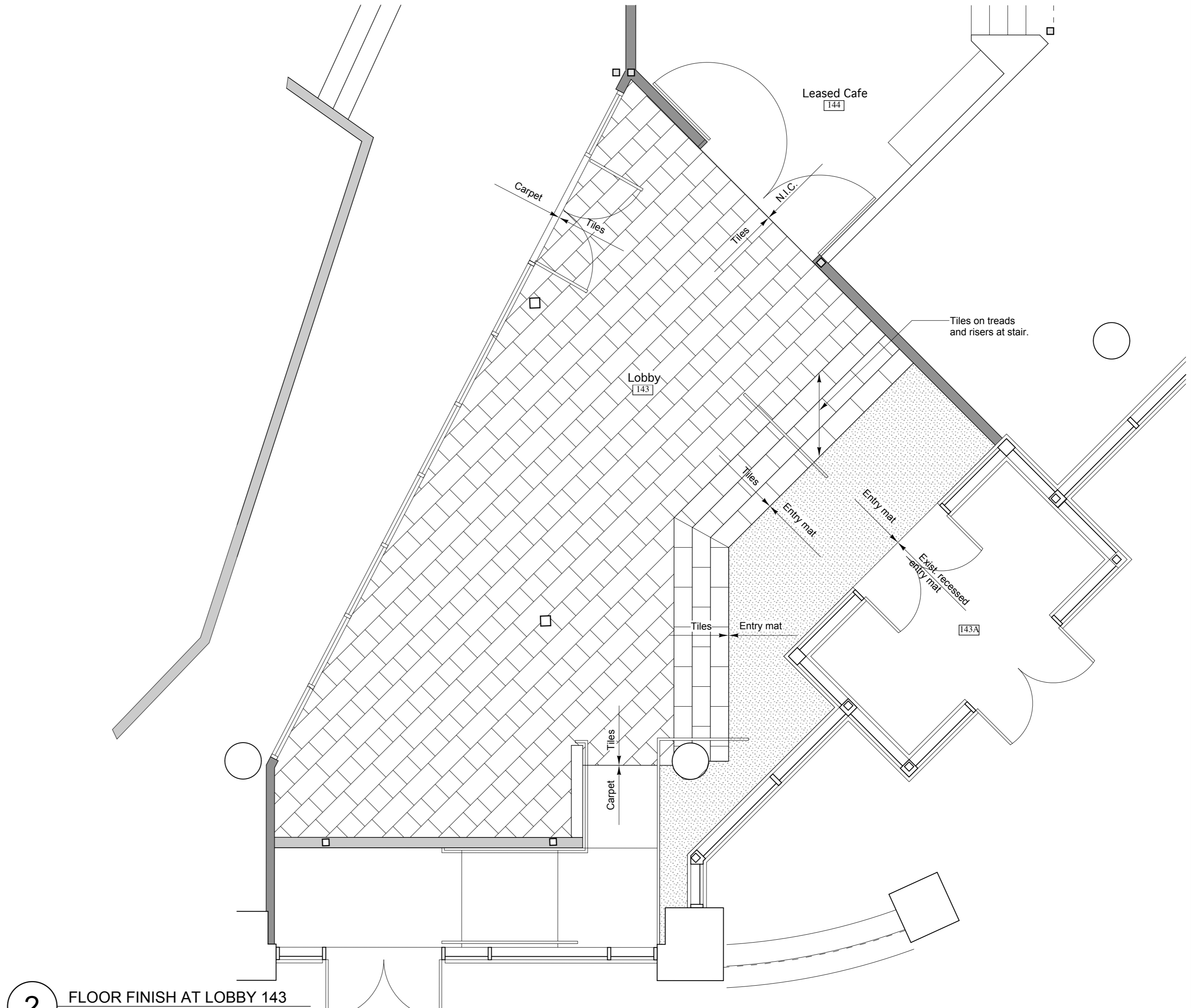

2 FLOOR FINISH AT LOBBY 143
SCALE: 1 1/2" = 1'-0"

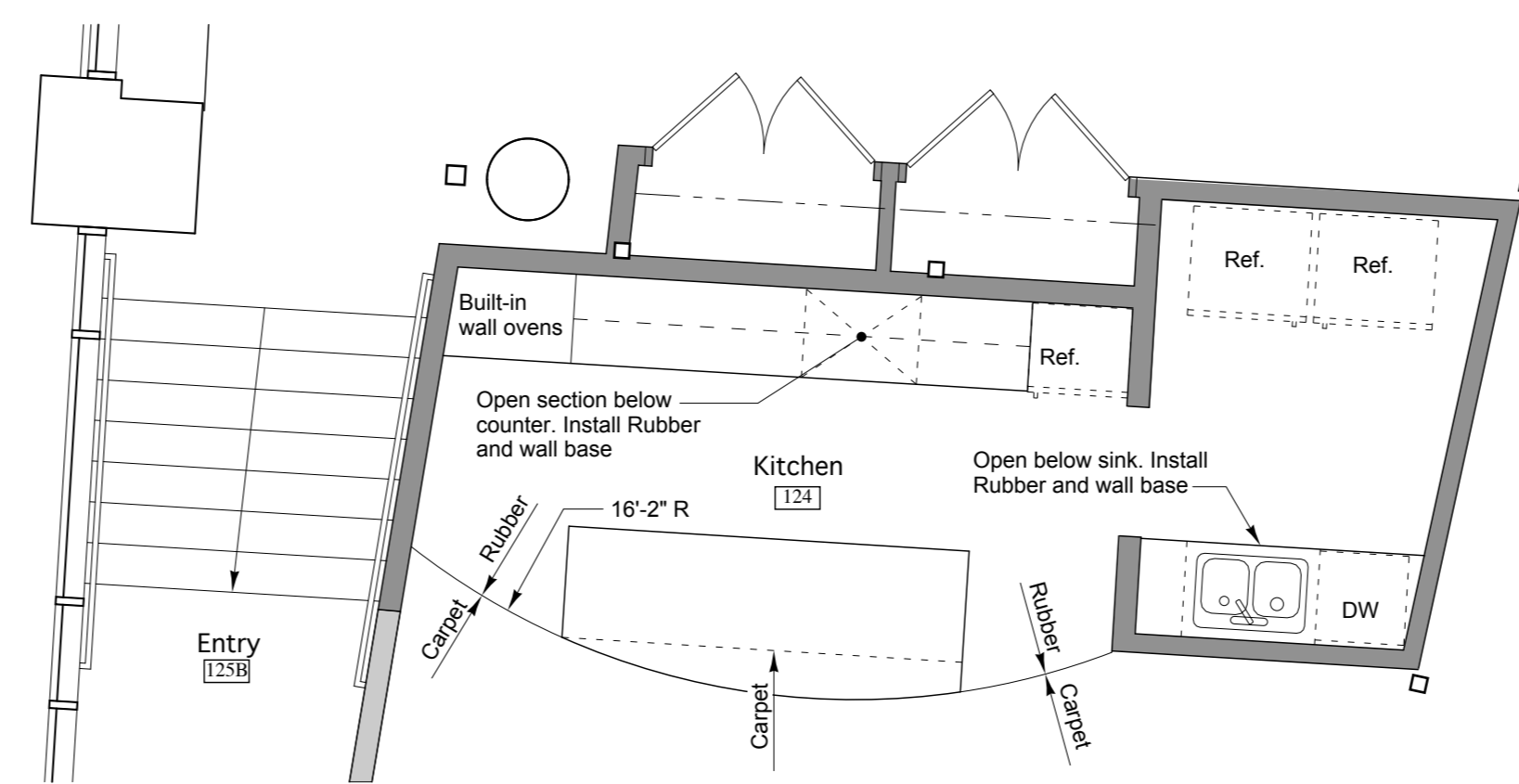

3 FLOOR FINISH AT KITCHEN 124
SCALE: 1 1/2" = 1'-0"

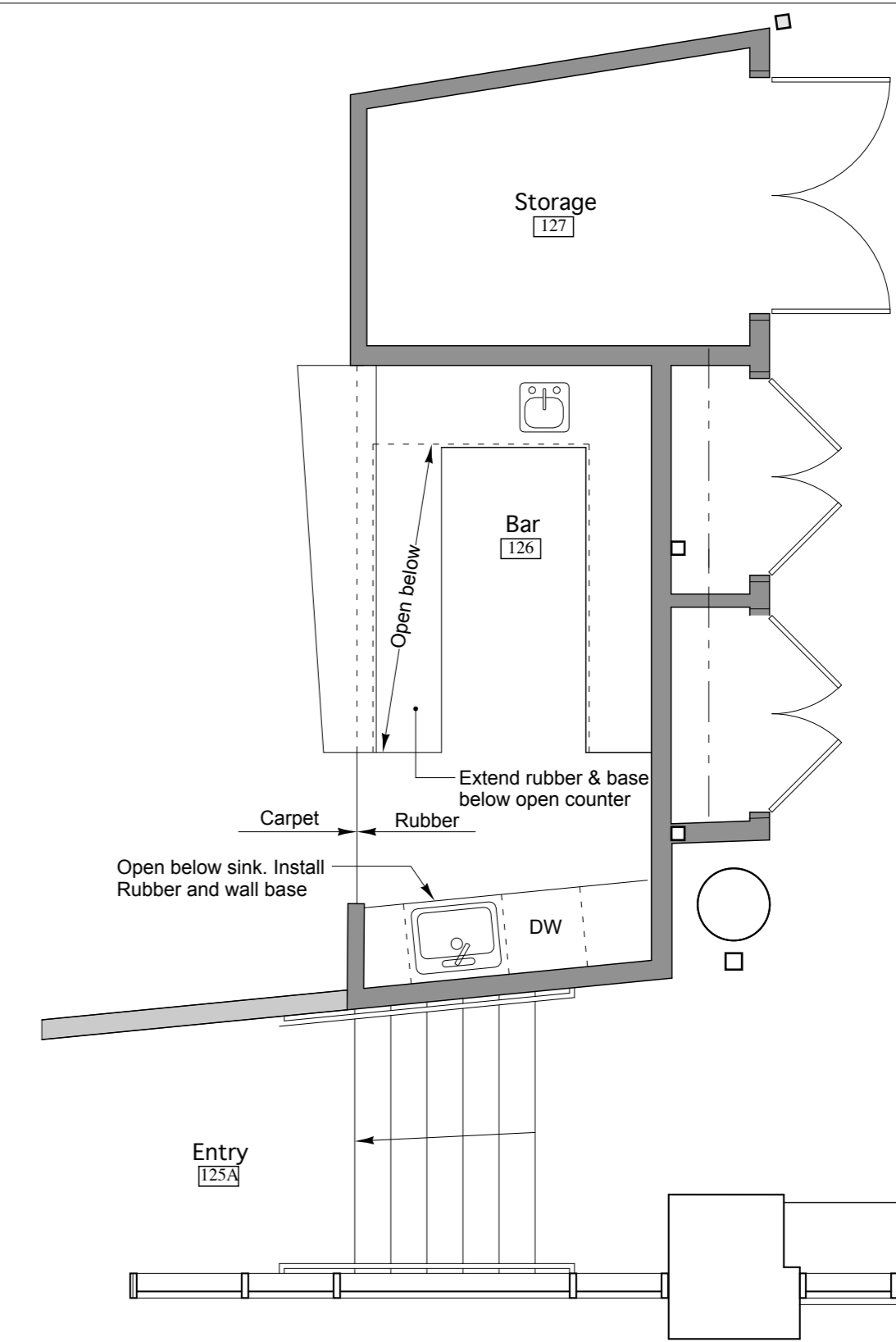

4 FLOOR FINISH AT BAR 126
SCALE: 1 1/2" = 1'-0"