

**4** STAIR 2 - Section Detail  
1 1/2" = 1'-0"

**5** STAIR 2 - Section Detail  
1 1/2" = 1'-0"

**6** STAIR 2 - Section Detail  
1 1/2" = 1'-0"

**7** Mezzanine Railing - Typ. Section Dtl.  
1 1/2" = 1'-0"

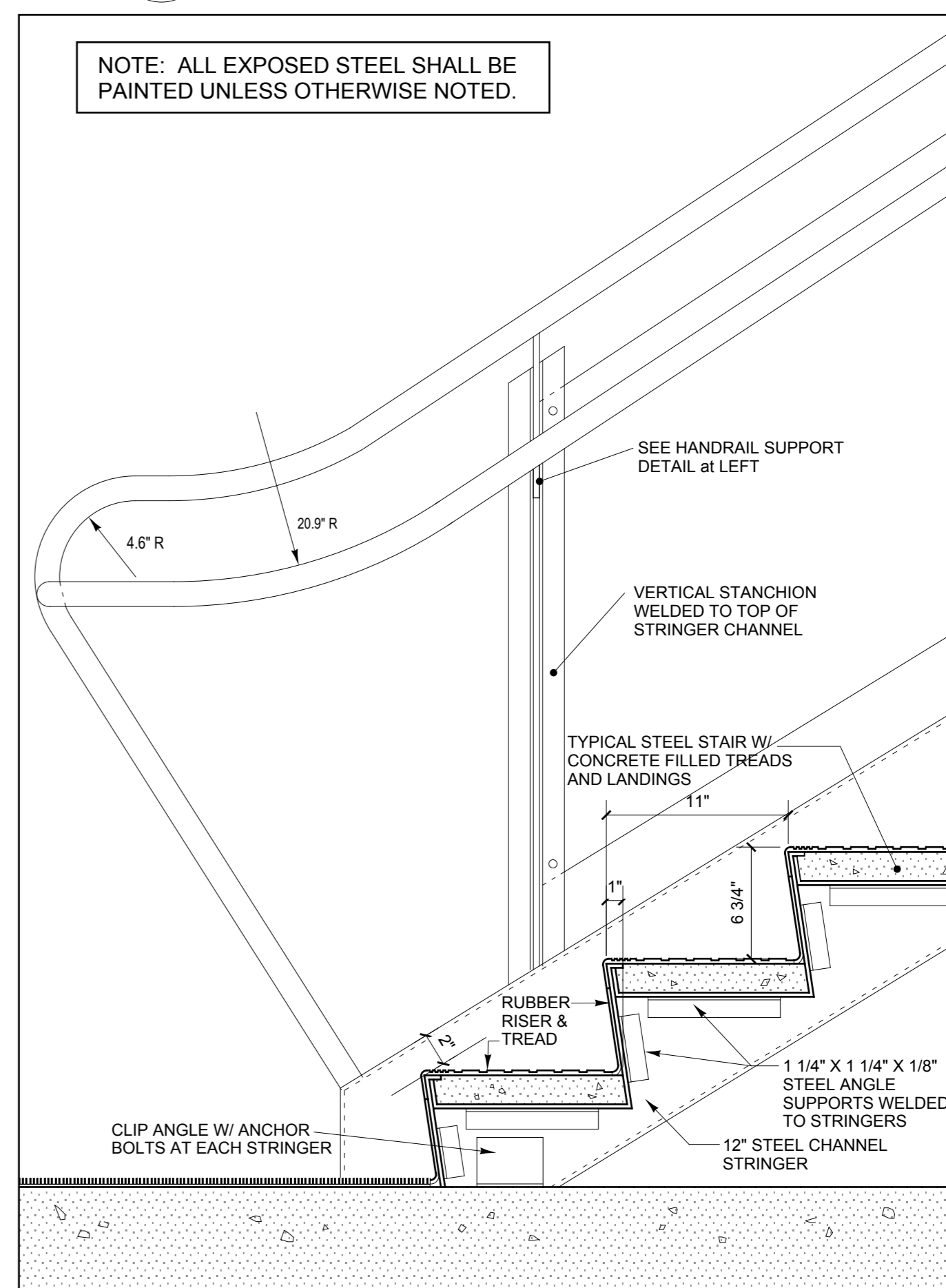
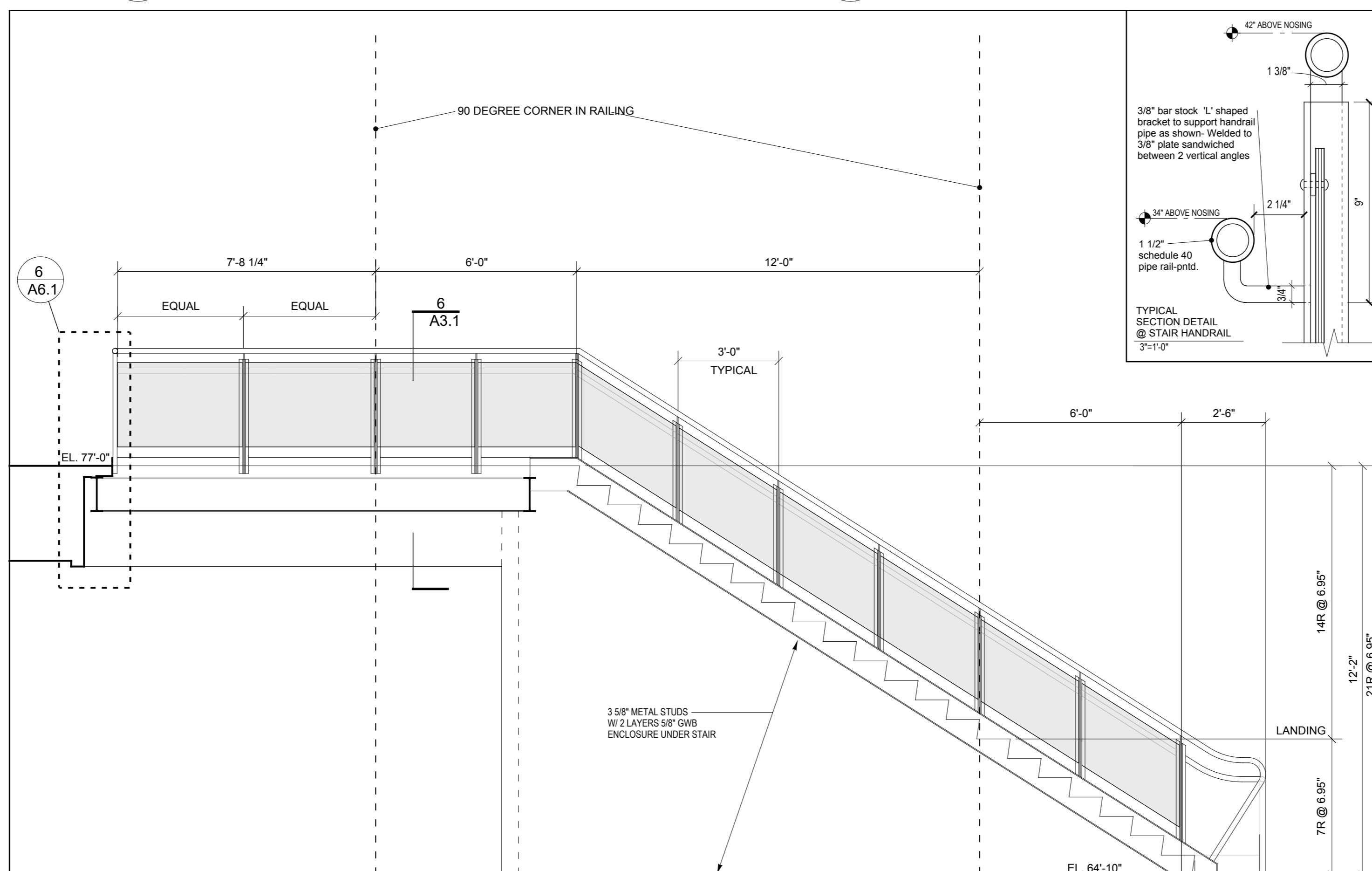
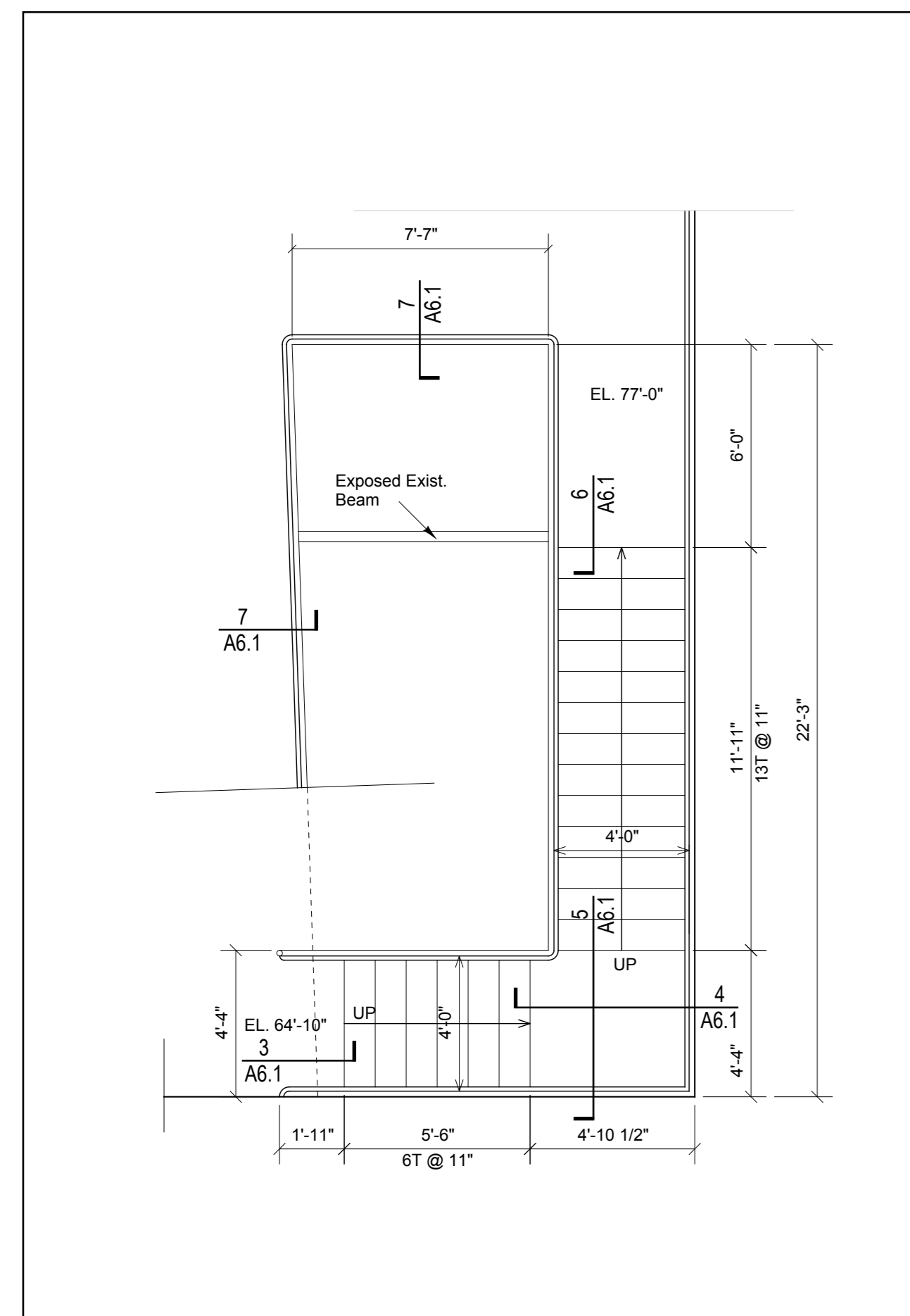

**1** STAIR 2 - PLAN  
1/4" = 1'-0"

**2** STAIR 2 - Section / Expanded Elevation  
3/8" = 1'-0"

**3** STAIR 2 - Section Detail  
1 1/2" = 1'-0"



**POWERPAY  
OFFICE FIT UP**

Winton Scott Architects  
5 Milk Street  
Portland, ME 04101

Wright Ryan Construction, Inc.  
10 Danforth Street  
Portland, ME 04101

Becker Structural Engineers, Inc.  
75 York Street  
Portland, Maine 04101

Mechanical Systems Engineers  
10 Royal River Center  
Yarmouth, Maine 04096

Bartlett Design  
942 Washington Ave.  
Bath, Maine 04530

Fore Solutions  
386 Fore Street  
Portland, Maine 04101

**STAIR 2 DETAILS**

**A6.1**