

POWERPAY OFFICES
8/31/09
BECKER STRUCT
REFER TO S1-1

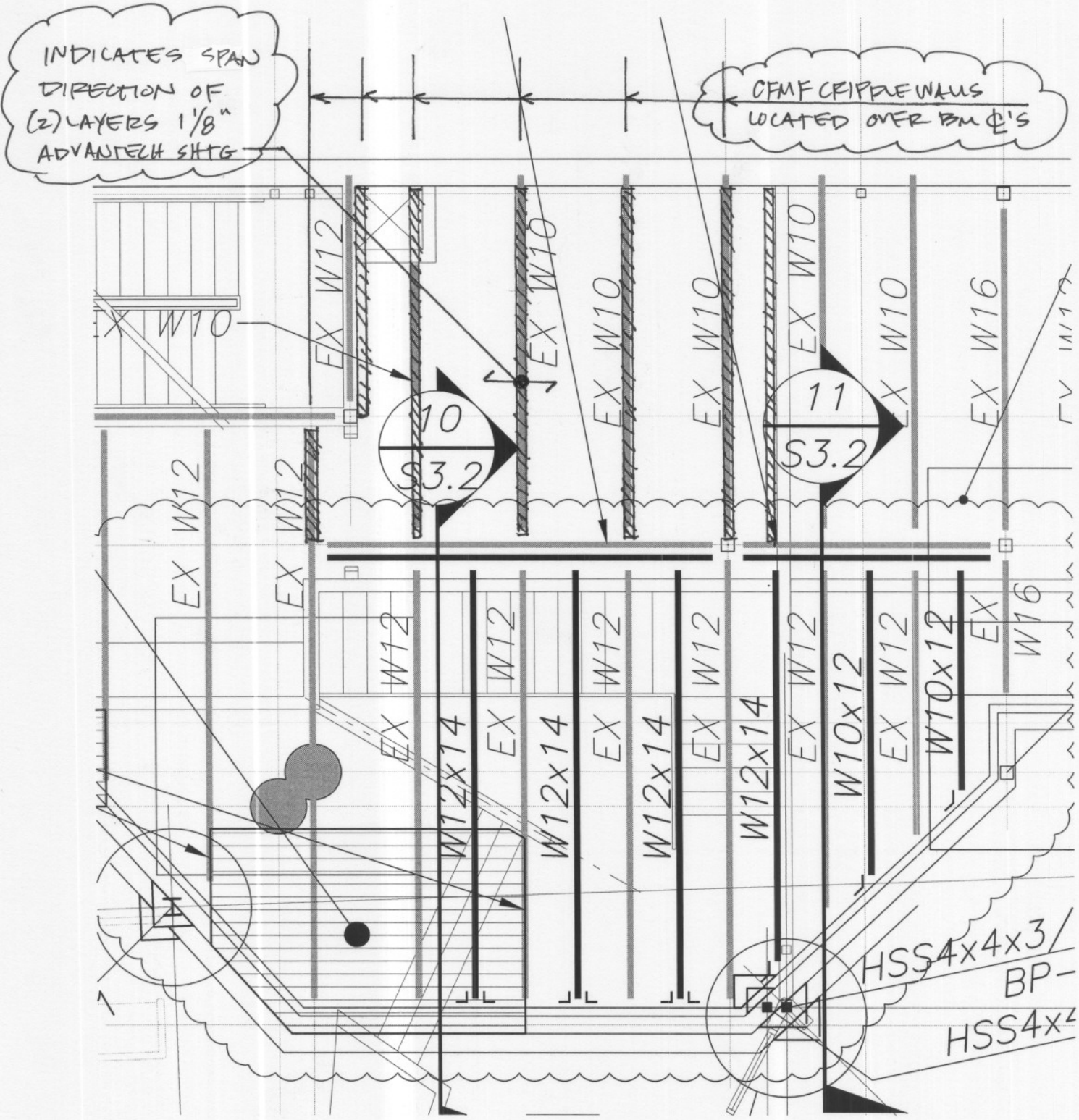

SEE SKS-21 P.2 FOR ADDL INFO

SKS-21 P.1
OVERFRAMING FOR REVISED
KITCHEN LAYOUT

BECKER

structural engineers, inc.

75 York Street, Portland, ME 04101-4550
Tel. 207-879-1838 ■ Fax 207-879-1822

Project POWER PAV OFFICES
W.O. 2036 Sheet 2 of 2
Calculated By: _____ Date 8/21/09
Checked By: _____ Date _____

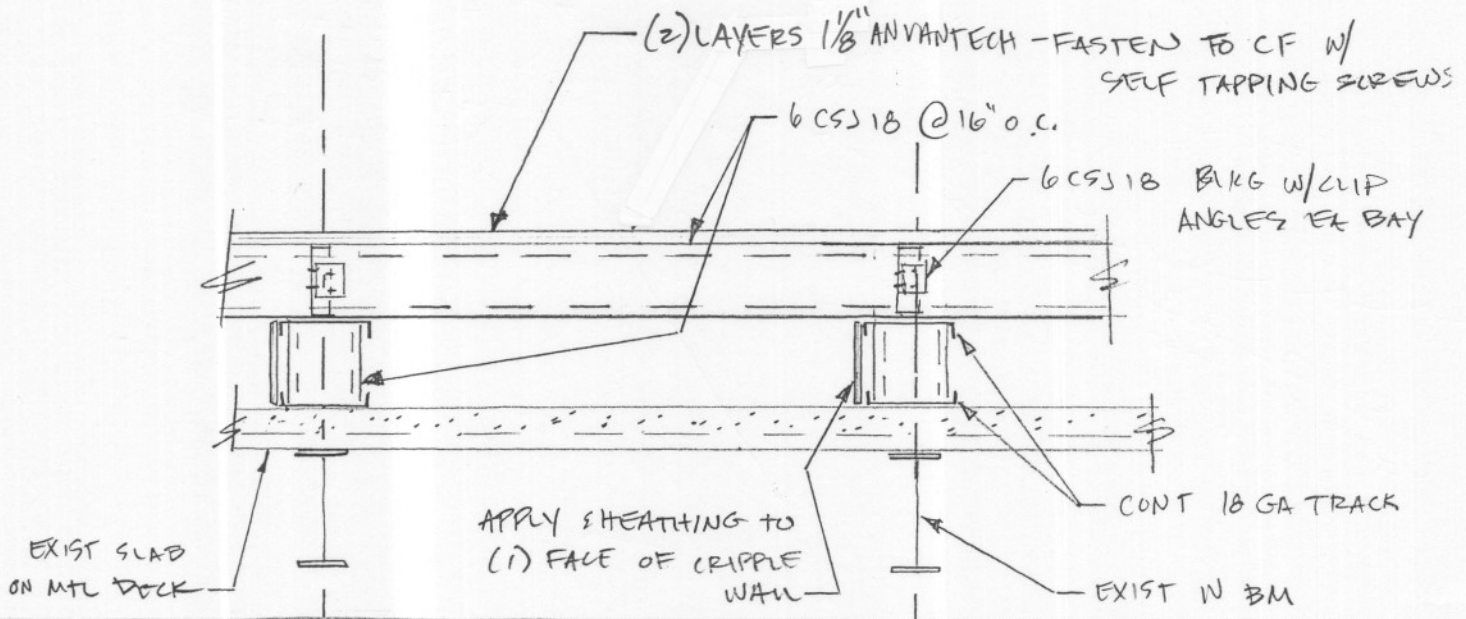

SKS-21 p.2