

**POWERPAY  
OFFICE FIT  
UP**

**Winton Scott  
Architects  
5 Milk Street  
Portland, ME 04101**

**Wright Ryan  
Construction, Inc.  
10 Danforth Street  
Portland, ME 04101**

**Becker Structural  
Engineers, Inc.  
75 York Street  
Portland, Maine 04101**

**Mechanical Systems  
Engineers  
10 Royal River Center  
Yarmouth, Maine 04096**

**Bartlett Design  
942 Washington St.  
Bath, Maine 04530**

**Fore Solutions  
386 Fore Street  
Portland, Maine 04101**

**SECOND FLOOR  
POWER  
PLAN-PART B**

**E1.5**

Include all revisions and changed up  
to and including 10-28-09

Scale: 1/8" = 1'-0" Date: 03-20-09

- NOTES:
1. CIRCUIT DESIGNATIONS LOCATED IN PLAN AREA B REFER TO PANEL P3.
  2. VOICE/DATA WIRING FROM OUTLETS SHALL BE EXTENDED TO NETWORK SWITCHES LOCATED IN THE CEILING SPACE BETWEEN THE FIRST FLOOR AND THE MEZZANINE. NETWORK SWITCHES TO BE PROVIDED BY OWNER'S CONSULTANT. COORDINATE AS REQUIRED.
  3. WORKSTATIONS LOCATED IN PLAN AREA B SHALL BE CIRCUITED TO PANEL P3.
  4. SEE SHEET E1.1 FOR FURNITURE PARTITION WIRING KEY.
  5. SEE SHEET E1.4 FOR SKYLIGHT AWNING WINDOW ELECTRIC OPERATOR WIRING DIAGRAM.
  6. PROVIDE 3 #12 AWG IN 3/4" CDT FROM EACH CEILING PADDLE FAN (PF) TO A WALL CONTROL STATION FURNISHED UNDER DIVISION 23. VERIFY EXACT LOCATION OF WALL STATIONS WITH MECHANICAL CONTRACTOR.
  7. PROVIDE (5) FOUR 120V, 20AMP CIRCUITS CONSISTING OF #12 AWG CONDUCTORS IN 3/4" CDT TO SERVE EXISTING PERIMETER WINDOW SHADE CONTROLLERS. CONNECT THE CIRCUIT TO PANEL P3 #63, 65, 67, 69, 70. EXTEND THE CIRCUIT WIRING TO SERVE BOTH EXISTING WINDOW SHADE CONTROL UNITS AS WELL AS NEW WIRELESS WINDOW SHADE RECEIVERS TO BE PROVIDED UNDER THIS CONTRACT FOR EACH 6FT WIDE WINDOW PANEL AS FOLLOWS  
 P3 #63 SHADES BETWEEN COL W10 AND W7 (4 PANELS)  
 P3 #65 SHADES BETWEEN COL W7 AND W5 (4 PANELS)  
 P3 #67 SHADES BETWEEN COL W5 AND W3 (4 PANELS)  
 P3 #69 SHADES BETWEEN COL W3 AND W1 (4 PANELS)  
 P3 #71 SHADES BETWEEN COL A2.5 AND A1.2 (2 PANELS)  
 P3 #71 SHADES BETWEEN COL N2 AND N3 (2 PANELS)  
 EXISTING WINDOW SHADE CONTROLLERS AND NEW WINDOW SHADE WIRELESS RECEIVERS SHALL BE MOUNTED ABOVE THE TOP OF THE WINDOWS (VERIFY EXACT LOCATIONS WITH ARCHITECT PRIOR TO ROUGH-IN).

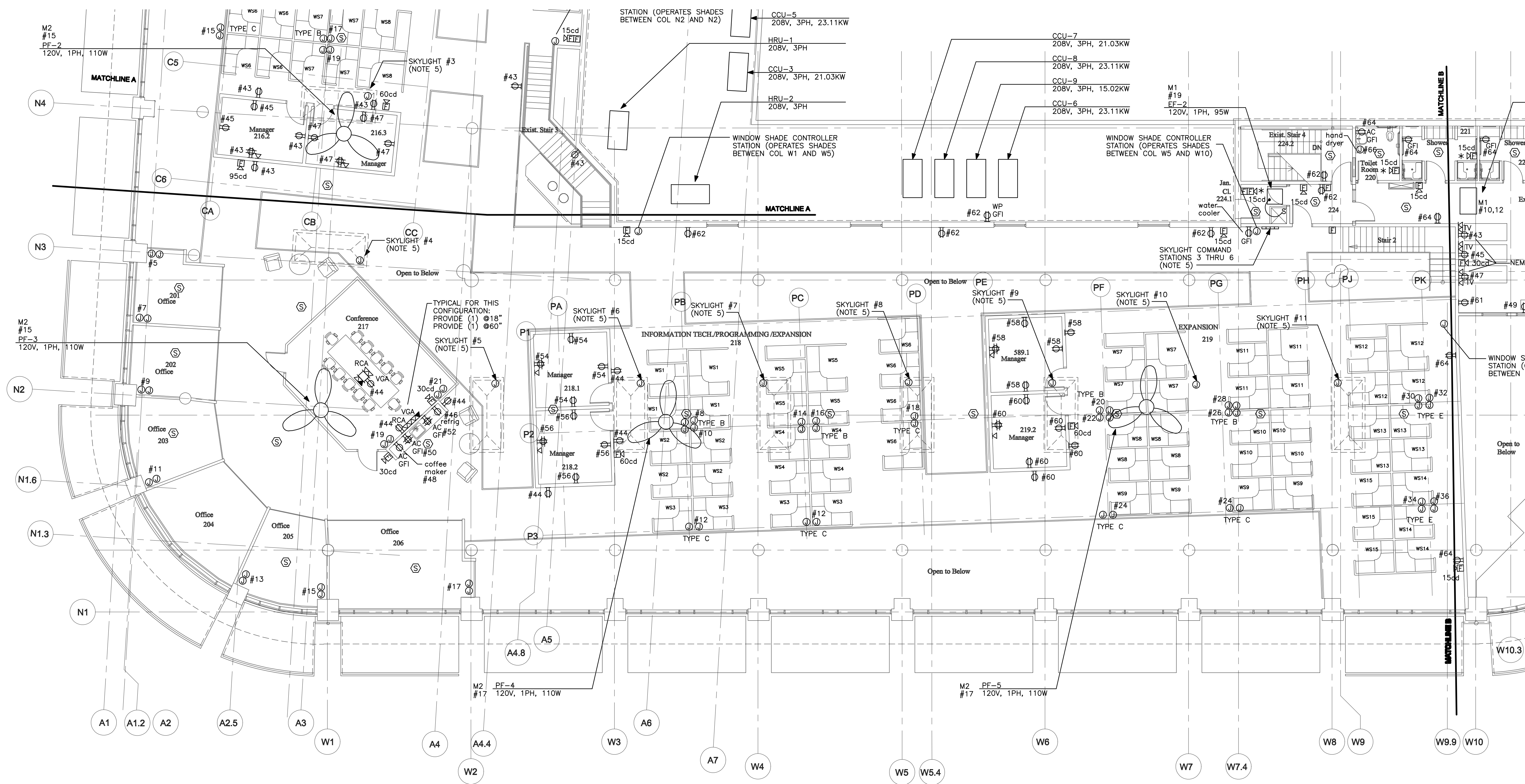
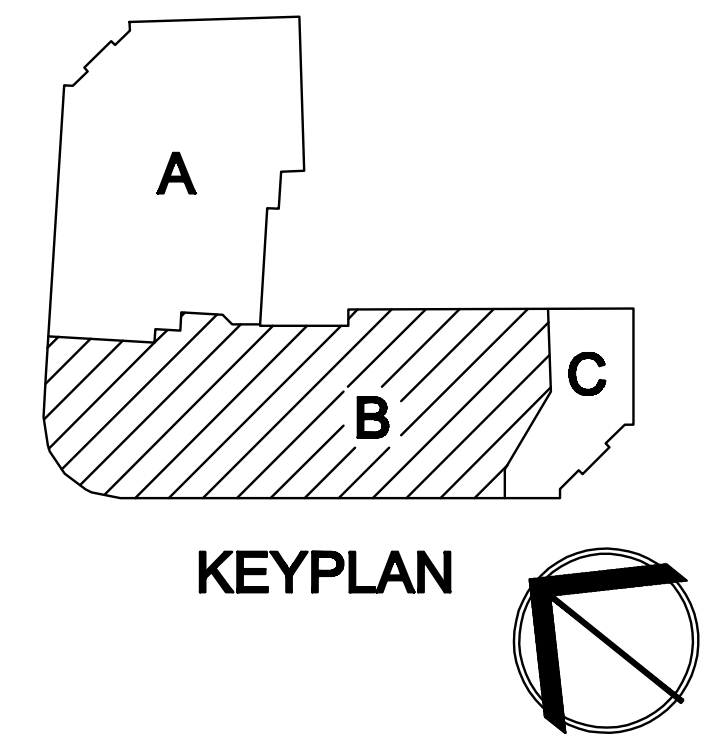

**1**  
**E1.5** SECOND FLOOR POWER PLAN - PART B  
1/8" = 1'-0"