

[MAVERICK'S RESTAURANT]
 P.O. 801256
 PENN NAMEPLATE
 N.S.F. & U.L.

SYSO FOOD SERVICES OF NORTHERN NEW ENGLAND
 (1) 5'-9" X 11'-6" X 7'-6" HIGH WITH FLOORS.
 4" URETHANE COOLER / FREEZER COMBINATION.

SHIP 81" LONG	
WALLS:	46"5
CORNERS:	11 1/2"4
V. TEES:	29"2

UNIT TO BE ERECTED OUTDOORS
 W/A DURO-LAST MEMBRANE ROOF.

NOTES TO INSTALLERS:
 DO NOT DRILL THRU WEATHER CAP.

INSTALL PRE-ASSEM. WOOD CURBS TO
 TOP OF WALK-IN BEFORE DROPPING
 PRO 3 UNITS INTO CEILING PANELS.
 SEAL THOROUGHLY.

FINISH

EMB. ALUM. INT.
 EMB. ALUM. EXT.

FLOOR

.080 ALUM. TREAD PLATE FLOOR

DOORS

(1) 30" X 74" L.H. COOLER DOOR,
 SELF-CLOSING HARDWARE W/K - 77 LATCH
 NO HEATER.

(1) 30" X 74" R.H. FREEZER DOOR,
 SELF-CLOSING HARDWARE W/K - 77 LATCH
 WITH HEATER &
 HEATED PRESSURE RELIEF PORT

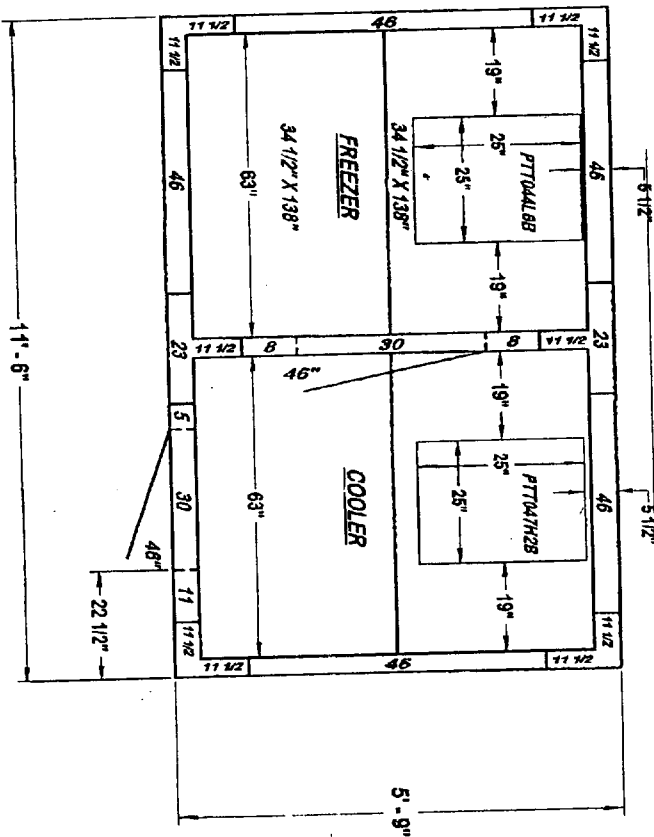

NOTE TO CLEANING DEPT.:
 CUT (2) 25" X 25" OPENINGS IN
 CEILING PANEL ONLY, AS SHOWN,
 FOR HEATRAFT REFRIGERATION
 SYSTEMS TRIM OFF OPENINGS AT
 JOB SITE WITH TRIM SUPPLIED
 BY HEATRAFT.

SHIP

DURO-LAST MEMBRANE ROOF
 (2) PRE-ASSEM. WOOD ROOF CURBS FOR
 OUTDOOR PRO - 3 UNITS.

(2) SILL PLATES
 (1) MED. TEMP. [PT04H2B]
 (1) LOW TEMP. [PT04LBB]

BOTH SYSTEMS TO BE:
 HEATRAFT PRO 3 OUTDOOR UNITS
 (208-230607PH)
 HERMETIC COMPRESSORS