

- VALVE RISER LEGEND**
- ① 4" DI CL U.G. SPIGOT, PLUMB AND LEVEL (BY OTHER'S)
 - ② 4" UNI-FLANGE (BY OTHER'S)
 - ③ 2 1/2" X 9" RED. FLANGE
 - ④ 2 1/2" GALV. SPOOL PC
 - ⑤ 2 1/2" FLANGED ELBOW
 - ⑥ WATER PRESSURE GAUGE (3.5" DIA.)
 - ⑦ 2 1/2" BUTTERFLY VLV W/ TAMPER SWITCH
 - ⑧ 2 1/2" AMES 2000 SS DC BFP
 - ⑨ 2 1/2" GRVD FLANGE
 - ⑩ 2 1/2" GRVD ELBOW
 - ⑪ POTTER VSR FLOWSWITCH (VANE TYPE)
 - ⑫ 1 1/4" TEST-N-DRAIN VLV (1/2" ORIFICE)
 - ⑬ 2 1/2" GRVD CHECK VLV W/ AUTO BALL DRIP
 - ⑭ SPARE HEAD BOX, 6 HD CAPACITY W/ WRENCH
 - ⑮ 1 1/4" GALV. 45 ELBOW W/ GALV. GRINNELL PLATE (MAIN DRAIN)
 - ⑯ 2 1/2" SINGLE FDC W/ WALL PLATE, CAP & CHAIN
 - ⑰ ELECTRIC BELL, 6" DIA., W/ BACKBOX (MOUNTED TO OUTSIDE BY OTHERS)
 - ⑱ PIPE STAND

HYDRAULIC CALCULATION INFORMATION

LOCATION: BASEMENT (AREA #1)

BASIS OF DESIGN: NFPA 13, 2007 EDITION
DENSITY AREA OF COVERAGE
.15 954 SQ FT

OCCUPANCY: BUSINESS MISC. STORAGE

SPRINKLERS: TOTAL THRD ORIFICE TEMP
16 1/2" 1/2" 155

SYSTEM DEMAND AT BASE OF RISER (BOR):
PRESSURE FLOW HOSE
71.98 PSI 403.43 GPM 250

SAFETY MARGIN: 23.0 PSI

HYDRAULIC CALCULATION INFORMATION

LOCATION: 1ST FLR RETAIL (AREA #2)

BASIS OF DESIGN: NFPA 13, 2007 EDITION
DENSITY AREA OF COVERAGE
.2 900 SQ FT

OCCUPANCY: RETAIL SPACE

SPRINKLERS: TOTAL THRD ORIFICE TEMP
13 1/2" 1/2" 155

SYSTEM DEMAND AT BASE OF RISER (BOR):
PRESSURE FLOW HOSE
85.18 PSI 351.56 GPM 250

SAFETY MARGIN: 10.44 PSI

HYDRAULIC CALCULATION INFORMATION

LOCATION: 3RD FLR APT (AREA #3)

BASIS OF DESIGN: NFPA 13, 2007 EDITION
DENSITY AREA OF COVERAGE
.1 4 HD'S

OCCUPANCY: RESIDENTIAL

SPRINKLERS: TOTAL THRD ORIFICE TEMP
4 1/2" 7/16" 155

SYSTEM DEMAND AT BASE OF RISER (BOR):
PRESSURE FLOW HOSE
73.03 PSI 60.69 GPM 100 GPM

SAFETY MARGIN: 24.89 PSI

HYDRAULIC CALCULATION INFORMATION

LOCATION: 4TH FLR APT (AREA #4)

BASIS OF DESIGN: NFPA 13, 2007 EDITION
DENSITY AREA OF COVERAGE
.0508 4 HD'S

OCCUPANCY: RESIDENTIAL

SPRINKLERS: TOTAL THRD ORIFICE TEMP
4 1/2" 7/16" 155

SYSTEM DEMAND AT BASE OF RISER (BOR):
PRESSURE FLOW HOSE
91.11 PSI 62.35 GPM 100 GPM

SAFETY MARGIN: 6.81 PSI

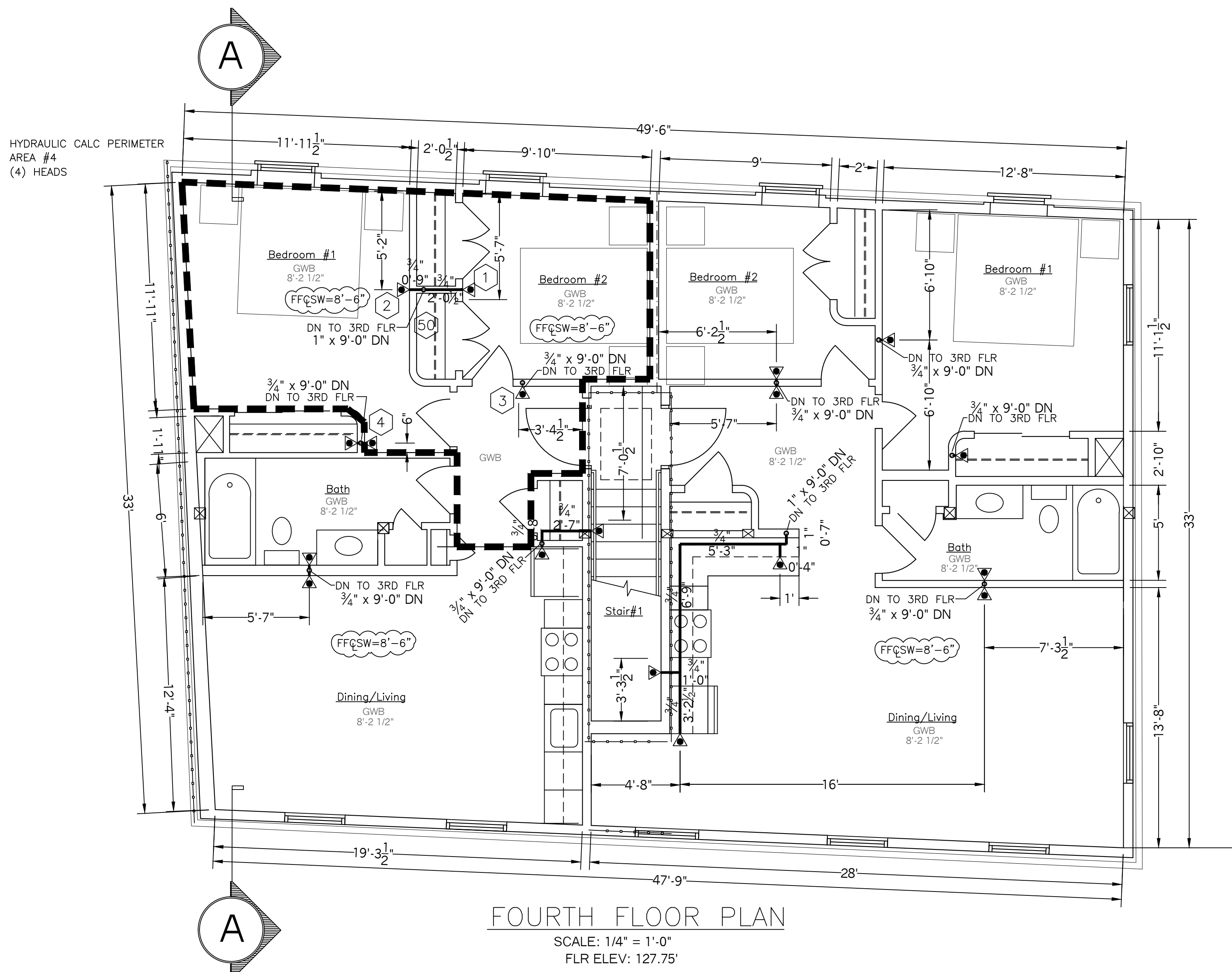

WATER SUPPLY DATA

STATIC = 96 PSI
RESIDUAL = 94 PSI
FLOW = 1352 GPM
TEST DATE = 6-20-2012
LOCATION = CORNER OF WILMOT ST AND CUMBERLAND AVE
SOURCE = PORTLAND WATER DIST.

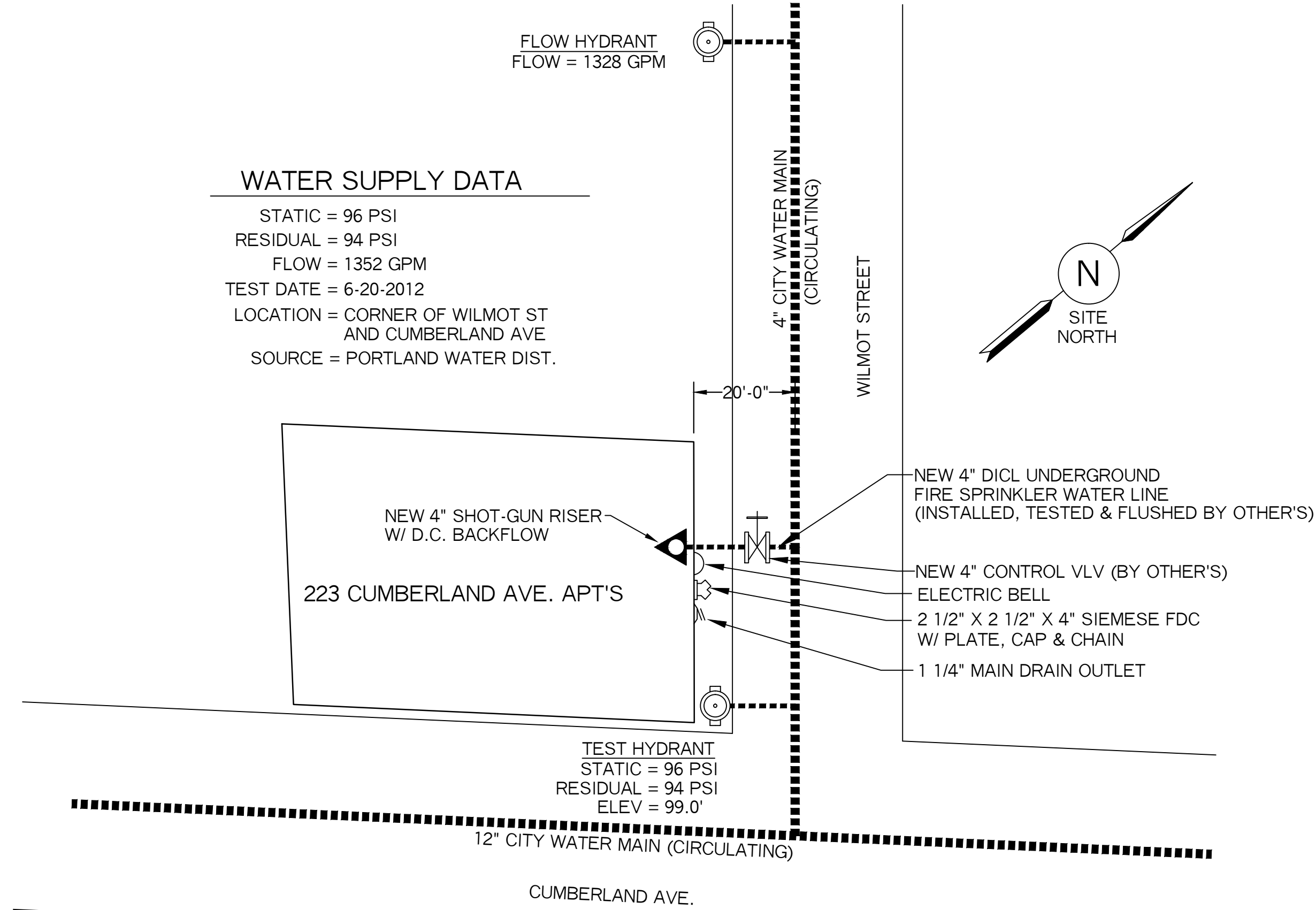

- SYSTEM GENERAL NOTES:**
- A WET PIPE SYSTEM OF AUTOMATIC SPRINKLERS DESIGNED AND INSTALLED PER NFPA 13 (2007 EDITION)
 - LINE PIPING TO BE SCHEDULE 40 BLACK STEEL WITH THREADED C.I. FITTINGS.
 - MAIN PIPING TO BE SCHEDULE 10 BLACK STEEL WITH GROOVED FITTINGS.
 - CVPC BLAZEMASTERS PLASTIC PIPE AND FITTINGS TO BE INSTALLED ON THE SECOND, THIRD AND FOURTH FLOORS.
 - CLOSETS LESS THAN 12 SQ FT SHALL NOT RECEIVE SPRINKLER PROTECTION

- SYSTEM SYMBOL LEGEND:**
- ▲ = WET SHOT-GUN RISER
 - = 200 BRASS UPRIGHT ABOVE CLG'S
 - = HYDRANT
 - ④ = HYDRAULIC CALCULATION REFERENCE POINT
 - = HANGER
 - ≡ = GROOVED COUPLING

SPRINKLER HEAD INFORMATION

QTY	SIZE	ORIFICE	K-FACTOR	DESCRIPTION	MODEL	TEMP	ESCUTCHEON	SYMBOL
1	1/2"	1/2"	5.6	VIKING "QR" WHITE PENDENT	VK302	155	RECESSED	○
21	1/2"	1/2"	5.6	VIKING "QR" BRASS UPRIGHT	VK300	155	NONE	●
32	1/2"	1/2"	5.6	VIKING "QR" WHITE HOR. SIDEWALL	VK305	155	RECESSED	△
30	1/2"	7/16"	4.9	VIKING RES. WHITE PENDENT	VK468	155	RECESSED	●
18	1/2"	7/16"	4.0	VIKING RES. WHITE HOR. SIDEWALL	VK486	155	RECESSED	◀
TOTAL HD'S=102								

RESIDENTIAL FIRE PROTECTION

223 CUMBERLAND AVE. APTS
223 CUMBERLAND AVE.
PORTLAND, ME. 04101

CRANDALL TOOTHAKER (OWNER)
PH: (207) 797-6066

64 DAGGETT HILL ROAD, GREENE MAINE 04236
PH: (207) 946-3473 FAX: (207) 946-3474

RESIDENTIAL FIRE PROTECTION, LLC
DATE: 2-29-2016
SCALE: 1/4" = 1'-0"
CONTRACT NO: C16005
DRAWING NO: 2 OF 2