

FIRST FLOOR PLAN
SCALE: 1/4"=1'-0"
SCALE: 0 2' 4' 8"
SCALE: 1/4"=1'-0"

REFER TO SHEET A6 FOR ACCESSIBILITY DETAILS & NOTES AT FIRST FLOOR BUSINESS & MERCANTILE OCCUPANCIES

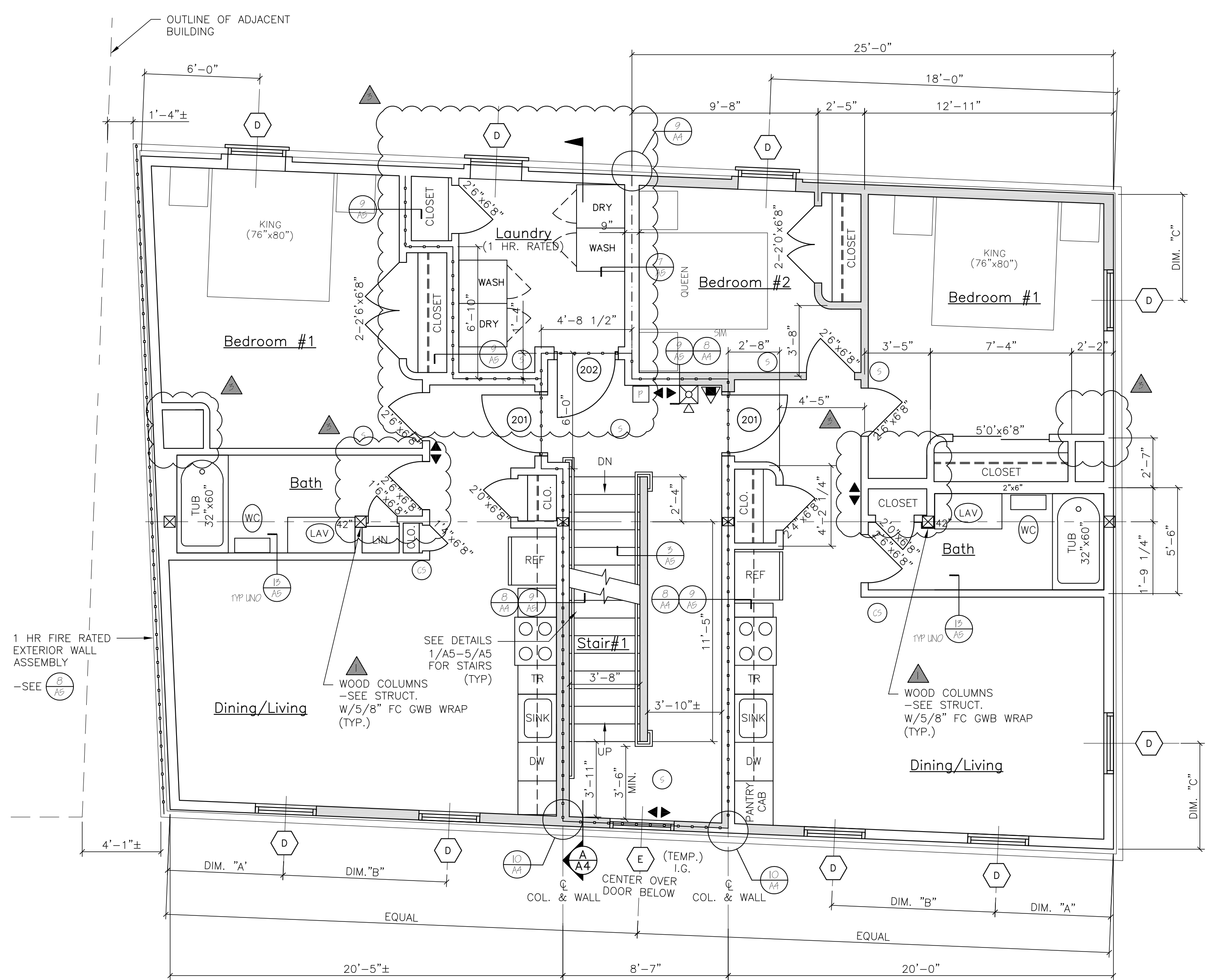

SECOND FLOOR PLAN
SCALE: 1/4"=1'-0"
SCALE: 0 2' 4' 8"
SCALE: 1/4"=1'-0"

| NFPA LEGEND | |
|-------------|--|
| | EXIT LIGHT |
| | FIRE EXTINGUISHER |
| | FIRE ALARM PULL MANUAL PULL STATION |
| | FIRE ALARM PANEL |
| | EMERGENCY LIGHT |
| | FIRE ALARM HORN STROBE UNIT |
| | FIRE ALARM STROBE UNIT |
| | SMOKE DETECTOR W/ SOUNDER BASE & STROBE (INTERCONNECTED) |
| | COMBINATION CARBON MONOXIDE / SMOKE DETECTOR W/ SOUNDER BASE & STROBE (INTERCONNECTED) |
| | HEAT DETECTOR |
| | ANNUNCIATOR PANEL |
| | KNOCK BOX |
| | 1 HR FIRE RATED PARTITION |
| | 1 HR FIRE RATED SEPARATION PARTITION |
| | "NOT AN EXIT" SIGN |

| LIFE SAFETY NOTES | |
|-------------------|--|
| 1. | THE BUILDING SHALL HAVE AN NFPA 13 FIRE SUPPRESSION SPRINKLER SYSTEM INSTALLED. SPRINKLER SYSTEM SHALL BE INSTALLED BY A CERTIFIED SPRINKLER CONTRACTOR AND SHALL BE REVIEWED AND APPROVED BY THE STATE OF MAINE FIRE MARSHAL AS WELL AS THE LOCAL AUTHORITY HAVING JURISDICTION. THE CONTRACTOR SHALL BEAR SOLE RESPONSIBILITY FOR THE DESIGN AND INSTALLATION OF THE SYSTEM FOR OCCUPANCY. |
| 2. | THE BUILDING SHALL HAVE A FIRE ALARM SYSTEM AS REQUIRED FOR COMPLIANCE WITH NFPA 101 LIFE SAFETY CODE COORDINATE WITH SPRINKLER SYSTEM. VERIFY LOCATION OF ALARM AND NOTIFICATION PANELS WITH THE AUTHORITY HAVING JURISDICTION. |
| 3. | SEE ACCESSIBILITY DETAILS FOR MOUNTING HEIGHTS OF LIFE SAFETY DEVICES. |
| 4. | ALL ALARMS AND DETECTORS SHALL BE INTERCONNECTED WITHIN EACH LIVING UNIT. |
| 5. | REFER TO THE WINDOW SCHEDULE FOR EGRESS WINDOWS. |

| GENERAL NOTES | |
|---------------|--|
| 1. | ALL HORIZONTAL UNIT SEPARATIONS (FLOOR/CEILING/ROOF) ASSEMBLIES SHALL BE 1 HR. FIRE RATED/ 5/8" G.C. |
| -SEE | |
| 2. | ALL VERTICAL UNIT SEPARATIONS (TENANT WALLS) SHALL BE 1 HR. FIRE RATED/ 5/8" G.C. |
| -SEE | |
| 3. | ALL STAIR ENCLOSURES SHALL BE 1 HR. FIRE RATED |
| -SEE | |
| 4. | STAIR DETAILS |
| -SEE | |
| 5. | REMOVE EXISTING DECKS & FIRE ESCAPES IN THEIR ENTIRETY. |
| 6. | SEE SHEET A6 FOR ACCESSIBILITY DETAILS AND NOTES. |
| 7. | FIRE RATED PARTITIONS AT ROOF ASSEMBLY |
| -SEE | |
| 8. | SEE SHEET A4 FOR THE RATED CONTINUITY DETAILS AT FLOOR/ WALL ASSEMBLIES. |

| LEGEND | |
|--------|--|
| SYMBOL | DESCRIPTION |
| | NEW WALL |
| | NEW WALL/EXISTING WALL W/ INFILL |
| | EXISTING WALL |
| | THIN LINEWEIGHT DENOTES EXISTING CONDITIONS |
| | HEAVY LINEWEIGHT DENOTES NEW CONDITIONS |
| | DEMOLISHED OR REMOVED STRUCTURE OR EQUIPMENT |

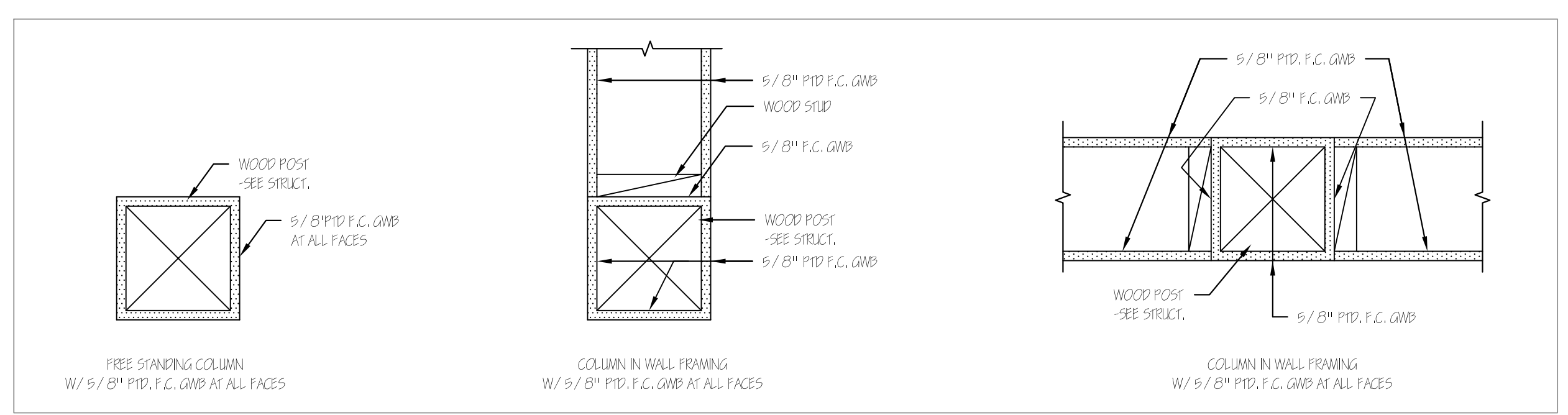

TYPICAL FIRE RATED COLUMN DETAILS

N15