

GRANT HAYS ASSOCIATES
 ARCHITECTURE & INTERIOR DESIGN
 P.O. BOX 6179 FALMOUTH MAINE 04105
 207.871.5900 www.granthays.com

PROJECT NAME
 6 UNIT APARTMENT/COMMERCIAL
 223 CUMBERLAND AVENUE
 225 CUMBERLAND AVENUE LLC.
 477 CONGRESS STREET
 PORTLAND, MAINE 04101

DATE
 29/EPT 2015
 SCALE
 1/4"=1'-0"
 DRAWN
 JAM/MFH
 JOB NO.
 150904

PROJECT NAME
 6 UNIT APARTMENT/COMMERCIAL
 223 CUMBERLAND AVENUE
 225 CUMBERLAND AVENUE LLC.
 477 CONGRESS STREET
 PORTLAND, MAINE 04101

FIRST & SECOND FLOOR PLAN
 DATE
 29/EPT 2015
 SCALE
 1/4"=1'-0"
 DRAWN
 JAM/MFH
 JOB NO.
 150904
 SHEET
A2
 COPYRIGHT REPRODUCTION OR REVUE OF THIS DOCUMENT WITHOUT WRITTEN PERMISSION FROM GRANT HAYS ASSOCIATES IS PROHIBITED.

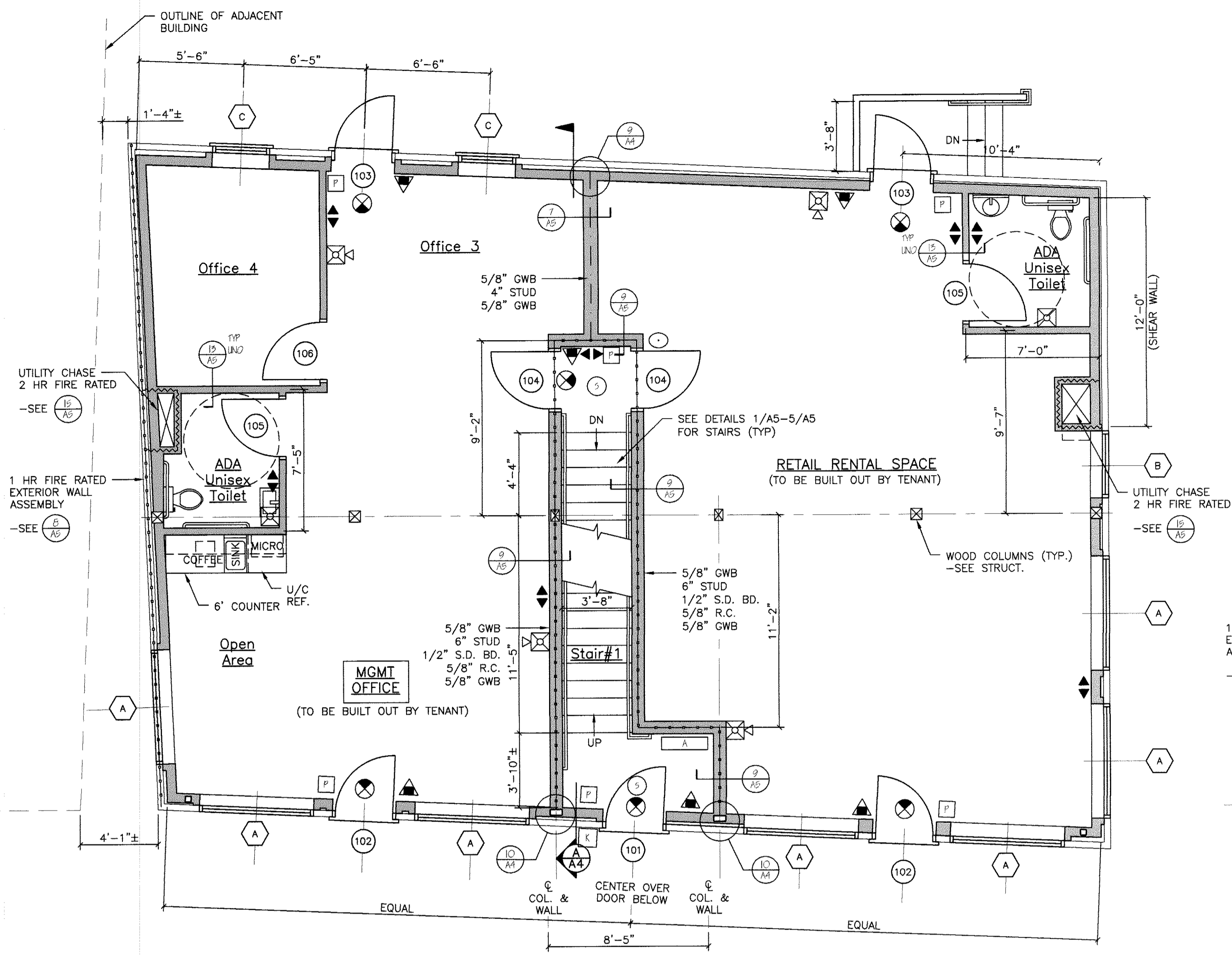

FIRST FLOOR PLAN
 SCALE: 1/4"=1'-0"

REFER TO SHEET A6 FOR ACCESSIBILITY DETAILS & NOTES AT FIRST FLOOR BUSINESS & MERCANTILE OCCUPANCIES

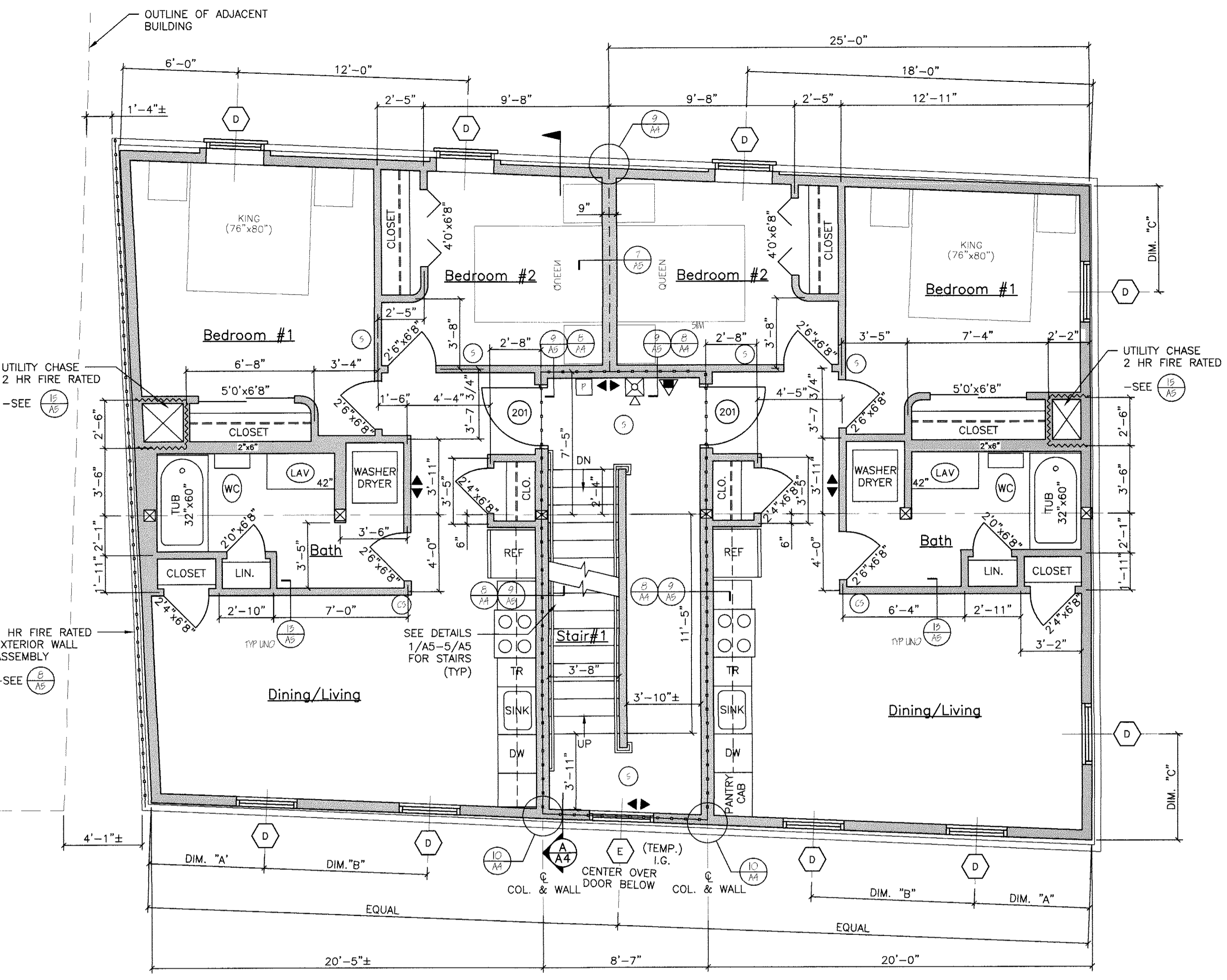

SECOND FLOOR PLAN
 SCALE: 1/4"=1'-0"

NIFPA LEGEND	
	EXIT LIGHT
	FIRE EXTINGUISHER
	FIRE ALARM PULL MANUAL PULL STATION
	FIRE ALARM PANEL
	EMERGENCY LIGHT
	FIRE ALARM HORN STROBE UNIT
	FIRE ALARM STROBE UNIT
	SMOKE DETECTOR W/ SOUNDER BELL & STROBE (INTERCONNECTED)
	COMBINATION CARBON MONOXIDE / SMOKE DETECTOR W/ SOUNDER BELL & STROBE (INTERCONNECTED)
	HEAT DETECTOR
	ANNUNCIATOR PANEL
	KNOCK BOX
	2 HR FIRE RATED PARTITION
	1 HR FIRE RATED PARTITION
	1 HR FIRE RATED SEPARATION PARTITION
	"NOT AN EXIT" SIGN

LIFE SAFETY NOTES

- THE BUILDING SHALL HAVE AN NIFPA IS FIRE SUPPRESSION SPRINKLER SYSTEM INSTALLED. SPRINKLER SYSTEM SHALL BE INSTALLED BY A CERTIFIED SPRINKLER CONTRACTOR AND SHALL BE REVIEWED AND APPROVED BY THE STATE OF MAINE FIRE MARSHAL AS WELL AS THE LOCAL AUTHORITY HAVING JURISDICTION. THE CONTRACTOR SHALL BEAR SOLE RESPONSIBILITY FOR THE DESIGN AND INSTALLATION OF THE SYSTEM FOR OCCUPANCY.
- THE BUILDING SHALL HAVE A FIRE ALARM SYSTEM AS REQUIRED FOR COMPLIANCE WITH NIFPA LIFE SAFETY CODE. COORDINATE WITH SPRINKLER SYSTEM. VERIFY LOCATION OF ALARM AND NOTIFICATION PANELS WITH THE AUTHORITY HAVING JURISDICTION.
- SEE ACCESSIBILITY DETAILS FOR MOUNTING HEIGHTS OF LIFE SAFETY DEVICES.
- ALL ALARMS AND DETECTORS SHALL BE INTERCONNECTED WITHIN EACH LIVING UNIT.
- REFER TO THE WINDOW SCHEDULE FOR EGRESS WINDOWS.

GENERAL NOTES

- ALL HORIZONTAL UNIT SEPARATIONS (FLOOR/CEILING/ROOF) ASSEMBLIES SHALL BE 1 HR. FIRE RATED / SIC 5.0.
 -SEE (6/AS) & (10/AS) & (1/AA)
- ALL VERTICAL UNIT SEPARATIONS (TENANT WALLS) SHALL BE 1 HR. FIRE RATED / SIC 5.0.
 -SEE (7/AS)
- ALL STAIR ENCLOSURES SHALL BE 1 HR. FIRE RATED.
 -SEE (1/AS) & (2/AS)
- STAIR DETAILS
 -SEE (1/AS) THRU (3/AS)
- REMOVE EXISTING DECKS & FIRE ESCAPES IN THEIR ENTIRETY.
- SEE SHEET A6 FOR ACCESSIBILITY DETAILS AND NOTES.
- FIRE RATED PARTITIONS AT ROOF ASSEMBLY
 -SEE (6/AA) & (7/AA)
- SEE SHEET A4 FOR FIRE RATED CONTINUITY DETAILS AT FLOOR/WALL ASSEMBLIES.

LEGEND	
SYMBOL	DESCRIPTION
	NEW WALL
	NEW WALL/EXISTING WALL W/INFILL
	EXISTING WALL
	THIN LINEWEIGHT DENOTES EXISTING CONDITIONS
	HEAVY LINEWEIGHT DENOTES NEW CONDITIONS
	DEMOLISHED OR REMOVED STRUCTURE OR EQUIPMENT

