

NOTES:

1. ALL DIMENSIONS ARE FOR REFERENCE ONLY. ALL DIMENSIONS SHALL BE FIELD VERIFIED BEFORE ORDERING SUPPLIES OR BEING CONSTRUCTION.

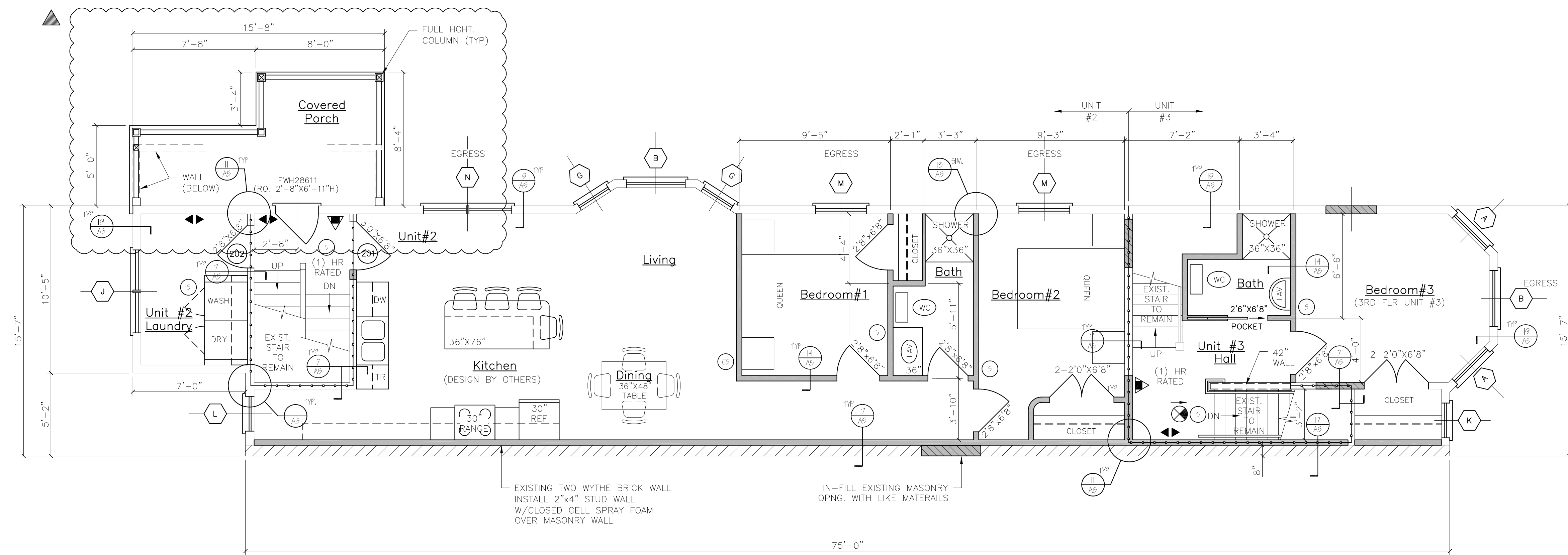

SECOND FLOOR PLAN
Unit#2 & Unit#3

EXISTING TWO WYTHE BRICK WALL
INSTALL 2"x4" STUD WALL
W/CLOSED CELL SPRAY FOAM
OVER MASONRY WALL

IN-FILL EXISTING MASONRY
OPNG. WITH LIKE MATERIALS

NO.	SIZE (WxD) (E)=EXISTING	INSUL	FIRE RATING	HARDWARE	SWING	REMARKS
1	5'-0"x6'-8"	R-7	1 HR	HW-5	SEE PLAN	* DOOR/FRAME ASSEMBLY, SELF CLOSING PANEL
2	2'-8"x6'-8" (E)	R-7	1 HR	HW-1	SEE PLAN	* DOOR/FRAME ASSEMBLY, SELF CLOSING FULL VIEW
3	5'-0"x6'-8" (E)	R-7	1 HR	HW-5	SEE PLAN	* DOOR/FRAME ASSEMBLY, SELF CLOSING, 9 LITE
4	5'-0"x6'-8"	R-7	1 HR	HW-5	SEE PLAN	* DOOR/FRAME ASSEMBLY, SELF CLOSING FULL VIEW
5	2'-8"x6'-8"	R-7	1 HR	HW-4	SEE PLAN	* DOOR/FRAME ASSEMBLY, SELF CLOSING PANEL
6	5'-0"x6'-8" (E)	R-7	1 HR	HW-2	SEE PLAN	* DOOR/FRAME ASSEMBLY, SELF CLOSING PANEL (REPLACE EXISTING DOOR)
7	2'-6"x6'-8" (E)	R-7	1 HR	HW-5	SEE PLAN	* DOOR/FRAME ASSEMBLY, SELF CLOSING PANEL
8	2'-8"x6'-8" (E)	R-7	1 HR	HW-4	SEE PLAN	* DOOR/FRAME ASSEMBLY, SELF CLOSING PANEL
9	3'-0"x6'-8"	R-7	1 HR	HW-2	SEE PLAN	* DOOR/FRAME ASSEMBLY, SELF CLOSING
10	2'-8"x6'-8" (E)	R-7	1 HR	HW-4	SEE PLAN	* DOOR/FRAME ASSEMBLY, SELF CLOSING (REPLACE EXISTING DOOR)
11	2'-8"x6'-8" (E)	R-7	1 HR	HW-2	SEE PLAN	* DOOR/FRAME ASSEMBLY, SELF CLOSING (REPLACE EXISTING DOOR)

NOTE: SEE FLOOR PLANS FOR UNIT INTERIOR DOOR SIZES, SWING AND TYPE.
REPLACE EXISTING DOORS & FRAMES NOTED IN DOOR SCHEDULE AS REQUIRED.

HW-1	3 BUTTS*, DOOR ENTRY LEVEL LOCKSET; THRESHOLD WEATHER STRIPPING; DOOR BOTTOM	* GC OPTION: SELF CLOSING BUTTS OR DOOR CLOSERS
HW-2	3 BUTTS*, DOOR ENTRY LEVEL LOCKSET; THRESHOLD WEATHER STRIPPING; DOOR BOTTOM; DOOR VENER	* GC OPTION: SELF CLOSING BUTTS OR DOOR CLOSERS
HW-3	3 BUTTS*, DOOR ENTRY LEVEL LOCKSET; THRESHOLD WEATHER STRIPPING; DOOR BOTTOM;	* GC OPTION: SELF CLOSING BUTTS OR DOOR CLOSERS
HW-4	3 BUTTS*, DOOR ENTRY LEVEL LOCKSET;	* GC OPTION: SELF CLOSING BUTTS OR DOOR CLOSERS
HW-5	3 BUTTS*, DOOR PASSAGE LEVER LATCH SET W/ EXIT FUNCTION	* GC OPTION: SELF CLOSING BUTTS OR DOOR CLOSERS
INTERNAL UNIT DOORS	3 BUTTS; LATCH SET EXCEPT PRIVACY SET AT BATHROOMS	* GC OPTION: SELF CLOSING BUTTS OR DOOR CLOSERS

NO.	SIZE (WxD)	TYPE	FIRE RATING	GLAZING	ROUGH OPENING (WxD)	REMARKS
1	1W2892	DOUBLE HANG	NONE	TEMP. INSUL. GL.	2'-10 1/2" x 9'-9 1/2" x 4"	ANDERSEN OR EQUIV., (TEMPERED WINDOW)
2	1W3462	DOUBLE HANG	NONE	TEMP. INSUL. GL.	1'8" x 16"	ANDERSEN OR EQUIV., (EGRESS & TEMPERED WINDOW)
3	1W2092	DOUBLE HANG	NONE	TEMP. INSUL. GL.	2'-2 1/2" x 9'-9 1/2" x 4"	ANDERSEN OR EQUIV., (TEMPERED WINDOW)
4	1W2042	DOUBLE HANG	NONE	TEMP. INSUL. GL.	2'-2 1/2" x 8'-4 1/2" x 4"	ANDERSEN OR EQUIV., (TEMPERED WINDOW)
5	2-1W2442	DOUBLE HANG	NONE	INSUL. GL.	4'-11 1/2" x 16'-4 1/2" x 4"	ANDERSEN OR EQUIV.
6	1W2492	DOUBLE HANG	NONE	TEMP. INSUL. GL.	2'-6 1/2" x 9'-9 1/2" x 4"	ANDERSEN OR EQUIV., (TEMPERED WINDOW)
7	1W2042	DOUBLE HANG	NONE	INSUL. GL.	2'-2 1/2" x 8'-4 1/2" x 4"	ANDERSEN OR EQUIV.
8	1W3092	DOUBLE HANG	NONE	TEMP. INSUL. GL.	5'-2 1/2" x 9'-9 1/2" x 4"	ANDERSEN OR EQUIV., (EGRESS & TEMPERED WINDOW)
9	2-1W3092	DOUBLE HANG	NONE	TEMP. INSUL. GL.	8'-9 1/2" x 16'-4 1/2" x 4"	ANDERSEN OR EQUIV., (EGRESS & TEMPERED WINDOW)

NOTE: SEE STRUCTURAL HEADER SCHEDULE FOR HEADER SIZE

WINDOW & DOOR SCHEDULE & HARDWARE SETS

SYMBOL	DESCRIPTION
(X)	EXIT LIGHT
(▲)	FIRE EXTINGUISHER
(FACP)	FIRE ALARM PANEL - LOCATE PER AMJ
(E)	EMERGENCY LIGHT
(S)	SMOKE DETECTOR W/ SOUNDER BASE & STROBE (INTERCONNECTED)
(CS)	COMBINATION CARBON MONOXIDE / SMOKE DETECTOR W/ SOUNDER BASE & STROBE (INTERCONNECTED)
(K)	KNOX BOX - LOCATE PER AMJ
(---)	1 HR RATED PARTITION
(---)	1 HR RATED SEPARATION PARTITION

SYMBOL	DESCRIPTION
(---)	NEW WALL
(---)	NEW WALL/EXISTING WALL W/INFILL
(---)	EXISTING WALL
(---)	THIN LINEWEIGHT DENOTES EXISTING CONDITIONS
(---)	HEAVY LINEWEIGHT DENOTES NEW CONDITIONS
(---)	DEMOLISHED OR REMOVED STRUCTURE OR EQUIPMENT
(⊕)	EXTERIOR LIGHT

STRUCTURAL HEADER SCHEDULE

LVL's
5' wide openings - Use (2) 1 3/4" x 9 1/2" LVL's.
4' wide openings - Use (2) 1 3/4" x 9 1/2" LVL's.
3' or less openings - Use (3) 2 x 10's.

Second Floor Level:
5' wide openings - Use (2) 1 3/4" x 9 1/2" LVL's.
4' wide openings - Use (3) 2 x 10's.
3' or less openings - Use (2) 2 x 10's.

Third Floor Level:
5' and less openings - Use (2) 2 x 10's.

LIFE SAFETY NOTES

- THE BUILDING SHALL HAVE AN NFPA (R) FIRE SUPPRESSION SPRINKLER SYSTEM INSTALLED. SPRINKLER SYSTEM SHALL BE INSTALLED BY A CERTIFIED SPRINKLER CONTRACTOR AND SHALL BE REVIEWED AND APPROVED BY THE STATE OF MAINE FIRE MARSHAL AS WELL AS THE LOCAL AUTHORITY HAVING JURISDICTION. THE CONTRACTOR SHALL BEAR SOLE RESPONSIBILITY FOR THE DESIGN AND INSTALLATION OF THE SYSTEM FOR OCCUPANCY.
- THE BUILDING SHALL HAVE A FIRE ALARM SYSTEM AS REQUIRED FOR COMPLIANCE WITH NFPA (R) LIFE SAFETY CODE COORDINATE WITH SPRINKLER SYSTEM. VERIFY LOCATION OF ALARM AND NOTIFICATION PANELS WITH THE AUTHORITY HAVING JURISDICTION.
- ALL ALARMS AND DETECTORS SHALL BE INTERCONNECTED.
- REFER TO THE WINDOW SCHEDULE FOR EGRESS WINDOWS.

GENERAL NOTES

- ALL HORIZONTAL UNIT SEPARATIONS (FLOOR/CEILING/ROOF) ASSEMBLIES SHALL BE 1 HR. FIRE RATED/STC 90.
-SEE (12/AB) & (13/AB) & (18/AB)
- ALL VERTICAL UNIT SEPARATIONS (PARTIAL WALLS) SHALL BE 1 HR. FIRE RATED/STC 90
-SEE (7/AB)
- ALL STAIR ENCLOSURES SHALL BE 1 HR FIRE RATED
-SEE (7/AB)
- SEE SHEET AS FOR HANDRAIL DETAILS

06.20.2016
ADDED EXTERIOR 2ND & 3RD FLOOR DECKS
REVEAL FLOOR PLAN

Engineering Review of Structural Framing System Only.

ENGINEERING DESIGN PROFESSIONALS
PO Box 575
Freeport, Maine 04032
207-865-9505

STATE OF MAINE
LARRY A. WICHROSKI
No. 5990
PROFESSIONAL ENGINEER

50 WILMOT STREET

MORIN DRAFTING 318-1177

50 WILMOT STREET, L.L.C.
477 CONGRESS STREET PORTLAND, MAINE

SECOND FLOOR PLAN

DRAWN: J. MORIN
SCALE: 1/4"=1'-0"
DATE: 11-18-2015
PLAN NO:

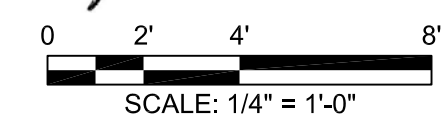

A3