

NOTES:
 1. ALL DIMENSIONS ARE FOR REFERENCE ONLY. ALL DIMENSIONS SHALL BE FIELD VERIFIED BEFORE ORDERING SUPPLIES OR BEING CONSTRUCTION.

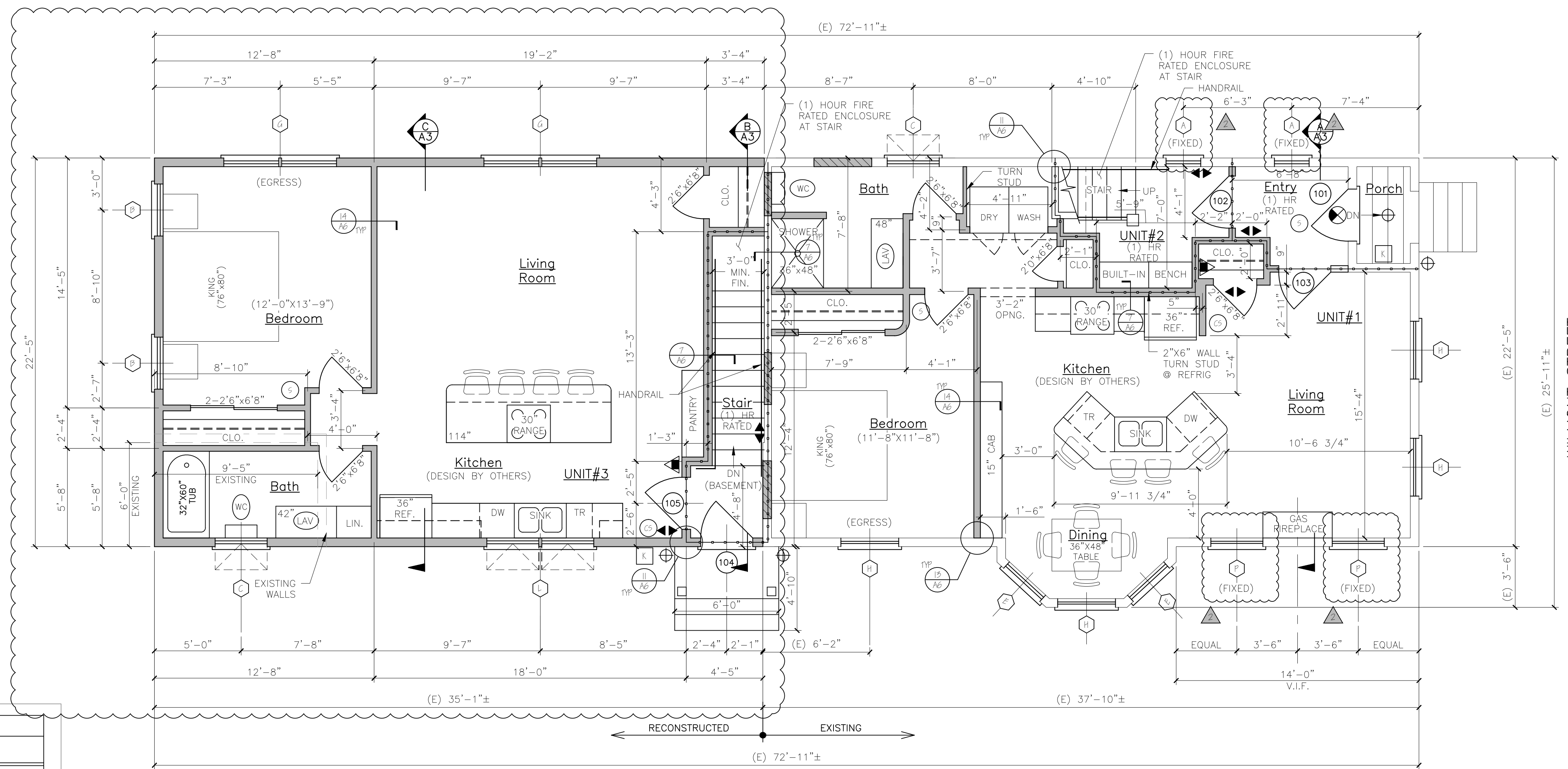

NOTE: WINDOW SUPPLIER SHALL PROVIDE FRM PACKAGE AND ADJUST MILLED UNITS ROUGH OPENINGS AS REQUIRED.
 NOTE: **CONTRACTOR SHALL VERIFY ROUGH OPENINGS BEFORE FRAMING OPENINGS
 NOTE: SEE ELEVATIONS FOR GRILLE PATTERNS, ORDER ACCORDINGLY.

| DOOR SCHEDULE | | | | | | |
|---------------|----------------------------|-------|-------------|----------|----------|--|
| NO. | SIZE (WxH) (E)-EXISTING | INSUL | FIRE RATING | HARDWARE | SWING | REMARKS |
| 100 | 5'-0"x6'-8" | R-7 | 1 HR | HW-5 | SEE PLAN | * DOOR/FRAME ASSEMBLY, SELF CLOSING, PANEL |
| 101 | 5'-0"x6'-2" | R-7 | 1 HR | HW-5 | SEE PLAN | * DOOR/FRAME ASSEMBLY, SELF CLOSING, PANEL |
| 102 | 5'-0"x6'-2" | R-7 | 1 HR | HW-5 | SEE PLAN | * DOOR/FRAME ASSEMBLY, SELF CLOSING, PANEL |
| 103 | 5'-0"x6'-8" | R-7 | 1 HR | HW-1 | SEE PLAN | * DOOR/FRAME ASSEMBLY, SELF CLOSING, FULL VIEW |
| 104 | 5'-0"x6'-8" | R-7 | 1 HR | HW-5 | SEE PLAN | * DOOR/FRAME ASSEMBLY, SELF CLOSING, 9/LITE |
| 105 | 5'-0"x6'-8" | R-7 | 1 HR | HW-5 | SEE PLAN | * DOOR/FRAME ASSEMBLY, SELF CLOSING, FULL VIEW |
| 106 | 5'-0"x6'-8" | R-7 | 1 HR | HW-4 | SEE PLAN | * DOOR/FRAME ASSEMBLY, SELF CLOSING, PANEL |
| 107 | 5'-0"x6'-8" | R-7 | 1 HR | HW-2 | SEE PLAN | * DOOR/FRAME ASSEMBLY, SELF CLOSING, PANEL (REPLACE EXISTING DOOR) |

NOTE: SEE FLOOR PLANS FOR UNIT INTERIOR DOOR SIZES, SWING AND TYPE. REPLACE EXISTING DOORS & FRAMES NOTED IN DOOR SCHEDULE AS REQUIRED.

| HW | BUITS | DOOR/ENTRY LEVEL LOCKSET; THRESHOLD WEATHER STRIPPING; DOOR BOTTOM | GC OPTION: SELF CLOSING BUITS OR DOOR CLOSERS |
|---------------------|---------|---|---|
| HW-1 | 5 BUITS | DOOR/ENTRY LEVEL LOCKSET; THRESHOLD WEATHER STRIPPING; DOOR BOTTOM | * GC OPTION: SELF CLOSING BUITS OR DOOR CLOSERS |
| HW-2 | 5 BUITS | DOOR/ENTRY LEVEL LOCKSET; THRESHOLD WEATHER STRIPPING; DOOR VIEWER | * GC OPTION: SELF CLOSING BUITS OR DOOR CLOSERS |
| HW-5 | 5 BUITS | DOOR; ENTRY LEVEL LOCKSET; THRESHOLD WEATHER STRIPPING; DOOR BOTTOM | * GC OPTION: SELF CLOSING BUITS OR DOOR CLOSERS |
| HW-4 | 5 BUITS | DOOR; ENTRY LEVEL LOCKSET | * GC OPTION: SELF CLOSING BUITS OR DOOR CLOSERS |
| HW-5 | 5 BUITS | DOOR; STORE ROOM LEVEL LOCKSET W/ EXIT FUNCTION | * GC OPTION: SELF CLOSING BUITS OR DOOR CLOSERS |
| INTERNAL UNIT DOORS | 5 BUITS | LEVEL LATCH SET; EXCEPT PRIVACY SET AT BATHROOMS | * GC OPTION: SELF CLOSING BUITS OR DOOR CLOSERS |

| WINDOW SCHEDULE | | | | | | |
|-----------------|---------------------|----------------|-------------|------------------------------------|------------------------|-----------------|
| NO. | SIZE (WxH) | TYPE | FIRE RATING | GLAZING | ROUGH OPENING (WxH) | REMARKS |
| 1 | MRAW2020P | AWNING (FIXED) | NONE | TEMPERED, INSL. GL. | 2'-11/4" x 2'-0 5/4" | PLYGEM |
| 2 | MRAW5050 | AWNING | NONE | TEMPERED, INSL. GL. FROSTED GL. | 5'-11/8" x 0-1/2" | PLYGEM |
| 3 | MRAW6050P | AWNING | NONE | TEMPERED, INSL. GL. | 5'-11/8" x 0-1/2" | PLYGEM |
| 4 | MRAW6050P | PICTURE | NONE | TEMPERED, INSL. GL. | 6'-2 3/8" x 6'-1 1/4" | PLYGEM |
| 5 | MRAW28910 | DOUBLE-HUNG | NONE | TEMPERED, INSL. GL. | 2'-10 5/8" x 6'-1 1/8" | PLYGEM |
| 6 | MRAW6050P | DOUBLE-HUNG | NONE | TEMPERED, INSL. GL. | 5'-2 5/8" x 6'-1 1/8" | PLYGEM (EGRESS) |
| 7 | MRAW60410-2 | DOUBLE-HUNG | NONE | TEMPERED, INSL. GL. | 6'-4 3/4" x 6'-1 1/8" | PLYGEM (EGRESS) |
| 8 | MRAW60410 | DOUBLE-HUNG | NONE | TEMPERED, INSL. GL. | 5'-6 3/8" x 6'-1 1/8" | PLYGEM (EGRESS) |
| 9 | MRAW2424 | AWNING | NONE | TEMPERED, INSL. GL. FROSTED GL. | 2'-2 1/4" x 2'-4 3/4" | PLYGEM |
| 10 | CUSTOM-FIELD VERIFY | DOUBLE-HUNG | NONE | TEMPERED, INSL. GL. (FIELD VERIFY) | | PLYGEM (EGRESS) |
| 11 | MRAW5050-2 | AWNING | NONE | TEMPERED, INSL. GL. | 6'-2 1/8" x 0-1/2" | PLYGEM |
| 12 | MRAW5050-5 | AWNING | NONE | TEMPERED, INSL. GL. | 9'-2 1/8" x 0-1/2" | PLYGEM |
| 13 | MRAW2424-2 | AWNING | NONE | TEMPERED, INSL. GL. | 2'-3 3/4" x 2'-4 3/4" | PLYGEM |
| 14 | MRAW5050P | AWNING (FIXED) | NONE | TEMPERED, INSL. GL. | 5'-11/8" x 0-1/2" | PLYGEM |
| 15 | MRAW5050-2 | AWNING | NONE | TEMPERED, INSL. GL. | 6'-2 1/8" x 0-1/2" | PLYGEM |

NOTE: VERIFY ALL WINDOW AND DOOR SIZES AND STYLES WITH OWNER BEFORE ORDERING.
 NOTE: SEE STRUCTURAL HEADER SCHEDULE FOR HEADER SIZE

WINDOW & DOOR SCHEDULE & HARDWARE SETS

| NFPA LEGEND | |
|-------------|--|
| | EXIT LIGHT |
| | FIRE EXTINGUISHER |
| | FIRE ALARM PANEL-LOCATE PER ANJ |
| | EMERGENCY LIGHT |
| | SMOKE DETECTOR W/ SOUNDER BASE & STROBE (INTERCONNECTED) |
| | COMBINATION CARBON MONOXIDE / SMOKE DETECTOR W/ SOUNDER BASE & STROBE (INTERCONNECTED) |
| | KNOCK BOX-LOCATE PER ANJ |
| | 1 HR RATED PARTITION |
| | 1 HR RATED SEPARATION PARTITION |
| | EGRESS LIGHT |

LIFE SAFETY NOTES

- THE BUILDING SHALL HAVE AN NFPA 13R FIRE SUPPRESSION SPRINKLER SYSTEM INSTALLED. SPRINKLER SYSTEM SHALL BE INSTALLED BY A CERTIFIED SPRINKLER CONTRACTOR AND SHALL BE REVIEWED AND APPROVED BY THE STATE OF MAINE FIRE MARSHAL AS WELL AS THE LOCAL AUTHORITY HAVING JURISDICTION. THE CONTRACTOR SHALL BEAR SOLE RESPONSIBILITY FOR THE DESIGN AND INSTALLATION OF THE SYSTEM FOR OCCUPANCY.
- THE BUILDING SHALL HAVE A FIRE ALARM SYSTEM AS REQUIRED FOR COMPLIANCE WITH NFPA 101 LIFE SAFETY CODE. COORDINATE WITH SPRINKLER SYSTEM. VERIFY LOCATION OF ALARM AND NOTIFICATION PANELS WITH THE AUTHORITY HAVING JURISDICTION.
- ALL ALARMS AND DETECTORS SHALL BE INTERCONNECTED.
- REFER TO THE WINDOW SCHEDULE FOR EGRESS WINDOWS.

GENERAL NOTES

- ALL HORIZONTAL UNIT SEPARATIONS (FLOOR/CEILING/ROOF) ASSEMBLIES SHALL BE 1 HR FIRE RATED / SIC 50.
-SEE & &
- ALL VERTICAL UNIT SEPARATIONS (RENTAL WALLS) SHALL BE 1 HR FIRE RATED / SIC 50.
-SEE
- ALL STAIR ENCLOSURES SHALL BE 1 HR FIRE RATED.
-SEE
- SEE SHEET A6 FOR HANDRAIL DETAILS
- SEE FOR FIRE RATING AT UNDERSIDE OF STAIR RUNS.
- SEE FOR 1 HOUR RATED EXTERIOR WALL.

| LEGEND | |
|--------|--|
| SYMBOL | DESCRIPTION |
| | NEW WALL |
| | NEW WALL/EXISTING WALL W/INFILL |
| | EXISTING WALL |
| | THIN LINEWEIGHT DENOTES EXISTING CONDITIONS |
| | HEAVY LINEWEIGHT DENOTES NEW CONDITIONS |
| | DEMOLISHED OR REMOVED STRUCTURE OR EQUIPMENT |

STRUCTURAL HEADER SCHEDULE

LVL's
 5' wide openings - Use (2) 1 3/4" x 9 1/2" LVL's.
 4' wide openings - Use (2) 1 3/4" x 9 1/2" LVL's.
 3' or less openings - Use (3) 2 x 10's.

Second Floor Level:
 5' wide openings - Use (2) 1 3/4" x 9 1/2" LVL's.
 4' wide openings - Use (3) 2 x 10's.
 3' or less openings - Use (2) 2 x 10's.

Third Floor Level:
 5' and less openings - Use (2) 2 x 10's.

REVISION 1 FLOOR PLAN 03-17-2017

Engineering Review of Structural Framing System Only.

LARRY A. WICHROSKI
 No. 5990
 LICENSED PROFESSIONAL ENGINEER

ENGINEERING DESIGN PROFESSIONALS
 PO Box 575
 Freeport, Maine 04032
 207-865-9505

52 WILMOT STREET
 MORIN DRAFTING 318-1177
 52 WILMOT STREET, L.L.C.
 477 CONGRESS STREET PORTLAND, MAINE

FIRST FLOOR PLAN
 DRAWN: J. MORIN
 SCALE: 1/4"=1'-0"
 DATE: 07-06-2016
 PLAN NO:

ISSUED FOR CONSTRUCTION
 03-17-17

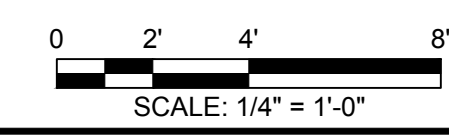

A3