

Location of Construction: 58 Wilmont St., Portland		Owner: Jay York		Phone: 773-3434		Permit No: <div style="font-size: 2em; font-weight: bold;">940748</div> PERMIT ISSUED <div style="border: 1px solid black; padding: 5px; margin: 5px;"> JUL 25 1994 </div> CITY OF PORTLAND Zone: A6 CBL: 26-O-5
Owner Address: same		Leasee/Buyer's Name:		BusinessName:		
Contractor Name: **Bob Dyer		Address: P.O. Box 4742 Portland 04112		Phone: none		
Past Use: 2 family		Proposed Use: 2 family with dormers		COST OF WORK: \$ 4,000		
				FIRE DEPT. <input type="checkbox"/> Approved <input type="checkbox"/> Denied		
				PERMIT FEE: \$ 40.00		
Proposed Project Description: to erect two dormers as per plans				SIGNATURES AND APPROVALS Signature: _____ PEDESTRIAN ACTIVITIES DISTRICT (P.U.D.) Action: Approved <input type="checkbox"/> Approved with Conditions: <input type="checkbox"/> Denied <input type="checkbox"/> Signature: _____ Date: _____		
				Zoning Approval: Special Zone or Reviews: <input type="checkbox"/> Shoreland <input type="checkbox"/> Wetland <input type="checkbox"/> Flood Zone <input type="checkbox"/> Subdivision		

- less than pickup truck load of debris

PHONE:

Permit No:	
<div style="font-size: 24pt; font-weight: bold; margin: 0;">940748</div> <div style="border: 1px solid black; padding: 5px; margin: 5px 0;"> <div style="font-size: 18pt; font-weight: bold; color: red; margin: 0;">JUL 25 1994</div> </div> <div style="font-size: 18pt; font-weight: bold; margin: 0;">CITY OF PORTLAND</div>	
Permit Issued:	
Zone:	CBL: 0-5
Zoning Approval:	
Special Zone or Reviews: <input type="checkbox"/> Shoreland <input type="checkbox"/> Wetland <input type="checkbox"/> Flood Zone <input type="checkbox"/> Subdivision <input type="checkbox"/> Site Plan maj <input type="checkbox"/> minor <input type="checkbox"/> mm <input type="checkbox"/>	
Zoning Appeal <input type="checkbox"/> Variance <input type="checkbox"/> Miscellaneous <input type="checkbox"/> Conditional Use <input type="checkbox"/> Interpretation <input type="checkbox"/> Approved <input type="checkbox"/> Denied	
Historic Preservation <input checked="" type="checkbox"/> Not in District or Landmark <input checked="" type="checkbox"/> Does Not Require Review <input type="checkbox"/> Requires Review	
Action: <input type="checkbox"/> Approved <input type="checkbox"/> Approved with Conditions <input type="checkbox"/> Denied	
Date: 7/22/94	
CEO DISTRICT <div style="border: 1px solid black; display: inline-block; padding: 5px; font-size: 1.5em; margin-left: 10px;">7</div>	

GRAMING PLANS
for DORMER
CONST. ON
58 WILMONT ST
NW CORNER.

BOR DTER
CONTRACTOR -
PO BOX 4742
PORTLAND ME
04112

EST COST
OF CONSTRUCTION
\$4,000



↑ 1/2 ↓

SURFACES

1/2" PLYWOOD SHEETING VERT. SURFACES
2" x 4" TRIM PINE
5/8" PLYWOOD SHEETING. HORIZONTAL SURFACES.

2" x 4" DORMER WALLS 16" ON CENTER
2" x 6" DORMER OVERHEAD 16" ON CENTER
2" x 6" RAFTERS SISTERED
ON DORMER WALL BEARING
RAFTERS BOTH SIDES

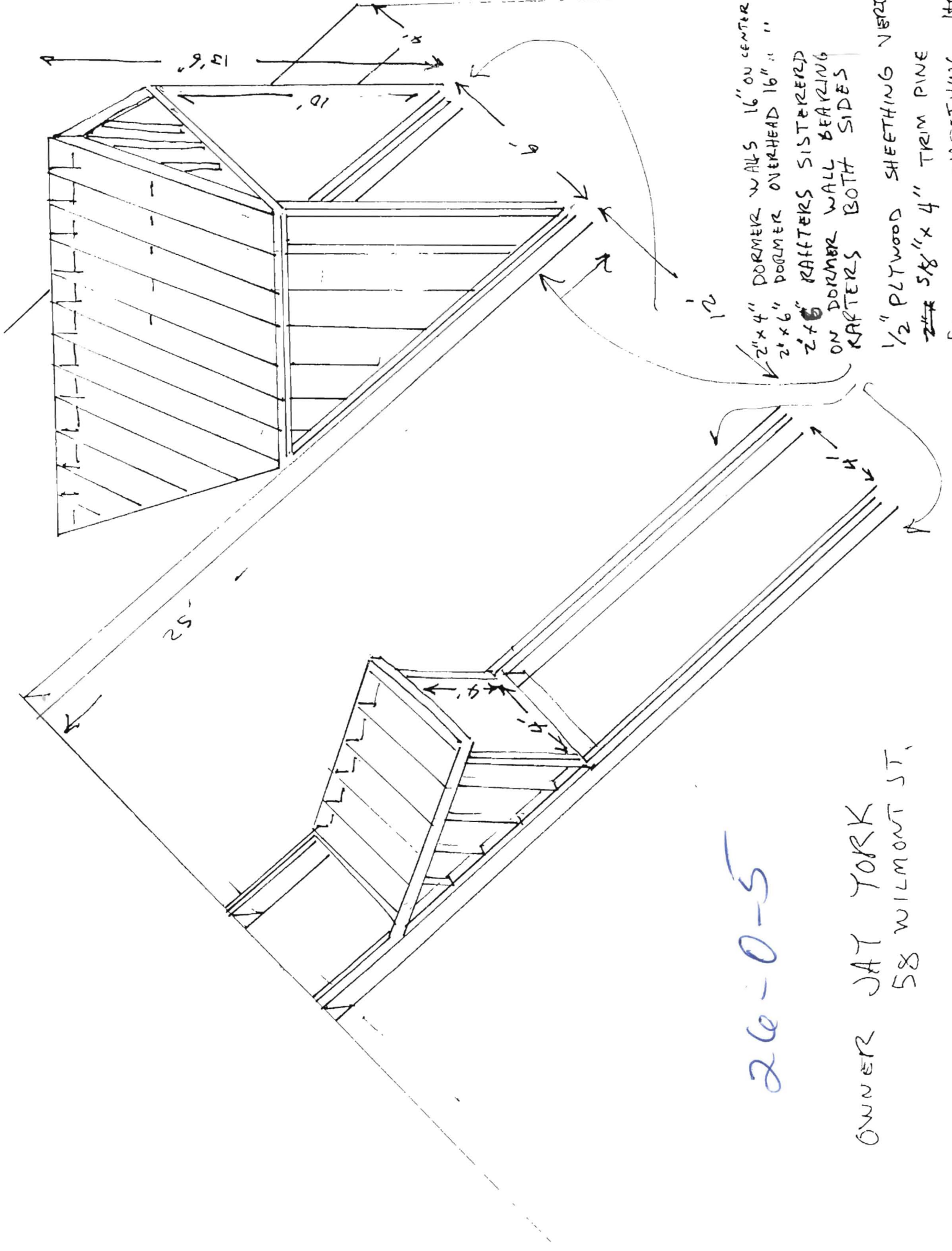

26-0-5

OWNER JAY YORK
58 WILMONT ST.

CRAMMING PLANS
FOR DORMER
CONST. ON
58 WILMONT ST
NW CORNER.

BORIS DIER
CONTRACTOR -
PO BOX 4742
PORTLAND ME
04112

EST COST
OF CONSTRUCTION
\$4,000

$\frac{1}{4}'' = 1'$

↑ . IN ↓

SURFACES

HORIZONTAL SURFACES.

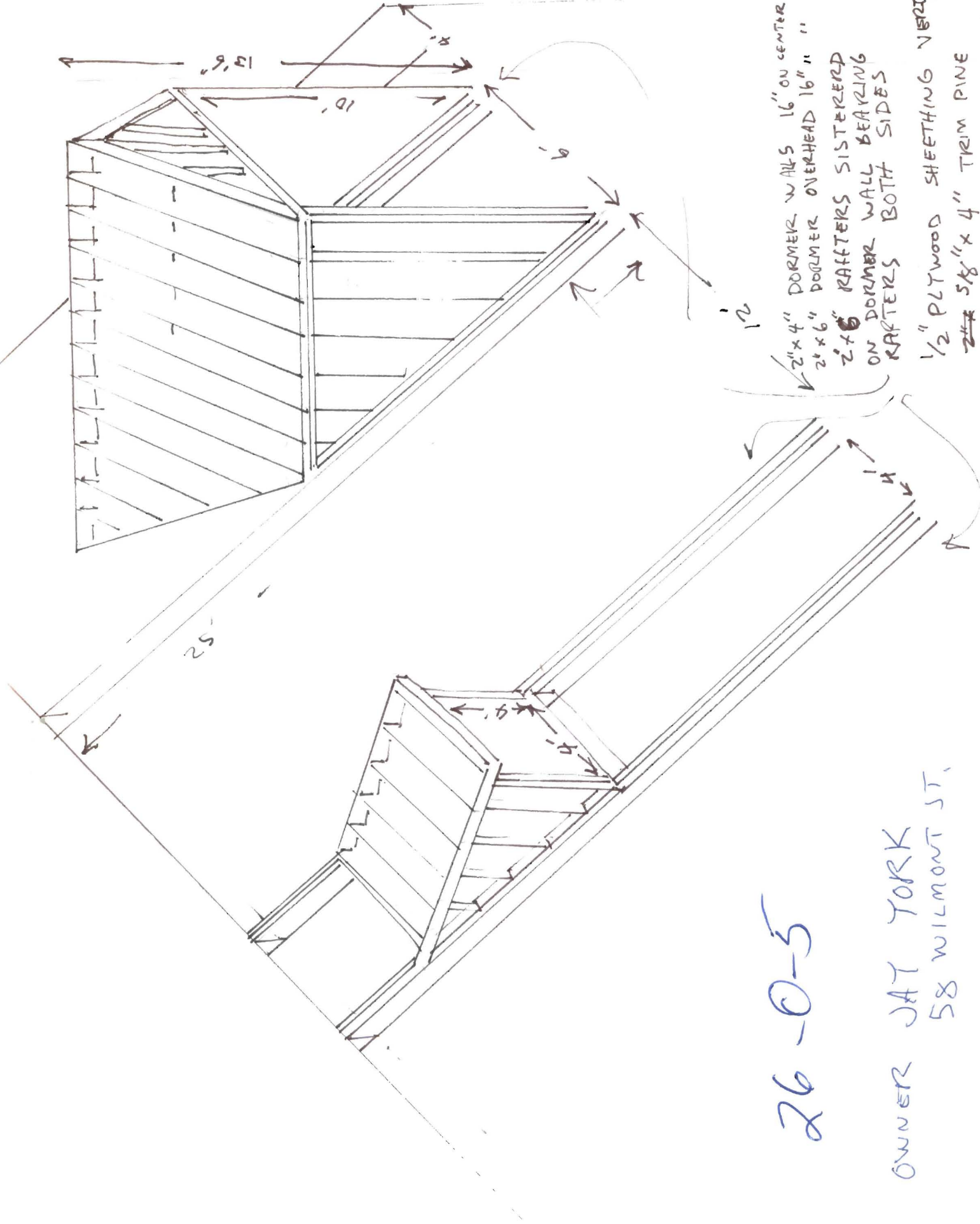

2" x 4" DORMER WALLS 16" ON CENTER
2" x 6" DORMER OVERHEAD 16" ON CENTER
2" x 6" RAFTERS SISTERED
ON DORMER WALL BEARING
RAFTERS BOTH SIDES

1/2" PLYWOOD SHEATHING VERT.
2" x 4" TRIM PINE
5/8" PLYWOOD SHEATHING. HORIZONTAL SURFACES.

26-0-5

OWNER JAY YORK
58 WILMONT ST.