

THE TRUSSES SHOWN ARE REPRESENTATIONS ONLY - THE ACTUAL TRUSSES ARE TO BE DESIGNED AND ENGINEERED BY THE COMPANY THAT BUILDS THEM. THEY ARE TO BE DESIGNED TO SUPPORT ANY "A" ROOFS AND/OR DORMERS SHOWN ON THE PLAN, AND THE SNOW LOADS THAT ARE IN EFFECT AT THE TIME OF CONSTRUCTION, IN THE TOWN THAT THIS PROJECT IS TO BE BUILT IN.  
 THE TRUSSES ARE TO BE BOTTOM CORD SUPPORT TRUSSES FOR BETTER INSULATION ABOVE THE WALLS. SEE CIRCLED DETAIL ON THE TRUSS EAVE BELOW.  
 IF THE C.E.O. WANTS THE TOWN SNOW LOAD ON THE PLANS, THE BUILDER, OWNER OR C.E.O. MAY ADD IT HERE.

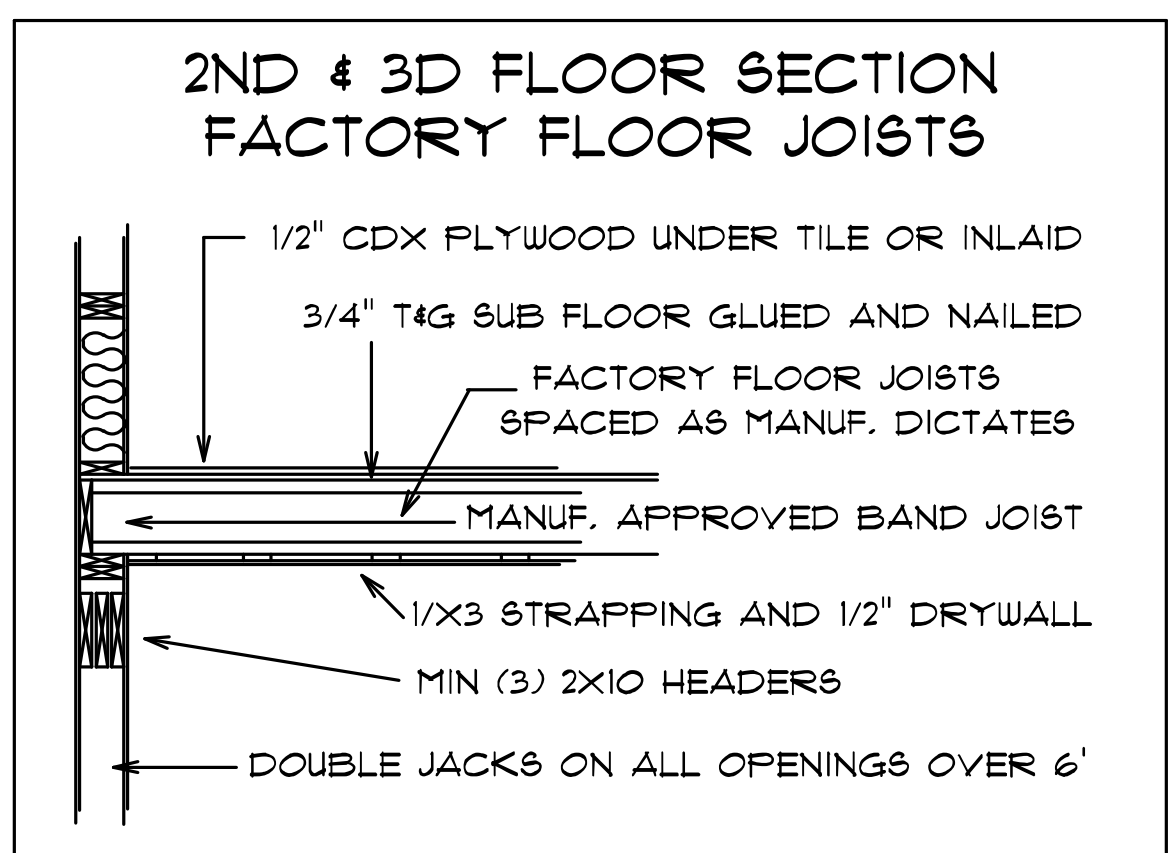
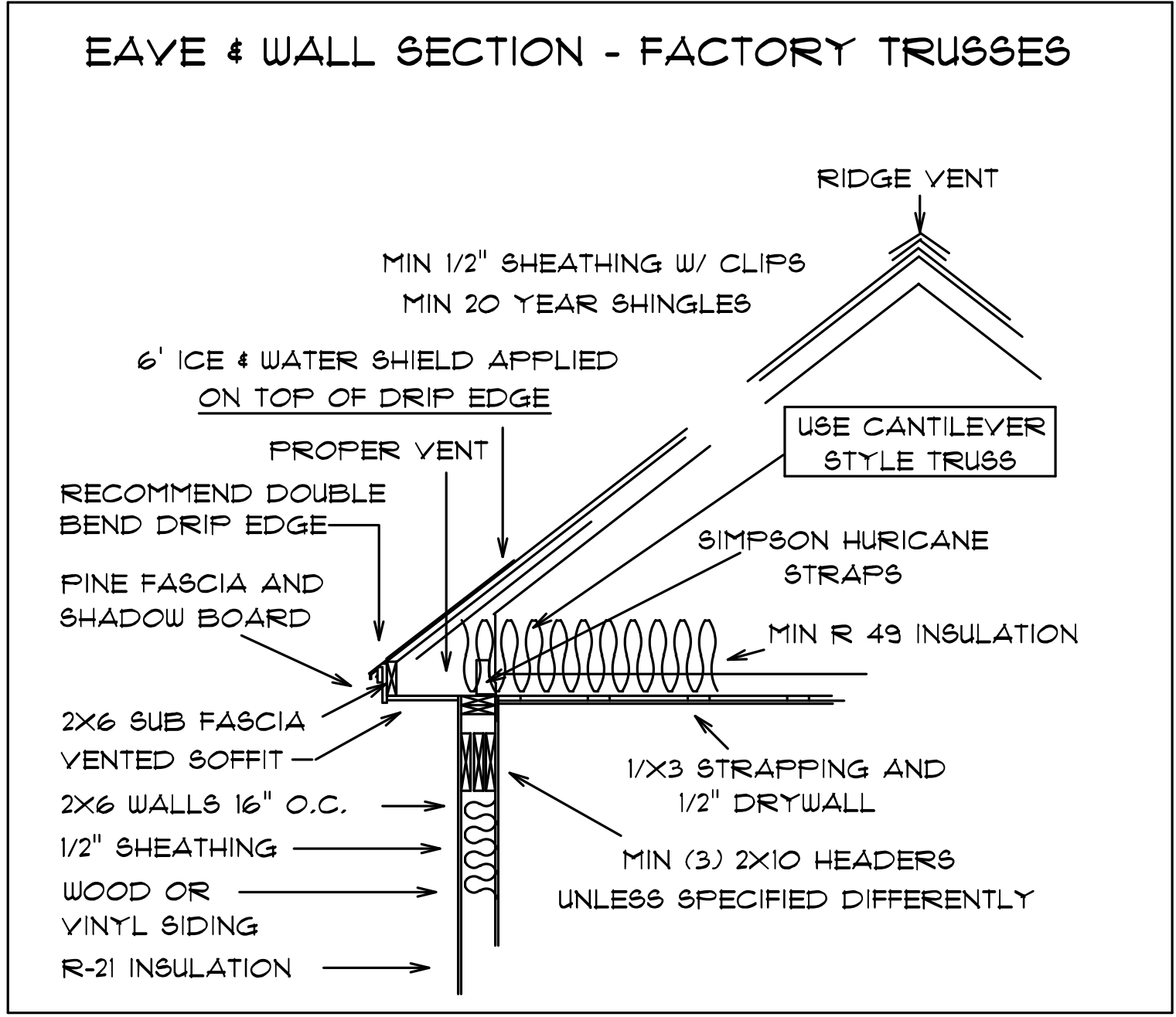
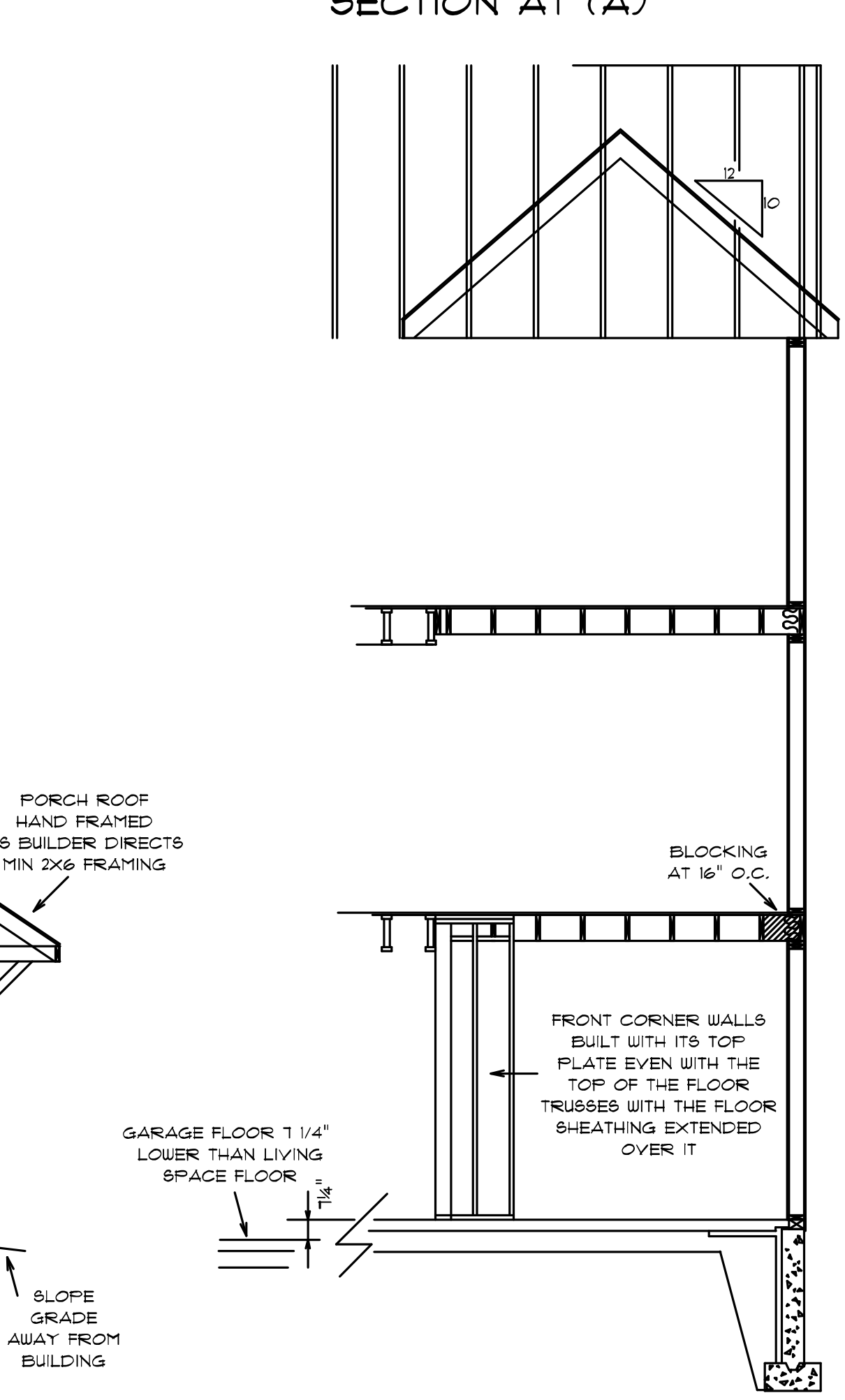
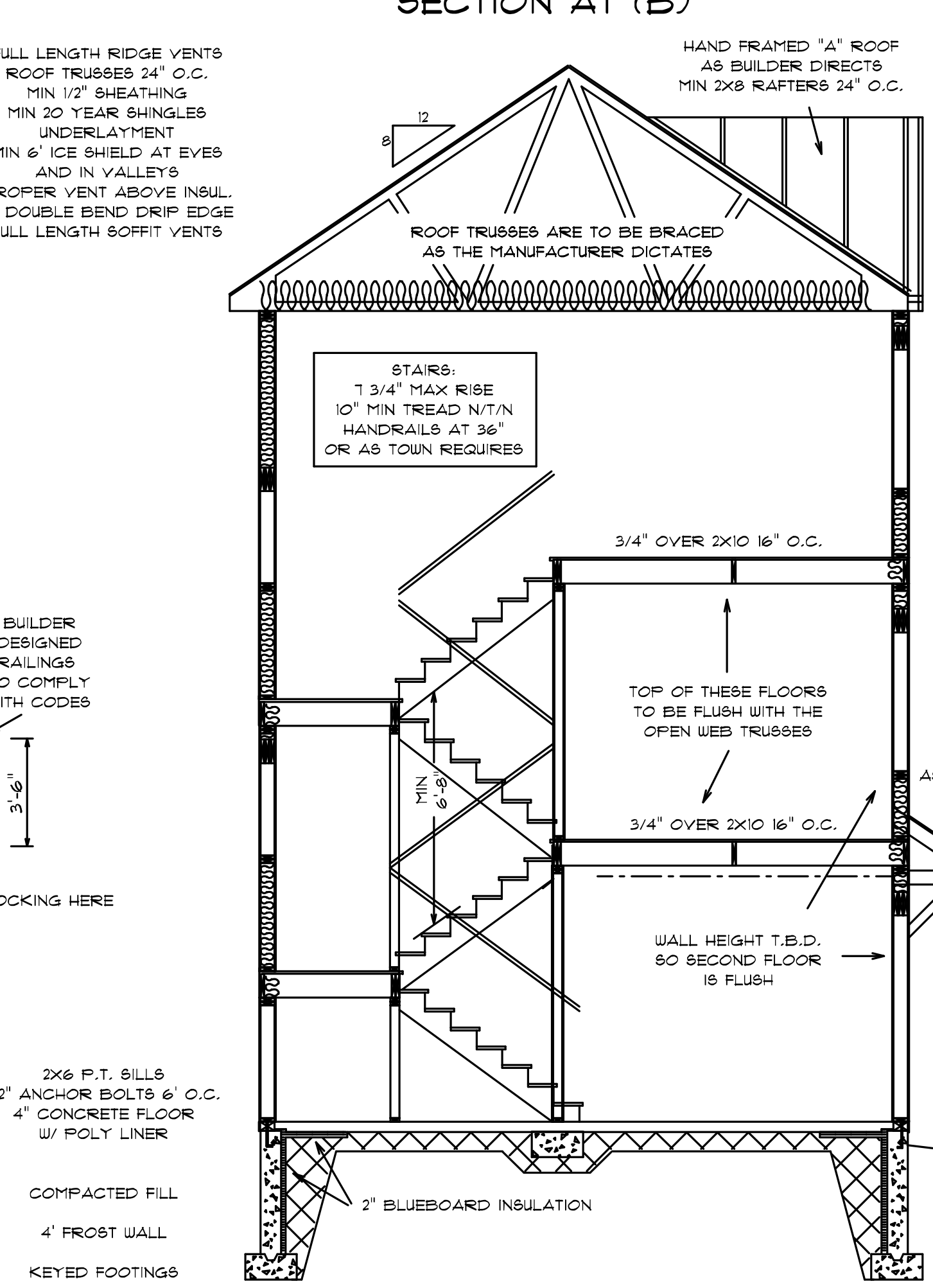
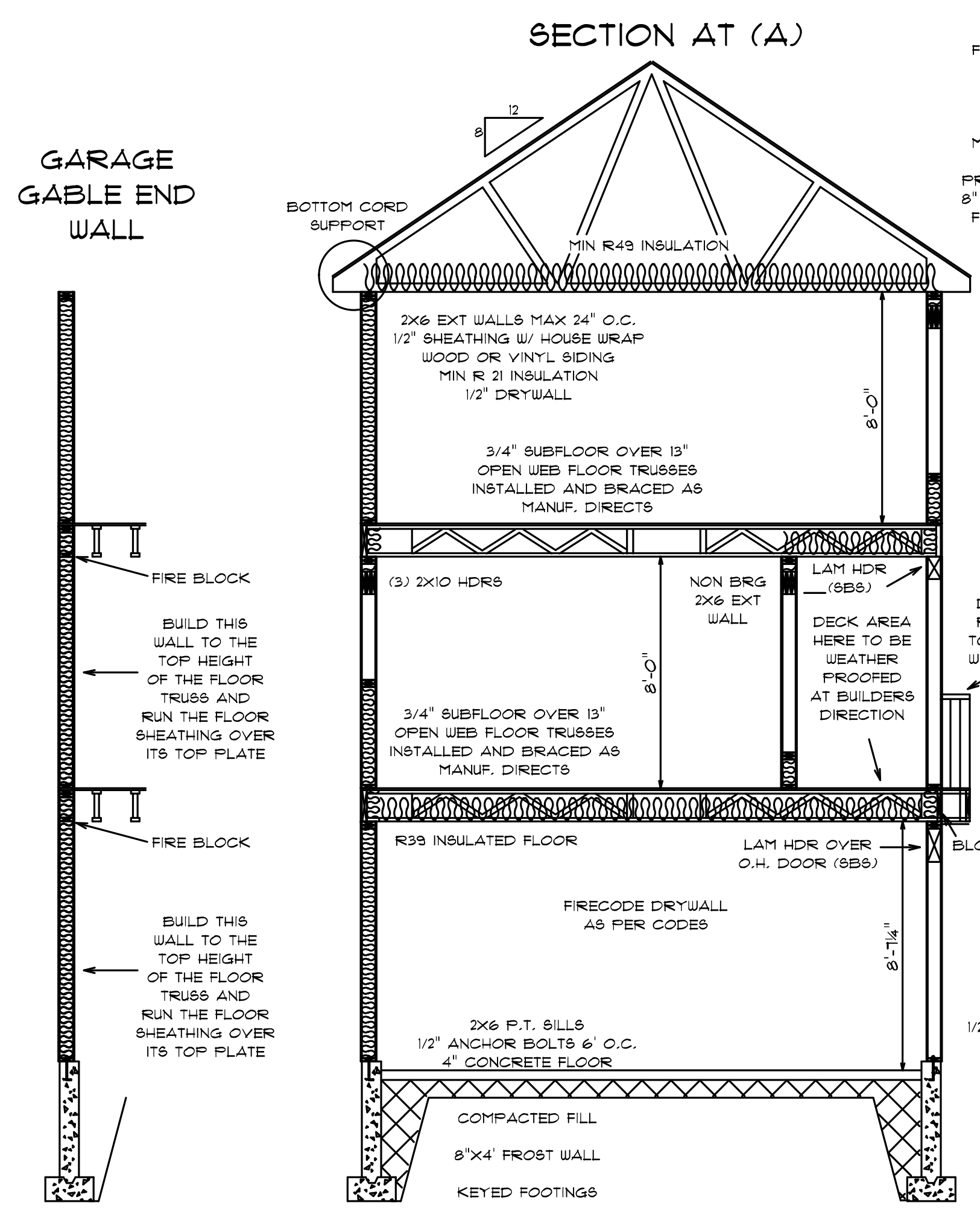

BUILDER TO GO OVER PLANS AND SECTIONS BEFORE CONSTRUCTION AND VERIFY THAT THEY ARE SUITABLE FOR HIS NEEDS. IF THERE ARE ANY QUESTIONS PLEASE CONTACT J.C.D.

ALL FRAMING AND SHEATHING TO BE FASTENED ACCORDING TO 2009 I.R.C. CODES TABLE R602.3 (1) & (2)

DETAILS NOT TO SCALE

