

**THIRD FLOOR FRAMING PLAN**  
1/8"=1'-0"

- NOTES**
1. TOP OF WOOD SHEATHING EL. 45'-2 1/2"
  2. TOP OF STEEL EL. 49'-0 1/4"
  3. INDICATES SPAN DIRECTION OF 3/4" THICK ADJUSTED SHEATHING. STAGGER JOINTS OF SHEATHING FASTEN TO TRUSSES W/ CONSTRUCTION.
  4. FLOOR TRUSSES TO BE DESIGNED PER FLOOR DESIGN LOADS AS NOTED IN GENERAL NOTES. DWG S1.0. SEE TRUSS LAYOUT PLAN S1.8 FOR ADD. INFO.
  5. GROSS WALL CORNER FRAMING LAYOUT/MECHANICAL AND LUMBERING CHANGES. SEE DWG S1.0 FOR ADD. INFO.
  6. EXTERIOR WALLS SHALL BE SHEATHED W/ 1/2" APA RATED SHEATHING. FASTEN SCHEDULE BLOCK ALLS PANEL EDGES AT PANEL EDGES U.N.O. PER SHEATHING SCHEDULE.
  7. INDICATES WOOD PANEL SHEATHING. SEE SHEATHING SCHEDULE DWG S1.3.
  8. PROVIDE END NUTS FOR WOOD PANEL EDGES. SEE SHEATHING SCHEDULE DWG S1.3.
  9. DETAILS DWG S2.1 FOR ADD. INFO.
  10. SEE S1.3 FOR TRUSS BRACING WALL FRAMING. SEE SCHEDULE DWG S1.5 FOR ADDITIONAL INFO & DETAILS.
  11. ADDITIONAL INFO & DETAILS.

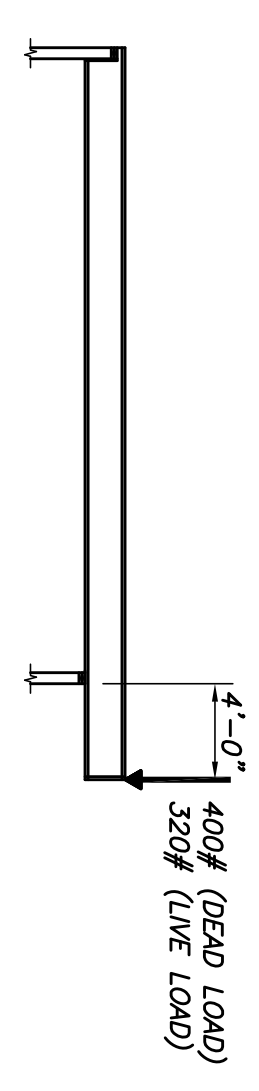

- NOTES**
1. LOADS INDICATED ARE IN ADDITION TO LOADS SPECIFIED IN THE GENERAL NOTES, DWG S1.0.
  2. TRUSS DESIGNER SHALL PROVIDE DOCUMENTATION OF TRUSS DESIGN.
  3. SEE PLAN FOR CANTILEVERED TRUSS LOCATIONS.

