

EXISTING SITE CONDITIONS
SCALE: 1'-20'-0"

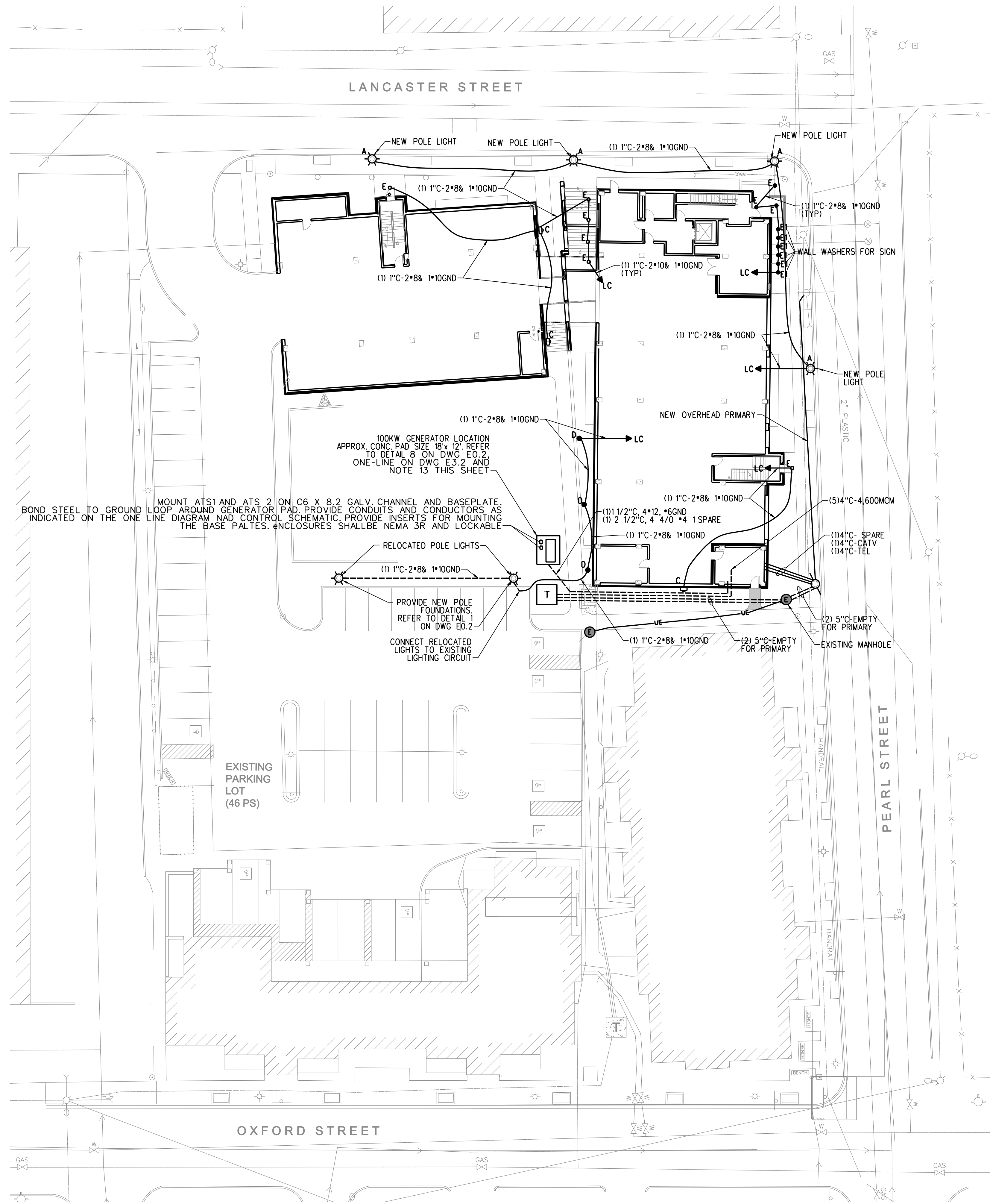

SITE CONDITIONS
SCALE: 1'-20'-0"

GENERAL NOTES - SITE ELECTRICAL

1. THE COMPLETE INSTALLATION SHALL CONFORM WITH ALL APPLICABLE FEDERAL, STATE AND LOCAL LAWS, CODES AND ORDINANCES, INCLUDED BUT NOT LIMITED TO APPROVED EDITIONS OF THE FOLLOWING: NATIONAL ELECTRICAL SAFETY CODE (ANSI C22); NATIONAL ELECTRICAL CODE (NFPA 70); OCCUPATIONAL SAFETY AND HEALTH ACT (OSHA) AND ALL AMENDMENTS THERETO. NOTHING CONTAINED IN THE DRAWINGS AND SPECIFICATIONS SHALL BE CONSTRUED TO CONFLICT WITH THESE LAWS, CODES, AND ORDINANCES, AND THEY ARE THEREBY INCLUDED IN THESE SPECIFICATIONS. OBTAIN PERMITS AND REQUEST INSPECTIONS FROM ALL AUTHORITIES HAVING JURISDICTION. COMPLY WITH ALL CMP, FAIRPOINT COMMUNICATIONS REGULATIONS AND STANDARDS.
2. THE FOLLOWING ELECTRICAL WORK SHALL BE PERFORMED UNDER THIS CONTRACT: UNDERGROUND CONDUIT, FITTINGS, AND ALL DEVICES; PROVISION OF HAND HOLES, NEW LIGHTING FIXTURES, POLES WITH ALL ACCESSORIES INCLUDING ANCHOR BOLTS AND POLE BASES; PROVISION OF UNDERGROUND CONDUIT AND WIRE TO SERVE NEW LIGHTING EQUIPMENT AND RECEPTACLES; PROVISION OF SERVICE EQUIPMENT INCLUDING OUTDOOR CABINETS, GROUNDING, METER ENCLOSURES, AND WEATHERPROOF RECEPTACLES.
3. CMP (ELECTRICAL UTILITY) SHALL PROVIDE ALL ASSOCIATED OVERHEAD AND UNDERGROUND PRIMARY WIRING, PRIMARY TERMINATIONS, PAD MOUNT TRANSFORMER, AND CONNECTIONS TO EXISTING OVERHEAD LINES.

4. PROVIDE UNDERGROUND ELECTRICAL WARNING TAPE: 6" WIDE PLASTIC TAPE, COLORED RED WITH SUITABLE LEGEND DESCRIBING BURIED ELECTRICAL LINES FOR ALL UNDERGROUND CONDUITS. LOCATE 6 INCHES BELOW THE FINISHED GRADE.
5. REFER TO CIVIL DRAWINGS FOR EXCAVATION AND BACKFILL OF ALL UNDERGROUND WORK.
6. EXISTING UTILITY LOCATIONS ARE APPROXIMATE AND SHALL BE FIELD VERIFIED. CONTRACTORS SHALL CONTACT DIG SAFE BEFORE BEGINNING ANY EXCAVATIONS.
7. FINAL LOCATION OF UTILITIES MAY VARY FROM PLANS PENDING UTILITY COMPANY FIELD COORDINATION.
8. SEE DWG. E1.0A FOR ADDITIONAL SITE DETAILS.
9. THE LOCAL TELEPHONE SERVICE PROVIDER AND THE CABLE TV COMPANY SHALL PROVIDE AND INSTALL ALL THE SITE UTILITY SERVICE CABLE TO NEW ELECTRICAL ROOM BACKBOARD IN THE CONDUITS PROVIDED AS PART OF THE SITE WORK.
10. OBTAIN THE SERVICES OF DIG SAFE TO CONFIRM LOCATIONS OF EXISTING UTILITIES.
11. UNDERGROUND CONDUIT SHALL BE SCHED 40 PVC. ABOVE GRADE CONDUIT SHALL BE RGS. ALL CONDUIT SWEEPS SHALL BE RGS LONG SWEEPS.
12. PROVIDE EXPANSION FITTINGS FOR ALL UNDERGROUND CONDUIT CONNECTED TO ABOVE GROUND STRUCTURES.

13. GENERATOR PAD GROUNDING: PROVIDE (2) 3/4"x 8' LONG GROUND RODS AT OPPOSITE CORNERS OF GENERATOR PAD. PROVIDE 3/0CU GROUND LOOP AROUND PAD. RUN GROUND CABLE TO MAIN SWITCHGEAR. VERIFY GROUNDING REQUIREMENTS WITH GENERATOR MANUFACTURER PRIOR TO INSTALLING.
14. PROVIDE A LISTED INTERSYSTEM BONDING TERMINAL AT THE SERVICE ENTRANCE IN ACCORDANCE WITH NFPA 70, 250.94
15. SEE ONE LINE DIAGRAM ON DRAWING E3.2.

Symbol	Label	Catalog Number	Description	Lamp	File	Lumens	LLF	Watts
○	A	ESU75MH00X4	Holophane- ESPLANDE	175W CLEAR MH- pulse start metal halide	ESU75MH00X 4.ies	14400	0.64	175
□	C	RD1-84F8-WT	BLACK ARCHITECTURAL WALL PACK, MOUNTED AS INDICATED ON ARCHITECTURAL ELEVATIONS. INTEGRAL PHOTO CONTROL.	TWO 42W CF 300K HORIZONTAL POSITION.				
●	D	H101-50M-FT	Holophane- DISTRIBUTION WITH COATED 50W MH ED-17 PROTECTED FROM 100W MH LAMP	50 watt metal halide-coated lamp	H101_H102-50M-FT.ies	3200	0.61	50
○	E	LGHZ 32W TT CFL	RECESSED DOWNLIGHT WITH WHITE REFLECTOR, FFL LENS WITH WHITE SPLAY AND COLD WEATHER BALLAST LAMPS IN THE HORIZONTAL POSITION.	TWO 32W TT	LGHZ_70M_6R_W_FFL.ies	4700	0.61	70

FOR MOUNTING HEIGHTS OF WALL MOUNTED LIGHTS REFER TO ARCHITECTURAL DRAWINGS.

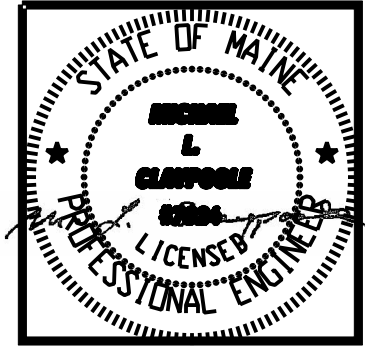
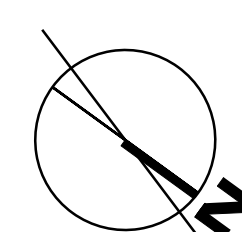

JOB NO. 10-020

DRWN: CHK: twg WBSJR

SCALE: AS NOTED

ISSUE: August 3, 2011 For Bid

TITLE: SITE LIGHTING PLAN

SHEET

E0.1