

KITCHEN LAYOUT	ACCESSIBILITY TYPE (ICCA/ANCI 117.1)	ROOM NUMBER
1	TYPE A	101, 201, 301, 401
2	TYPE A	107, 109, 207, 209, 307, 309, 407, 409
	TYPE B	102, 103, 106, 113, 114, 202, 203, 206, 213, 214, 302, 303, 306, 313, 314, 402, 403, 406, 413, 414
3	TYPE B	204
4	TYPE A	405
	TYPE B	105, 205, 305
5	TYPE A	100
6	TYPE B	111, 211, 311, 411
7	TYPE B	112, 212, 312, 412
8	TYPE B	208, 308, 408
9	TYPE A	110, 210, 310, 410
10	TYPE B	304, 404

GENERAL NOTES:

- GC RESPONSIBLE FOR OPP. HAND COORDINATION.
- AT ALL CABINETS IDENTIFIED AS REMOVABLE, ALL SURFACES THAT MAY EVENTUALLY BE EXPOSED SHALL BE COMPLETELY FINISHED (PAINT, WALL BASE, PIPING INSULATION KITS, ETC.) PRIOR TO PLACEMENT OF CABINETRY.
- FRONT INSIDE EDGE OF ALL COUNTERTOPS TO BE FULL RADIUS (BULLNOSE). FINISH COUNTER EDGE WITH 1/2" X COUNTER DEPTH HARDWOOD STAINED TO MATCH CABINETRY.

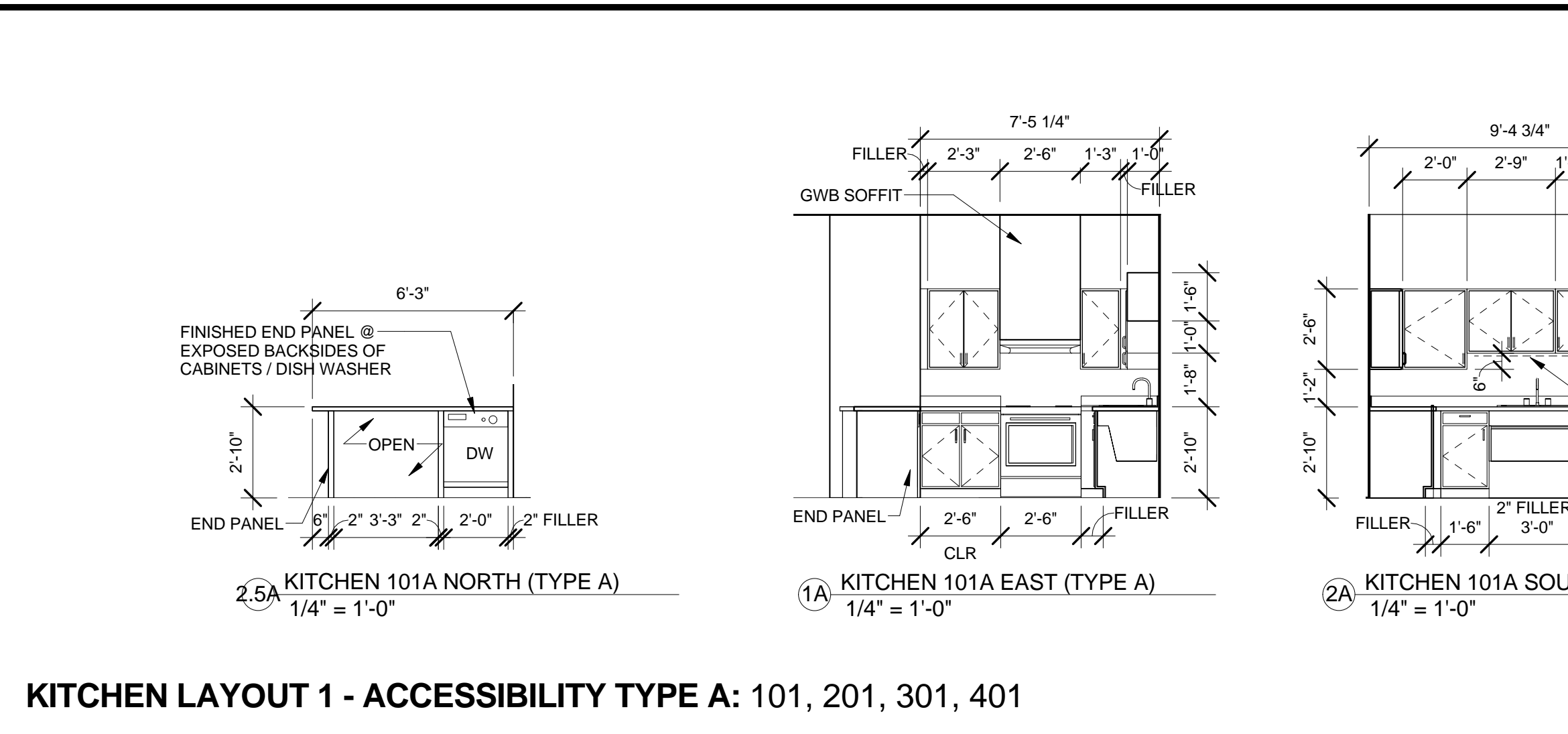

KITCHEN LAYOUT 1 - ACCESSIBILITY TYPE A: 101, 201, 301, 401

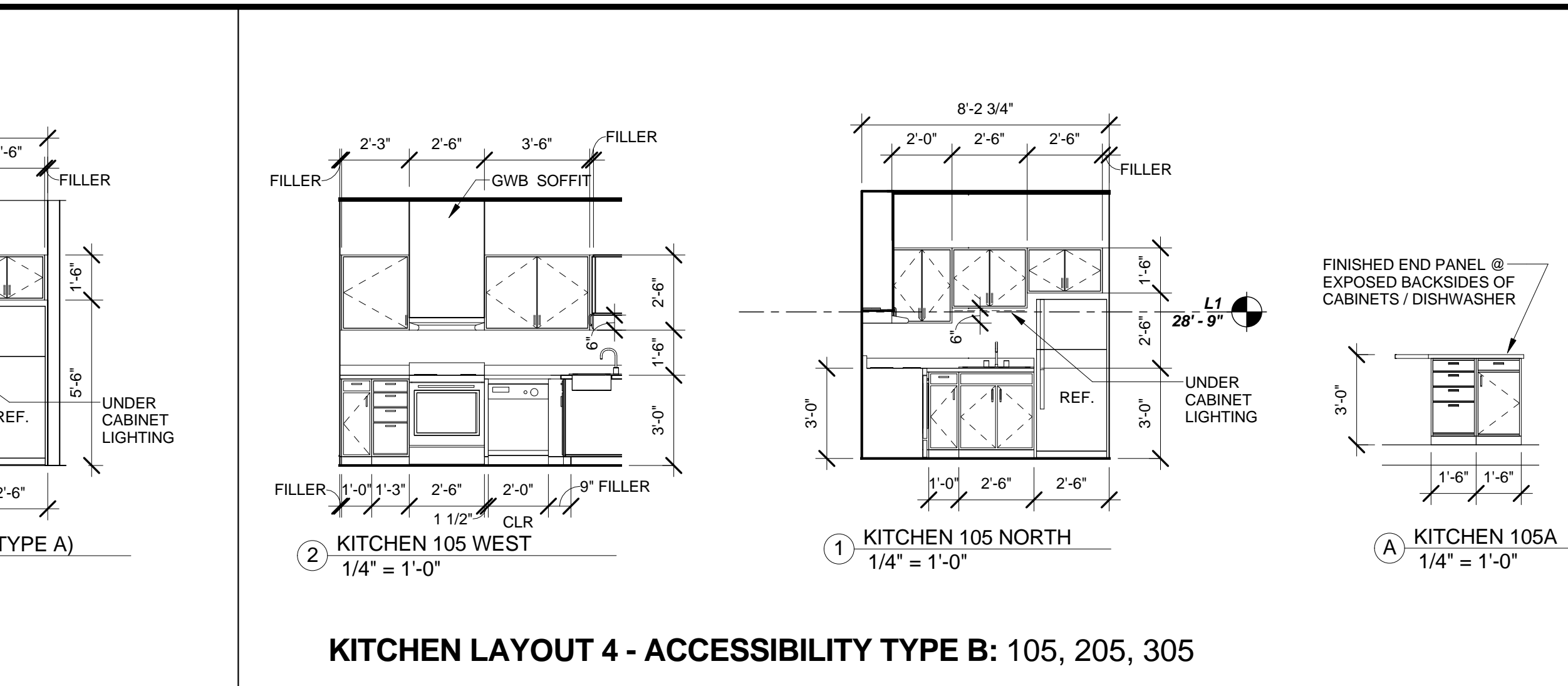

KITCHEN LAYOUT 4 - ACCESSIBILITY TYPE B: 105, 205, 305

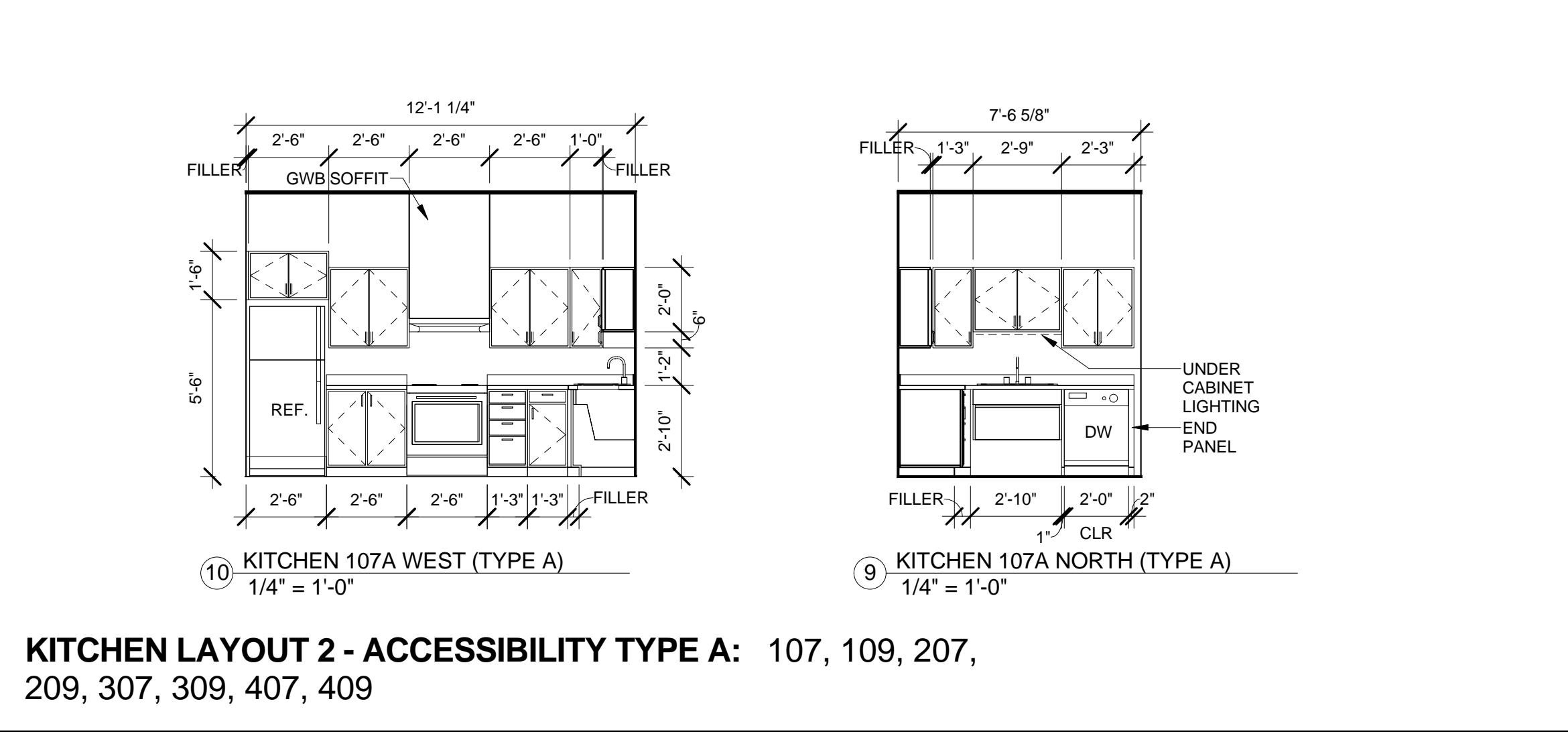

KITCHEN LAYOUT 2 - ACCESSIBILITY TYPE A: 107, 109, 207, 209, 307, 309, 407, 409

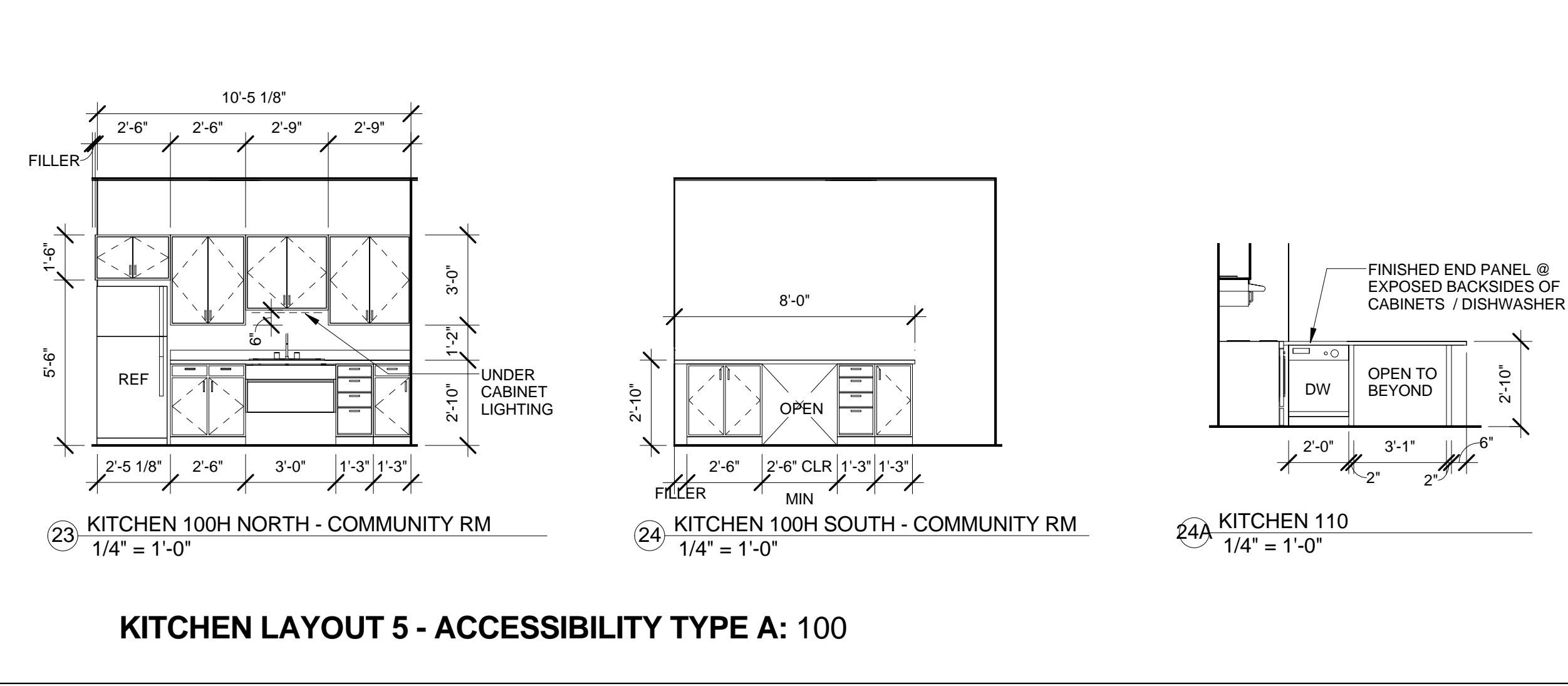

KITCHEN LAYOUT 5 - ACCESSIBILITY TYPE A: 100

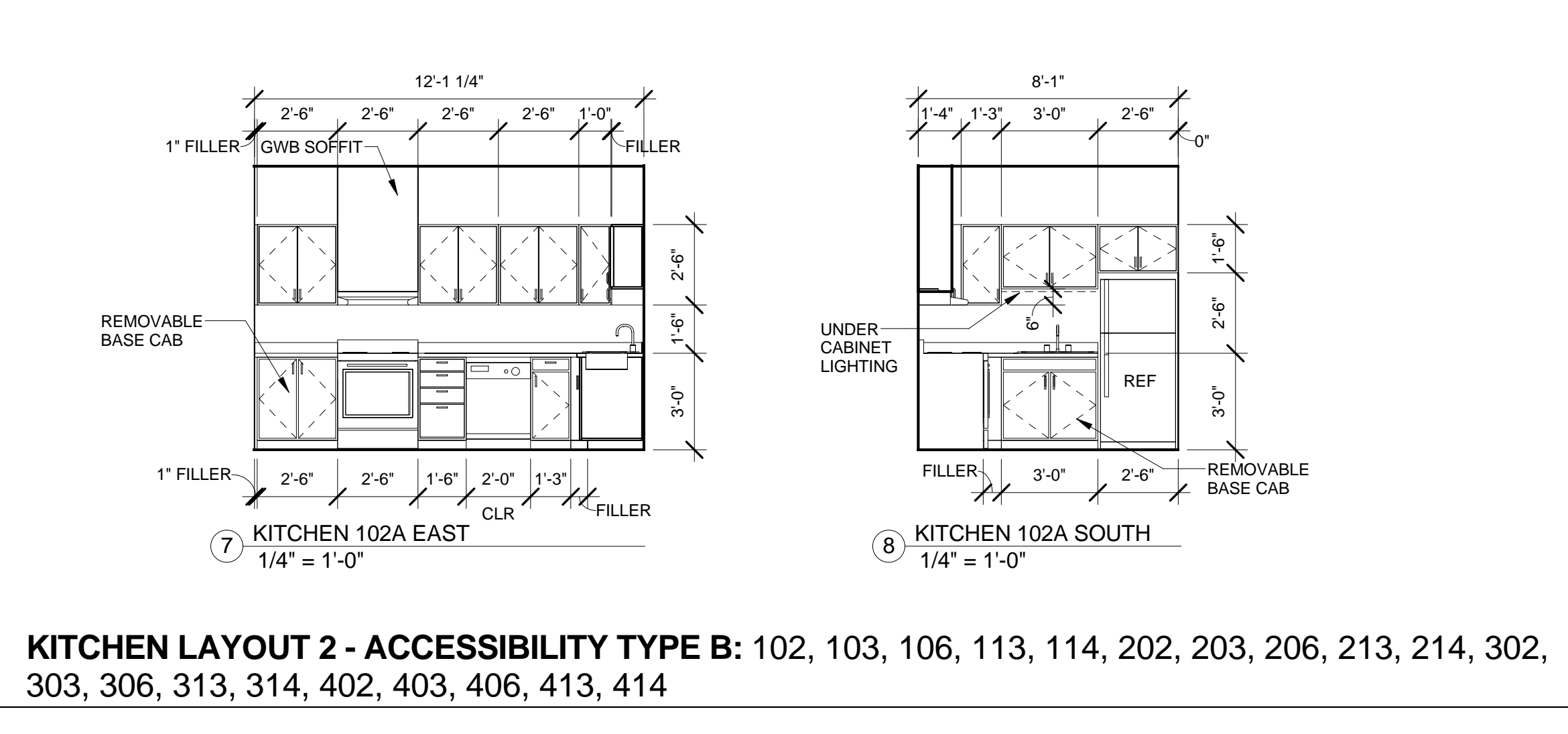

KITCHEN LAYOUT 2 - ACCESSIBILITY TYPE B: 102, 103, 106, 113, 114, 202, 203, 206, 213, 214, 302, 303, 306, 313, 314, 402, 403, 406, 413, 414

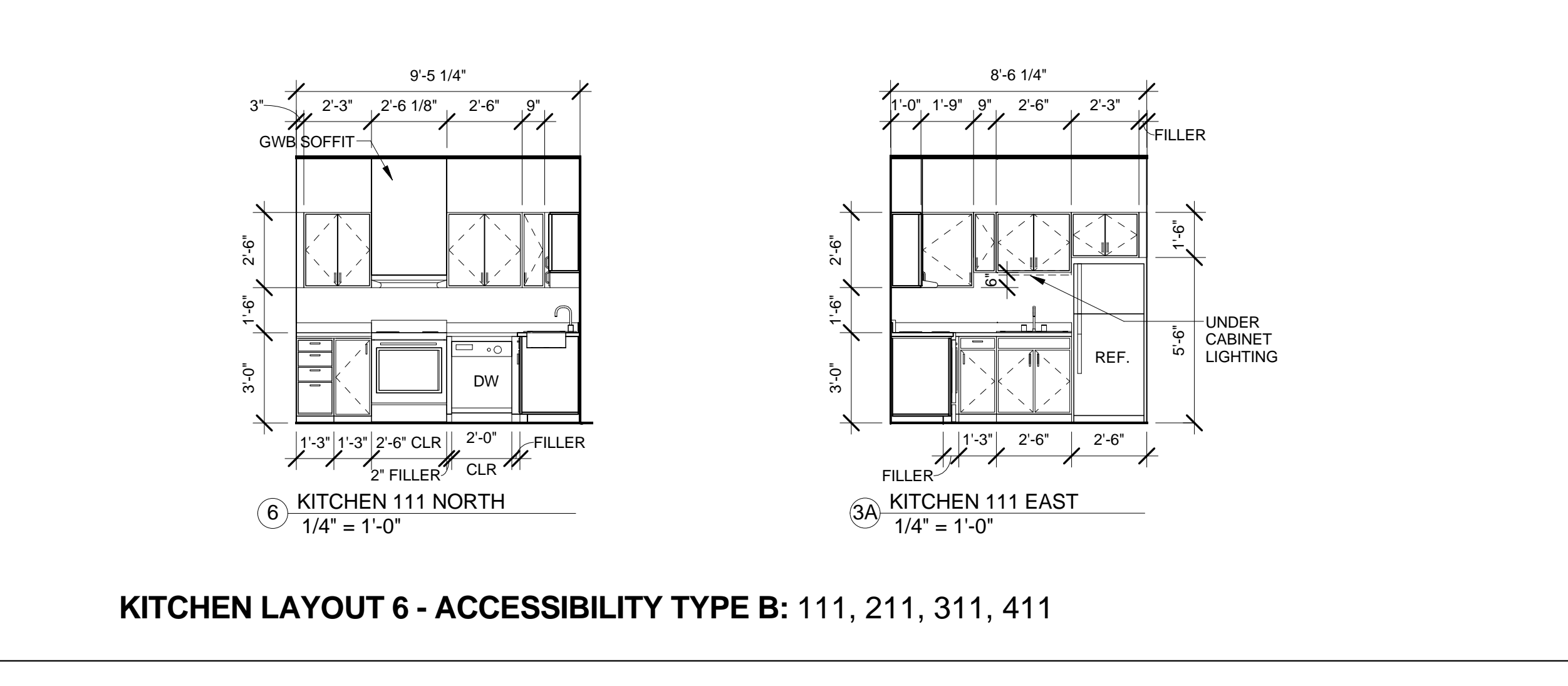

KITCHEN LAYOUT 6 - ACCESSIBILITY TYPE B: 111, 211, 311, 411

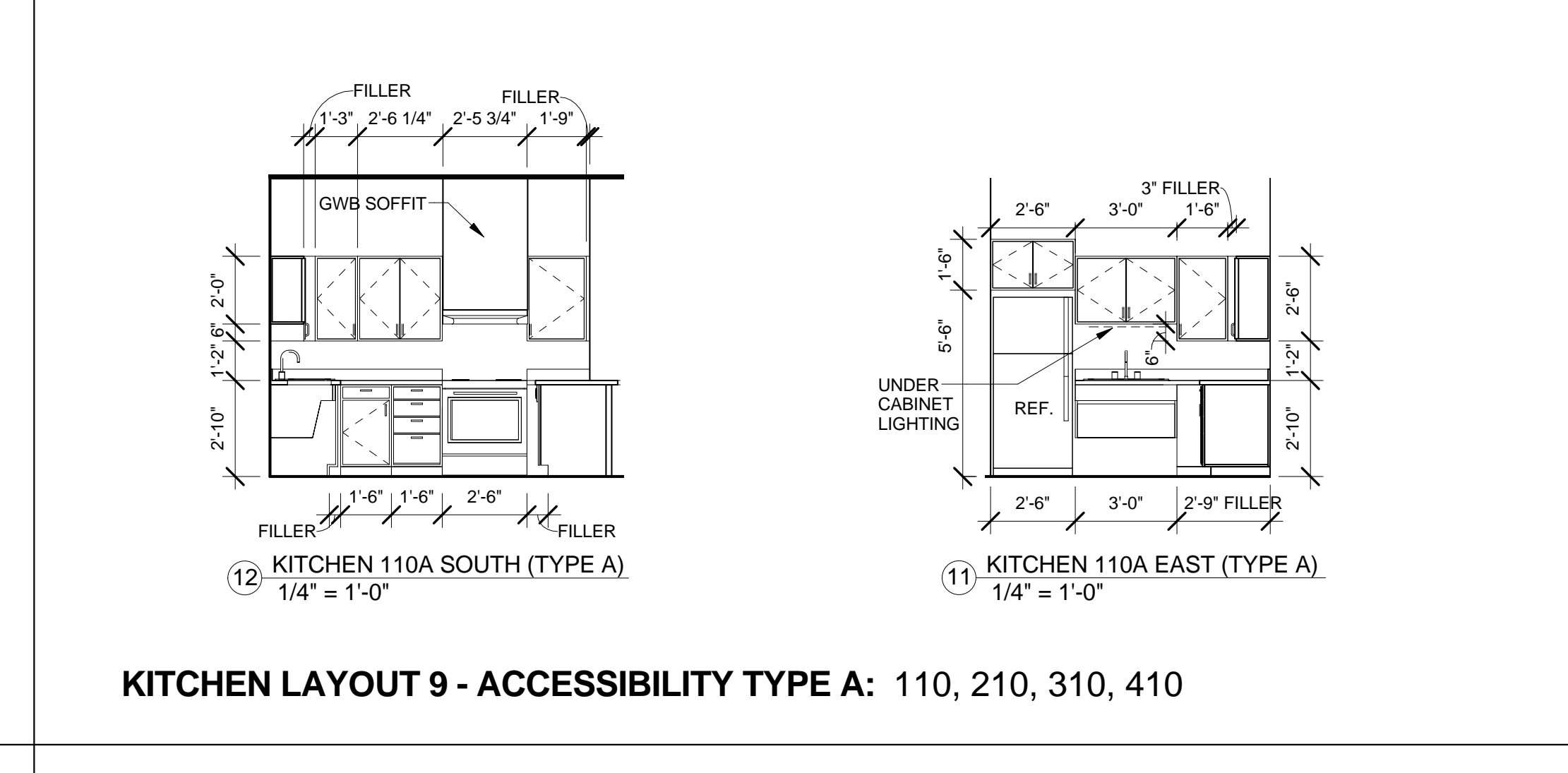

KITCHEN LAYOUT 9 - ACCESSIBILITY TYPE A: 110, 210, 310, 410

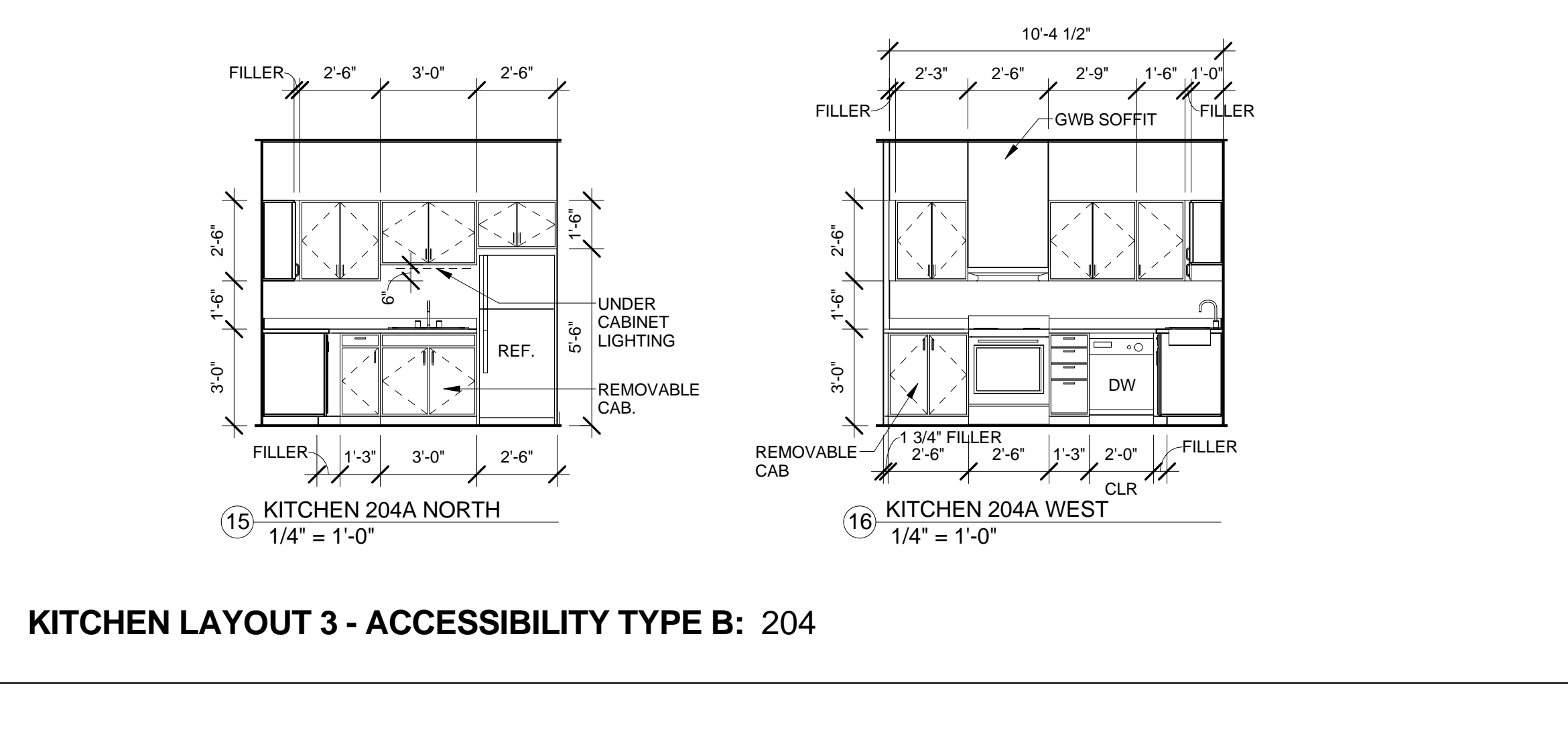

KITCHEN LAYOUT 3 - ACCESSIBILITY TYPE B: 204

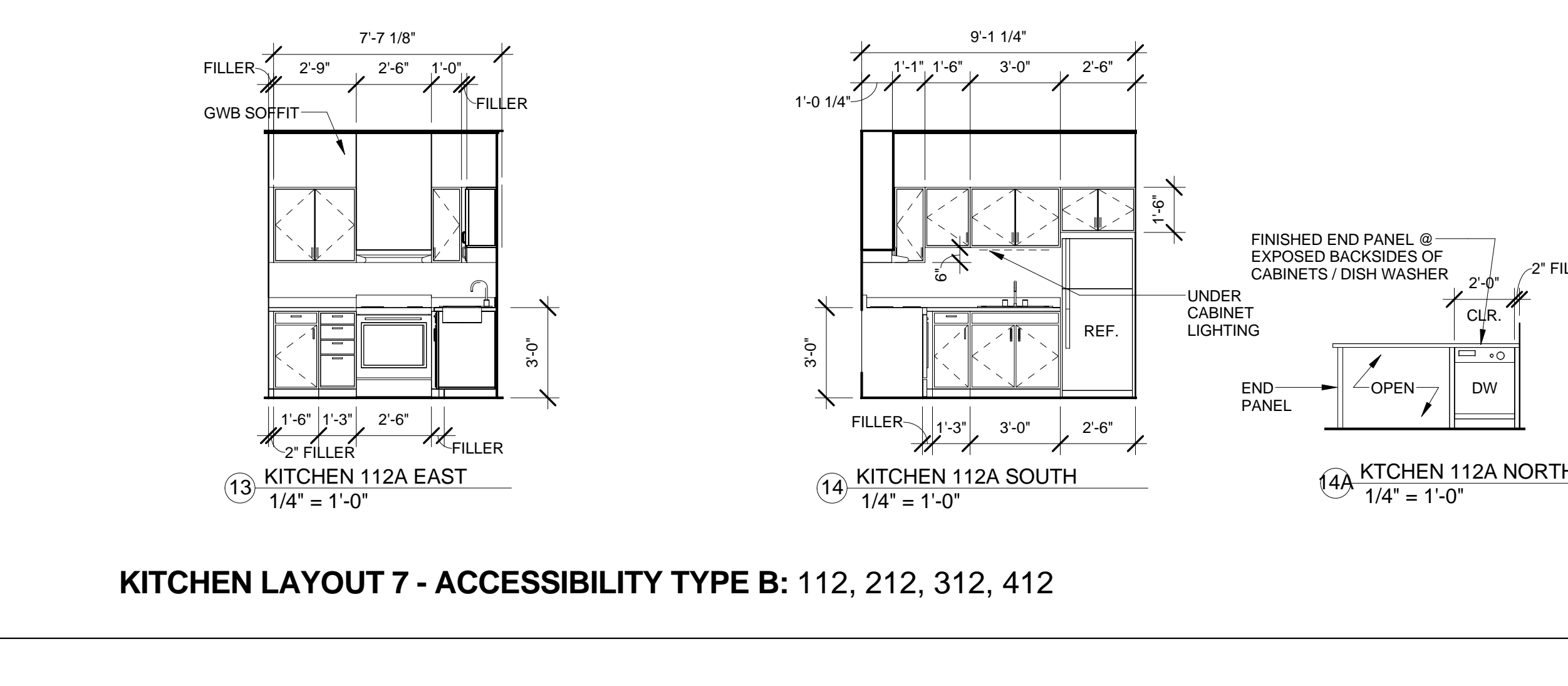

KITCHEN LAYOUT 7 - ACCESSIBILITY TYPE B: 112, 212, 312, 412

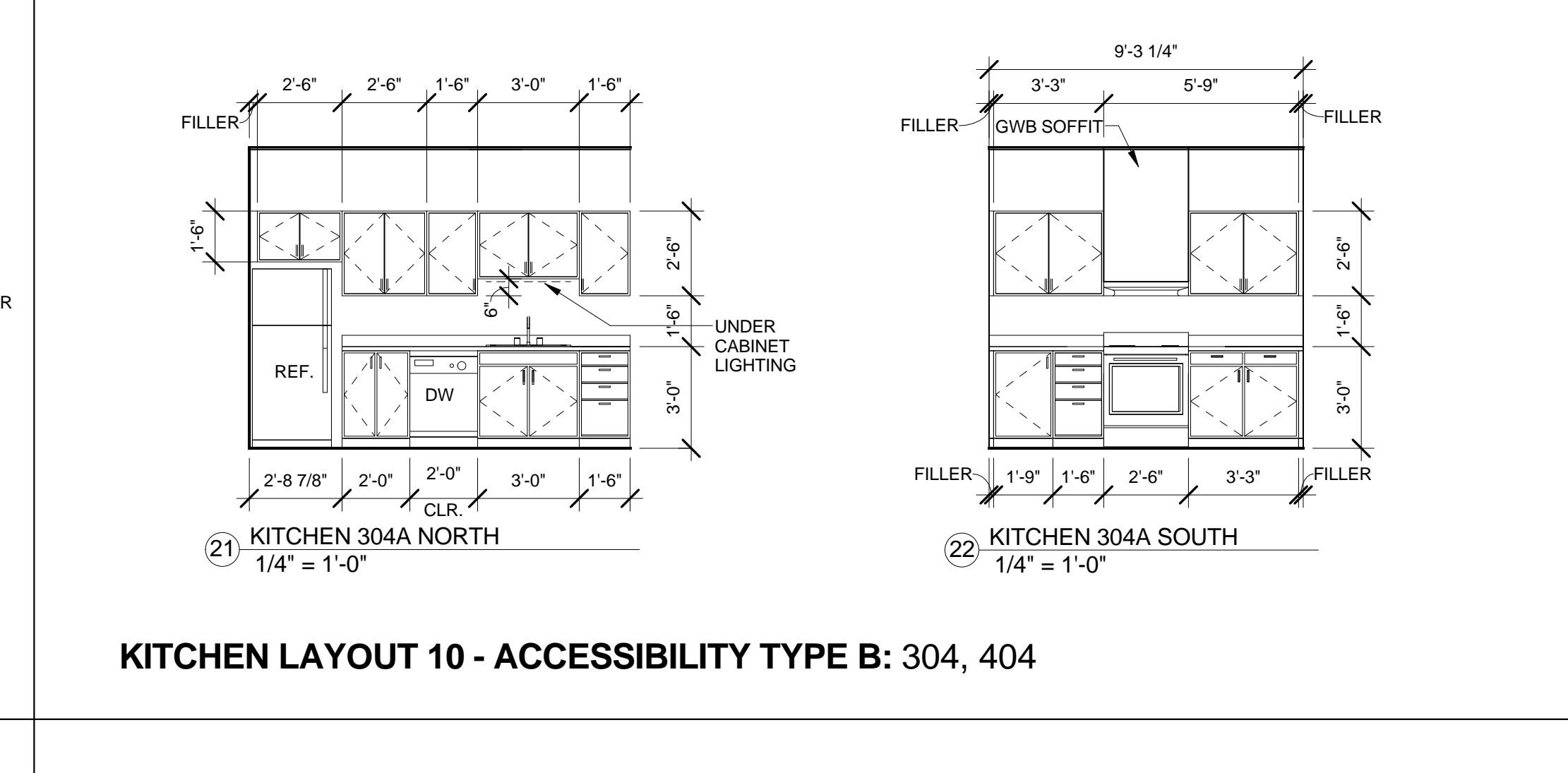

KITCHEN LAYOUT 10 - ACCESSIBILITY TYPE B: 304, 404

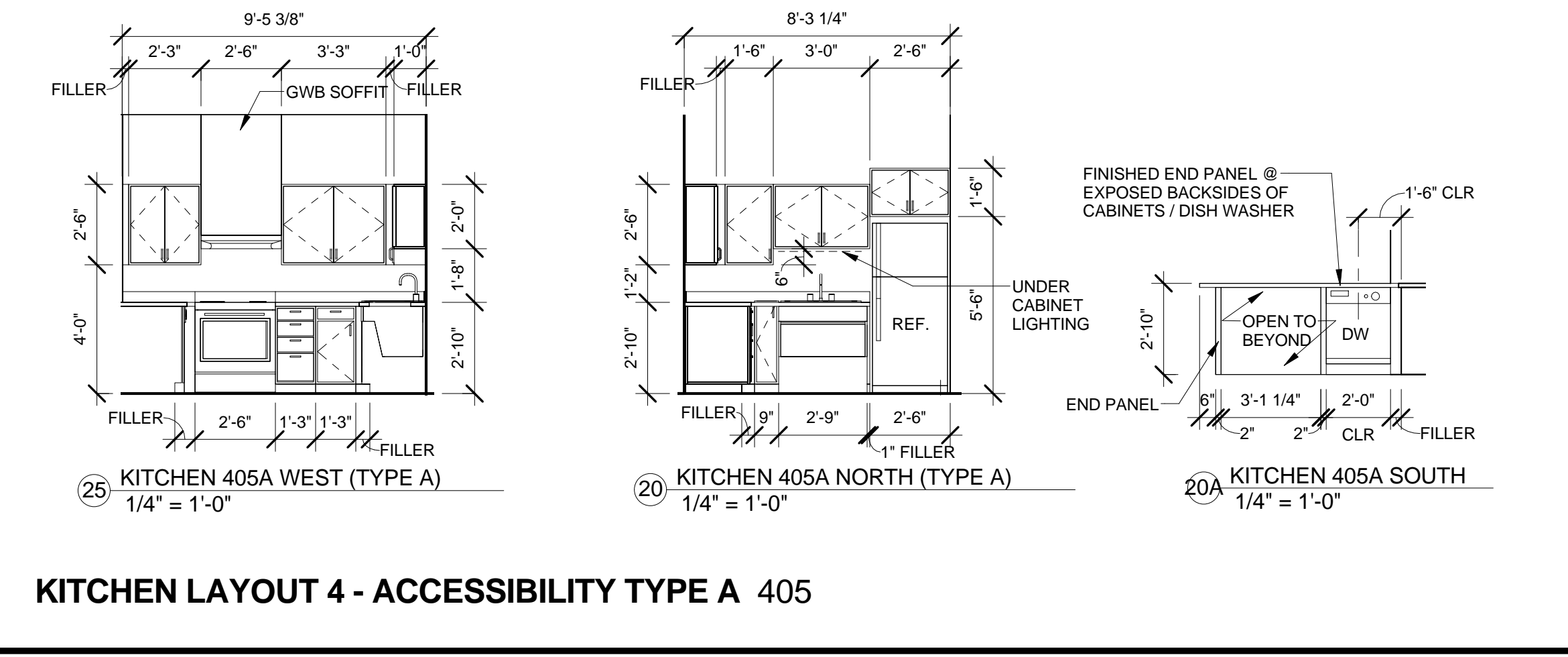

KITCHEN LAYOUT 4 - ACCESSIBILITY TYPE A: 405

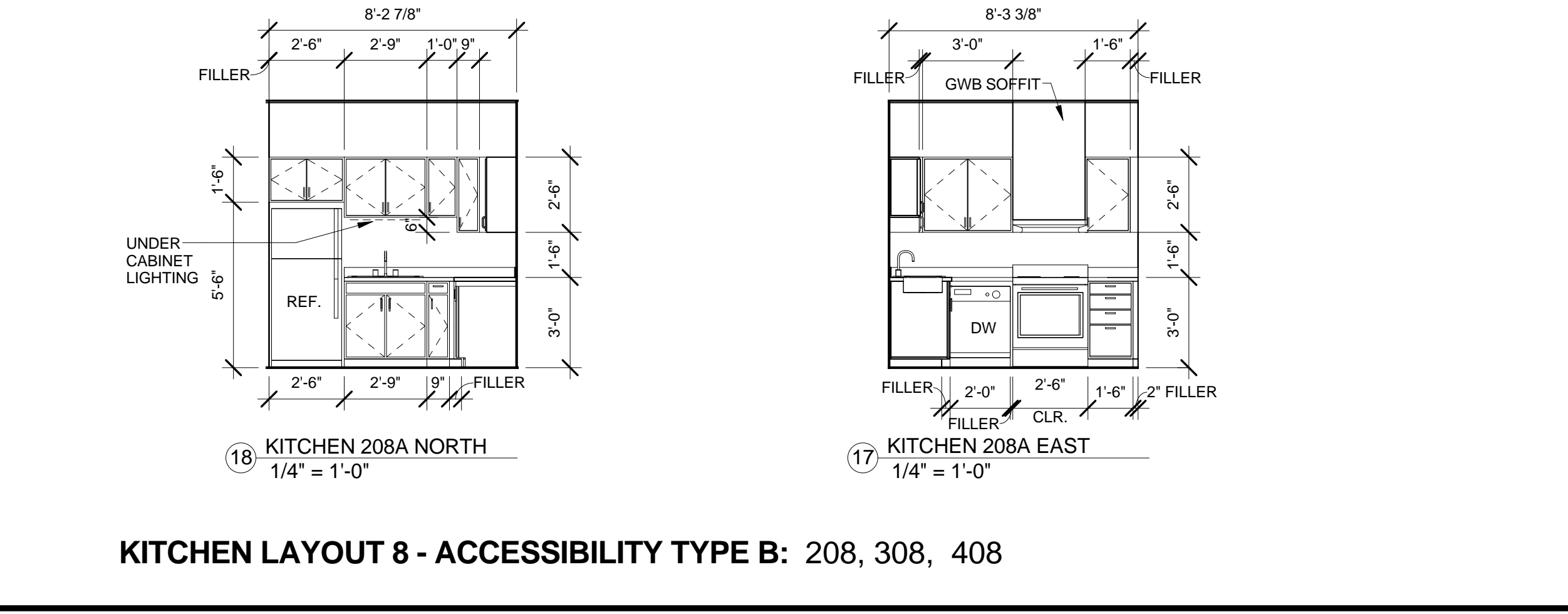

KITCHEN LAYOUT 8 - ACCESSIBILITY TYPE B: 208, 308, 408

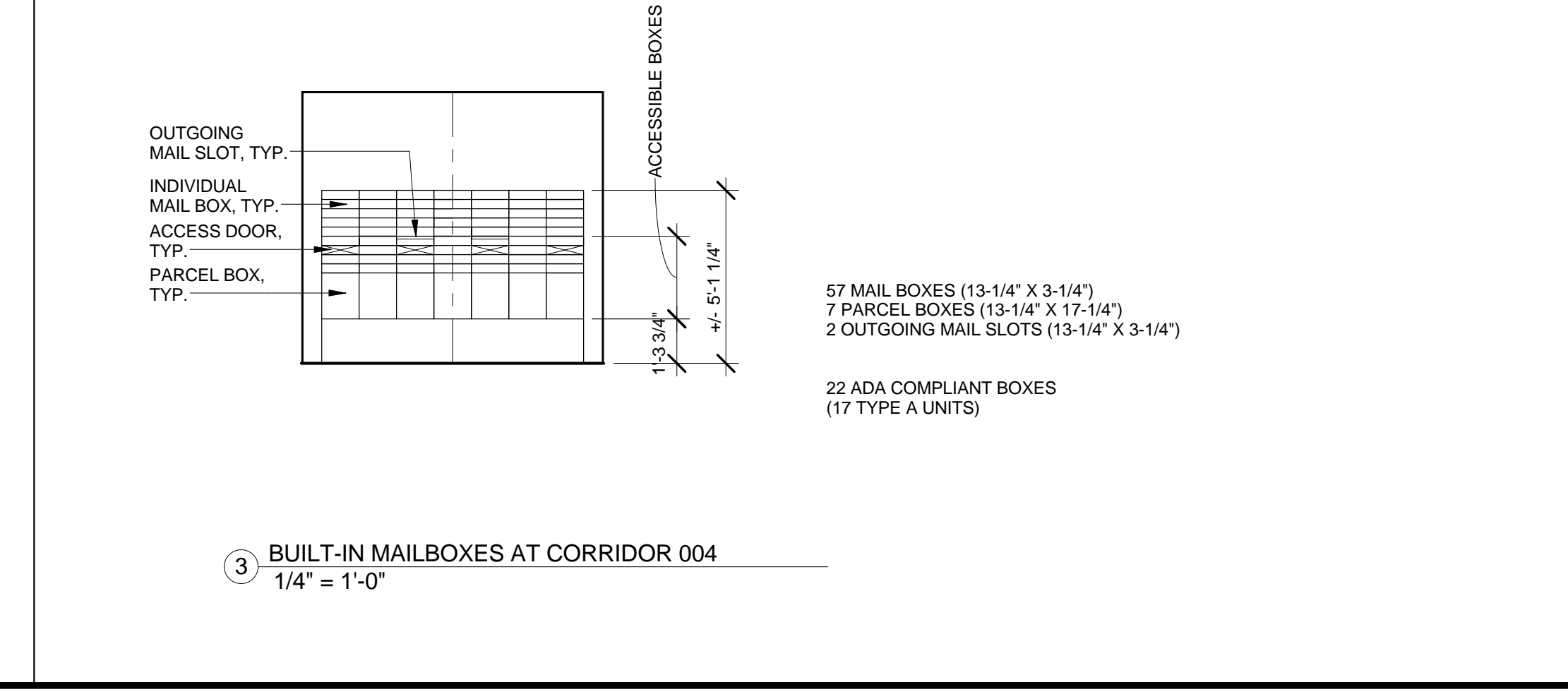

BUILT-IN MAILBOXES AT CORRIDOR 004
1/4" = 1'-0"



COPYRIGHT
PDT Architects
Reuse or reproduction of the contents of this document is not permitted without written permission of PDT Architects.

307 CUMBERLAND AVENUE
PORTLAND, MAINE 04101
www.avestahousing.org



Pearl Place 2
184 Pearl Street

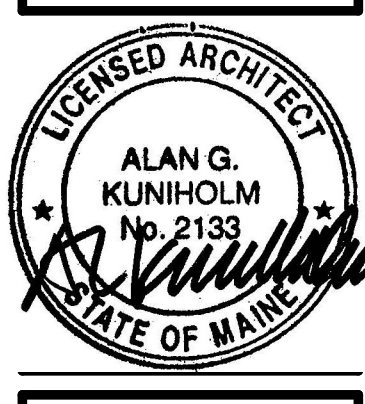

JOB NO. 10020
DRWN. CHK Checker
SCALE: 1/4" = 1'-0"
ISSUE 08/03/11
TITLE INTERIOR ELEVATIONS
SHEET A203