

DISPLAY THIS CARD ON PRINCIPAL FRONTAGE OF WORK
CITY OF PORTLAND

Please Read
Application And
Notes, If Any,
Attached

BUILDING INSPECTION
PERMIT

Permit Number: 061712

This is to certify that AVESTA HOUSING DEVELOPMENT CORPORATION/Agewo

has permission to Temporary Job Site Trailer 10' x 40'

AT 210 PEARL ST

026 E001001

PERMIT ISSUED

DEC 28 2006

provided that the person or persons who accept this permit shall comply with all of the provisions of the Statutes of the State and of the Ordinances of the City of Portland regulating the construction, maintenance and use of buildings and structures, and of the application on file in this department.

Apply to Public Works for street line and grade if nature of work requires such information.

Notification of inspection must be given and when permission procured before this building or part thereof is loaded or closed-in. 4 HOUR NOTICE IS REQUIRED.

A certificate of occupancy must be procured by owner before this building or part thereof is occupied.

OTHER REQUIRED APPROVALS

Fire Dept. Craig Cash

Health Dept. _____

Appeal Board _____

Other _____

Department Name

Jeanne Burke 12/1/06
 Director - Building & Inspection Services

PENALTY FOR REMOVING THIS CARD

City of Portland, Maine - Building or Use Permit Application

389 Congress Street, 04101 Tel: (207) 874-8703, Fax: (207) 874-8716

Permit No: 06-1712	Issue Date:	CBL: 026 E001001
-----------------------	-------------	---------------------

Location of Construction: 210 PEARL ST	Owner Name: AVESTA HOUSING DEVELOPM	Owner Address: 307 CUMBERLAND AVE	Phone:
Business Name:	Contractor Name: Ledgewood Construction	Contractor Address: 27 Maine St. So. Portland	Phone 2077671866
Lessee/Buyer's Name	Phone:	Permit Type: Commercial	Zone: B-7
Past Use: Vacant land -Connected w/ permit#061496 New 60 rental housing units	Proposed Use: Temporary Job Site Trailer 10' x 40'	Permit Fee: \$30.00	Cost of Work: \$30.00
		FIRE DEPT: <input checked="" type="checkbox"/> Approved <input type="checkbox"/> Denied	CEO District: 1
Proposed Project Description: Temporary Job Site Trailer 10' x 40'		INSPECTION: Use Group: <i>Temp Trailer</i> Type:	
		Signature: <i>Greg Case</i>	Signature: <i>AMB 12/1/06</i>
PEDESTRIAN ACTIVITIES DISTRICT (P.A.D.)			
Action: <input type="checkbox"/> Approved <input type="checkbox"/> Approved w/Conditions <input type="checkbox"/> Denied			
		Signature:	Date:

Permit Taken By: Idobson	Date Applied For: 11/28/2006	Zoning Approval
-----------------------------	---------------------------------	------------------------

- This permit application does not preclude the Applicant(s) from meeting applicable State and Federal Rules.
- Building permits do not include plumbing, septic or electrical work.
- Building permits are void if work is not started within six (6) months of the date of issuance. False information may invalidate a building permit and stop all work..

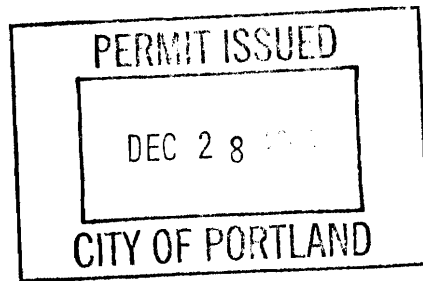

Special Zone or Reviews <input type="checkbox"/> Shoreland <input type="checkbox"/> Wetland <input type="checkbox"/> Flood Zone <input type="checkbox"/> Subdivision <input type="checkbox"/> Site Plan Maj <input type="checkbox"/> Minor <input checked="" type="checkbox"/> (MM) Date: <i>11/28/06</i>	Zoning Appeal <input type="checkbox"/> Variance <input type="checkbox"/> Miscellaneous <input type="checkbox"/> Conditional Use <input type="checkbox"/> Interpretation <input type="checkbox"/> Approved <input type="checkbox"/> Denied Date:	Historic Preservation <input checked="" type="checkbox"/> Not in District or Landmark <input type="checkbox"/> Does Not Require Review <input type="checkbox"/> Requires Review <input type="checkbox"/> Approved <input type="checkbox"/> Approved w/Conditions <input type="checkbox"/> Denied Date:
---	---	--

CERTIFICATION

I hereby certify that I am the owner of record of the named property, or that the proposed work is authorized by the owner of record and that I have been authorized by the owner to make this application as his authorized agent and I agree to conform to all applicable laws of this jurisdiction. In addition, if a permit for work described in the application is issued, I certify that the code official's authorized representative shall have the authority to enter all areas covered by such permit at any reasonable hour to enforce the provision of the code(s) applicable to such permit.

SIGNATURE OF APPLICANT	ADDRESS	DATE	PHONE
RESPONSIBLE PERSON IN CHARGE OF WORK, TITLE		DATE	PHONE



General Building Permit Application

If you or the property owner owes real estate or personal property taxes or user charges on any property within the City, payment arrangements must be made before permits of any kind are accepted.

Location/Address of Construction: <u>210 PEARL ST</u>		
Total Square Footage of Proposed Structure <u>400</u>		Square Footage of Lot
Tax Assessor's Chart, Block & Lot Chart# Block# Lot# <u>SEE PLAN</u>	Owner: <u>LEDGEWOOD CONSTRUCTION</u>	Telephone: <u>767-1866</u>
Lessee/Buyer's Name (If Applicable)	Applicant name, address & telephone: <u>27 MAIN ST S. PORTLAND, ME 04106</u>	Cost Of Work: \$ _____ Fee: \$ <u>30</u> C of O Fee: \$ _____
Current Specific use: <u>Vacant Land</u> If vacant, what was the previous use? _____ Proposed Specific use: _____		
Project description: <u>TEMPORARY JOB TRAILER</u>		
Contractor's name, address & telephone: <u>LedgeWood Const.</u>		
Who should we contact when the permit is ready: <u>Clint Gendreau</u>		
Mailing address: _____ Phone: <u>767-1866</u> <u>Above</u>		

Please submit all of the information outlined in the Commercial Application Checklist. Failure to do so will result in the automatic denial of your permit.

In order to be sure the City fully understands the full scope of the project, the Planning and Development Department may request additional information prior to the issuance of a permit. For further information visit us on-line at www.portlandmaine.gov, stop by the Building Inspections office, room 315 City Hall or call 874-8703.

I hereby certify that I am the Owner of record of the named property, or that the owner of record authorizes the proposed work and that I have been authorized by the owner to make this application as his/her authorized agent. I agree to conform to all applicable laws of this jurisdiction. In addition, if a permit for work described in this application is issued, I certify that the Code Official's authorized representative shall have the authority to enter all areas covered by this permit at any reasonable hour to enforce the provisions of the codes applicable to this permit.

Signature of applicant: _____

Date: 11/28/06

This is not a permit; you may not commence ANY work until the permit is issued.

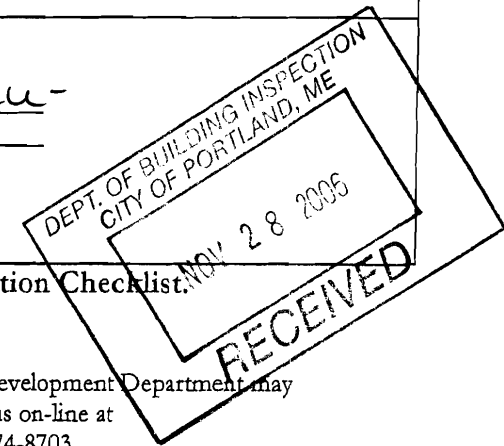

City of Portland, Maine - Building or Use Permit

389 Congress Street, 04101 Tel: (207) 874-8703, Fax: (207) 874-8716

Permit No: 06-1712	Date Applied For: 11/28/2006	CBL: 026 E001001
-----------------------	---------------------------------	---------------------

Location of Construction: 210 PEARL ST	Owner Name: AVESTA HOUSING DEVELOPM	Owner Address: 307 CUMBERLAND AVE	Phone:
Business Name:	Contractor Name: Ledgewood Construction	Contractor Address: 27 Maine St. So. Portland	Phone: (207) 767-1866
Lessee/Buyer's Name	Phone:	Permit Type: Commercial	

Proposed Use: Temporary Job Site Trailer 10' x 40'	Proposed Project Description: Temporary Job Site Trailer 10' x 40'
--	--

Dept: Zoning **Status:** Approved **Reviewer:** Marge Schmuckal **Approval Date:** 11/28/2006
Note: **Ok to Issue:**

Dept: Building **Status:** Approved with Conditions **Reviewer:** Jeanine Bourke **Approval Date:** 12/01/2006
Note: **Ok to Issue:**

1) Stairs per code per Clint - Ledgewood

Dept: Fire **Status:** Approved **Reviewer:** Cptn Greg Cass **Approval Date:** 11/29/2006
Note: **Ok to Issue:**

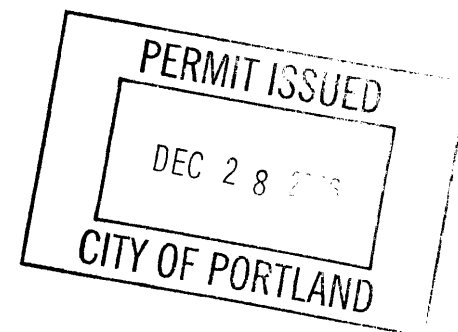

Metal Fab
 to OSHA & code
 compliance
 per Clint Ledgewood

12/1/06

LANCASTER STREET

OXFORD STREET

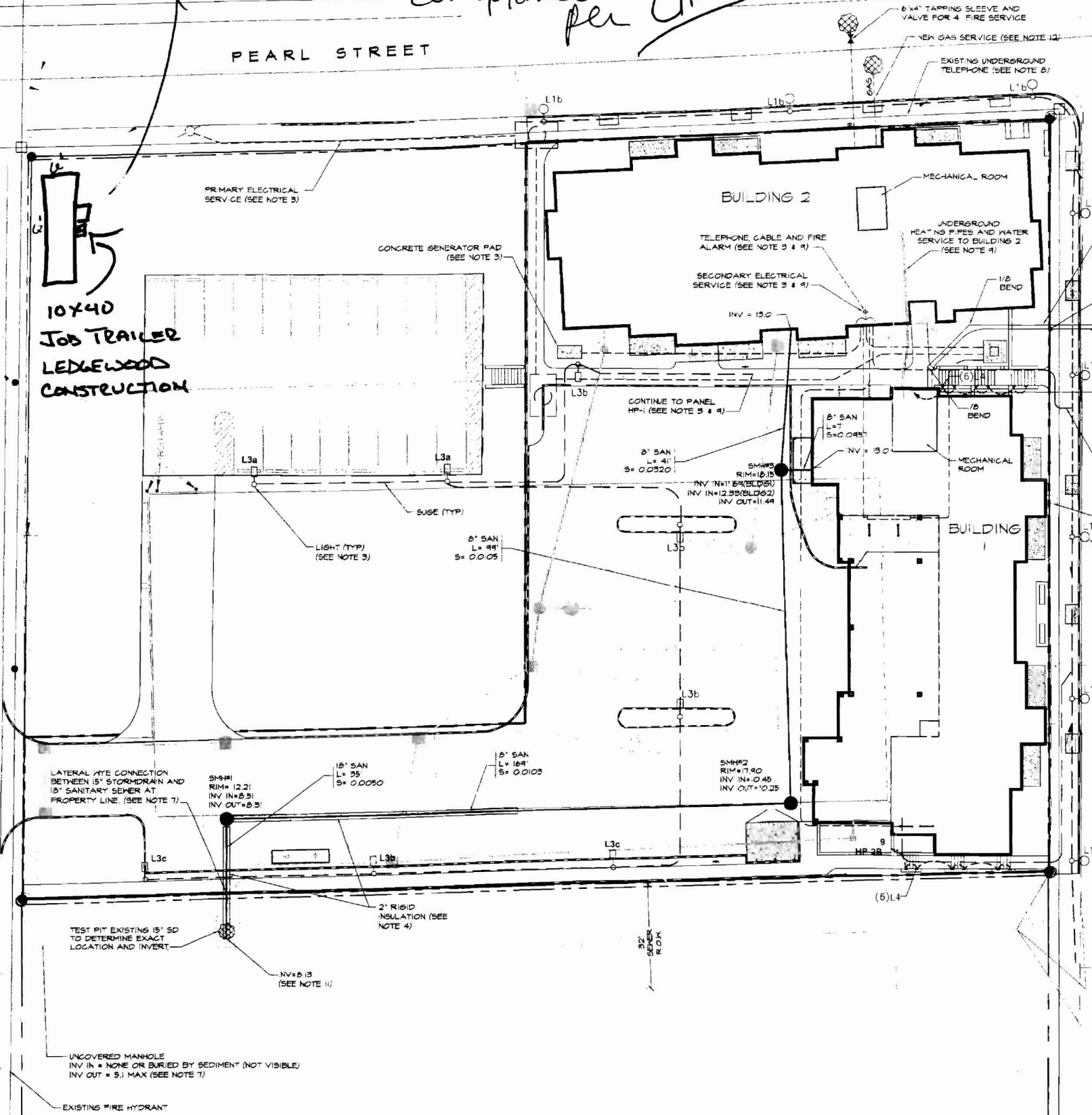

10x40
 JOB TRAILER
 LEDGEWOOD
 CONSTRUCTION

LATERAL TIE CONNECTION
 BETWEEN 15" STORMDRAIN AND
 18" SANITARY SEWER AT
 PROPERTY LINE. (SEE NOTE 7)

TEST PIT EXISTING 15" SD
 TO DETERMINE EXACT
 LOCATION AND INVERT.

UNCOVERED MANHOLE
 INV IN = NONE OR BURIED BY SEDIMENT (NOT VISIBLE)
 INV OUT = 5.1 MAX (SEE NOTE 7)

EXISTING FIRE HYDRANT

PRIMARY ELECTRICAL
 SERVICE (SEE NOTE 3)

CONCRETE GENERATOR PAD
 (SEE NOTE 3)

LIGHT (TYP)
 (SEE NOTE 3)

6USE (TYP)

8" SAN
 L= 41'
 S= 0.0320

8" SAN
 L= 169'
 S= 0.0103

SMH#1
 RIM= 12.2'
 INV IN= 8.5'
 INV OUT= 8.5'

18" SAN
 L= 35'
 S= 0.0050

SMH#2
 RIM= 17.40'
 INV IN= 10.45'
 INV OUT= 10.25'

SMH#3
 RIM= 18.15'
 INV IN= 12.55 (BLD#2)
 INV OUT= 11.44'

SECONDARY ELECTRICAL
 SERVICE (SEE NOTE 3 & 4)

TELEPHONE CABLE AND FIRE
 ALARM (SEE NOTE 3 & 4)

BUILDING 2

6" x 4" TAPPING SLEEVE AND
 VALVE FOR 4" FIRE SERVICE

NEW GAS SERVICE (SEE NOTE 12)

EXISTING UNDERGROUND
 TELEPHONE (SEE NOTE 8)

MECHANICAL ROOM

UNDERGROUND
 HEATING PIPES AND WATER
 SERVICE TO BUILDING 2
 (SEE NOTE 9)

CONTINUE TO PANEL
 HP-1 (SEE NOTE 3 & 4)

BUILDING 1

MECHANICAL ROOM

4" FIRE SERVICE

GAS

NEW GAS
 SERVICE
 (SEE NOTE 12)

TELEPHONE, CABLE AND FIRE

GAS AT

STR

(SEE

1a

1a

1a

1a

1a

1a

1a

1a

1a

1a

1a

1a

1a

1a

1a

1a

1a

1a

1a

1a