

Pearl Place Building 1 & 2 Portland Maine

Developer
Avesta Pearl Street One, L.P.

Architect
Winton Scott Architects

Landscape Architect
Carroll Associates

Structural Engineer
Becker Structural Engineers

Framing Sections & Details
S3.3

Sept 1, 2006

Scale: Noted

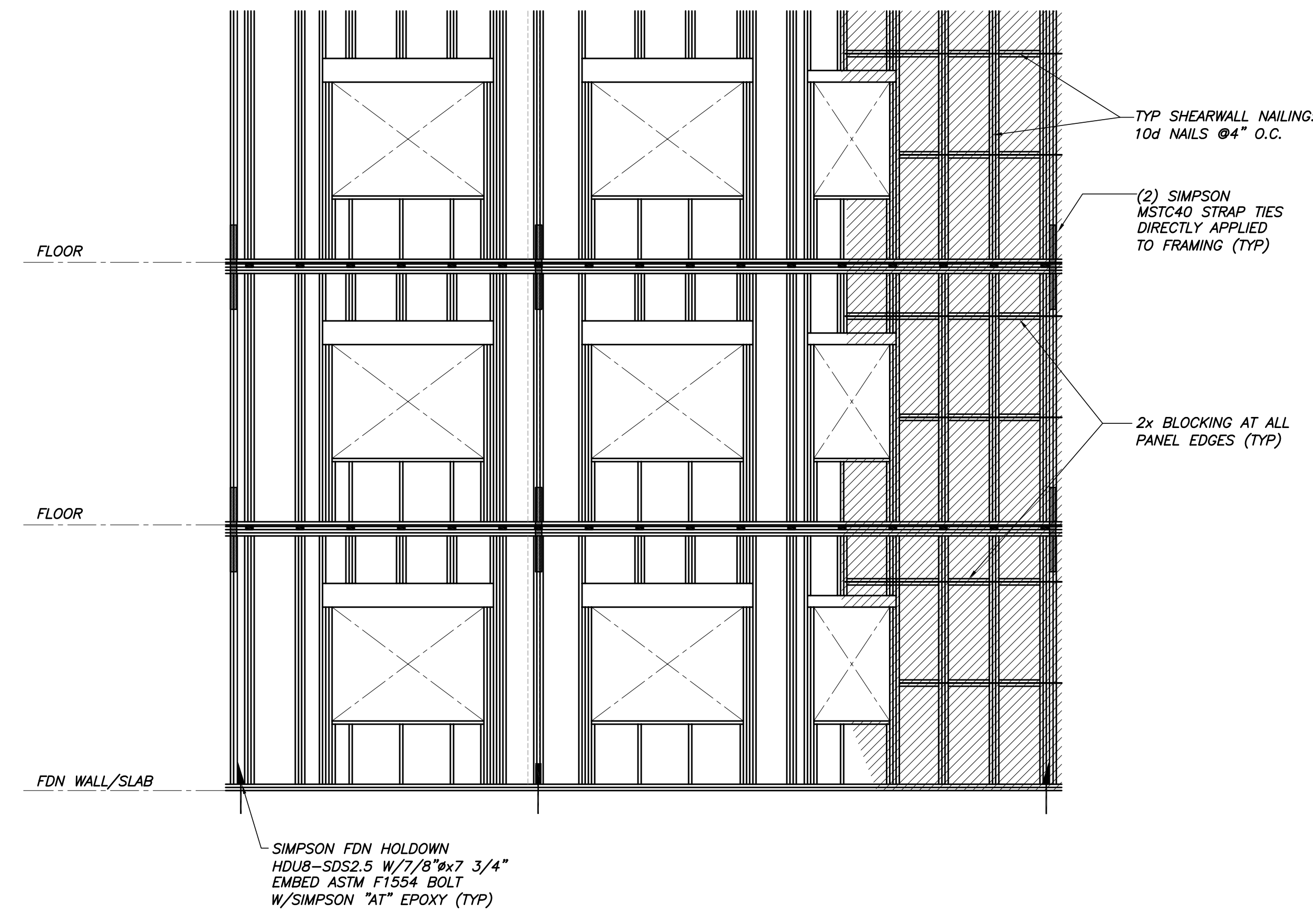

TYP PARTIAL SHEARWALL ELEVATION
N.T.S.

- WOOD STUD SHEARWALL NOTES:
- PLYWOOD SHEAR PANELS SHALL BE SINGLE SIDED MINIMUM 1/2" APA RATED SHEATHING PANELS. ORIENTED STRAND BOARD (OSB) SHEATHING OF THE SAME THICKNESS IS AN ACCEPTABLE SUBSTITUTE, UNLESS NOTED OTHERWISE BY ARCHT.
 - PLYWOOD TO BE PLACED WITH FACE GRAIN PERPENDICULAR TO STUDS.
 - USE 4'-0"x8'-0" PLYWOOD SHEETS WHERE POSSIBLE.
 - MINIMUM WIDTH OF PLYWOOD SHEET IS 2'-0"
 - SHEARWALL ELEVATIONS ARE INTENDED TO DETAIL SHEARWALL ELEMENTS ONLY. FRAMING SHOWN MAY NOT REFLECT ALL BUILDING COMPONENTS AT THE SHEARWALL AREA.
 - COORDINATE SHEARWALL DIMENSIONS AND LOCATIONS WITH ARCHITECTURAL DRAWINGS.
 - HOLES ARE ALLOWED IN PLYWOOD SHEARWALLS AS SHOWN ON THE DRAWINGS (SEE ARCHITECTURAL DRAWINGS.)
 - PROVIDE "2x" OR "4x" BLOCKING (SEE ELEVATIONS) AS NAILING SURFACE AT UNSUPPORTED PANEL EDGES. BLOCK ALL PANEL EDGES.
 - SHEAR PANEL EDGE NAILING PATTERN INDICATED ON SHEARWALL SCHEDULE AND ELEVATIONS. AT LOCATIONS WITH SHEAR PANELS ON TWO SIDES, INDICATED NAILING PATTERN APPLIES TO BOTH SIDES.
 - 3/8" MINIMUM EDGE DISTANCE AT ANY NAILED CONNECTION.
 - SHEARWALL HOLD DOWNS SHALL BE AS SPECIFIED, MANUFACTURED BY SIMPSON STRONG-TIE COMPANY, INC. SHEARWALL HOLD DOWN ANCHORS SHALL BE "EPOXY-TIE" ADHESIVE ANCHORS BY SIMPSON STRONG-TIE COMPANY, INC. THREADED ROD SHALL BE ASTM 1554 (MIN) OF SIZE AND EMBEDMENT AS SPECIFIED. MINIMUM CONCRETE EDGE DISTANCE SHALL BE 1 3/4".
 - ALL FOUNDATION WALLS REQUIRE 5/8" A307 HEADED ANCHOR BOLTS AS NOTED IN FOUNDATION SECTIONS WITH 8" MIN EMBED. ANCHOR BOLTS REQUIRE DECREASED SPACING AT SHEARWALLS, SEE SHEARWALL ELEVATION. ANCHOR BOLTS AT SHEARWALLS MAY BE EPOXIED.
 - ALL NAILS AT WOOD SHEARWALLS REQUIRE 10d COMMON NAILS @4" O.C.

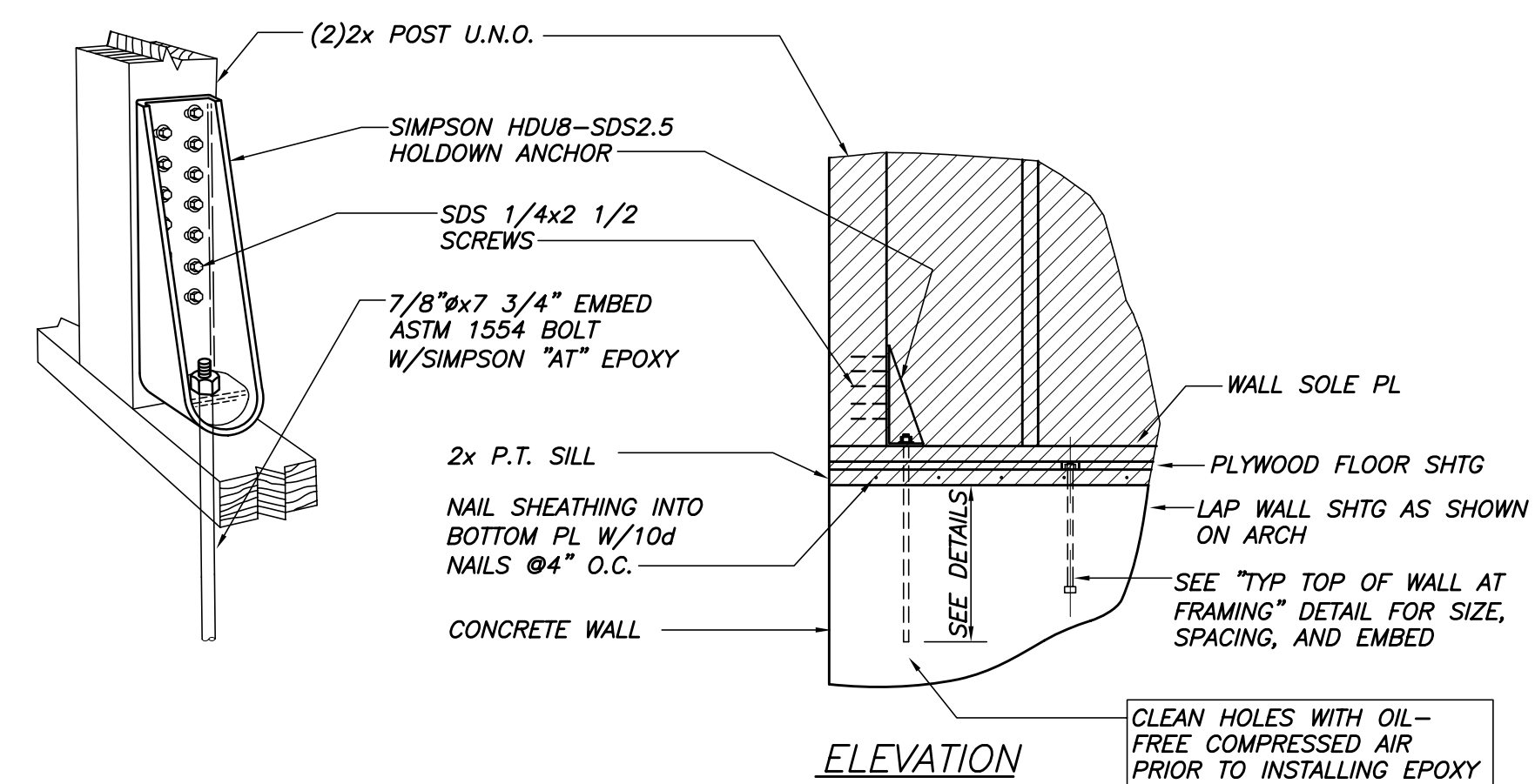

TYP HOLDOWN DETAIL AT FDN WALL
N.T.S.

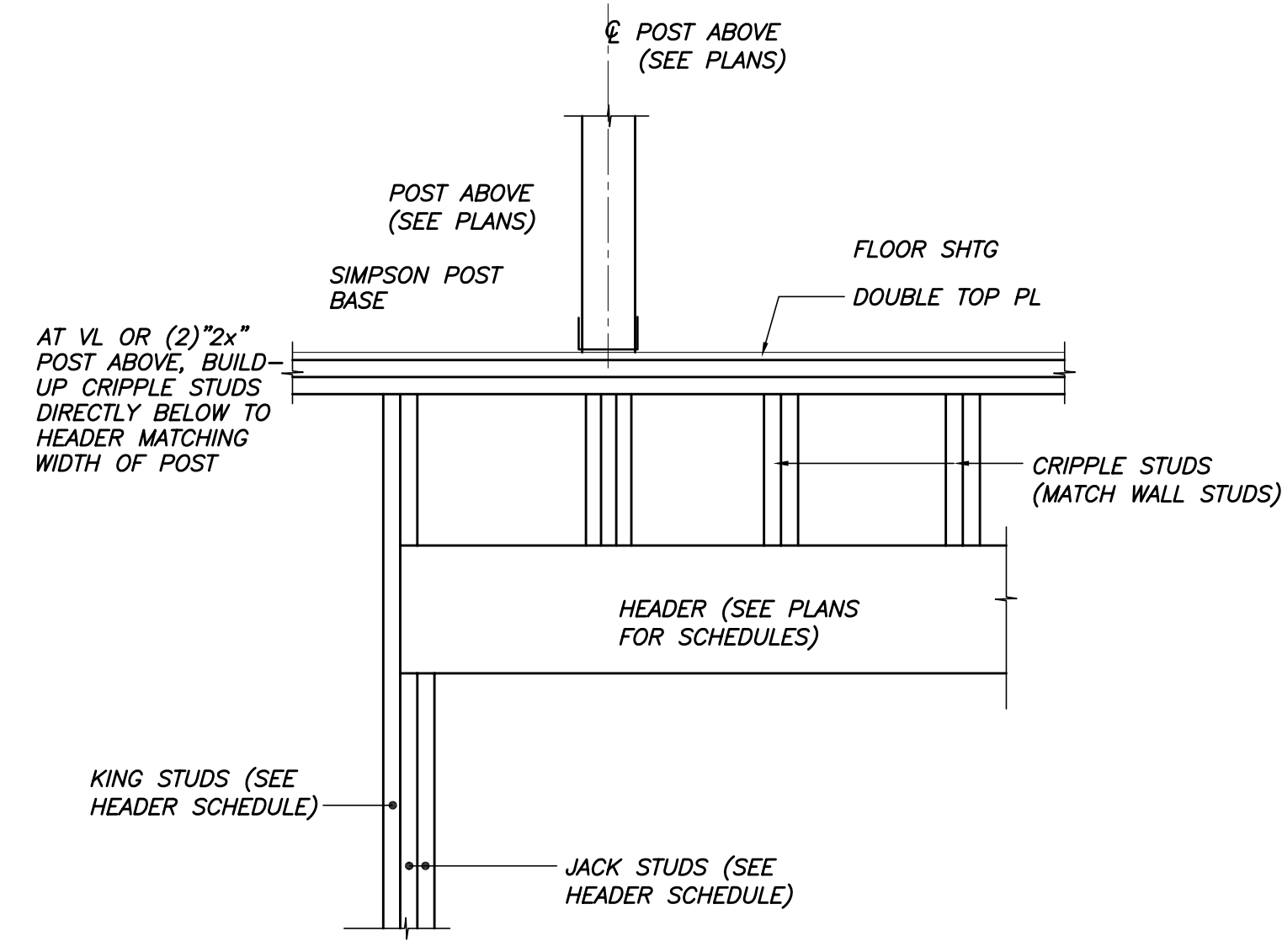

TYP HEADER DETAIL
N.T.S.

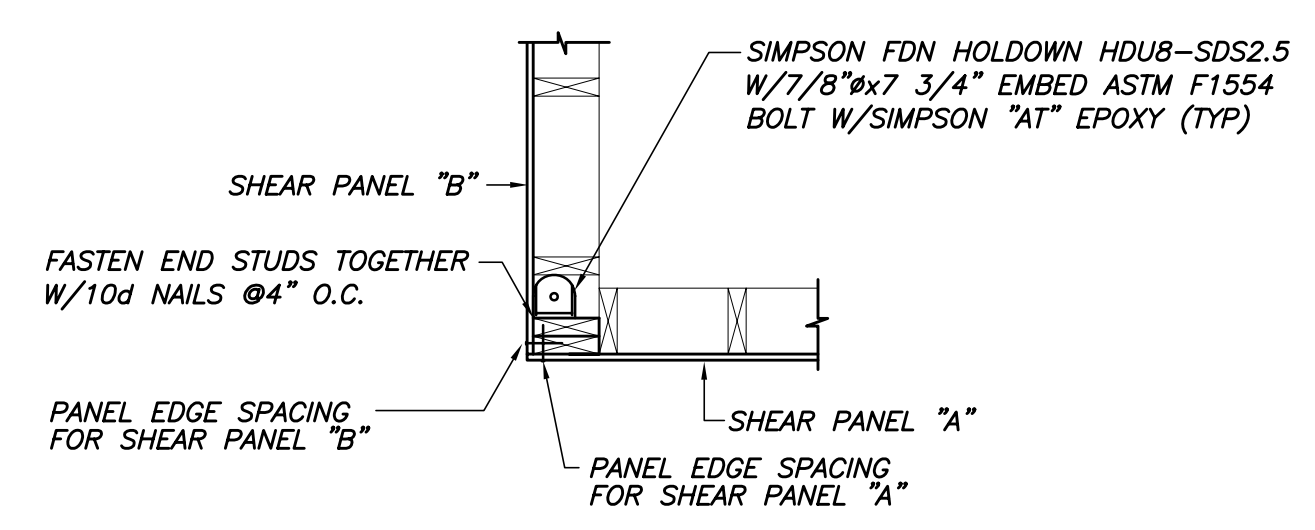

NOTE: DOUBLE SHEARWALL CONDITION SHOWN. AT SINGLE SHEARWALL, SHEAR PANEL "A" ONLY.

TYP HDU-8 AT (3)2x6 POST DETAIL
N.T.S.

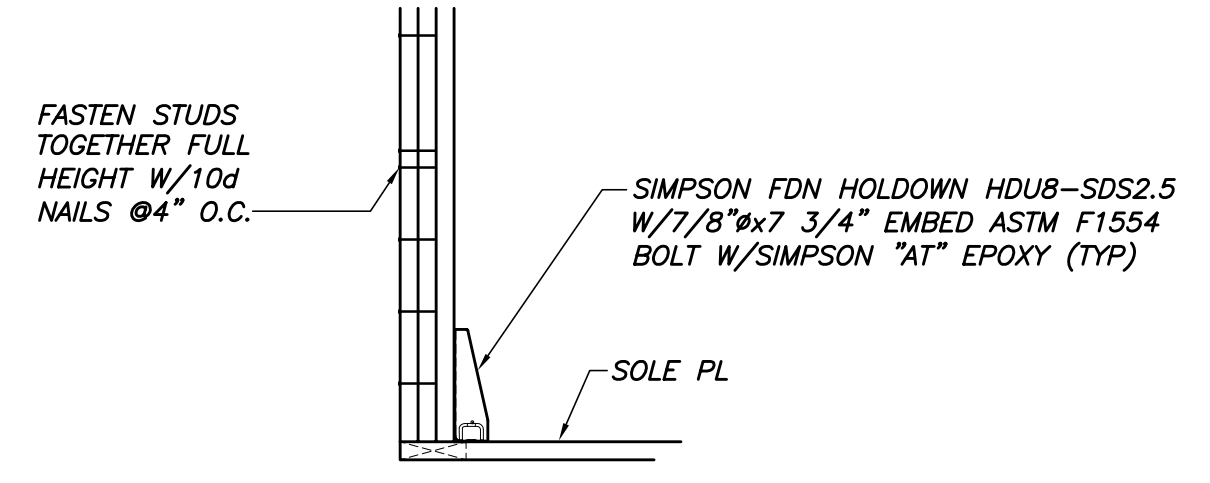

TYP (3)2x6 NAILING AT SHEAR WALL END POST
N.T.S.