

1 Stair Section Detail  
Scale: 1 1/2" = 1'-0"

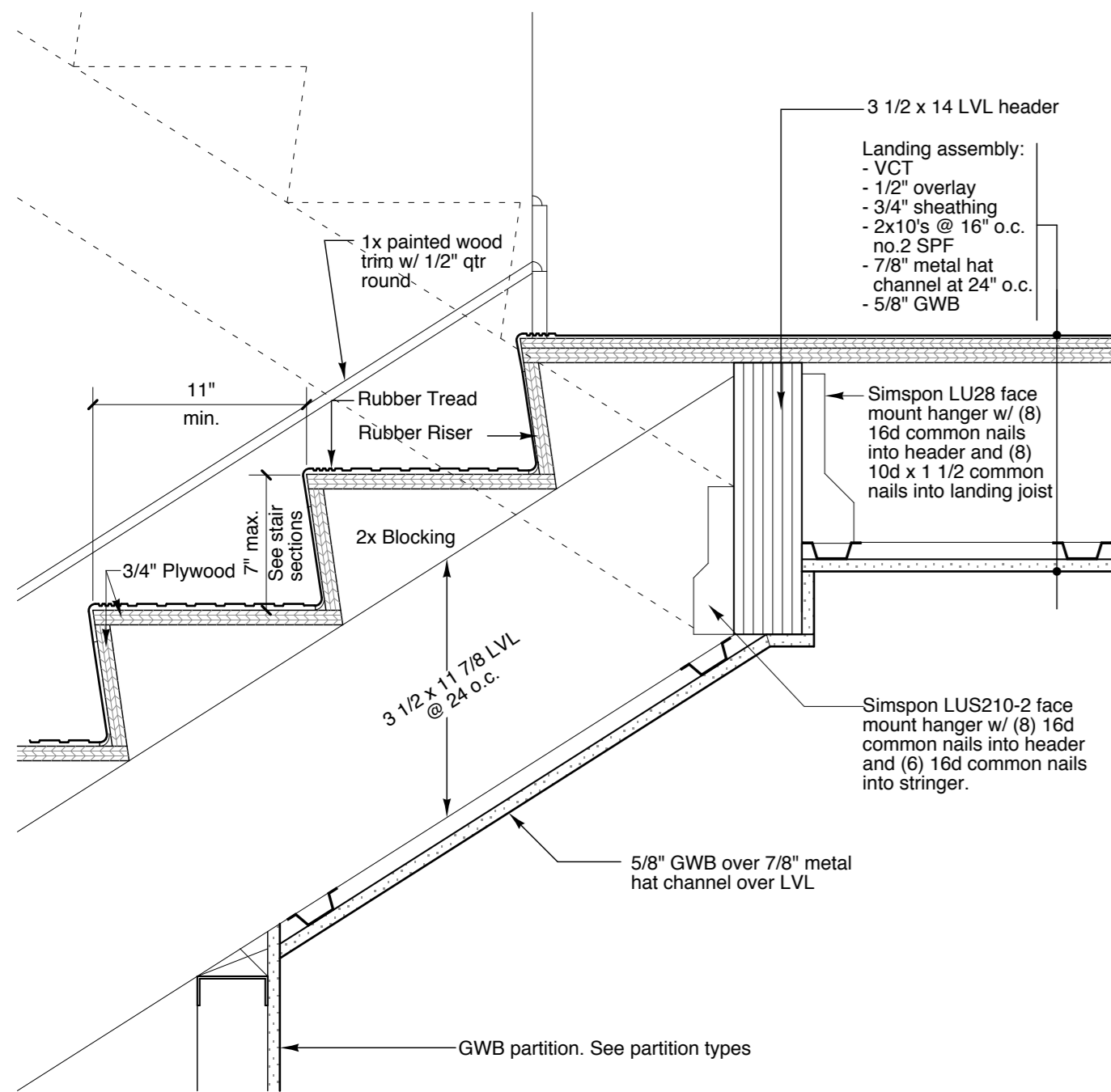

2 Stair Section Detail at Landing  
Scale: 1 1/2" = 1'-0"

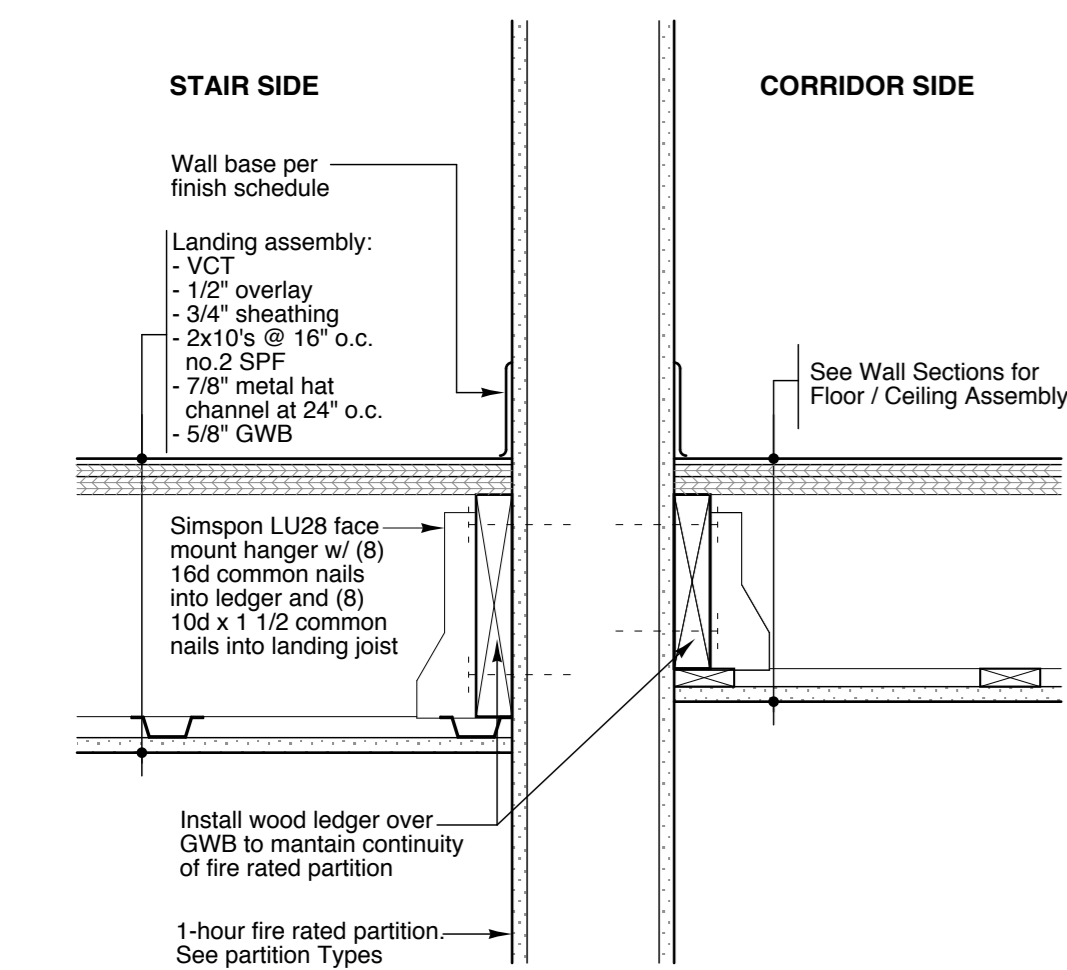

3 Landing Detail at 1-Hour Fire Rated Partition  
Scale: 1 1/2" = 1'-0"

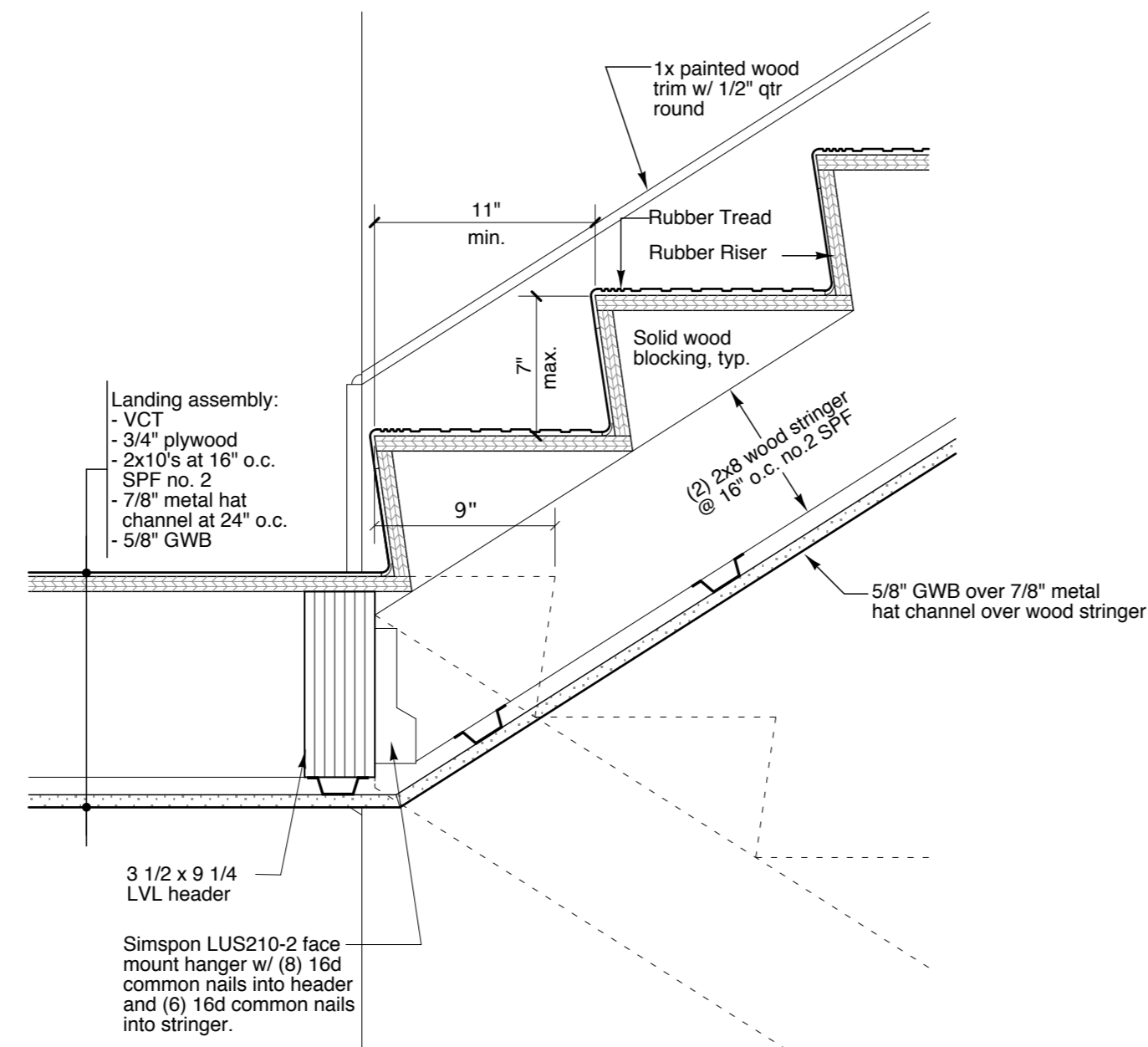

4 Stair Section Detail at Landing  
Scale: 1 1/2" = 1'-0"

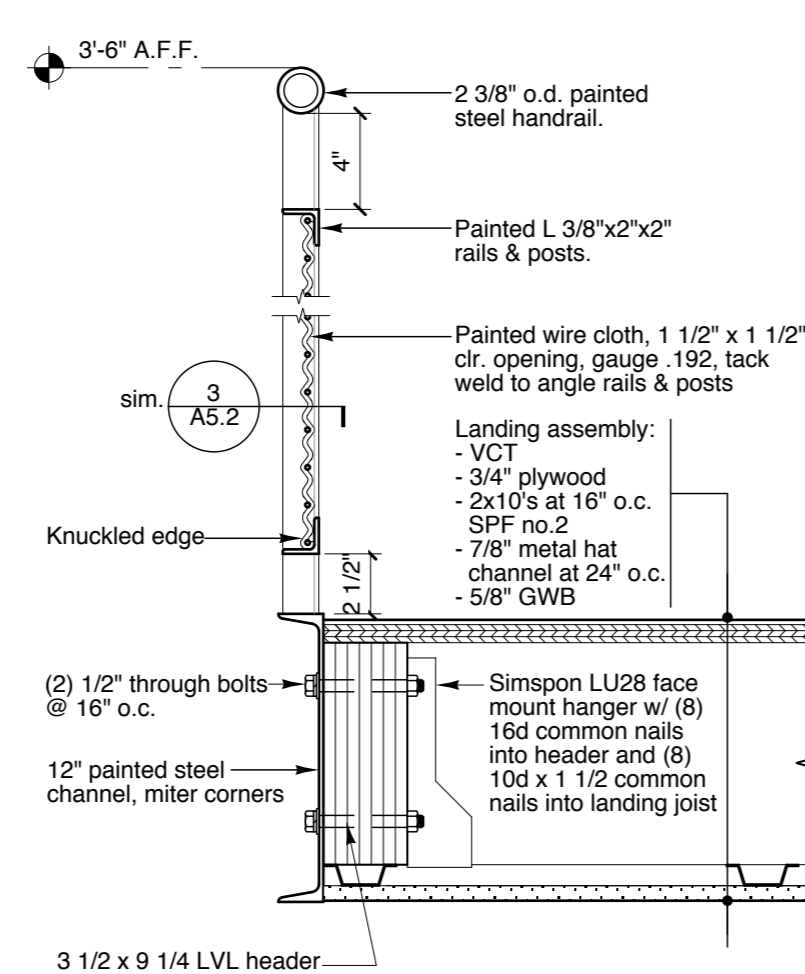

5 Typical Guardrail Detail  
Scale: 1 1/2" = 1'-0"

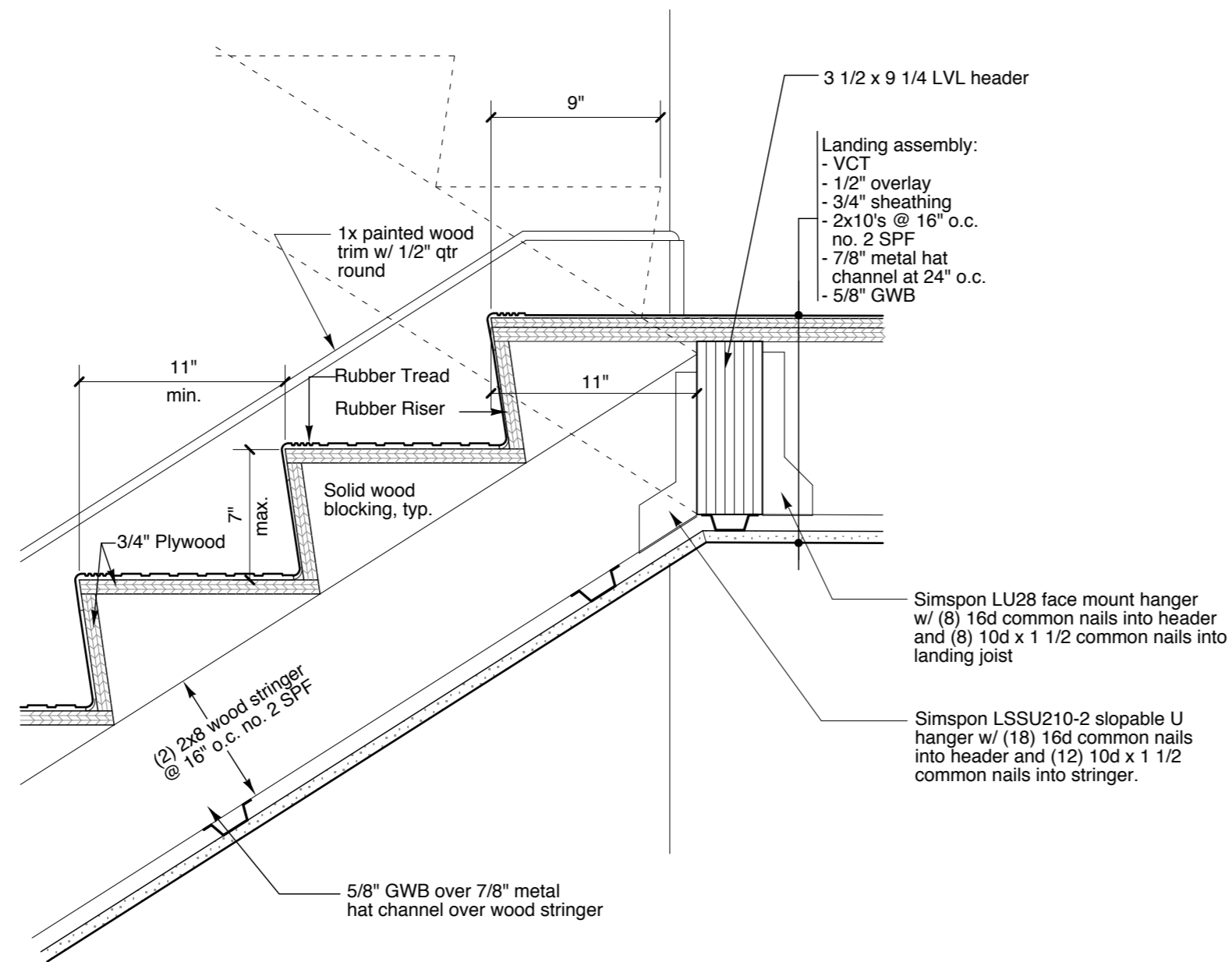

6 Stair Section Detail at Landing  
Scale: 1 1/2" = 1'-0"

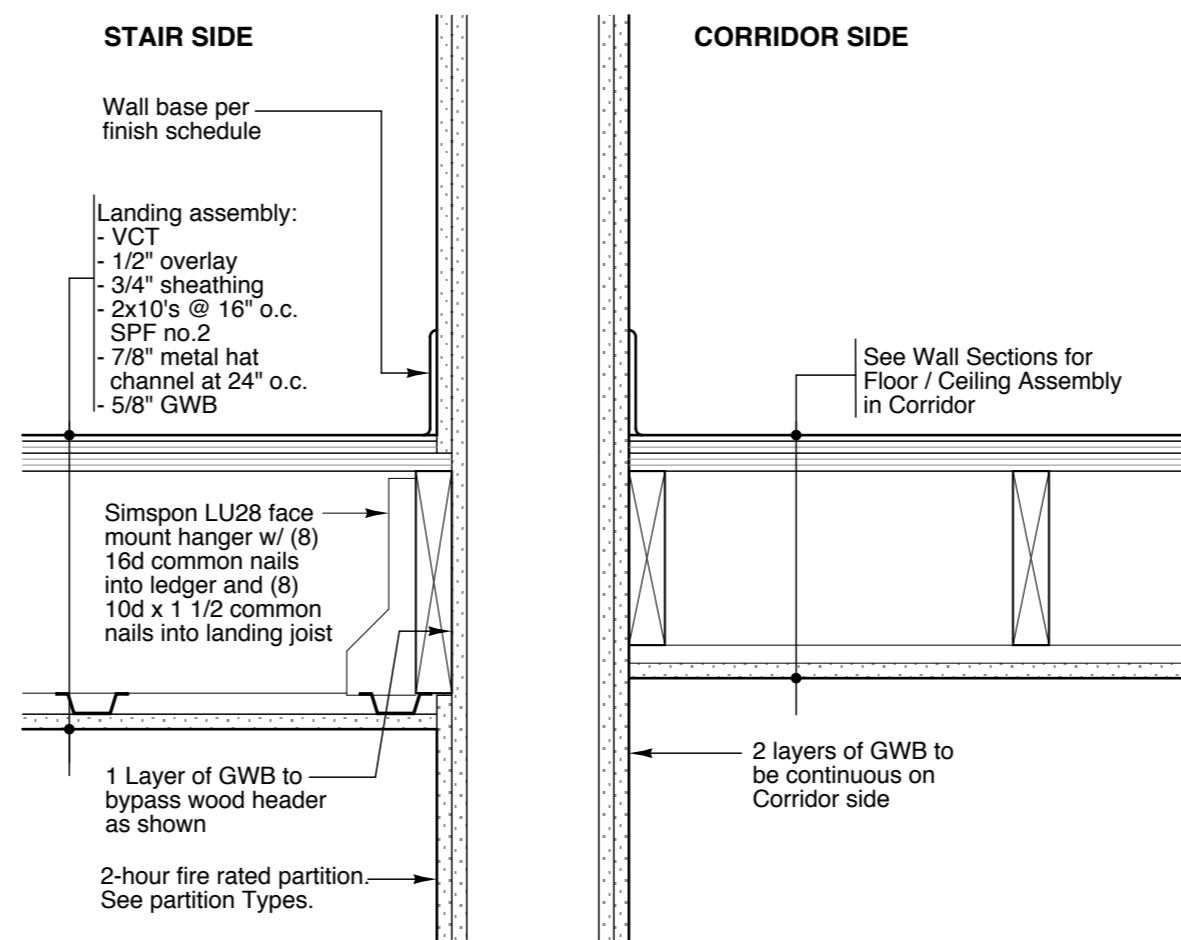

7 Landing Detail at 2-Hour Fire Rated Partition  
Scale: 1 1/2" = 1'-0"

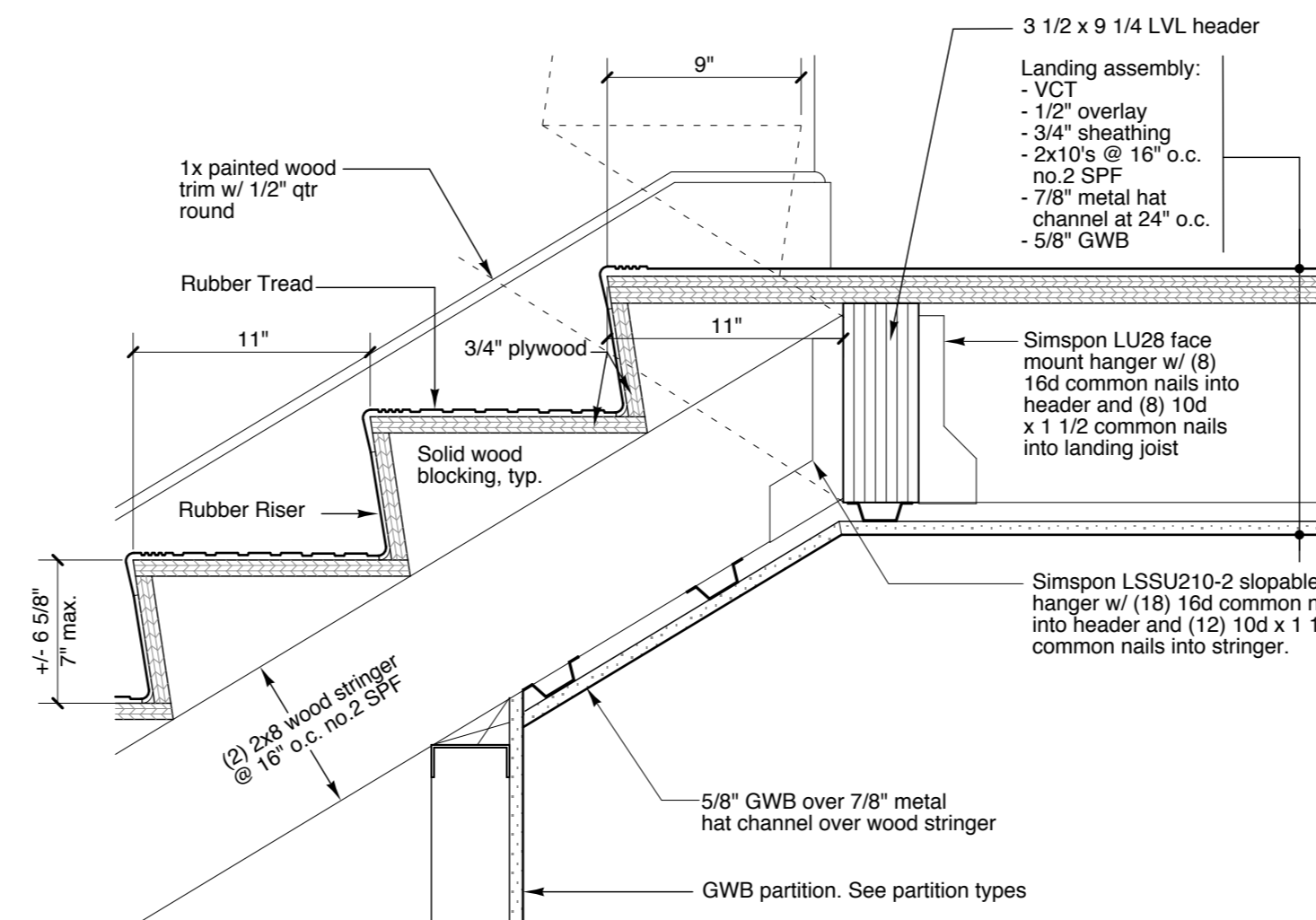

9 Stair Section Detail at Landing  
Scale: 1 1/2" = 1'-0"

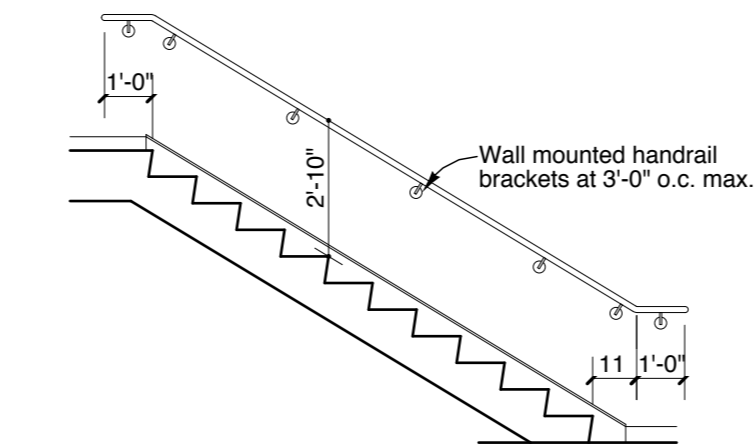

10 Handrail Details

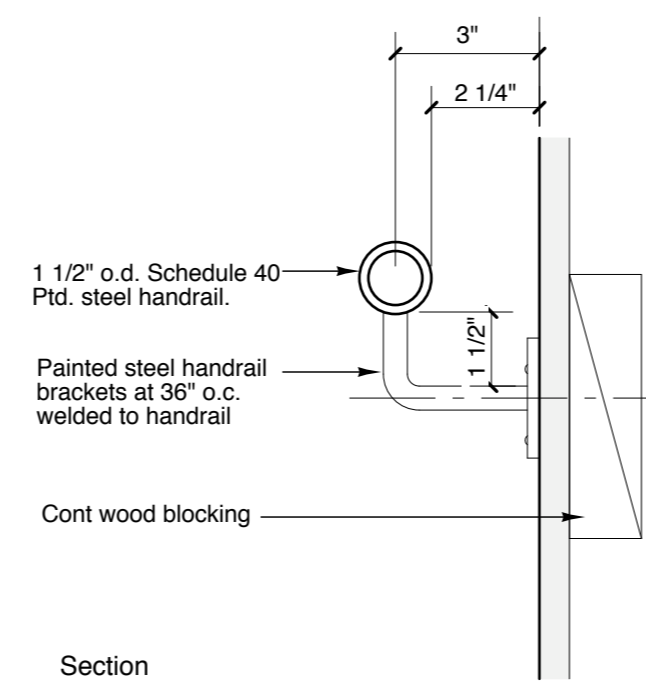

10 Handrail Details  
Scale: 3" = 1'-0"

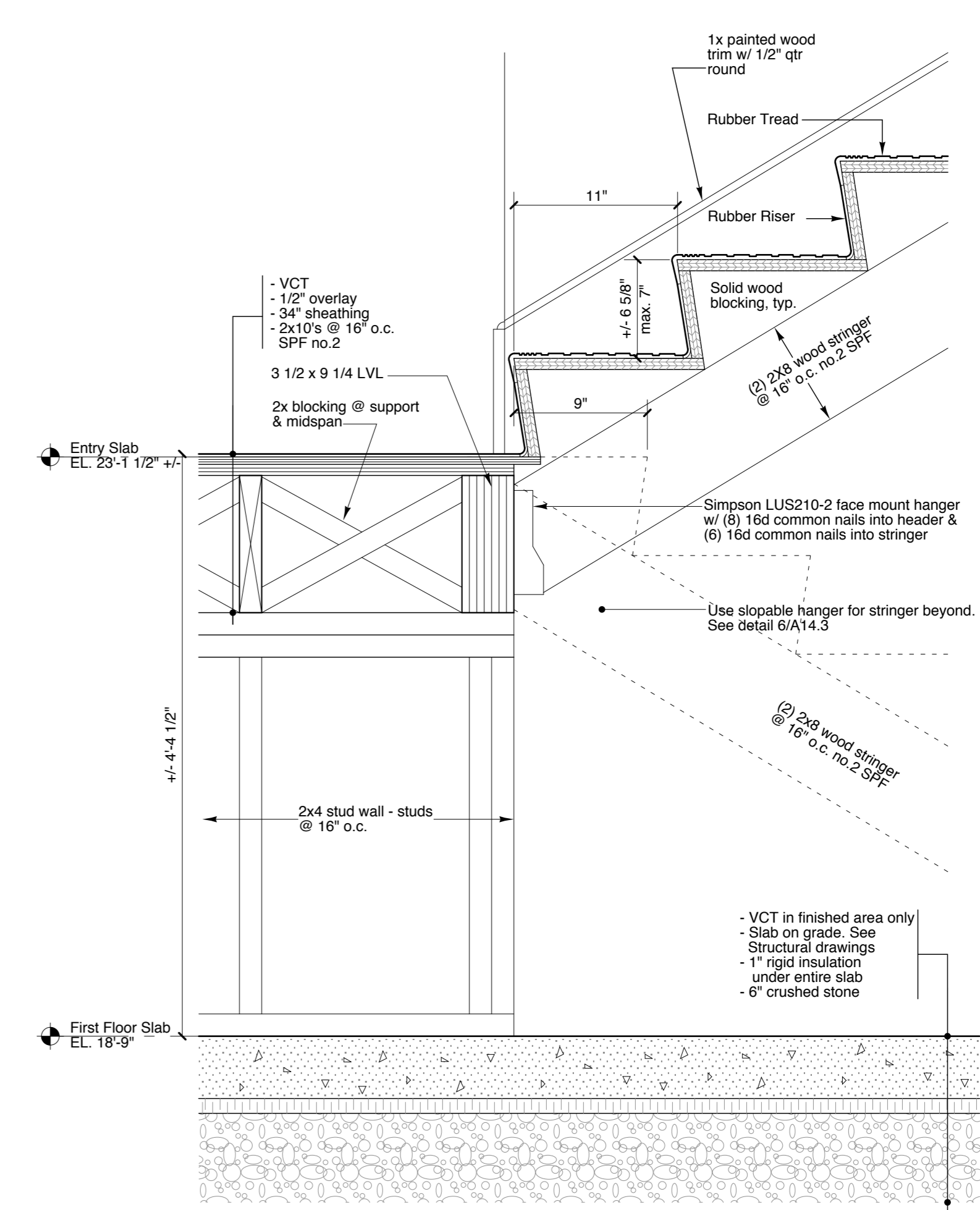

8 Detail at Bottom Landing of Stair 2-1  
Scale: 1 1/2" = 1'-0"

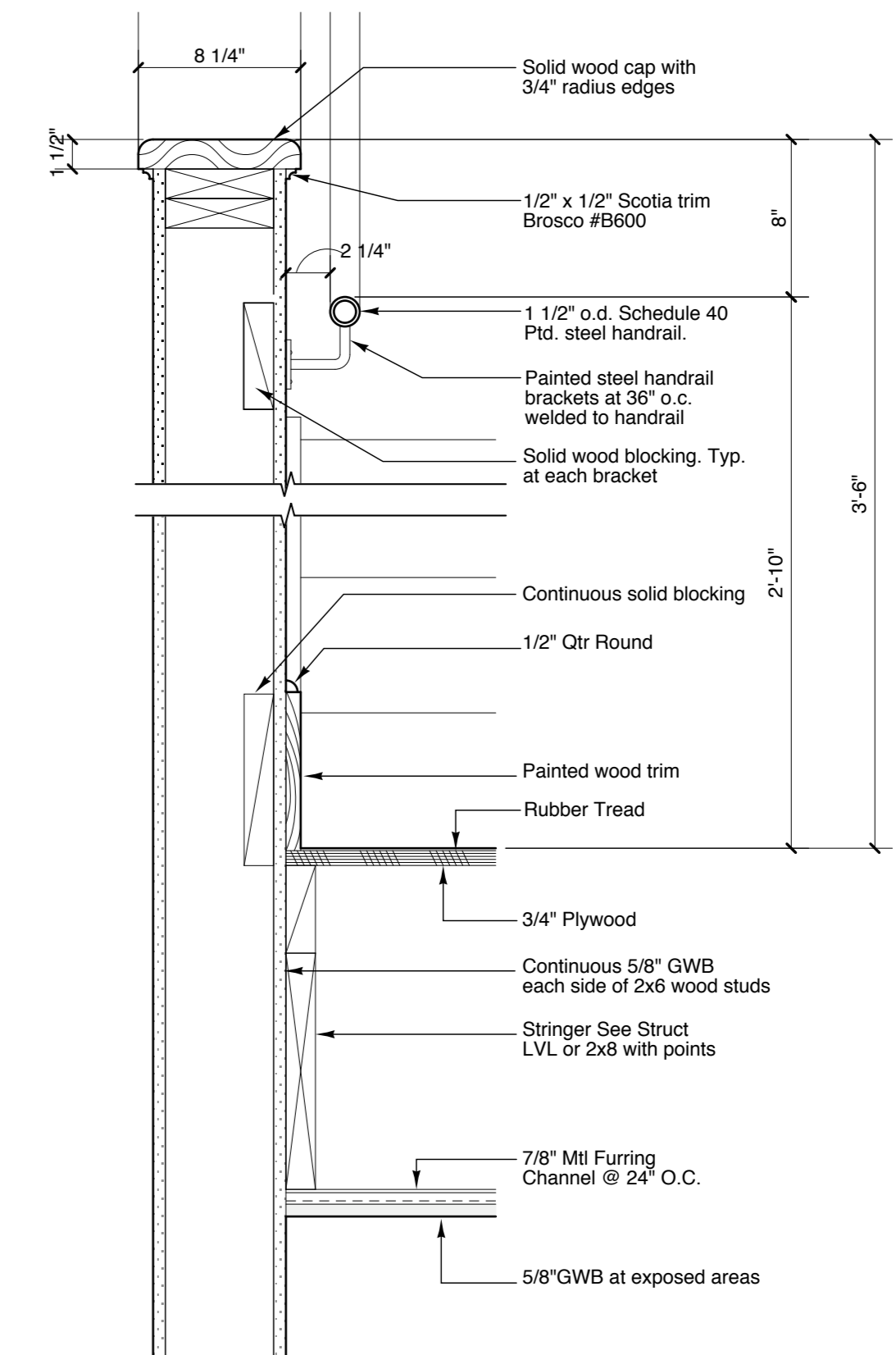

11 Typical Stringer Section Detail  
Scale: 1 1/2" = 1'-0"

Pearl Place  
Building 1 & 2  
Portland Maine

Developer  
Avesta Pearl  
Street One, L.P.

Architect  
Winton Scott Architects

Landscape Architect  
Carroll Associates

Civil  
Gorrill Palmer  
Consulting Engineers

Structural  
Becker Structural  
Mechanical / Plumbing  
Mechanical Systems  
Engineers

Electrical  
Bartlett Designs

STAIR DETAILS

A14.3

Scale: as indicated

September 1, 2006