

SECTION DETAIL AT HALF WALL AT TOP OF STAIRS

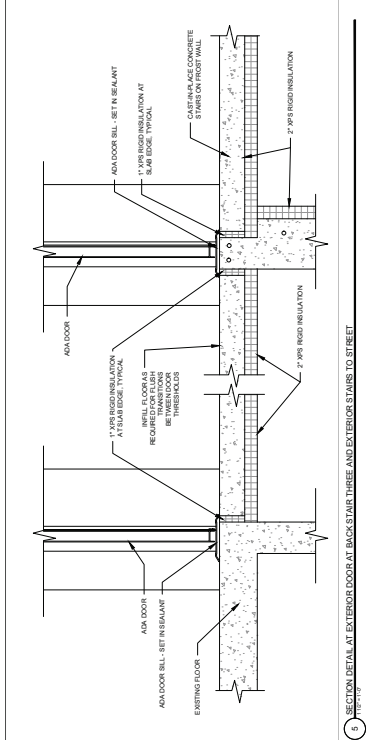

SECTION DETAIL AT EXTERIOR DOOR AT BACK STAIR THREE AND EXTERIOR STAIRS TO STREET

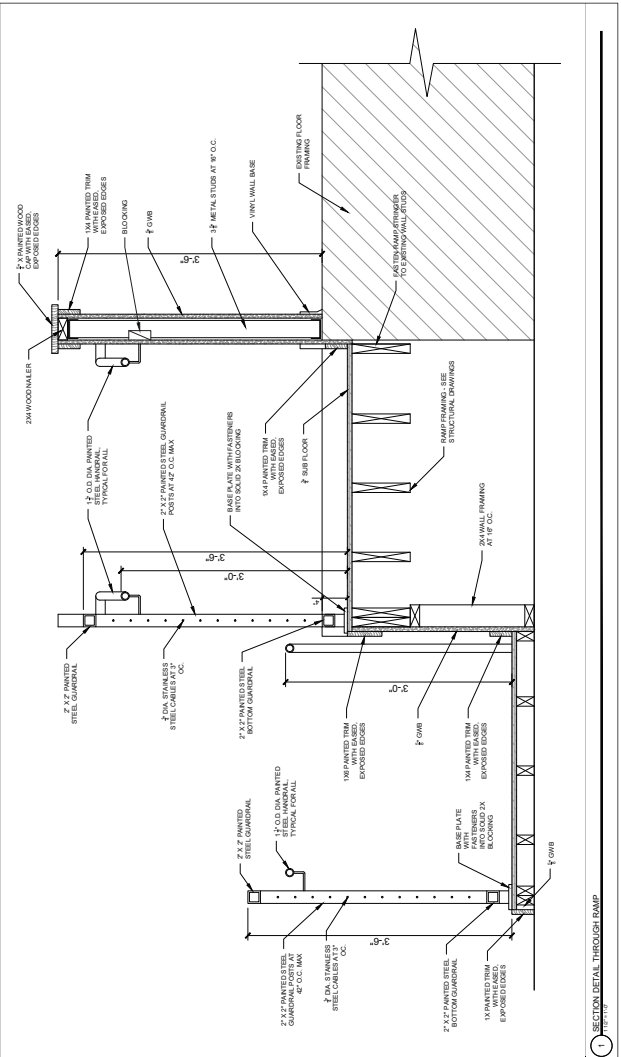

SECTION DETAIL THROUGH RAMP

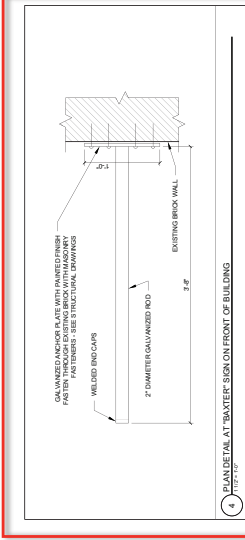

PLAN DETAIL AT 'BAXTER' SIGN FRONT OF BUILDING

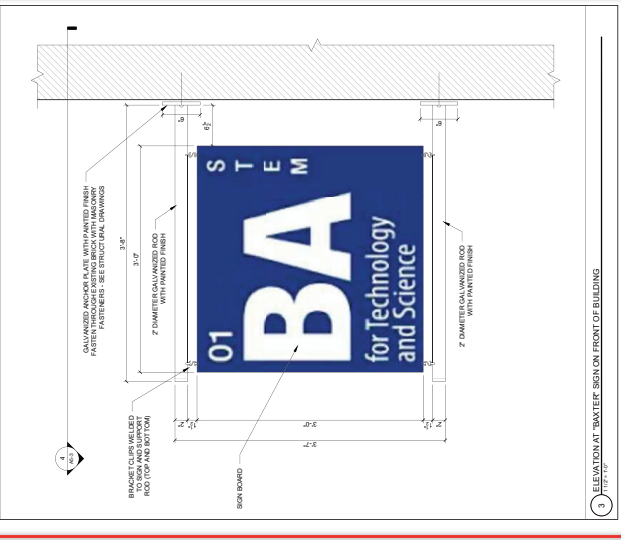

ELEVATION AT 'BAXTER' SIGN ON FRONT OF BUILDING

#2