

1 SCIENCE LAB THREE (135)
1/2" = 1'-0"

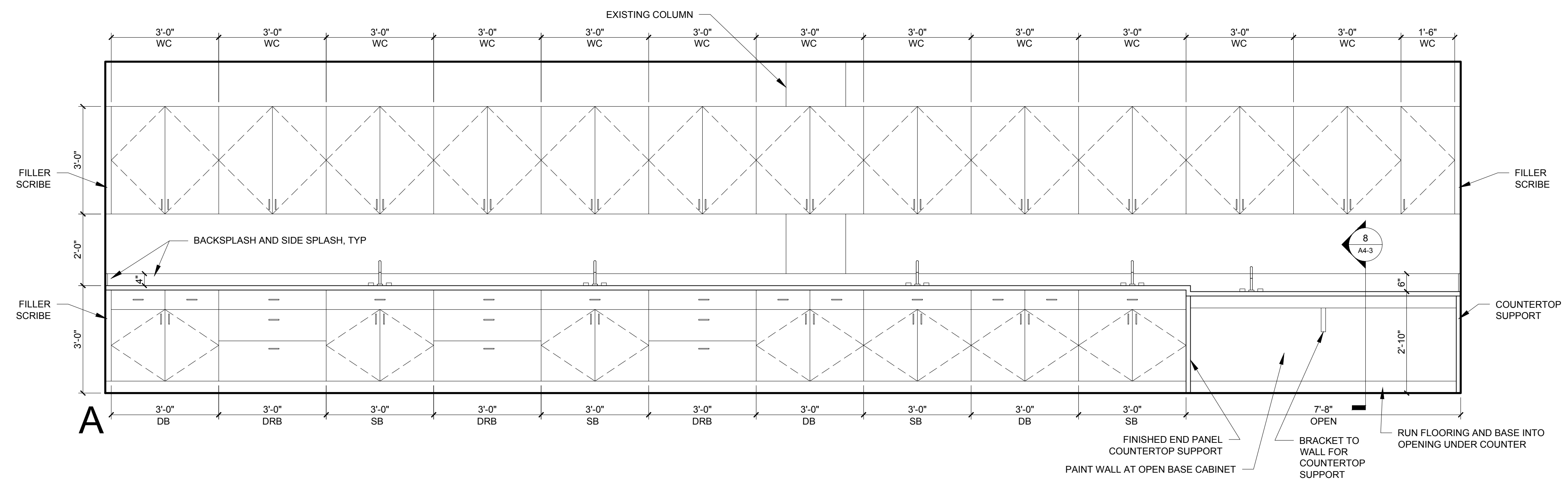

2 SCIENCE LAB TWO (134)
1/2" = 1'-0"

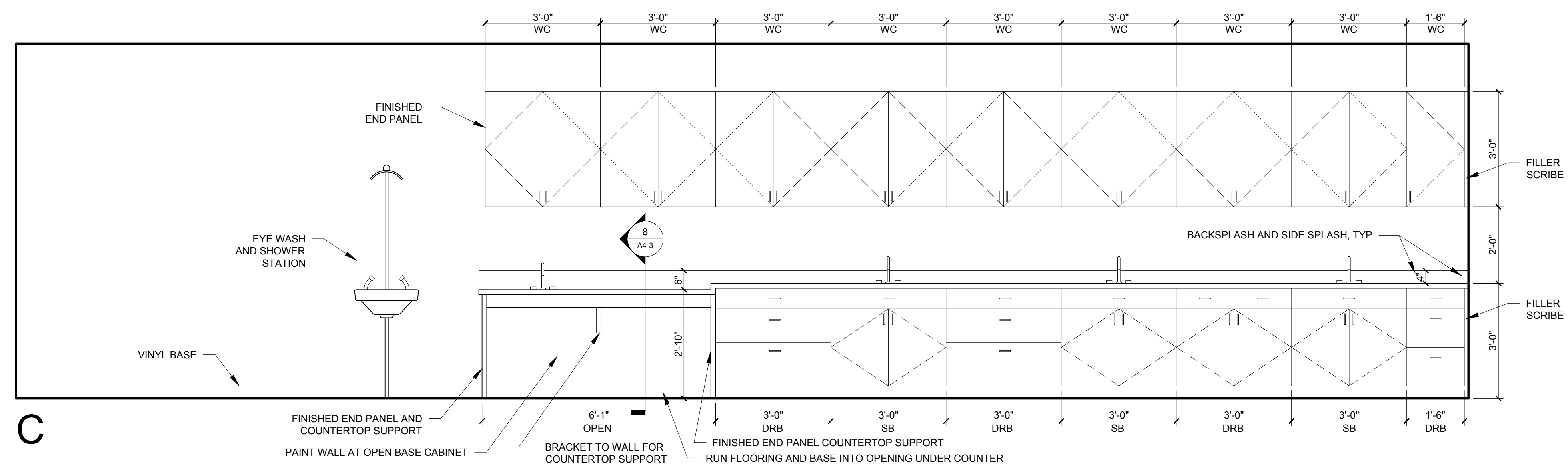

3 CHEMISTRY SCIENCE LAB ONE (133)
1/2" = 1'-0"

- UNIT NOTES**
- 1.) G.C. TO CONFIRM AND COORDINATE ALL ROUGH FRAMING DIMENSIONS FOR BUILT-IN FIXTURES ETC.
G.C. TO CONFIRM AND COORDINATE ALL CABINETS AND APPLIANCES DIMENSIONS
 - 2.) PROVIDE APPROPRIATE BLOCKING IN WALLS BEHIND ALL FIXTURES, PARTITIONS AND ACCESSORIES. BLOCKING FOR GRAB BARS TO BE PROVIDED IN WALLS OF BATHROOMS
 - 3.) PROVIDE MOISTURE RESISTANT GWB AT ALL WALLS AND CEILINGS IN BATHROOMS TYPICAL
 - 4.) REFER TO ELECTRICAL AND MECHANICAL DRAWINGS FOR ADDITIONAL INFORMATION REGARDING LIGHTING, DIFFUSERS, ETC.
 - 5.) PROVIDE FIRE EXTINGUISHER ON BRACKET IN BASE CABINET BELOW SINK - TYPICAL (ONE SINK PER ROOM)
 - 6.) WHERE DROPPED SOFFITS AND CEILINGS ARE SHOWN, THESE ARE IN ADDITION TO THE FIRE RATED GWB CEILING ABOVE WHICH IS PART OF THE RATED ASSEMBLY
 - 7.) WHERE PLUMBING VALVES ARE LOCATED IN FIRE RATED WALLS, PROVIDE FIRE RATED BOX IN WALL FOR VALVE TO BE INSTALLED WITHIN
- CABINETS AND APPLIANCE ABBREVIATIONS**
- DB = DRAWER BASE
 - DRB = DOOR BASE
 - SB = SINK BASE
 - WC = WALL CABINET
 - DW = DISHWASHER
 - REF = REFRIGERATOR

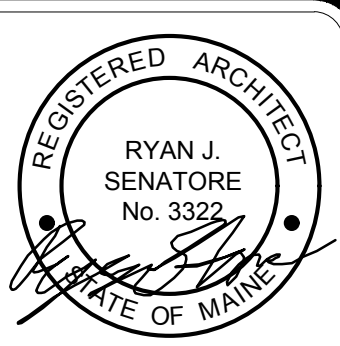

© 2017 RYAN SENATORE ARCHITECTURE

BAXTER ACADEMY
INTERIOR FIT-UP
185 LANCASTER STREET, PORTLAND, MAINE



RYAN SENATORE ARCHITECTURE
565 CONGRESS STREET
PORTLAND, MAINE 04101
207-650-6414
senatore@rsaarchitecture.com

CONSULTANTS:

REVISIONS:

DATE: 31 JANUARY 2017

PROJECT No. 1648

DRAWN BY: RRT, RJS

CHECKED BY: RJS

SCALE: AS NOTED

SHEET TITLE:
INTERIOR ELEVATIONS

A4-4