

© 2017 RYAN SENATORE ARCHITECTURE

**BAXTER ACADEMY**  
INTERIOR FIT-UP  
185 LANCASTER STREET, PORTLAND, MAINE



**RYAN SENATORE ARCHITECTURE**  
565 CONGRESS STREET  
PORTLAND, MAINE 04101  
207.650.0414  
senatore@rsharchitecture.com

CONSULTANTS:

REVISIONS:

DATE: 31 JANUARY 2017

PROJECT No. 1648

DRAWN BY: RRT, RJS

CHECKED BY: RJS

SCALE: AS NOTED

SHEET TITLE:  
FIRST FLOOR  
REFLECTED  
CEILING PLAN

**A1-4**

RCP LEGEND				
SYMBOL	TAG	DESCRIPTION	MANUFACTURER	MODEL NUMBER
		2'x4' ACT HUNG CEILING	XXXXXXXXXXXXXXXX	XXXXXXXXXXXXXXXXXXXXXXXXXXXX
		2'x4' FIRE RATED ACT HUNG CEILING	XXXXXXXXXXXXXXXX	XXXXXXXXXXXXXXXXXXXXXXXXXXXX
	A	2'x4' RECESSED	XXXXXXXXXXXXXXXX	XXXXXXXXXXXXXXXXXXXXXXXXXXXX
	B	6\"/>	XXXXXXXXXXXXXXXX	XXXXXXXXXXXXXXXXXXXXXXXXXXXX

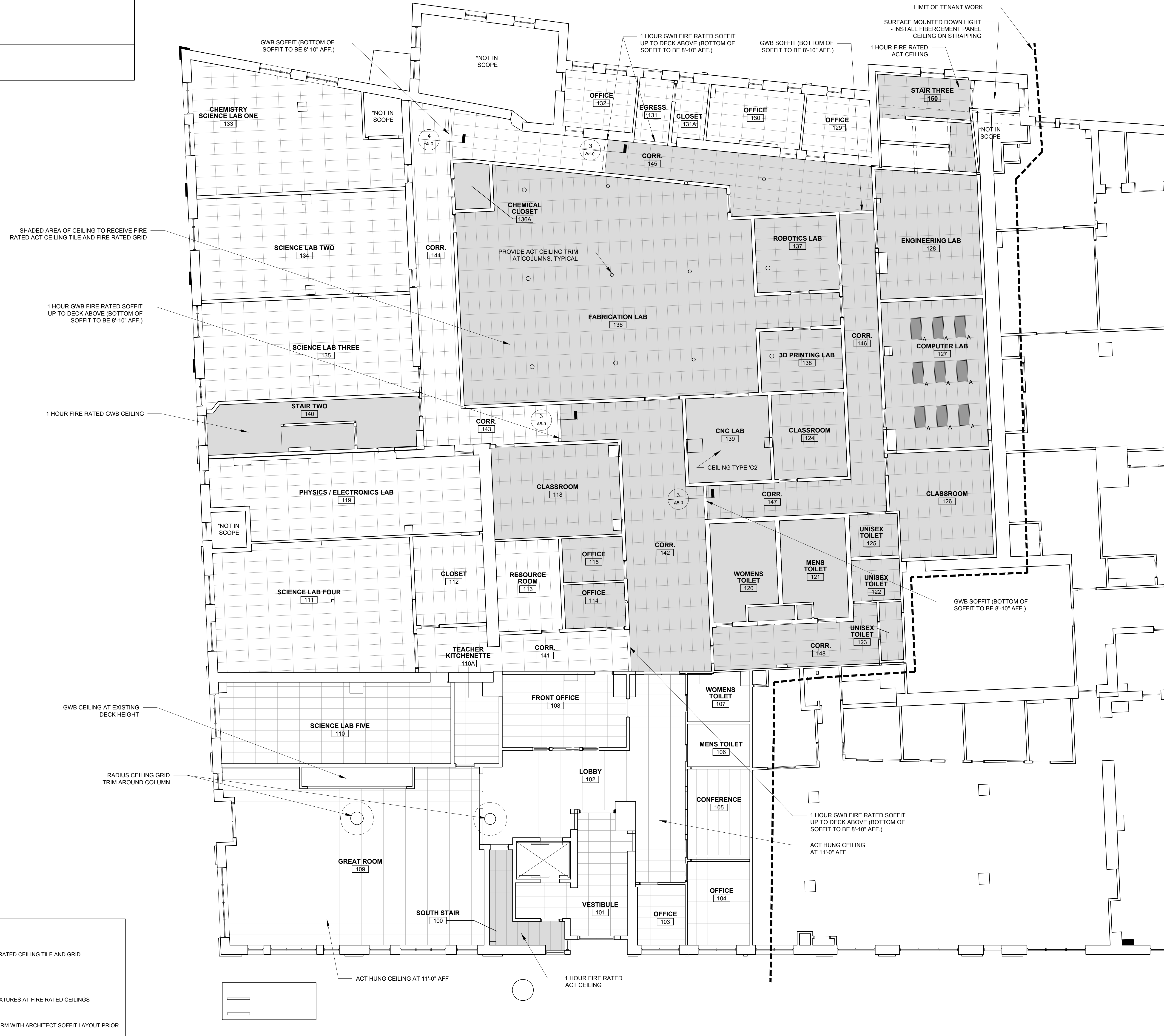

- REFLECTED CEILING PLAN NOTES**
- 1.) CEILINGS TO BE INSTALLED AT 9'-0" MINIMUM ABOVE FINISHED FLOOR (UNLESS OTHERWISE NOTED)
  - 2.) ALL CEILINGS TO BE 2'x4' ACT HUNG CEILINGS WITH GRID UNLESS OTHERWISE NOTED, PROVIDE FIRE RATED CEILING TILE AND GRID WHERE INDICATED ON PLANS
  - 3.) ALL CEILINGS TO HAVE 6" OF SOUND BATT INSULATION PLACED ON TOP OF CEILING AND GRID
  - 4.) LIGHTING LAYOUT NOT SHOWN, PROVIDE LIGHTING LEVELS TO MEET CODE
  - 5.) TYPICAL LIGHT TO BE 2'x4' RECESSED LIGHT TO FIT IN ACT GRID, PROVIDE FIRE RATED AND SEALED FIXTURES AT FIRE RATED CEILINGS
  - 6.) ALL LIGHTING TO BE ON DIMMER SWITCHES
  - 7.) PROVIDE SOFFITS AS REQUIRED AT OPENINGS, HEADERS AND MECHANICAL ELEMENTS, G.C. TO CONFIRM WITH ARCHITECT SOFFIT LAYOUT PRIOR TO CONSTRUCTION

1 FIRST FLOOR REFLECTED CEILING PLAN  
1/8"=1'-0"