

REFLECTED CEILING PLAN NOTES

- 1.) CEILINGS TO BE INSTALLED AT 9'-0" MINIMUM ABOVE FINISHED FLOOR (UNLESS OTHERWISE NOTED)
- 2.) ALL CEILINGS TO BE 2'x4' ACT HUNG CEILINGS WITH GRID UNLESS OTHERWISE NOTED, PROVIDE FIRE RATED CEILING TILE AND GRID WHERE INDICATED ON PLANS
- 3.) ALL CEILINGS TO HAVE 6" OF SOUND BATT INSULATION PLACED ON TOP OF CEILING AND GRID
- 4.) LIGHTING LAYOUT NOT SHOWN, PROVIDE LIGHTING LEVELS TO MEET CODE
- 5.) TYPICAL LIGHT TO BE 2'x4' RECESSED LIGHT TO FIT IN ACT GRID, PROVIDE FIRE RATED AND SEALED FIXTURES AT FIRE RATED CEILINGS
- 6.) ALL LIGHTING TO BE ON DIMMER SWITCHES
- 7.) PROVIDE SOFFITS AS REQUIRED AT OPENINGS, HEADERS AND MECHANICAL ELEMENTS, G.C. TO CONFIRM WITH ARCHITECT SOFFIT LAYOUT PRIOR TO CONSTRUCTION

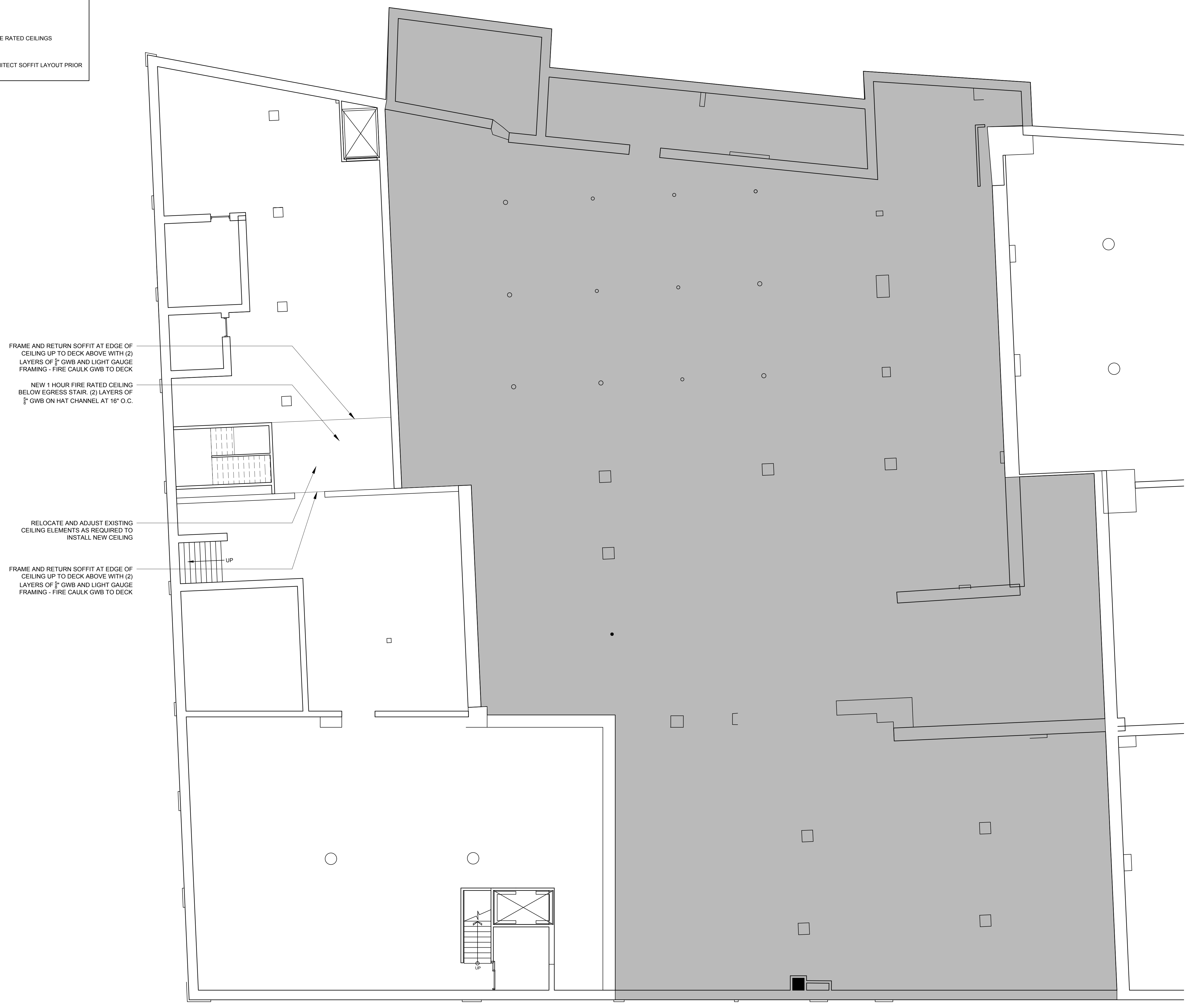

FRAME AND RETURN SOFFIT AT EDGE OF CEILING UP TO DECK ABOVE WITH (2) LAYERS OF 5/8" GWB AND LIGHT GAUGE FRAMING - FIRE CAULK GWB TO DECK

NEW 1 HOUR FIRE RATED CEILING BELOW EGRESS STAIR. (2) LAYERS OF 5/8" GWB ON HAT CHANNEL AT 16" O.C.

RELOCATE AND ADJUST EXISTING CEILING ELEMENTS AS REQUIRED TO INSTALL NEW CEILING

FRAME AND RETURN SOFFIT AT EDGE OF CEILING UP TO DECK ABOVE WITH (2) LAYERS OF 5/8" GWB AND LIGHT GAUGE FRAMING - FIRE CAULK GWB TO DECK

WALL LEGEND	
	EXISTING WALL
	WALL TO BE REMOVED
	NEW WALL



1 BASEMENT REFLECTED CEILING PLAN
1/2" = 1'-0"



© 2017 RYAN SENATORE ARCHITECTURE

BAXTER ACADEMY
INTERIOR FIT-UP
185 LANCASTER STREET, PORTLAND, MAINE

RSA
RYAN SENATORE
ARCHITECTURE
565 CONGRESS STREET
PORTLAND, MAINE 04101
207-650-0414
senatore@rsaarchitecture.com

CONSULTANTS:

REVISIONS:

DATE: 31 JANUARY 2017
PROJECT No. 1648
DRAWN BY: RRT, RJS
CHECKED BY: RJS
SCALE: AS NOTED

SHEET TITLE:
BASEMENT
REFLECTED
CEILING PLAN

A1-3