

DISPLAY THIS CARD ON PRINCIPAL FRONTAGE OF WORK
CITY OF PORTLAND

PERMIT ISSUED
Permit Number: 060679
CITY OF PORTLAND

Please Read Application And Notes, If Any, Attached

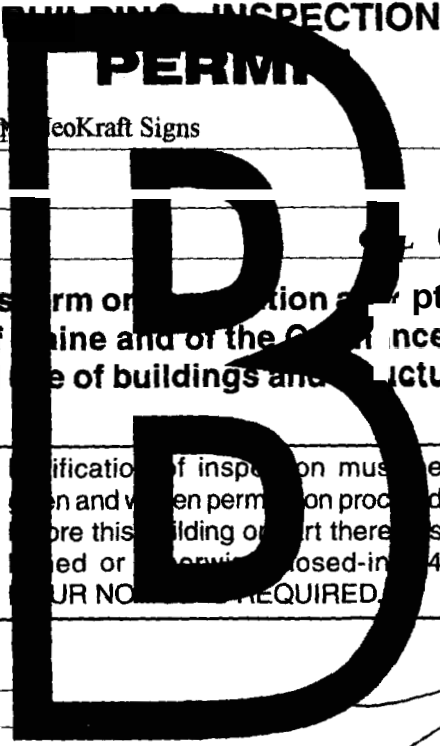

This is to certify that HOWLES CORPORATION NeoKraft Signs

has permission to Install 5 signs to bldg

AT 71 KENNEBEC ST

025 E001001

provided that the person or persons who apply for or obtain this permit shall comply with all of the provisions of the Statutes of Maine and of the Ordinances of the City of Portland regulating the construction, maintenance and use of buildings and structures, and of the application on file in this department.

Apply to Public Works for street line and grade if nature of work requires such information.

ification of inspection must be
en and when permission proceed
before this building or part thereof is
ed or service closed-in 4
OUR NO. REQUIRED.

A certificate of occupancy must be procured by owner before this building or part thereof is occupied.

OTHER REQUIRED APPROVALS

Fire Dept.

Health Dept

Appeal Board

Other

Department Name

[Handwritten Signature]
e/7/02
Director - Building & Inspection Services

PENALTY FOR REMOVING THIS CARD

City of Portland, Maine - Building or Use Permit Application
 89 Congress Street, 04101 Tel: (207) 874-8703. Fax: (207) 874-8716

Location of Construction: 71 KENNEBEC ST	Owner Name: HOWLES CORPORATION
Business Name:	Contractor Name: NeoKraft Signs
Lessee/Buyer's Name	Phone:
Past Use: Commercial - Noyes Self Storage	Proposed Use: Commercial Install 6 signs to bldg - one directional & five with advertising
Proposed Project Description: Install 5 signs to bldg	

Permit No: 06-0679	Issue Date: PERMIT ISSUED	CBL: 025 E001001
Owner Address: PO BOX 938	Phone:	
Contractor Address: 686 Main St. Lewiston	Phone: 2077829654	
Permit Type: Signs - Permanent	Zone: B5	
Permit Fee: \$448.00	Cost of Work: \$448.00	CEO District: 1
FIRE DEPT: <input type="checkbox"/> Approved <input checked="" type="checkbox"/> Denied <i>N/A</i>	INSPECTION: Use Group: <i>U</i> Type: <i>Sign</i> <i>IBC 2003</i>	
Signature:	Signature:	
PEDESTRIAN ACTIVITIES DISTRICT (P.A.D.)		
Action: <input type="checkbox"/> Approved <input type="checkbox"/> Approved w/Conditions <input checked="" type="checkbox"/> Denied		
Signature: _____ Date: _____		

Permit Taken By: dmartin	Date Applied For: 05/05/2006
------------------------------------	--

Zoning Approval		
Special Zone or Reviews <input type="checkbox"/> Shoreland <input type="checkbox"/> Wetland <input type="checkbox"/> Flood Zone <input type="checkbox"/> Subdivision <input type="checkbox"/> Site Plan Maj <input type="checkbox"/> Minor <input type="checkbox"/> MM <input type="checkbox"/> OK Date: 8/7/06 <i>AFB</i>	Zoning Appeal <input type="checkbox"/> Variance <input type="checkbox"/> Miscellaneous <input type="checkbox"/> Conditional Use <input type="checkbox"/> Interpretation <input type="checkbox"/> Approved <input type="checkbox"/> Denied Date:	Historic Preservation <input checked="" type="checkbox"/> Not in District or Landmark <input type="checkbox"/> Does Not Require Review <input type="checkbox"/> Requires Review <input type="checkbox"/> Approved <input type="checkbox"/> Approved w/Conditions <input type="checkbox"/> Denied <i>AFB</i> Date:

CERTIFICATION

I hereby certify that I am the owner of record of the named property, or that the proposed work is authorized by the owner of record and that I have been authorized by the owner to make this application as his authorized agent and I agree to conform to all applicable laws of this jurisdiction. In addition, if a permit for work described in the application is issued, I certify that the code official's authorized representative shall have the authority to enter all areas covered by such permit at any reasonable hour to enforce the provision of the code(s) applicable to such permit.

SIGNATURE OF APPLICANT	ADDRESS	DATE	PHONE
RESPONSIBLE PERSON IN CHARGE OF WORK, TITLE		DATE	PHONE

THIS IS NOT A PERMIT/CONSTRUCTION MAY NOT COMMENCE UNTIL THE PERMIT IS ISSUED

NOYES SELF-STORAGE
U.C.#5903

SIGNAGE APPLICATION

THIS IS NOT A PERMIT
CONSTRUCTION CANNOT NOT COMMENCE UNTIL THE PERMIT IS ISSUED

In the interest of processing your application in the quickest possible manner, please complete the information below Building or Use Permit.

If you or the property owner owes real estate or personal property taxes or user charge on any property within the City, payment arrangements must be made before permits any kind are accepted.

Location/Address of Construction: 71-93 KENNEBEC STREET

Total Square Footage of Proposed Structure 209 S.F. Square Footage of Lot 74,957 S.F.

Tax Assessor's Chart, Block & Lot Number
Chart# 25 Block# E Lot# 001001
Telephone #: 207-775-5876

Lessee/Buyer's Name (If Applicable) NA
Owner's/Purchaser/Lessee Address: NOYES SELF-STORAGE
P.O. Box 938
PORTLAND, ME 04104
Total s.f. of signs 209 x 200\$, plus \$30.00
TOTAL\$ 448

Current use: WAREHOUSE & STORAGE Proposed use: NO CHANGE

Project description:
INSTALL NON-LIT SIGNS ON 6 AREAS OF BUILDING - 5 advertising 1 directional

Applicants Name, Address & Telephone: } NEOKRAFT SIGN CO. 207-782-9654
Contractor's Name, Address & Telephone: } PETER MURPHY
686 MAIN STREET
LEWISTON, ME 04240

Who shall we contact when the permit is ready: PETER MURPHY
Telephone: 782-9654

If you would like it mailed, what mailing address should we use:

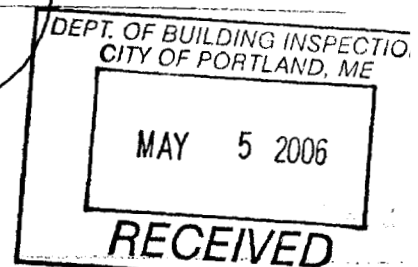

City of Portland, Maine - Building or Use Permit

39 Congress Street, 04101 Tel: (207) 874-8703, Fax: (207) 874-8716

Permit No: 06-0679	Date Applied For: 05/05/2006	CBL: 025 E001001
------------------------------	--	----------------------------

Location of Construction: 11 KENNEBEC ST	Owner Name: HOWLES CORPORATION	Owner Address: PO BOX 938	Phone:
Business Name:	Contractor Name: NeoKraft Signs	Contractor Address: 686 Main St. Lewiston	Phone: (207) 782-9654
Lessee/Buyer's Name	Phone:	Permit Type: Signs - Permanent	

Proposed Use: Commercial Install 6 signs to bldg - one directional & five with advertising	Proposed Project Description: Install 5 signs to bldg
--	---



Dept: Building **Status:** Approved with Conditions **Reviewer:** Tammy Munson **Approval Date:** 0810712006
Note: **Ok to Issue:**

1) Signage Installation to comply with Chapter 31 of the IBC 2003 building code.

Comments:

5/18/06-amachado: Spoke with Peter Murphy at Neocraft. B5 only allows one sign per facade plus one. The application includes 7 signs. Peter will speak to the owner and may appeal the number allowed to planning. He will get back to me.

5/18/06-amachado: Peter Murphy called me back. He and Peter Noyes are working on a letter to explain their position to planning about why they need more than 5 signs. He will send it along when it is done.

6/8/06-amachado: Planning turned down request for seven signs. Left message with Peter Murphy of Neocraft Signs asking him what he wanted to do.

8/2/06-amachado: Shane Moffat called from Neocraft Signs. He wanted to know why the permit was still on hold. When I called him back, I spoke to Peter Murphy and told him that we still had not received the revised sign locations that will meet the zoning requirements.

8/4/06-amachado: Peter Murphy sent in a revised site plan that meets the zoning ordinance.

THIS IS NOT A PERMIT/CONSTRUCTION MAY NOT COMMENCE UNTIL THE PERMIT IS ISSUED

If the property is located in a HISTORIC DISTRICT, a separate sketch is required indicating design, dimensions, construction materials and source of illumination if any. A photograph of the building façade should be submitted, showing where each sign is to be installed.

Certification

I hereby certify that I am the Owner of record of the named property, or that the owner of record authorizes the proposed work and that I have been authorized by the owner to make this application as his/her authorized agent. I agree to conform to all applicable laws of this jurisdiction. In addition, if a permit for work described in this application is issued, I certify that the Code Official's authorized representative shall have the authority to enter all areas covered by this permit at any reasonable hour to enforce the provisions of the codes applicable to this permit.

Signature of applicant: <i>D. W. Munk - NEOKRAFT</i>	Date: <i>5-5-06</i>
--	---------------------

AGENT FOR OWNER

Sign Permit Fee: \$30.00 plus \$2.00 per square foot.

A building permit is also required for any awning based on cost of work-\$30.00 for the first \$1,000.00 at \$6.00 for each additional \$1,000.00

BY FILLING OUT THIS APPLICATION IS DOES NOT MEET THAT YOU WILL BE APPROVED FOR THE AMOUNT OF SIGNAGE YOU ARE APPLYING FOR

IT IS SUGGESTED THAT YOU DO NOT ORDER ANY SIGNAGE UNTIL YOU HAVE RECEIVED YOUR SIGN PERMIT THAT HAS BEEN SIGNED BY THE BUILDING, ZONING AND POSSIBLE HISTORICAL OFFICIALS OF THIS OFFICE

SIGNAGE PRE-APPLICATION

PLEASE ANSWER ALL QUESTIONS

ADDRESS: 93 KENNEBEC STREET ZONE: B5

OWNER: NOYES SELF-STORAGE

APPLICANT: NEOKRAFT SIGN Co.

ASSESSOR NO. 25 - E - 001001

PLEASE CIRCLE APPROPRIATE ANSWER

SINGLE TENANT LOT? YES NO MULTI-TENANT LOT? YES NO
 FREESTANDING SIGN? (ex. Pole sign) YES NO --- DIMENSIONS _____ HEIGHT _____
 MORE THAN ONE SIGN? YES NO DIMENSIONS _____ HEIGHT _____
 SIGN ATTACHED TO BLDG.? YES NO DIMENSIONS _____
 MORE THAN ONE SIGN? YES NO DIMENSIONS _____
 AWNING: YES NO IS AWNING BACKLIT? YES NO HEIGHT OFF SIDEWALK _____
 IS THERE ANY MESSAGE, TRADEMARK OR SYMBOL ON IT? _____

LIST ALL EXISTING SIGNAGE AND THEIR DIMENSIONS:

ALL EXISTING SIGNS WILL BE REPLACED WITH NEW SIGNS

ELM STREET: 134'
 SOMERSET STREET: 457'
 CHESTNUT STREET: 168'
 KENNEBEC STREET: 457'

*** TENANT BLDG. FRONTAGE (IN FEET): _____

*** REQUIRED INFORMATION

AREA FOR COMPUTATION

SIGNS A & B	71 S.F.	5 ft per linear ft of bldg facade placed	36.67 ok
SIGNS C & D	57 S.F.	1 per facade + 1	- 35.5 ok
SIGNS E & F	57 S.F.	(5 ft total)	- 2 ft X 28 ft 56 ft total
SIGN G	24 S.F.		left corner 28 ft; right corner 28 ft
	<u>209 S.F.</u>		36.67
			35.5 @ left corner
			28.5 @ right corner → 87.33 ft total
			23.33

YOU SHALL PROVIDE:

A SITE SKETCH AND BUILDING SKETCH SHOWING EXACTLY WHERE EXISTING AND NEW SIGNAGE IS LOCATED MUST BE PROVIDED. SKETCHES AND/OR PICTURES OF PROPOSED ARE ALSO REQUIRED.

SIGNATURE OF APPLICANT Pete W. Murphy DATE: _____

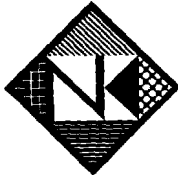

Neokraft

Neokraft Signs Inc.
 686 Main Street
 Lewiston, Maine 04240
 Telephone: 207.782.9654
 Facsimile: 207.782.0009
 1.800.339.2258
<http://www.neokraft.com>

Transmittal to CITY OF PORTLAND
 MS. ANN MACHADO-ZONING
 389 CONGRESS STREET
 PORTLAND, ME 04101

Date 08.3.2006
Job No. 5403
Re. SIGNS

- Item**
- | | | |
|---|---|---|
| <input type="checkbox"/> Attached | <input type="checkbox"/> Hand Delivered | <input type="checkbox"/> Under separate cover |
| <input type="checkbox"/> Shop Drawings | <input type="checkbox"/> Prints | <input type="checkbox"/> Samples |
| <input type="checkbox"/> Copy of letter | <input type="checkbox"/> Change Order | <input type="checkbox"/> Other |
| | | <input type="checkbox"/> Specifications |

Copies	Date	No.	Description
1	08.03.2006	5403	PROPOSED SIGNS

- Purpose**
- | | | |
|---------------------------------------|---|---|
| <input type="checkbox"/> For approval | <input type="checkbox"/> No exception taken | <input type="checkbox"/> Rejected |
| <input type="checkbox"/> For your use | <input type="checkbox"/> Make corrections noted | <input type="checkbox"/> Review and comment |
| <input type="checkbox"/> As requested | <input type="checkbox"/> Revise and resubmit | <input checked="" type="checkbox"/> Other |

Remarks re: Noyes Self Storage, 93 Kennebec Street
 Ann, The enclosed revised drawings illustrate FIVE advertising signs and ONE entrance sign. This should satisfy the City's requirements. Please don't hesitate to contact me if you have any questions.

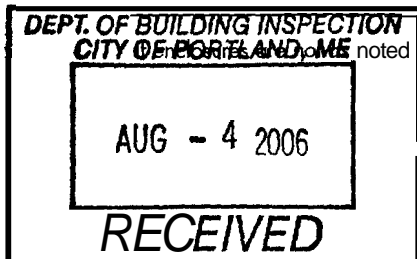

indly notify us at once.

OFFICE \CLERICAL\TEMPLATES\TRANSMITTAL FORM.DOT

From: Deb Andrews
To: Ann Machado
Date: 6/8/2006 2:37:00 PM
Subject: Re: 71 KENNEBEC STREET - Noyes Self Storage

Ann: I have reviewed Noyes Self Storage's request for a special exception to Portland's sign regulations. In order to be granted a special exception, the sign(s) must meet the review criteria set forth in Sec. 14-526 (23) of the Site Plan Ordinance. I find that the proposed signage program, which calls for a total of 7 signs (2 more than 5 signs allowed by ordinance), fails to meet Standards a and b, which read as follows:

a. The size, scale, proportions, design, materials, placement, and source and intensity of illumination of any signage approved shall be designed to complement and enhance the architectural attributes of the building(s) to which they are attached or to which they are visually related. In addition, such signs shall be appropriate to the scale and character of the neighborhood in which the sign is located, and shall be designed to suit the conditions from which it will be viewed, especially in relation to the distance, travel speed, and mode of travel of the viewing public.

b. The signage shall either be of special design merit or shall respond to unique circumstances associated with the subject property.

Deb Andrews

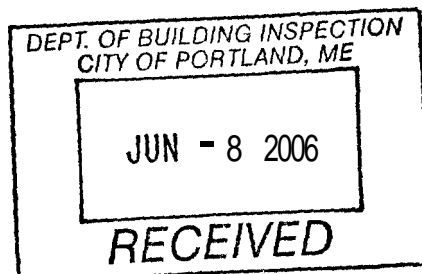

Earle W. Noyes & Sons

Moving Specialists

P.O. Box 938 127 Oxford Street Portland, ME 04104
Phone: (207)775-5876 Toll Free: (800) 341-7576 FAX: (207) 775-5715

May 22, 2006

City of Portland
Attn.: Ms. Ann Machado
389 Congress Street
Portland, ME 04101

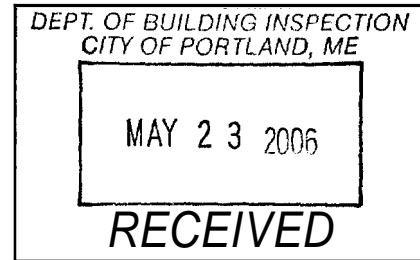

RE: Sign permit application for Noyes Self Storage

Dear Ms. Machado:

Our sign vendor, ~~Neokraft~~ Sign Company, recently filed for a sign permit to install (7) non-lit signs on our building at 93 Kennebec Street. I am aware that the regulations in a B-5 Zone limit the total number of signs to six; however, I would like to have the Planning Department consider our request for (7) signs based upon the following issues:

- The building is very large, filling the space of an entire city block bordered by Elm, Kennebec, Chestnut, and Somerset Streets. The footprint of the building (actually two buildings joined together in the past) is almost 75,000 sq. ft. The impact of the signs is minimal considering the scale of the building.
- All of the signs are important so that vehicular traffic can be targeted considering the traffic patterns of one-way streets. I especially want to be able to target the traffic proceeding up Chestnut Street on the new extension from Marginal Way.
- Because our entrance is not readily evident (it's an overhead door) the sign shown is vitally important to direct customers inside. Keep in mind that we get a certain amount of "walk-in" trade from prospective tenants and with people buying packing supplies.
- Due to the size and shape (curved wall at Kennebec and Elm Streets) of the building, the signs are not readily concurrently visible.

I would like to request further examination of our request for signs for our business. At your request, a member of the Planning Staff could meet at the site with myself and Peter Murphy ~~from~~ Neokraft Sign Company. Please don't hesitate to contact me or Peter Murphy if you should have any questions, or if you should require any additional information. Thank you for your consideration and I look forward to hearing ~~from~~ you soon.

Sincerely,

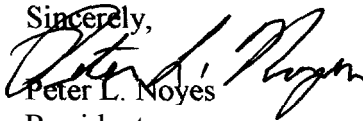
Peter L. Noyes
President

Think of Noyes when you think of moving.

ACORD™ CERTIFICATE OF LIABILITY INSURANCE

DATE (MM/DD/YYYY)
04/14/06

PRODUCER
HRH Northern New England
 959 Congress St
 Portland, ME 04102-2175
 207 553-2131

THIS CERTIFICATE IS ISSUED AS A MATTER OF INFORMATION ONLY AND CONFERS NO RIGHTS UPON THE CERTIFICATE HOLDER. THIS CERTIFICATE DOES NOT AMEND, EXTEND OR ALTER THE COVERAGE AFFORDED BY THE POLICIES BELOW.

INSURERS AFFORDING COVERAGE

NAIC #

INSURED
Earle W. Noyes & Sons Inc.
 P. O. Box 938
 Portland, ME 04104

INSURER A **Hanover Insurance Company**

INSURER B **Maine Approved Sif Ind Tr**

INSURER C **Dirigo RE**

INSURER D:

INSURER E:

INSR	ADD'L TR	TYPE OF INSURANCE	POLICY NUMBER	POLICY EFFECTIVE DATE (MM/DD/YY)	POLICY EXPIRATION DATE (MM/DD/YY)	LIMITS	
A		GENERAL LIABILITY	ZDP521431609	12/31/05	12/31/06	EACH OCCURRENCE	\$1,000,000
		<input type="checkbox"/> COMMERCIAL GENERAL LIABILITY <input type="checkbox"/> CLAIMS MADE <input checked="" type="checkbox"/> OCCUR				DAMAGE TO RENTED PREMISES (Ea occurrence)	\$100,000
		GEN'L AGGREGATE LIMIT APPLIES PER <input type="checkbox"/> POLICY <input type="checkbox"/> PRO-JECT <input type="checkbox"/> LOC				MED EXP (Any one person)	\$5,000
						PERSONAL & ADV INJURY	\$1,000,000
						GENERAL AGGREGATE	\$2,000,000
						PRODUCTS - COMP/OP AGG	\$2,000,000
		AUTOMOBILE LIABILITY				COMBINED SINGLE LIMIT (Ea accident)	\$
		<input type="checkbox"/> ANY AUTO <input type="checkbox"/> ALL OWNED AUTOS <input type="checkbox"/> SCHEDULED AUTOS <input type="checkbox"/> HIRED AUTOS <input type="checkbox"/> NON-OWNED AUTOS				BODILY INJURY (Per person)	\$
						BODILY INJURY (Per accident)	\$
						PROPERTY DAMAGE (Per accident)	\$
		GARAGE LIABILITY				AUTO ONLY - EA ACCIDENT	\$
		<input type="checkbox"/> ANY AUTO				OTHER THAN AUTO ONLY: EA ACC	\$
						AGG	\$
		EXCESS/UMBRELLA LIABILITY				EACH OCCURRENCE	\$
		<input type="checkbox"/> OCCUR <input type="checkbox"/> CLAIMS MADE				AGGREGATE	\$
		<input type="checkbox"/> DEDUCTIBLE <input type="checkbox"/> RETENTION \$					\$
B C		WORKERS COMPENSATION AND EMPLOYERS' LIABILITY	Self Insured Fd Yr Excess W.C.	02/01/06 01/01/06	02/01/07 01/01/07	<input checked="" type="checkbox"/> WCSTATU- OTH-	
		ANY PROPRIETOR/PARTNER/EXECUTIVE OFFICER/MEMBER EXCLUDED? If yes, describe under SPECIAL PROVISIONS below				E.L. EACH ACCIDENT	\$1,000,000
		OTHER				E.L. DISEASE - EA EMPLOYEE	\$1,000,000
						E.L. DISEASE - POLICY LIMIT	\$1,000,000

DESCRIPTION OF OPERATIONS/ LOCATIONS/ VEHICLES/ EXCLUSIONS ADDED BY ENDORSEMENT/ SPECIAL PROVISIONS

Neokraft Signs, Inc.
 Attn: Peter Murphy
 686 Main Street
 Lewiston, ME 04240

SHOULD ANY OF THE ABOVE DESCRIBED POLICIES BE CANCELLED BEFORE THE EXPIRATION DATE THEREOF, THE ISSUING INSURER WILL ENDEAVOR TO MAIL 30 DAYS WRITTEN NOTICE TO THE CERTIFICATE HOLDER NAMED TO THE LEFT, BUT FAILURE TO DO SO SHALL IMPOSE NO OBLIGATION OR LIABILITY OF ANY KIND UPON THE INSURER, ITS AGENTS OR REPRESENTATIVES.

AUTHORIZED REPRESENTATIVE

Andrie M. Schedr

THIS IS NOT A PERMIT/CONSTRUCTION MAY NOT COMMENCE UNTIL THE PERMIT IS ISSUED

Please **check off the following indicating that you have included** the below items to expedite the process of this sign application:

- "Certification of Liability" listing the City additionally insured if any portion of the *sign* abuts or encroaches on the public right of way, or can fall into the public right of way
- N/A* Letter of permission from the owner *DOES NOT APPLY*

A sketch plan indicating the following:

- Drawing of the property showing all dimensions of the lot
- Location of all buildings and property setbacks from all buildings
- Driveways and abutting streets showing street frontage and any right of ways
- Indicate **OR** drawing the dimensions of all buildings on the lot
- Define in footage the frontage of your business front
- Indicate on drawing of existing signage and dimensions of each sign *EXISTING TO BE REPLACED*
- Indicate on drawing all proposed signage and dimension of each sign
- N/A* Sign area height and setback of each existing and proposed freestanding sign
- N/A* Certification of flammability required for awning/canopy at time of application
- N/A* UL # required for lighted signs at the time of Final Inspection. Failure to provide this information will invalidate the Sign Permit.

The Provisions of Section **3102.0** of the City's Building Code "The BOCA National **Building** Code 1999 edition" shall govern the construction, alteration, repair and maintenance of outdoor signs together with the associated appurtenant and auxiliary devices in respect to structural and fire safety. In accordance to section 3102.4.4 of BOCA construction documents and owners consent is all follows; "Before any permit is issued for the erection of a sign, Construction Documents shall be filed with the code official showing the dimensions, materials and required details of construction, including loads, stresses and anchorage. The applications shall be accompanied by the written contract of the owner or lessees of the premises upon which the sign is to erected. **NO PERMIT CAN OR WILL BE ISSUED UNLESS THIS INFORMATION IS SUBMITTED AND APPROVED BY THE INSPECTIONS OFFICE.**

ELECTRICAL SIGNAGE PERMITS/RESPONSIBILITIES

All sign companies or any persons engaged in the installation, interchange or maintenance of signage in the City of Portland must have the Electrician or Electrical Contractor who provided power to the sign(s) or associated equipment apply for an electrical permit in the Inspections Office.

It is the responsibility of your company to contact your sub-contractor or the owner to inform them of this policy. Whether your company does the final connections, which requires a valid Maine Electricians License or your sub contractor provides this service; permits and inspections shall be required.

Failure to comply with this procedure may result in the denial of sign permits by this office for your company or its representation to install or interchange any future signage in the City of Portland.

INFORMATION REQUIREMENTS FOR SIGN PERMIT APPLICATION

Applicants for a sign permit will be asked to submit the following information to the Code Enforcement Office:

1. ✓ Proof of insurance
2. Letter of permission from the owner *DOES NOT APPLY*
3. ✓ A sketch plan of lot, indicating location of buildings, driveways and any abutting streets or right of ways. Lengths of building frontages and street frontages should be noted. (see attached)
4. ✓ Indicate on the plan all existing and proposed signs *EXISTING TO BE REPLACED*
5. Computation of the following:
 - A) Sign area of each existing and proposed building sign
 - B) *N/A* Sign area height and setback of each existing and proposed freestanding sign.
6. ✓ A sketch of any proposed sign(s), indicating dimensions, materials, source of illumination and construction method (see attached).
7. *N/A* Certificate of flammability required for awning/canopy at time of application.
8. *N/A* UL # required for lighted signs at the time of application.
9. ✓ **You must have complete structural details (i.e. showing all connections to buildings and footing details) Specifics required or your permit may be held up**

Fee for permit - \$30.00 plus \$1.00 per square foot

Fee for awning based on cost of work - \$30.00 for the first \$1,000.00, \$6.00 for each additional \$1,000.000.

NOTE: Once a sketch plan has been filed for a property, the code enforcement office will **keep** a record of the plan so that a new sketch plan will not be required for later changes to signage on the property. In such an instance, applicants will only be required to submit information applicable to the new sign.

701.227

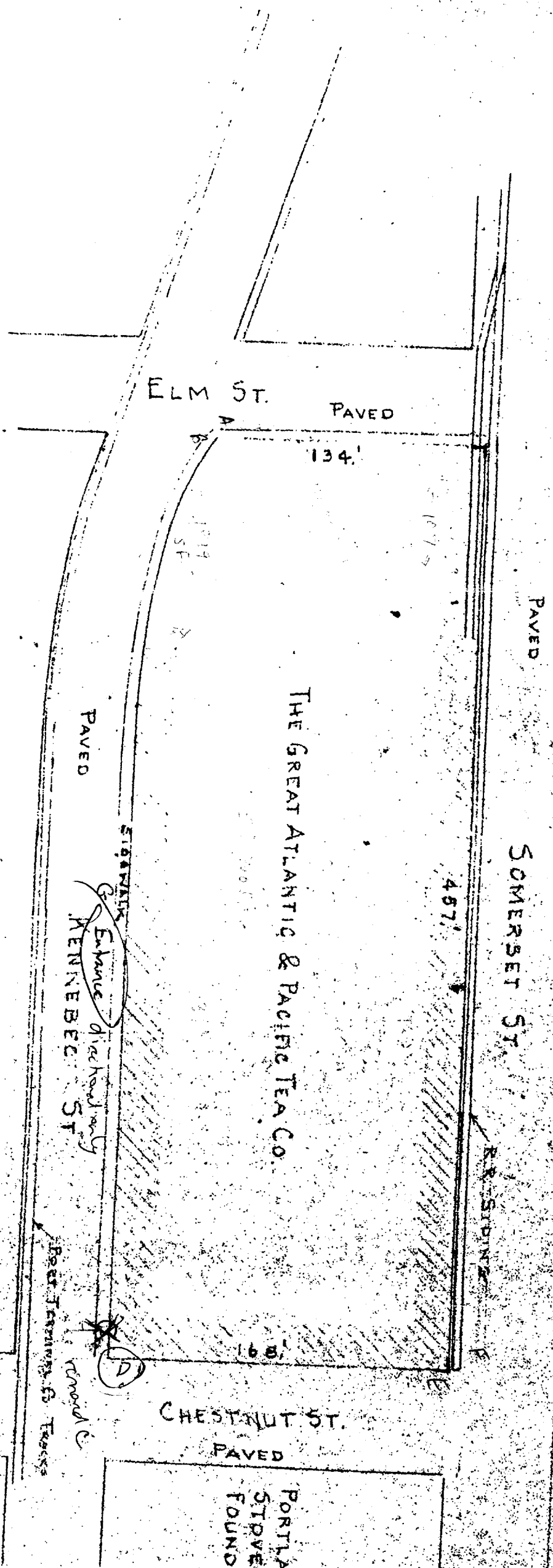

PLOT PLAN
 SCALE "1"=50'-0" REDUCED

CUSHMAN'S BAKERY

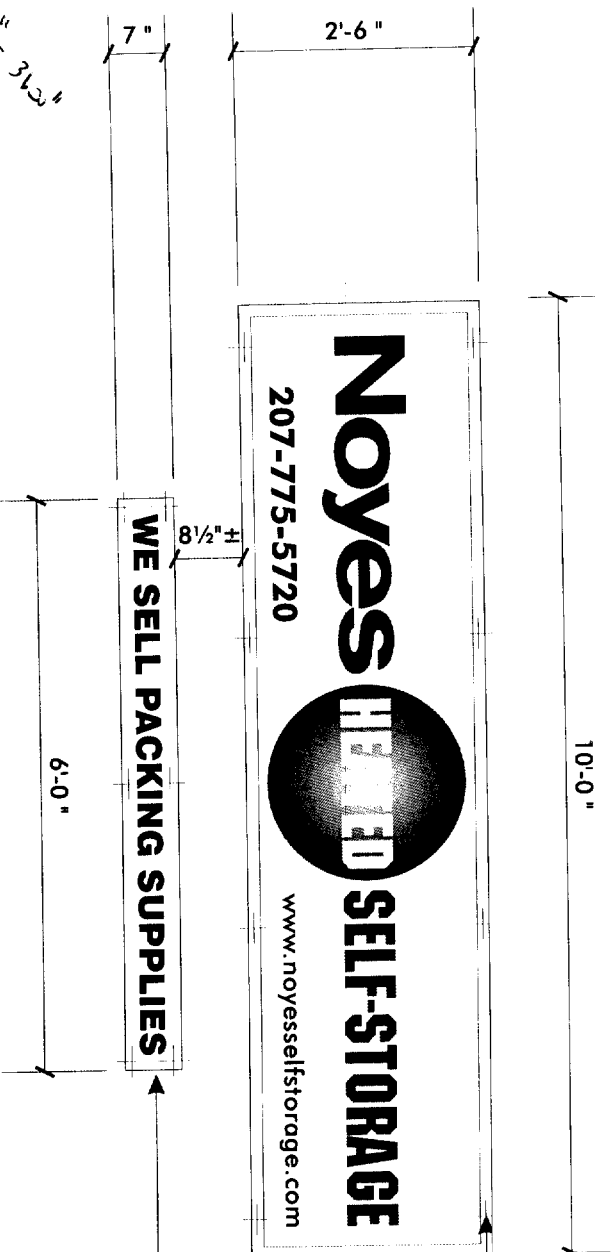

SIGN TYPE C - TYPE B SINGLE FACE NON-LIGHTED WALL SIGNS
SCALE: 1/2" = 1'-0"

$$\begin{array}{r}
 335" \times 120" = 312' \\
 + 25' \\
 \hline
 340' \\
 340' \times 120" = 308'
 \end{array}$$

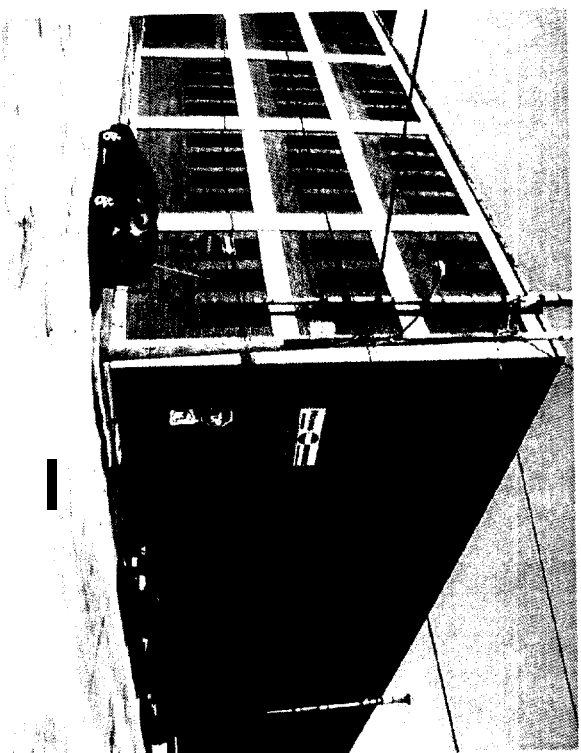

PHOTO COMPOSITE—CORNER OF KENNEBEC AND CHESTNUT
 NO SCALE

(14) TOTAL FASTENERS; SEE PAGE 3 FOR FASTENER DETAILS

TYPE C (MAKE 3) SEE PHOTO BELOW FOR LOCATIONS
 FABRICATED ALUMINUM TUBE SIGNS WITH DROP LIP
 RETAINERS, PAINTED WHITE
 FIRST SURFACE VINYL GRAPHICS: GSP ROYAL BLUE [220-87],
 GSP BLACK [220-12] AND DURACHROME PRINTED ORANGE
 GRADIENT BACKGROUND WITH WHITE COPY

TYPE B FABRICATION FROM PAGE 1
 SEE PHOTO BELOW FOR LOCATIONS
 FLAT ALUMINUM PANEL WITH GSP CARDINAL RED [220-53]
 VINYL GRAPHICS; MOUNT CENTERED BELOW MAIN SIGN

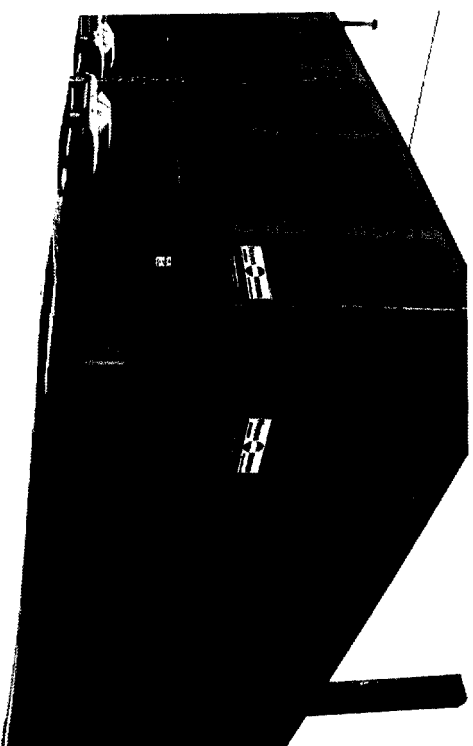
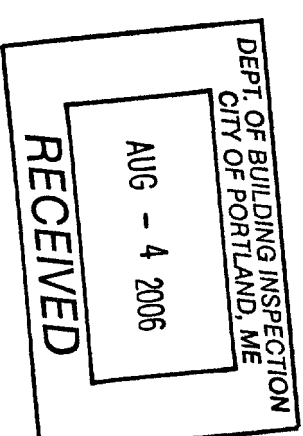
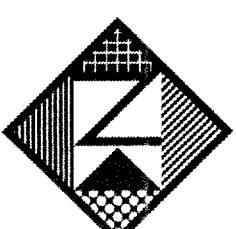

PHOTO COMPOSITE—CORNER OF SOMERSET AND CHESTNUT
 NO SCALE



Neokraft
 S I G N S

Neokraft Signs Inc.
 686 Main Street
 Lewiston, Maine 04240
 Telephone: 207.782.9654
 Facsimile: 207.782.0009
 1.800.339.2258
<http://www.neokraft.com>

Custom Sign Fabrication

Except for designs supplied by the client, all ideas, plans or arrangements indicated on this drawing are copyrighted and owned by Neokraft Signs Inc. and shall not be reproduced, used by or disclosed to any person, firm or corporation without written permission of Neokraft Signs Inc.

Noyes Self Storage
5403

Location:	93 Kennebec Portland, ME
Drawing No.:	2 of 4
Drawn by:	BK
Date:	06.27.2006
Gen Ref.:	

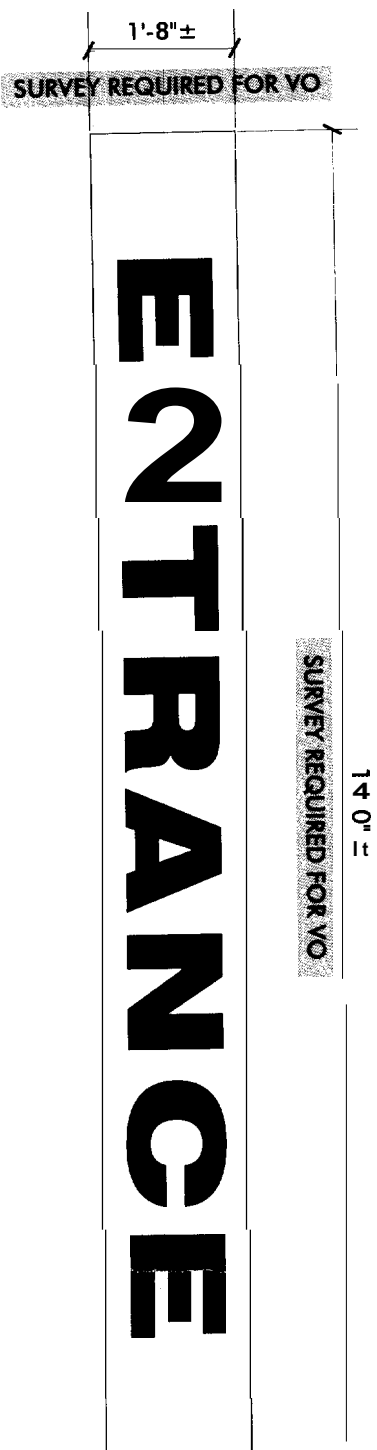

WHITE ALUMINUM OVERLAY PANEL TO COVER EXISTING FACE
 CARDINAL RED VINYL COPY (220-53)

SIGN TYPE D FACE FOR EXISTING NON-LIGHTED WALL SIGN
 SCALE: 1/2" = 1'-0" (1) REQUIRED

DEPT. OF BUILDING INSPECTION
 CITY OF PORTLAND, ME
 AUG - 4 2006
 RECEIVED



PHOTO—EXISTING
 NO SCALE



PHOTO COMPOSITE
 NO SCALE

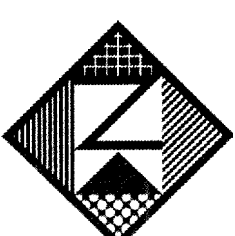

Neokraft
 S I G N S

Neokraft Signs Inc.
 686 Main Street
 Lewiston, Maine 04240
 Telephone: 207.782.9654
 Facsimile: 207.782.0009
 1.800.339.2258
<http://www.neokraft.com>
 Custom Sign Fabrication

Except for designs supplied by the client, all ideas, plans or arrangements indicated on this drawing are copyrighted and owned by Neokraft Signs Inc and shall not be reproduced, used by or disclosed to any person, firm or corporation without written permission of Neokraft Signs Inc.

Noyes Self Storage
5403

Location:	93 Kennebec Portland, ME
Drawing No.:	4 of 4
Drawn by:	BK
Date:	06.27.2006
Gen Ref.:	

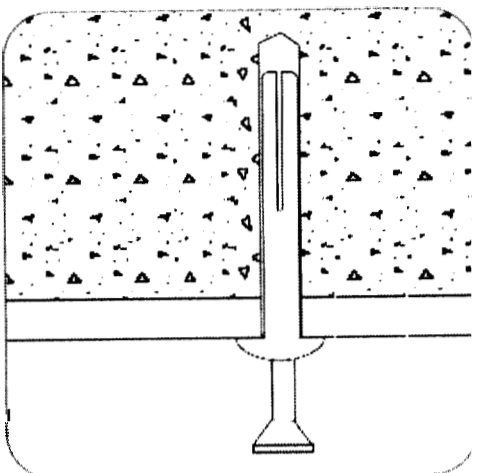

**ZAMAC HAMMER SCREW™ DRIVE ANCHORS
AS MFG BY POWERS FASTENERS, NEW
ROCHELLE, NY OR EQUAL:**

ZAMAC ALLOY WITH CARBON OR STAINLESS STEEL,
ONE-STEP DRIVE ANCHOR FEATURING A PHILLIPS
TYPE HEAD AND A SCREW THREAD FOR USE IN
CONCRETE, BLOCK, BRICK OR STONE

SIZE RANGE: 1/4" DIA. X 3/4" TO 3" LONG

**SIGNS 1 & 2—DRIVE-ANCHOR MOUNTING DETAIL
NOT TO SCALE**

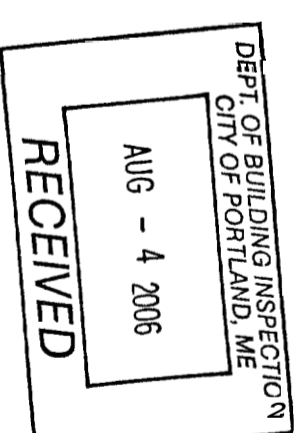

Powers Fasteners, New Rochelle, NY

Zamac Hammer-Screw®

BASE MATERIAL

Concrete, Block, Brick, Stone

SIZE RANGE

1/4" x 3/4" to 1 1/2" x 3"

ANCHOR MATERIAL

Zamac Alloy with Carbon or Stainless Steel Drive Screw

The Zamac Hammer-Screw is a unique, one-step drive anchor featuring a Phillips type head and a screw thread for use in concrete, block, brick or stone. It is available in a 1/4" diameter and lengths ranging from 3/4" to 3".

PRODUCT DESCRIPTION

With a body formed from corrosion resistant Zamac alloy and a carbon or stainless steel drive screw, this anchor has been developed as an improvement over standard nailin anchors.

Traditionally, Zamac Nailin anchors have been used for light duty, non-engineered applications and have not been recommended for use overhead. In order to overcome these problems, the Zamac Hammer-Screw has been designed to provide a removable anchor with up to 40% higher tension load capacities when installed in concrete.

While the standard Zamac Nailin has not been recommended for use overhead, the Zamac Hammer-Screw can be used overhead provided it is designed by an engineer who will take the proper design considerations and safety factors into account.

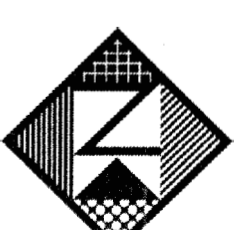

Neokraft
S I G N S

Neokraft Signs Inc.
686 Main Street
Lewiston, Maine 04240
Telephone: 207.782.9654
Facsimile: 207.782.0009
1.800.339.2258
<http://www.neokraft.com>

Custom Sign Fabrication

Except for designs supplied by the client, all ideas, plans or arrangements indicated on this drawing are copyrighted and owned by Neokraft Signs Inc. and shall not be reproduced, used by or disclosed to any person, firm or corporation without written permission of Neokraft Signs Inc.

**Noyes Self
Storage5403**

Location:	93 Kennebec
	Portland, ME
Drawing No.:	3 of 4
Drawn by:	BK
Date:	06.27.2006
Gen Ref.:	