

- GENERAL NOTES**
- ELEVATION OF EXISTING UTILITIES AS SHOWN ON THESE PLANS IS BASED ON RECORDS OF THE PORTLAND UTILITIES DEPARTMENT. THE CONTRACTOR SHALL VERIFY THE LOCATION AND DEPTH OF ALL UTILITIES BEFORE ANY EXCAVATION OR CONSTRUCTION. THE CONTRACTOR SHALL BE RESPONSIBLE FOR OBTAINING ALL NECESSARY PERMITS AND APPROVALS FROM THE CITY OF PORTLAND AND THE PORTLAND UTILITIES DEPARTMENT. THE CONTRACTOR SHALL BE RESPONSIBLE FOR PROTECTING ALL UTILITIES WHICH DO NOT INTERFERE WITH THE PROPOSED WORK.
 - UTILITIES SHALL BE CONSTRUCTED IN ACCORDANCE WITH THE APPLICABLE STANDARDS OF THE CITY OF PORTLAND AND AFFECTED UTILITY OWNERS.
 - LOCATION OF UTILITY STRUCTURES AND INSETS OF OPEN UTILITIES MAY BE ADJUSTED TO MEET FIELD CONDITIONS, ONLY AFTER PRIOR APPROVAL OF THE OWNER, THE AFFECTED UTILITY COMPANY, AND THE CITY OF PORTLAND.
 - SITE CONTRACTOR TO BRING SANITARY AND WATER SERVICE INSIDE FOUNDATION WALL.
 - WHERE STORM DRAIN OR SEWER MAINS HAVE LESS THAN FOUR (4) FEET OF COVER BETWEEN THE TOP OF PIPE AND FINISH GRADE INSULATE PIPE USING TWO (2) INCH THICK STYROFOAM INSULATION BOARD OVER AND ALONG SIDES OF THE PIPE.
 - WHERE ELECTRICAL CONDUIT COVERS OFF UTILITY POLE, MUST BE RIGID CONDUIT AND BE ENCASED IN CONCRETE FOR FIRST TEN FEET.
 - LIMIT OF WORK SHALL BE THE FIVE LIVER COMPANY PROPERTY LINE UNLESS OTHERWISE SHOWN.
 - NO SOIL SHALL BE REMOVED FROM SITE.

STORY DRAIN SCHEDULE

STORY	FINISH GRADE	INVERT	OUTLET
C.B. #1	8.90	8.90	5.98
C.B. #2	8.60	8.60	5.81
C.B. #3	9.20	9.20	5.71
VORTEC STRUCTURE	10.30	10.30	5.45
INVERT	5.45	5.45	5.35

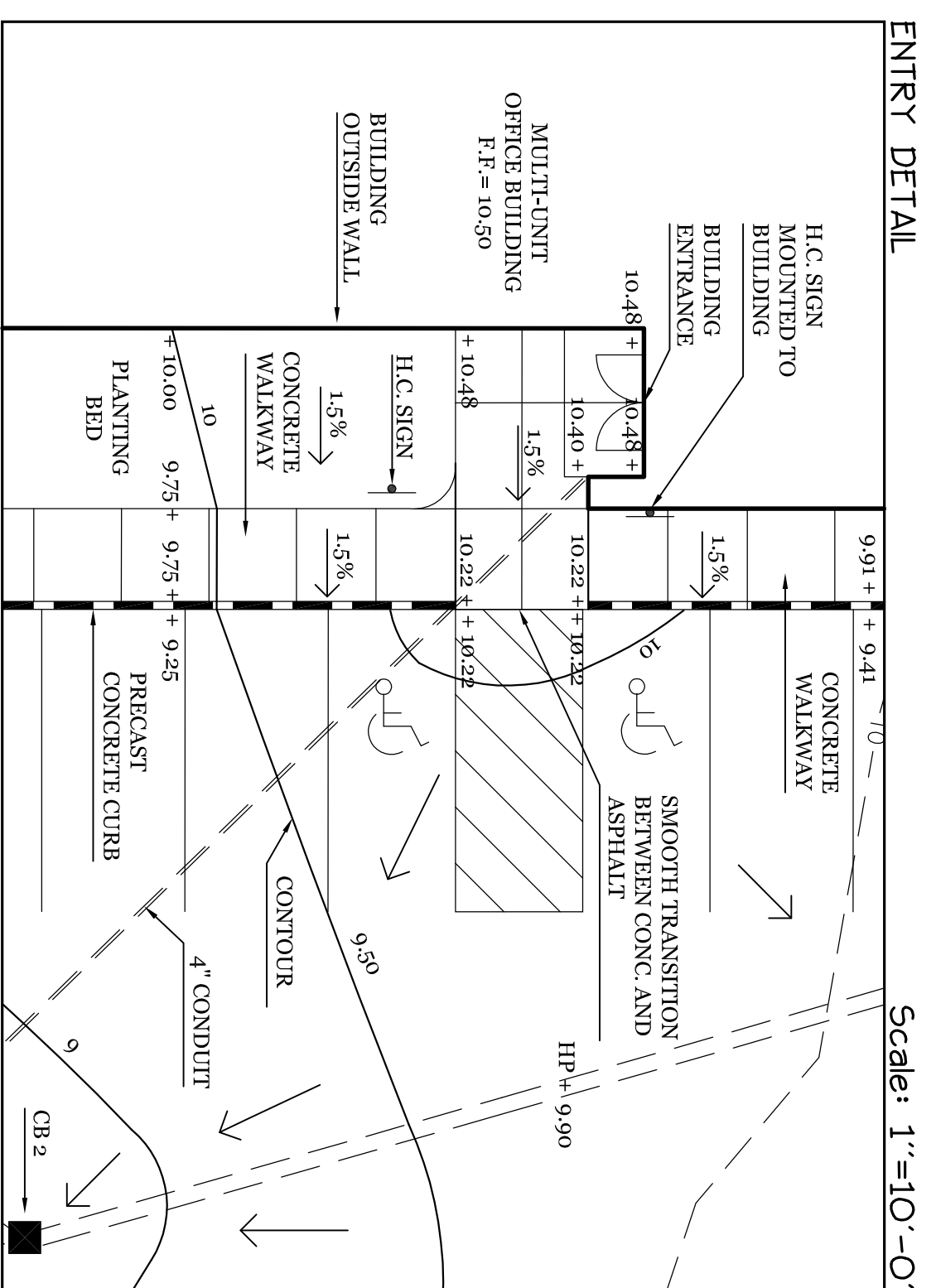

LEGEND

PROPERTY LINE	EXISTING	PROPOSED	STREET SIGN	EXISTING	PROPOSED
GRANITE MONUMENT	[Symbol]	[Symbol]	BUILDING UP-LIGHT	[Symbol]	[Symbol]
IRON PIPE	[Symbol]	[Symbol]	CURT WIRE	[Symbol]	[Symbol]
EASHPENT	[Symbol]	[Symbol]	GATE VALVE	[Symbol]	[Symbol]
GRANITE CURB	[Symbol]	[Symbol]	GAS MAIN	[Symbol]	[Symbol]
PRECAST CONC. CURB	[Symbol]	[Symbol]	UNDERGROUND ELEC.	[Symbol]	[Symbol]
CONTOUR	[Symbol]	[Symbol]	UNDERGROUND TELE.	[Symbol]	[Symbol]
CATCHBASIN	[Symbol]	[Symbol]	OVERHEAD ELEC. + TELE.	[Symbol]	[Symbol]
MANHOLE	[Symbol]	[Symbol]	WATER	[Symbol]	[Symbol]
HYDRANT	[Symbol]	[Symbol]	GAS	[Symbol]	[Symbol]
UTILITY POLE	[Symbol]	[Symbol]	SANITARY	[Symbol]	[Symbol]
PEDESTRIAN LIGHT	[Symbol]	[Symbol]	SEWER DRAIN	[Symbol]	[Symbol]
PARKING LOT LIGHT	[Symbol]	[Symbol]			
FENCE	[Symbol]	[Symbol]			
SPOT ELEVATION	[Symbol]	[Symbol]			
HANDICAP SIGN	[Symbol]	[Symbol]			

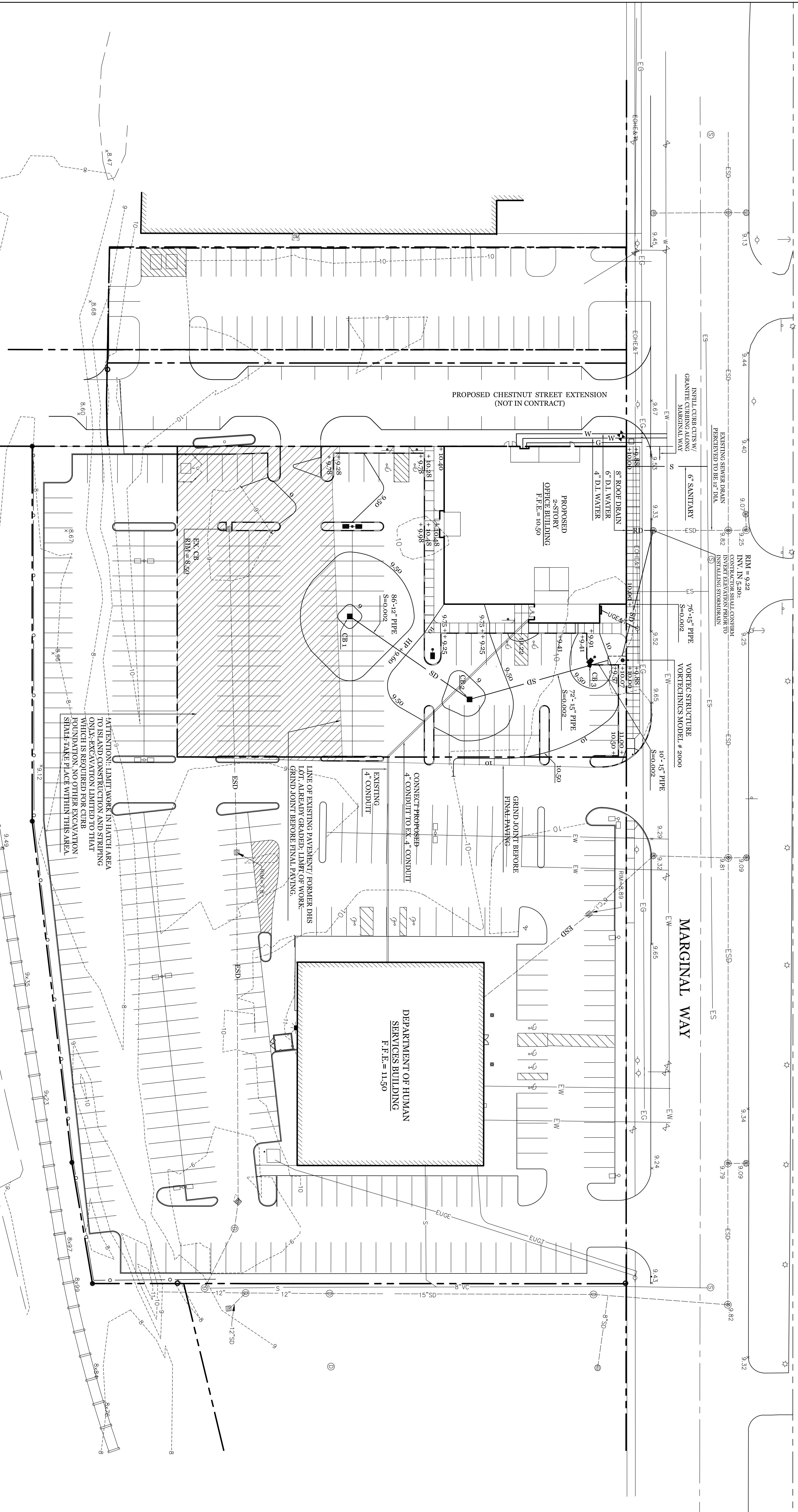

Prepared For:
Owner/Applicant:
FIVE LIVER COMPANY
5 Milk Street
Portland, Maine 04112
(207) 772-0404

Prepared By:
MITCHELL & ASSOCIATES
Landscape Architects
70 Campbell Street
Portland, Maine 04101
Tel: (207) 774-4427

MULTI-TENANT OFFICE BUILDING

135 Marginal Way Portland, Maine

Date:
JULY 7, 2004

Revisions:

Scale: 1"=30'

0 15 30 60

North: [North Arrow]

Sheet No.:
3

Reproduction or reuse of this document without the express written consent of Mitchell & Associates is prohibited.

Title:
GRADING, DRAINAGE & UTILITIES PLAN