

2 1/2" Ø OF 2 1/2" DIAMETER STAKES WITH #12 GAUGE WIRE ENCASED IN 2-1/2" RENEWABLE RUBBER HOSE 1/2" APART. ONE 2 STAKES LOCATED BEHIND STAKES SHALL BE FINELY SET TO REMOVE NECESSARY TENSION.

REMOVE PLASTIC BARREL... AT LEAST THE TOP 1/3 OF ROOTBALL OR MORE IF THE ROOTBALL IS PINE OR MORE THAN ONE TRUNK. EARTH SAUCER (S) THIS SOIL 10%--SEE NOTE ABOVE UNDISTURBED SUBGRADE

1 TREE + SHRUB INSTALLATION
NOT TO SCALE

PLANT LIST

KEY	QTY	BOTANICAL NAME	COMMON NAME	SIZE
M. PN	10	MALUS FINKSRIE	FINKSRIE CRAB	15-20" CAL.
F. CA	2	FITUS CALLETRIANA 'ARISTOCRAT'	ARISTOCRAT ORNAMENTAL PEAR	15-20" CAL.
A. KAR	13	AZALEA KAREN	KAREN AZALEA	15-18" HT.
E. CAM	5	EUONITHUS CAMPANULATUS	REDYEN EUONITHUS	3-4' HT.
E. FEG	3	EUONITHUS FORTUNEI 'EMERALD GALETY'	EMERALD GALETY EUONITHUS	15-18" HT.
J. CPN	18	JUNIPERUS CHINENSIS 'PROCELIBENS NANA'	DWARF JAPANESE GARDEN JUNIFER	18-24" HT.
J. HW	33	JUNIPERUS HORIZONTALIS 'WILTON'	DWARF RUG JUNIFER	18-24" HT.
P. SN	2	PRUNUS STROBUS 'NANA'	DWARF WHITE PINE	18-24" HT.
R. AQL	7	RHOODODENDRON 'AQUO'	AQUO RHODODENDRON	18-24" HT.
R. RA	7	ROSA RUGOSA 'ALBA'	WHITE RUGOSA ROSE	18-24" HT.
R. RR	7	ROSA RUGOSA 'RUBRUM'	RED RUGOSA ROSE	18-24" HT.
S. JNC	6	SIBYRINIUM TORmentosum	DOUBLEFILE WIKERUNN	2-4' HT.
H.500	80	HERESYCALIS STELLA DE ORO	STELLA DE ORO DALLLY	1 QT.

GENERAL NOTES

- TOTAL SITE AREA: BUILDING PARCEL: 115 ACRES
- ZONING DISTRICT: B-5 URBAN COMMERCIAL BUSINESS
- OWNER BUILDING PARCEL: FIVE LIVERS COMPANY 574 LIVER STREET PORTLAND, MAINE 04101
- SPACE AND BULK REQUIREMENTS: ALLOWED: PROPOSED: 5200 SQ. FT. 18643 SQ. FT. 18643 SQ. FT. 148' 148' 148' 148' 22 PERCENT 26643 FEET 28 FEET
- PARCEL REQUIREMENTS: REQUIRED: 94 SPACES PROPOSED: 94 SPACES
- OFFICE BUILDING SUMMARY: N/A
- EXISTING CONDITIONS AND BOUNDARY INFORMATION FROM A PLAN ENTITLED "WATER-SET STREET PORTLAND, MAINE" FOR FIVE LIVERS COMPANY DATED JULY 1989 DWG NO. C-100 PROJ NO. 84501
- BENCHMARK ELEVATIONS ARE BASED ON THE MEAN SEA LEVEL - PORTLAND WAY - FRANKLIN ARTERIAL.
- LEFT OF WORK SHALL BE AS SHOWN.

PLANTING NOTES

- CALL DG-SAFE (1-888-344-7233) PRIOR TO BEGINNING WORK. THE LANDSCAPE CONTRACTOR IS ADVISED OF THE PRESENCE OF UNDERGROUND UTILITIES AND SHALL VERIFY THE EXISTENCE AND LOCATION OF SAME BEFORE COMMENCING ANY WORK OF EXCAVATION, PAVING, WALKS, CURBING, ETC. DAMAGED IN PERFORMANCE OF THIS JOB AT NO ADDITIONAL COST TO OWNER.
- CONTRACTOR SHALL THOROUGHLY FAMILIARIZE HIMSELF WITH ALL SITE CONDITIONS PRIOR TO CONSTRUCTION BIDDING. ANY DISCREPANCIES BETWEEN DRAWINGS, DETAILS, NOTES AND ARCHITECT'S FIELD LATER DIRECTION AND RESOLUTION BEFORE ANY ADDITIONAL WORK PROCEEDS.
- DO NOT SCALE FROM DRAWINGS. ANY DIMENSIONS IN DIMENSIONING SHALL BE REPORTED IMMEDIATELY TO THE LANDSCAPE ARCHITECT.
- PROVIDE SMOOTH TRANSITION WHERE NEW WORK MEETS EXISTING CONDITIONS.
- CONTRACTOR SHALL FINISH AND PLACE 12 INCHES OF LOAM IN ALL SHRUB BEDS. 30 NOTES IN ALL TREE FITS, AND 6 INCHES UNDER ALL TREE AREAS. THE LANDSCAPE CONTRACTOR SHALL BE RESPONSIBLE FOR THE GENERAL MAINTENANCE OF THE LANDSCAPE PRIOR TO FINISHING LOAM.
- ALL PLANT MATERIAL INSTALLED SHALL MEET THE SPECIFICATIONS OF THE AMERICAN STANDARDS FOR NURSERY STOCK BY THE AMERICAN ASSOCIATION OF NURSERYMEN.
- ALL PLANT MATERIAL SHALL BE FREE FROM INSECTS AND DISEASE.
- ALL PLANTING SHALL BE DONE IN ACCORDANCE WITH ACCEPTABLE HORTICULTURAL PRACTICES. THIS IS TO INCLUDE PROPER PLANTING, WEEDING, SPRAYING, FERTILIZING, PLANNING AND ADJUTATE MAINTENANCE UNTIL ACCEPTANCE FROM THE OWNER.
- ALL PLANTING AREAS PRIOR TO PLANTING.
- ALL SHRUB BEDS AND TREE FITS SHALL BE MULCHED WITH 3" CLEAN SIEVED BARK MULCH.
- ALL PLANTING SHALL BE DONE IN ACCORDANCE WITH ACCEPTABLE HORTICULTURAL PRACTICES. THIS IS TO INCLUDE PROPER PLANTING, WEEDING, SPRAYING, FERTILIZING, PLANNING AND ADJUTATE MAINTENANCE UNTIL ACCEPTANCE FROM THE OWNER.
- WHERE INDICATED ON PLAN PLANTING SOIL MIXTURE FOR GROUND COVER AND/OR SPECIAL BED AREAS SHALL CONSIST OF FOUR PARTS TOP SOIL AND ONE PART SAND. ONE PART SAND AND ONE PART TOP SOIL SHALL BE SUBSTITUTED WITH WELL-ROTTED OR DEHYDRATED MANURE OR COMPOST. ROTOTILL BEDS TO A DEPTH OF 8 INCHES.
- DAMAGE TO EXISTING SHALL BE THE RESPONSIBILITY OF THE LANDSCAPE CONTRACTOR.
- DO NOT REMOVE ANY SOILS FROM SITE.

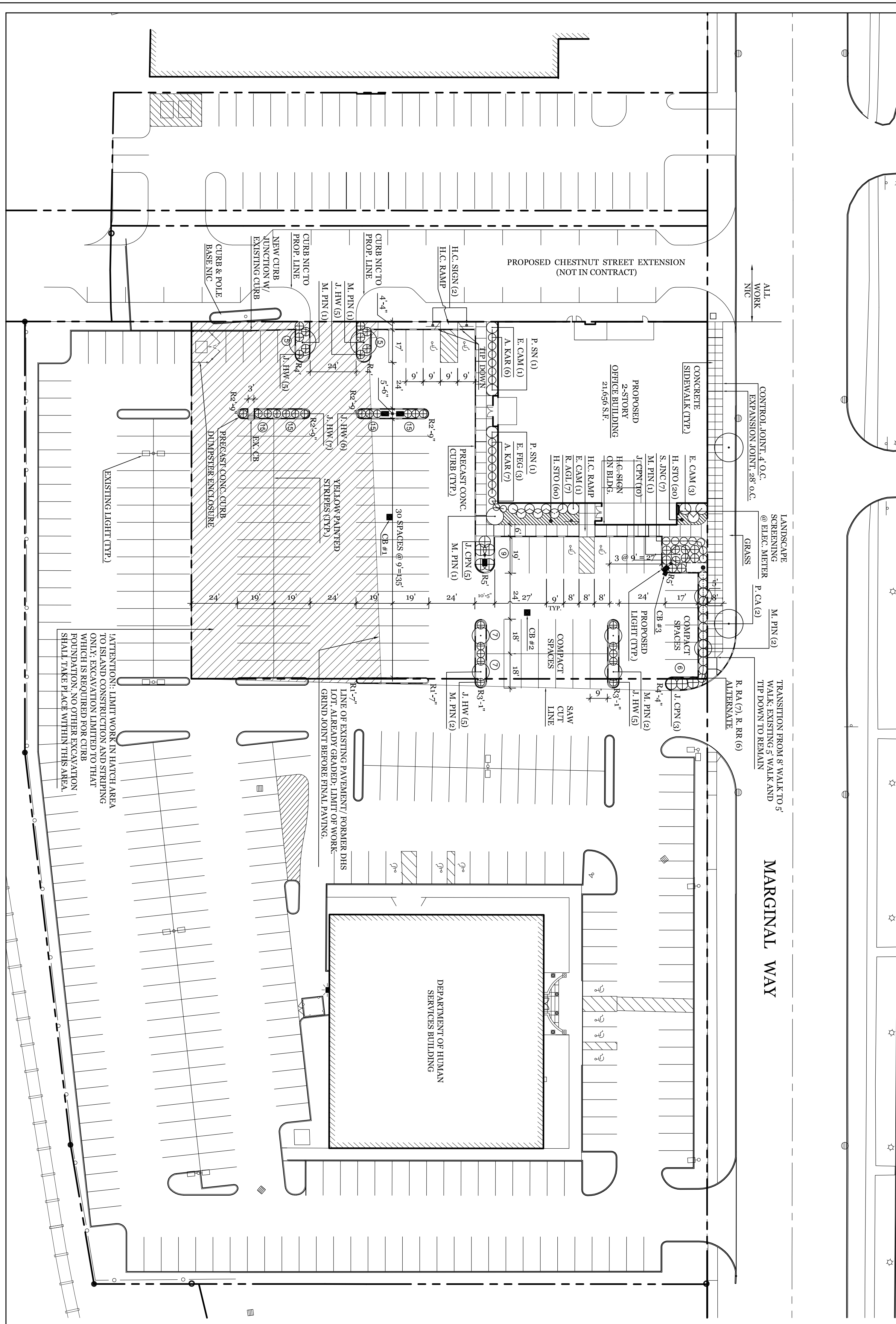

LEGEND

PROPERTY LINE	EXISTING	PROPOSED
GRANITE MONUMENT	□	□
IRON PIPE	○	○
EASEMENT	— · — · —	— · — · —
GRANITE CURB	▬	▬
PRECAST CONC. CURB	▬	▬
CATCHBASIN	⊕	⊕
MANHOLE	⊙	⊙
HYDRANT	⊕	⊕
UTILITY POLE	⊕	⊕
PEDESTRIAN LIGHT	⊕	⊕
PARKING LOT LIGHT	⊕	⊕
FENCE	⊕	⊕
BUILDING UP-LIGHT	⊕	⊕
STREET SIGN	⊕	⊕
HANDICAP SIGN	⊕	⊕
NO CUT NO FILL	▨	▨

Scale: 1"=30'

0 15 30 60

North:

Sheet No.: **2**

Date: JULY 7, 2004

Revisions:

Title: LAYOUT AND PLANTING PLAN

Reproduction or reuse of this document without the express written consent of Mitchell & Associates is prohibited.

Prepared For: Owner/Applicant: FIVE LIVERS COMPANY 5 Milk Street Portland, Maine 04112 (207) 772-0404

Prepared By: MITCHELL & ASSOCIATES Landscape Architects 70 Cambridge Street Portland, Maine 04101 Tel: (207) 774-4427

135 Marginal Way Portland, Maine

MULTI-TENANT OFFICE BUILDING