

**TYPICAL CROSS SECTION
ALONG "PINCH POINT" BEHIND midtown Two (High)**
SCALE: 1" = 4' Horiz., 1" = 8' Vert.

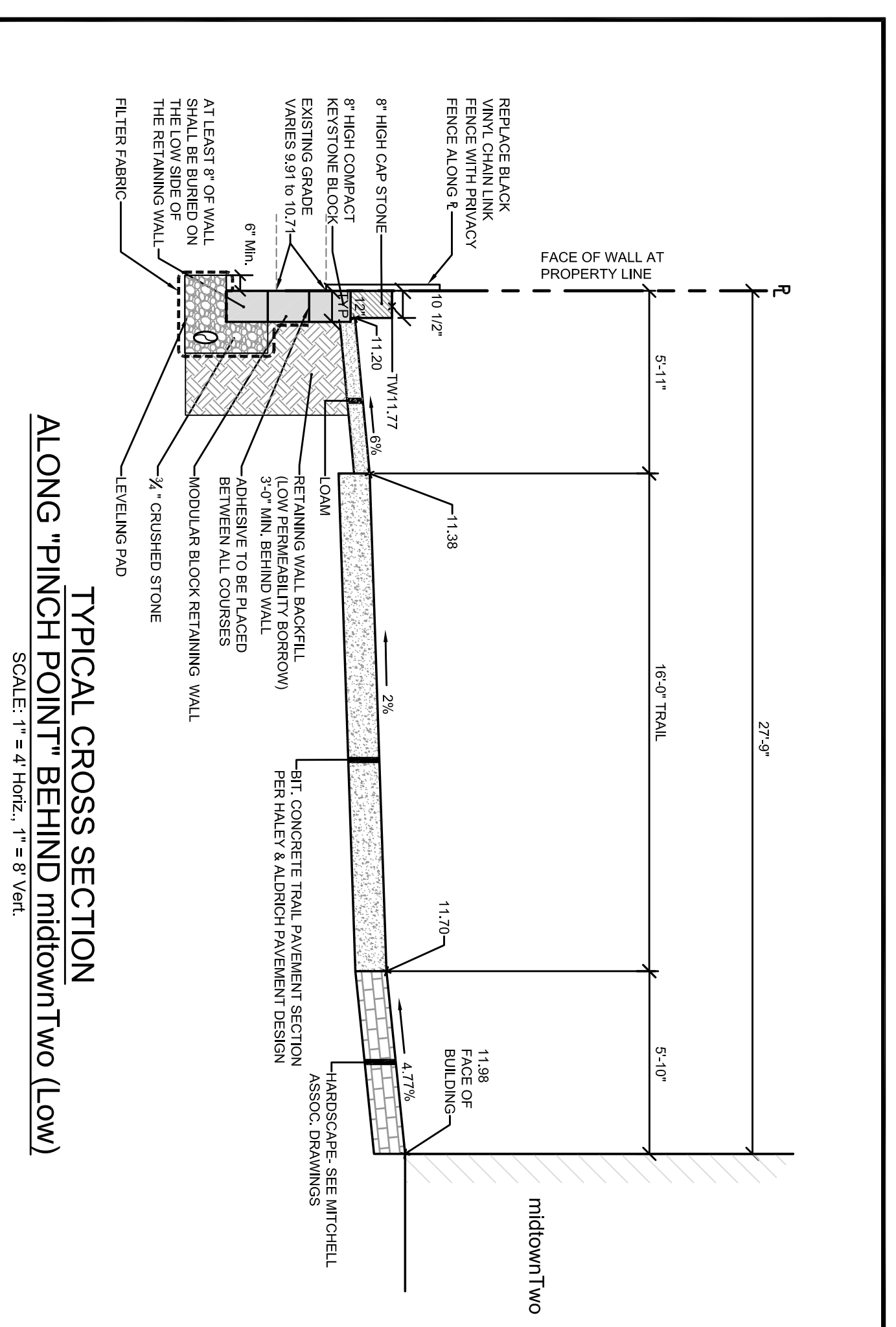

**TYPICAL CROSS SECTION
ALONG "PINCH POINT" BEHIND midtown Two (Low)**
SCALE: 1" = 4' Horiz., 1" = 8' Vert.

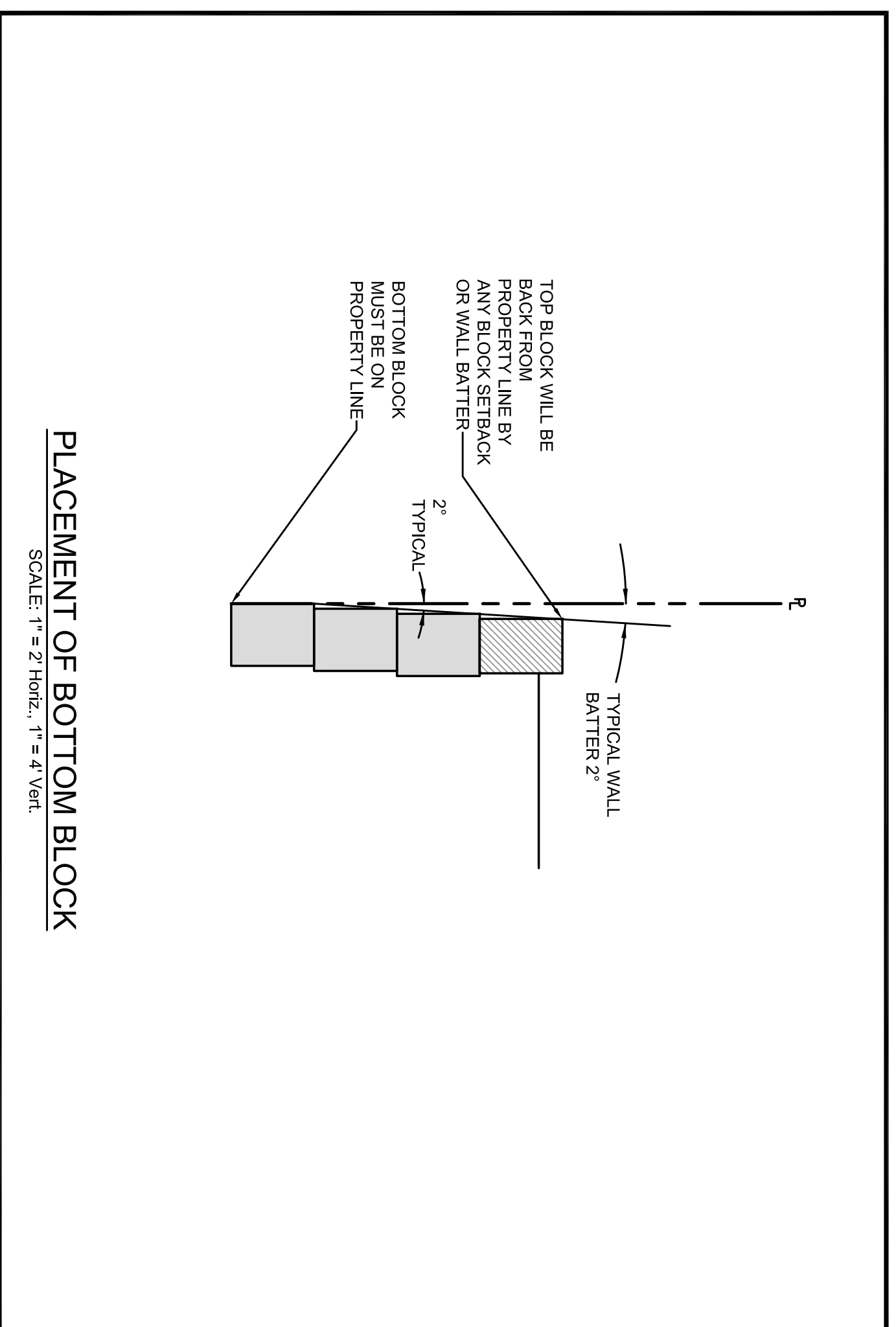

PLACEMENT OF BOTTOM BLOCK
SCALE: 1" = 2' Horiz., 1" = 4' Vert.

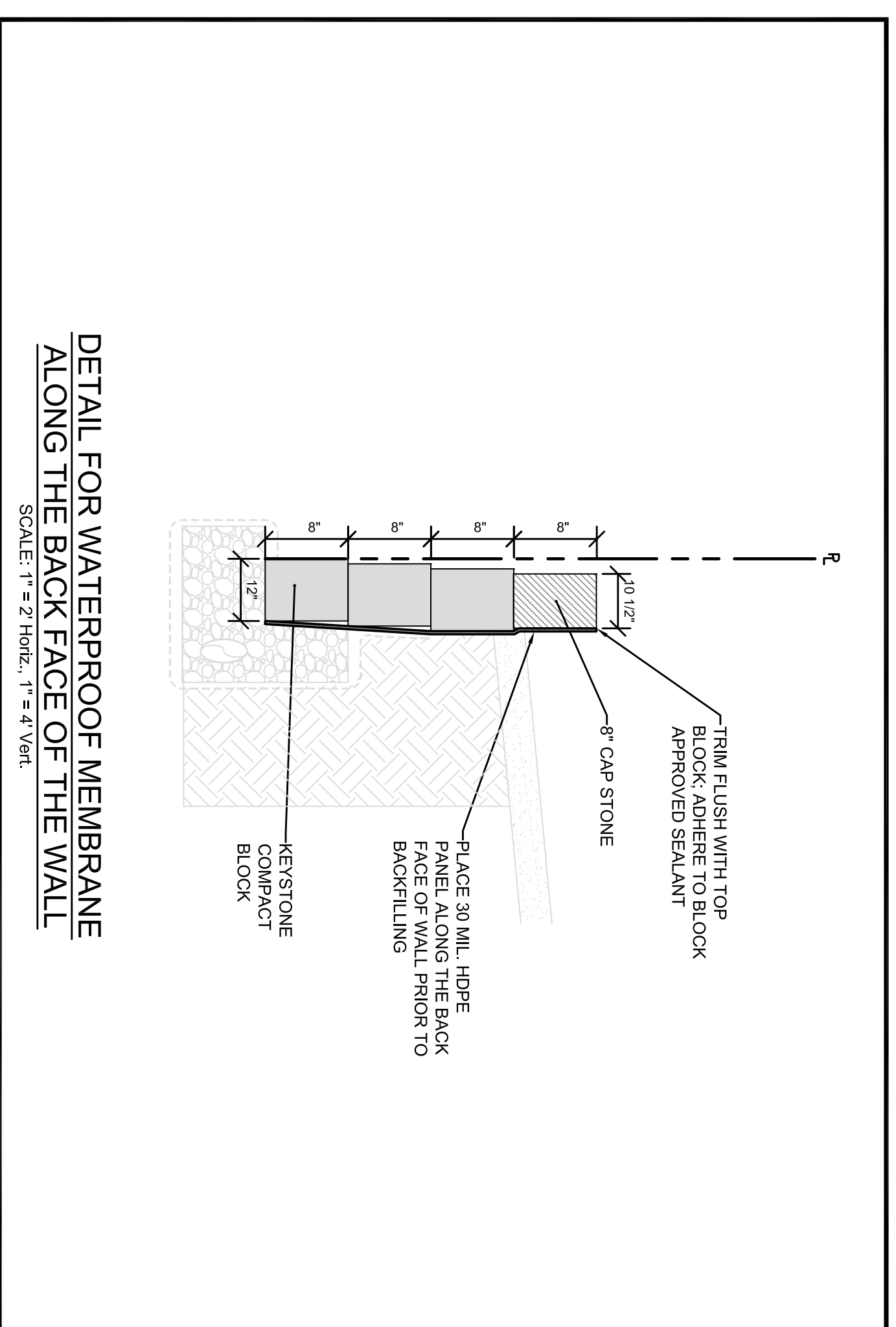

**DETAIL FOR WATERPROOF MEMBRANE
ALONG THE BACK FACE OF THE WALL**
SCALE: 1" = 2' Horiz., 1" = 4' Vert.

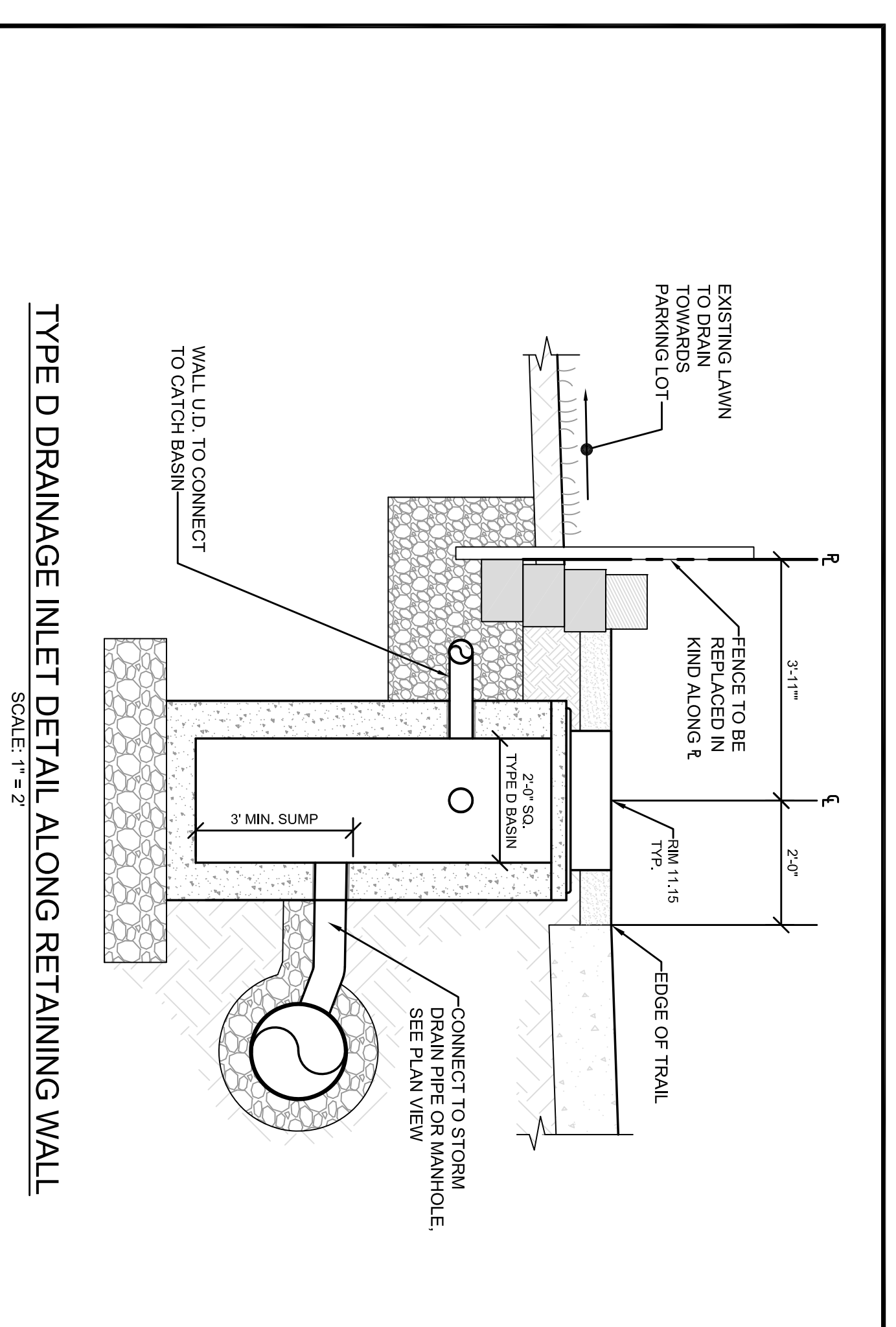

TYPE D DRAINAGE INLET DETAIL ALONG RETAINING WALL
SCALE: 1" = 2'

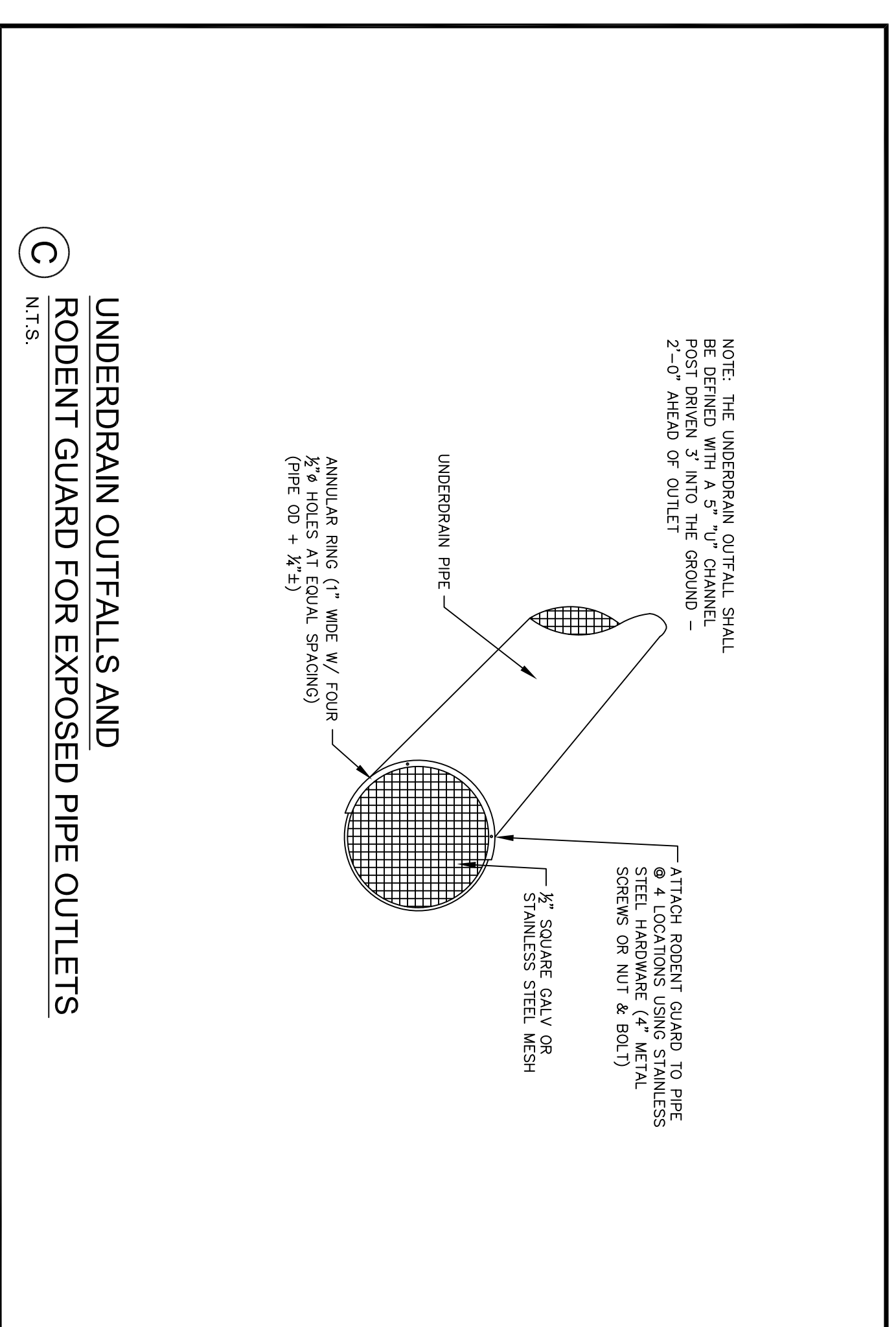

**UNDERDRAIN OUTFALLS AND
RODENT GUARD FOR EXPOSED PIPE OUTLETS**
N.T.S.

BASIS OF DESIGN FOR THE BAYSIDE TRAIL RECONSTRUCTION BEHIND midtown Two
ASHTO Standards Which Must Be Met:

- The minimum width of the shoulder adjacent to a multiuse path must be 5 feet before a vertical drop or rise is permitted (5'-1.2" provided).
- Railings and other obstructions need to have a 2 foot setback from the edge of the trail (no obstructions).
- The trail cross slope is 2% (see detail sections).
- The grade from the edge of the trail should not exceed 6% for a distance of 5'-0" (slope varies from 0% to 6%).

New Cross Sections:

- Two cross sections are shown. One is at the sags along the trail; the other is at the crests (i.e. 41 feet apart).
- Inlets are required along the top of the wall to intercept drainage.
- Temporary Construction Easement to be granted by Abutter.
- Option 1 or 2 shall be selected by abutting property owner.

PRELIMINARY - NOT FOR CONSTRUCTION

		PROJECT midtown PORTLAND, MAINE	
SHEET TITLE BAYSIDE TRAIL RETAINING WALL DETAILS AND ABUTTER OPTIONS		CLIENT FEDQA DV001, LLC	DATE: OCTOBER 2014 SCALE: AS NOTED JOB NO.: SP-A03078 FILE NAME: 3062-RET WALL OPTIONS
REV 1 2	DATE 11/14/14 01/21/15	DESCRIPTION FINAL LEVEL III SUBMISSION TO CITY OF PORTLAND REVISION PER PROPOSAL COMMENTS SUBMITTED TO CITY	DESIGNED: WGH/SRB CHECKED: WGH/SRB DATE: AS NOTED
REVISIONS P.E. STEPHEN R. BISHOP LIC. #2428		PROJECT midtown PORTLAND, MAINE	