

**SOMERSET STREET PROFILE FACING NOYES**  
SCALE: 1"=4' VERT.; 1:20' HORIZ.

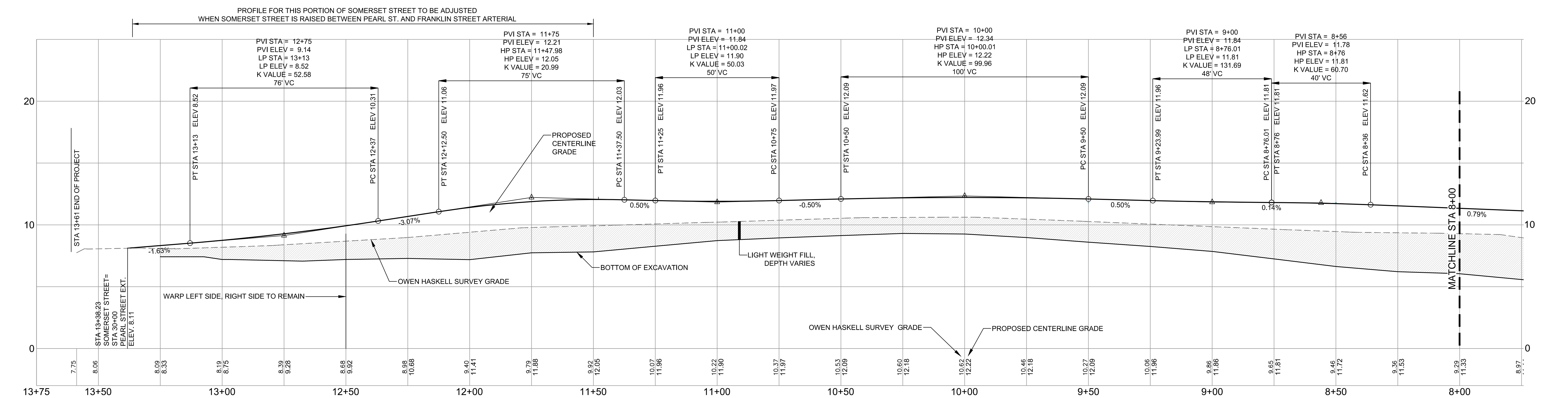

**SOMERSET STREET PROFILE FACING NOYES**  
SCALE: 1"=4' VERT.; 1:20' HORIZ.

**NOTE:**  
THE SIDEWALK SLOPE ON THE SOUTHERLY SIDE OF SOMERSET STREET BETWEEN STATIONS 3+75 AND 7+25 WILL BE INCREASED BY 2% IN AREAS WHERE IT WILL NOT BE ABOVE THE BRICK ON THE NOYES BUILDING

REFER TO DRAWING C-7.0 AND C-7.0A FOR TYPICAL CROSS SECTIONS

**THIS DRAWING IS INTENDED TO BE PLOTTED AND VIEWED IN COLOR.**  
BLACK AND WHITE PLAN NOT SUITABLE FOR REVIEW

		PROJECT <b>midtown</b> PORTLAND, MAINE		<b>FAY, SPOFFORD &amp; THORNDIKE</b> ENGINEERS - PLANNERS - SCIENTISTS 778 MAIN ST., SUITE 8, SOUTH PORTLAND, ME 04106 FORMERLY DELUCA-HOFFMAN ASSOCIATES
SHEET TITLE <b>SOMERSET STREET PROFILE FACING NOYES BUILDING</b>		CLIENT <b>THE FEDERATED COMPANIES</b>	DRAWN: KEW DESIGNED: WGH/BEK CHECKED: WGH/SRB	DATE: OCTOBER 2014 SCALE: AS NOTED JOB NO. SP-M037B
REVISIONS 1 11.14.14 FINAL LEVEL III SUBMISSION TO CITY OF PORTLAND 2 11.14.14 DESCRIPTION		FILE NAME: 3062-PROFILE-ROADWAY	SHEET <b>C-8.0A</b>	