

NOTE: CONCRETE PAVERS SHALL BE SEALED WITH SUREBOND SB-1370 JOINT STABILIZING SEALER OR APPROVED EQUAL

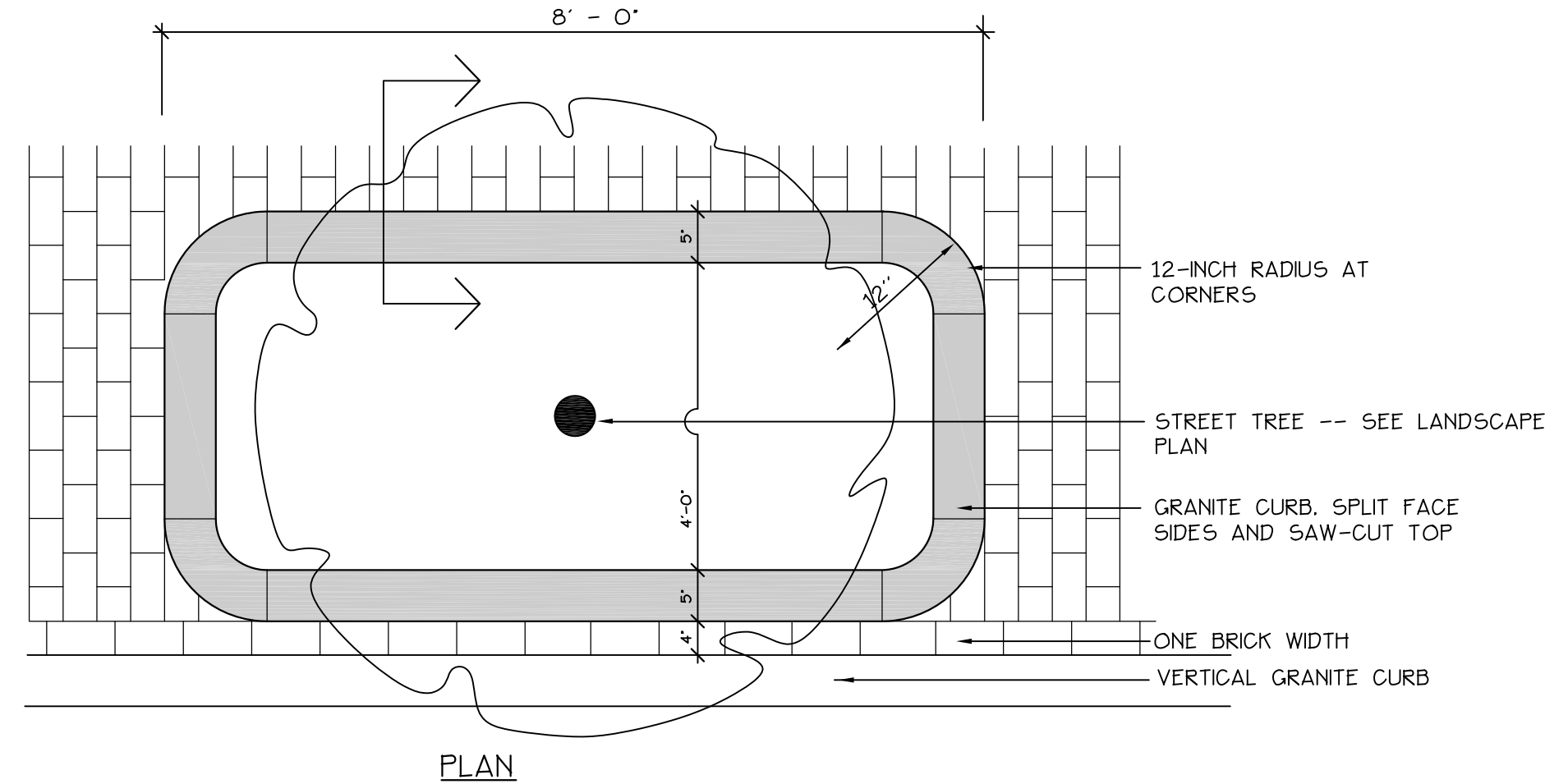
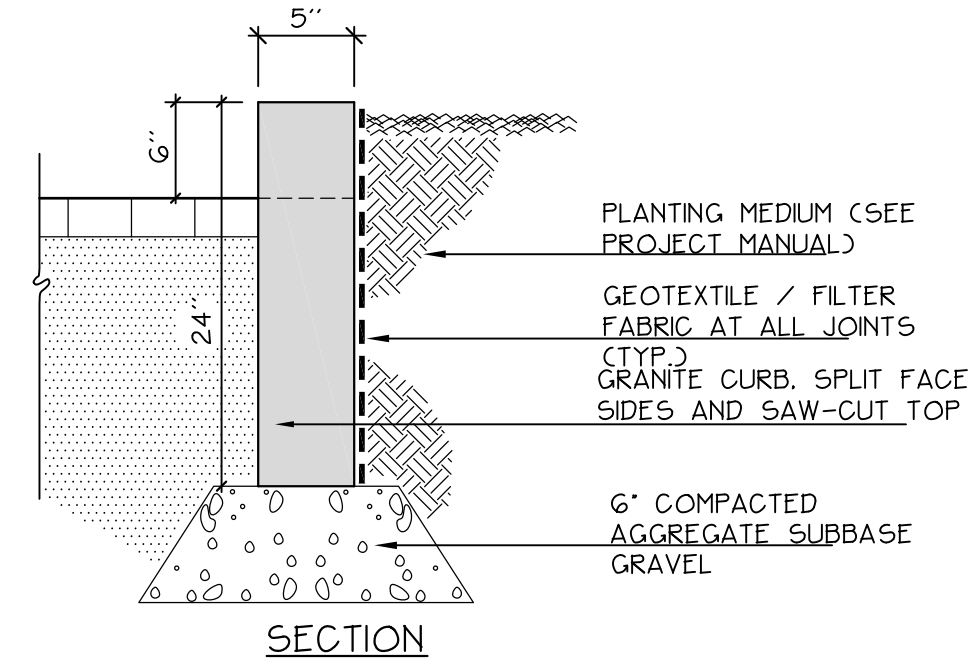

4 STREET TREE RAISED PLANTING BED
 L2.0 NOT TO SCALE

Tradeport Stone™

Genest Tradeport Stone offers you two distinct textures that can easily enhance any landscape design. Available in an antiqued texture that offers the look of quarried stone or a smooth traditional surface with a crisp non-antiqued edge. The larger stone sizes add appeal and distinction for residential or commercial driveways, walkways, patios, downtown plazas and city sidewalks. The Tradeport comes in four blended colors that can easily match the colors in your landscape.

Packaging

- 93.6 sq. ft. per pallet
- 3,520 lbs per pallet
- 10.4 sq. ft. per layer
- 9 layers per pallet

Three Stone Sizes

- 200mm x 200mm (7 7/8" x 7 7/8")
- 200mm x 300mm (7 7/8" x 11 13/16")
- 200mm x 400mm (7 7/8" x 15 3/4")

All Stones are 80mm (3 1/8") Thick



Laying Styles

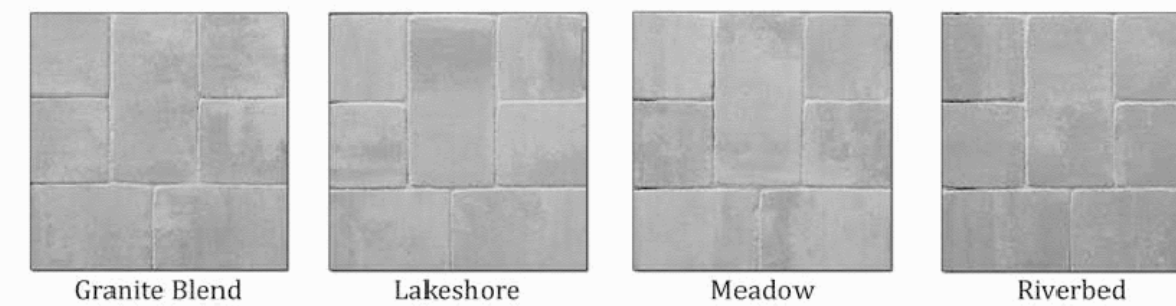
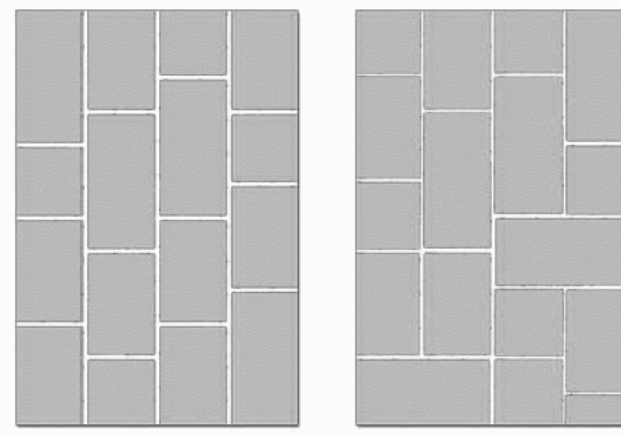

General specifications meet or exceed ASTM C-936
 Compressive strength: 9,000 PSI minimum
 Maximum water absorption: 5%
 Equals or exceeds freeze-thaw resistance
 *Laying Styles do not reflect the number of stones within the pallet.
 In some cases you may have extra or less stones in your design.

Genest
 1-800-649-4773
 GenestConcrete.com

1 PRE-CAST CONCRETE MODULAR PAVERS
 L2.0 NOT TO SCALE

2 DETAIL NOT USED
 L2.0 NOT TO SCALE

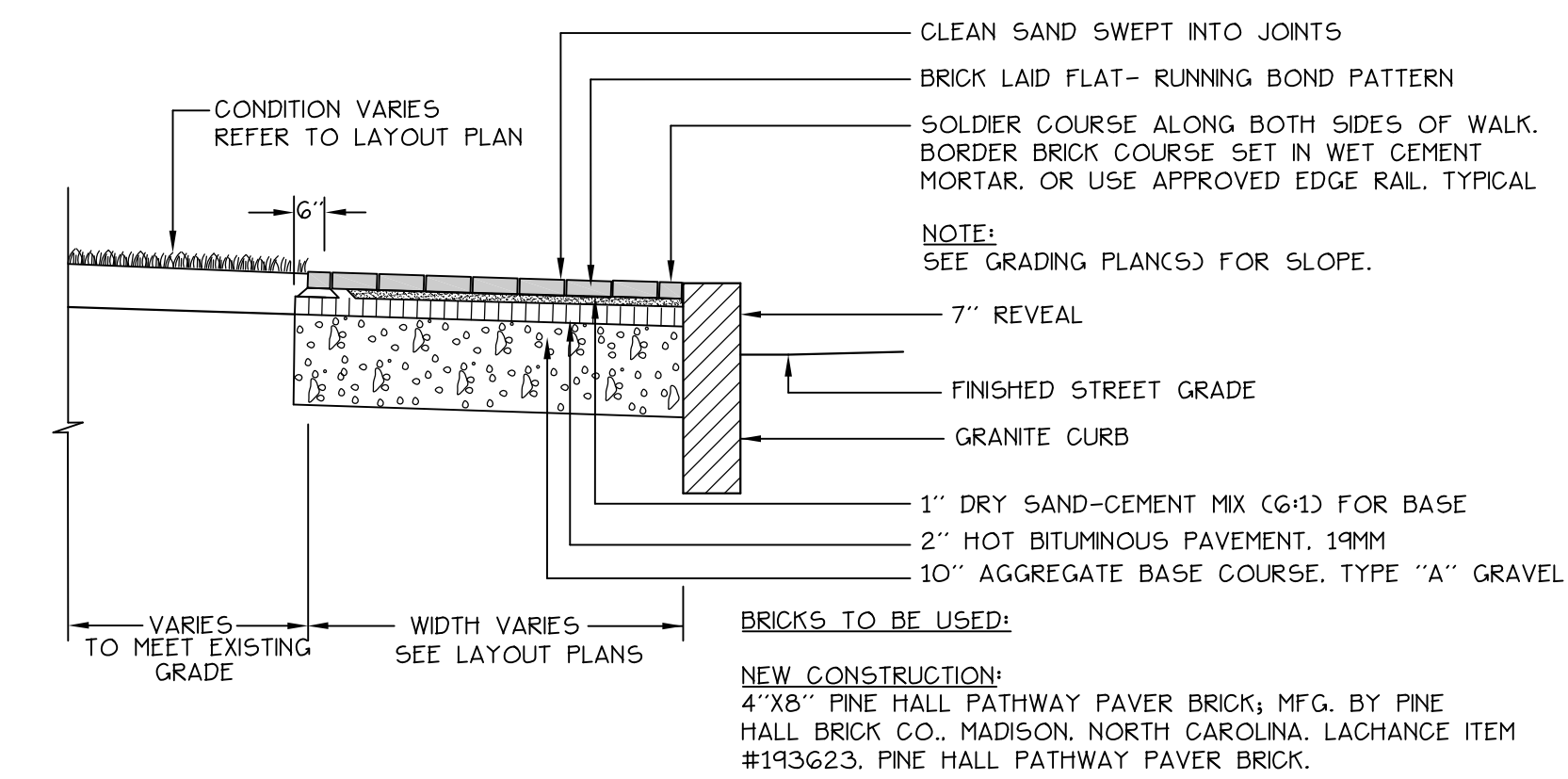

4-A CITY OF PORTLAND BRICK SIDEWALK DETAIL
 L2.0 NOT TO SCALE

3 DETAIL NOT USED
 L2.0 NOT TO SCALE



211 North Lindbergh Blvd.
 St. Louis, MO 63141
 800.231.1327 | tel: 314.754.0835 fax
 specs@anovafurnishings.com
 anovafurnishings.com

RCPMF6— Madison Recycled Plastic Flat Bench
 6' flat bench with recycled plastic seat planks steel legs



Material
 The 6' flat bench is composed of .50" thick formed steel legs with 1.5" x 3.5" (2" x 4" nominal dimensions) recycled plastic planks for the seat. The bench is 72.25" long and will support 200 lbs per linear foot. The recycled plastic planks are impervious to moisture and corrosion, do not require the application of sealants or preservatives, and will never need painting or staining throughout the product's life. The bench is designed to be portable for flexibility in placement or surface mounted using predrilled .5" diameter holes in feet to prevent movement. Mounting hardware is not included.

Finish
 Fade-resistant, powder coated steel components feature a state-of-the-art primer proven to prevent rusting. Treated components exceed the industry standard by 84% in testing by independent sources.

Color
 See website or sales representative for color choices.

Assembly
 Some assembly is required. Assembly hardware is included.

Maintenance
 The product is virtually maintenance-free and requires only periodic cleaning with a sponge and a solution of mild detergent and water to remove surface dirt. Do not clean with solvent or petroleum base products.

Warranty
 20-year limited structural warranty with 7-year finish warranty from the date of purchase.

Replacement Parts
 Replacement Left Leg R-5608
 Replacement Right Leg R-5609

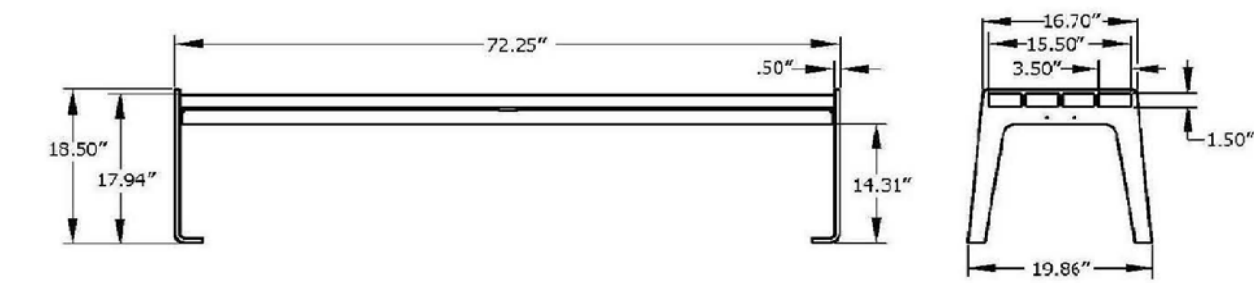

SHIPPING INFORMATION

Unit Weight	Unit Shipping Wt. UPS	Unit Shipping Wt. Truck (1+ Units)	Unit Ship Size w/Pallet	Max Units Per Pallet	Pallet Size/Wt. (33" x 48")	Total No. Pkgs.	Shipping Class
123 lbs.	N/A	131 lbs./unit	15 cu. ft.	5	100 lbs.	2	70

5 BENCH SEATING DETAIL
 L2.0 NOT TO SCALE

OLYMPIA™ BIKE RACK

SURFACE MOUNT INSTALLATION INSTRUCTIONS

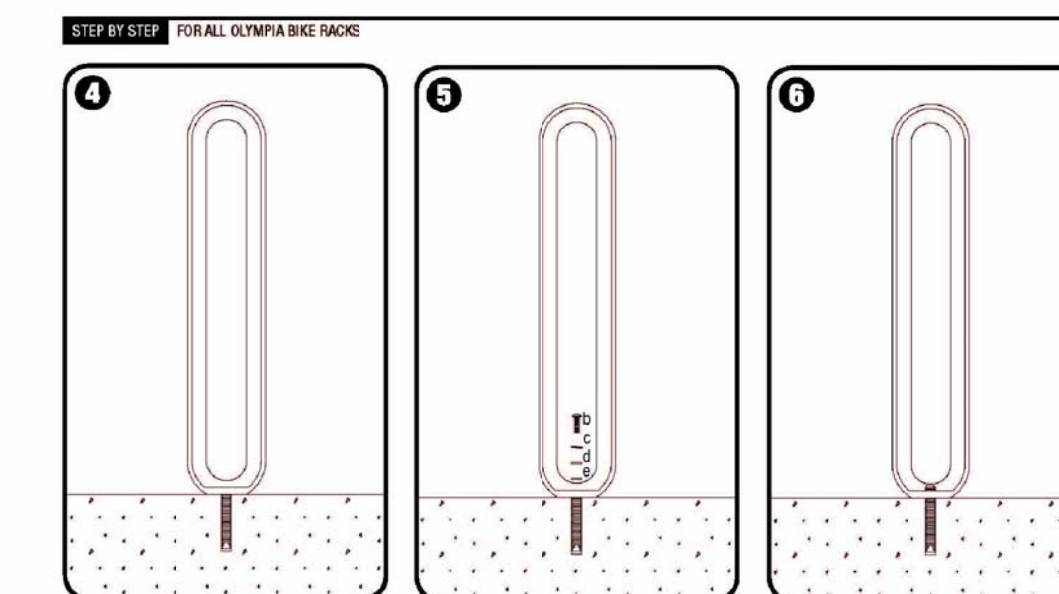

Position bike rack.
 Position bike rack so that mounting holes line up with anchors.

Attach bike rack.
 Slide 1/2" stainless steel lock washer (a), then 1/2" stainless steel flat washer (b) and 1/2" nylon flat washer (c) onto each 1/2" x 1/2" x 1-1/4" tamper-resistant button head cap screw (d).

Tighten screws.
 Insert screws into mounting holes in bike rack and thread into anchors using provided 5/16" hex bit for tamper-resistant screws.

FORMS+SURFACES™

OLYMPIA™ BIKE RACK

SURFACE MOUNT INSTALLATION INSTRUCTIONS

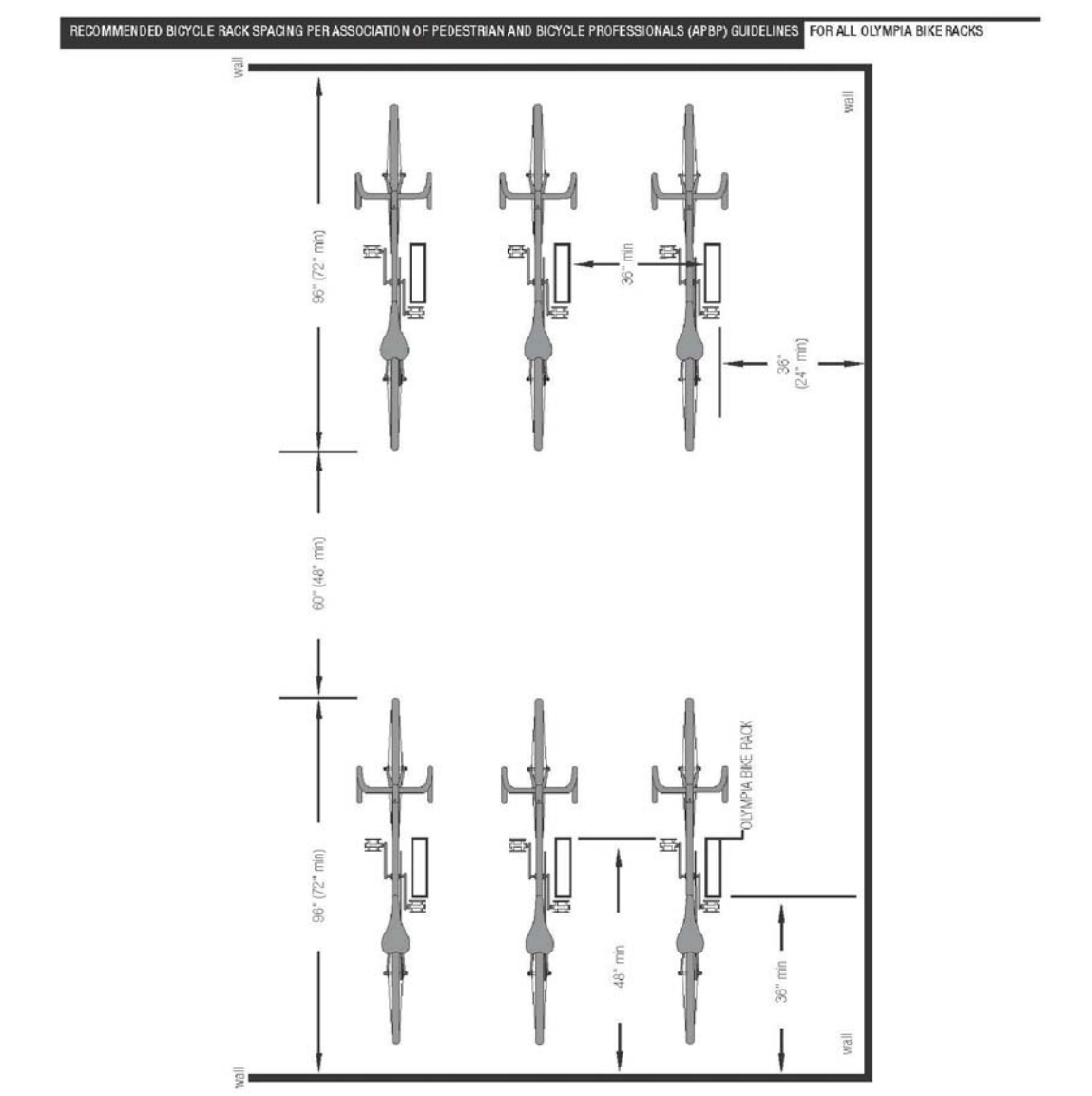

FORMS+SURFACES™

6 BIKE RACK DETAIL
 L2.0 NOT TO SCALE

PRELIMINARY - NOT FOR CONSTRUCTION

PROJECT midtown PORTLAND, MAINE		 70 Center Street Portland, Maine 04040 207.774.4427
SHEET TITLE LANDSCAPE DETAILS		
CLIENT THE FEDERATED COMPANIES		DRAWN: DATE: 11.14.14 DESIGNED: SCALE: N.T.S. CHECKED: JOB NO. SP-M037B FILE NAME: SHEET L2.0
1	11.14.14	FINAL LEVEL III SUBMISSION TO CITY OF PORTLAND
REV	DATE	DESCRIPTION
ROBERT B. METCALF, ME LA LIC. # 1815		 ROBERT B. METCALF, ME LA LIC. # 1815