

midtownThree  
F.F.E. 12.0

midtownTwo  
F.F.E. 12.0

FOR CONTINUATION SEE SHEET C-3.5

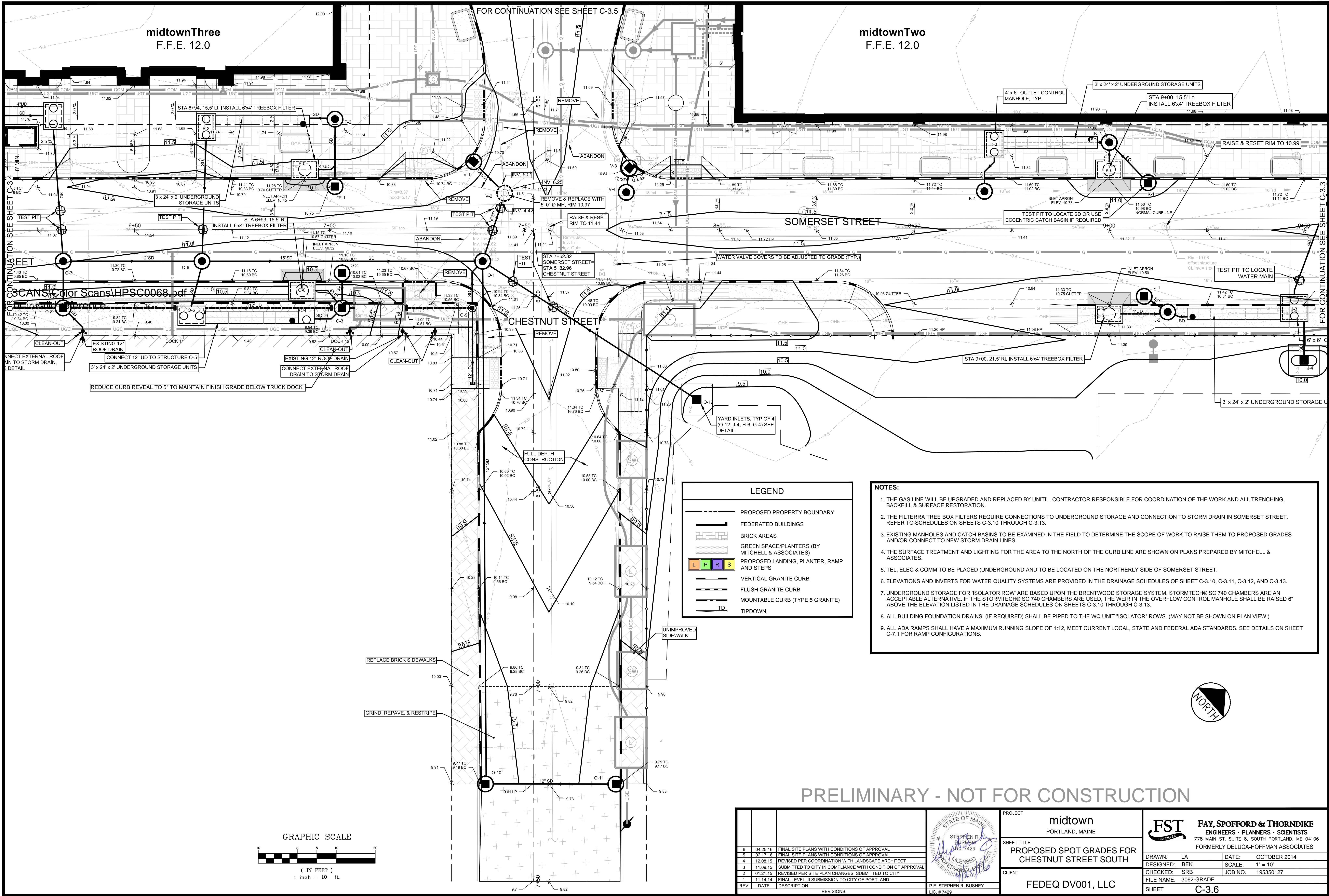

**LEGEND**

- PROPOSED PROPERTY BOUNDARY
- ▭ FEDERATED BUILDINGS
- ▭ BRICK AREAS
- ▭ GREEN SPACE/PLANTERS (BY MITCHELL & ASSOCIATES)
- ▭ PROPOSED LANDING, PLANTER, RAMP AND STEPS
- ▭ VERTICAL GRANITE CURB
- ▭ FLUSH GRANITE CURB
- ▭ MOUNTABLE CURB (TYPE 5 GRANITE)
- ▭ TIPDOWN

- NOTES:**
1. THE GAS LINE WILL BE UPGRADED AND REPLACED BY UNITIL. CONTRACTOR RESPONSIBLE FOR COORDINATION OF THE WORK AND ALL TRENCHING, BACKFILL & SURFACE RESTORATION.
  2. THE FILTERRA TREE BOX FILTERS REQUIRE CONNECTIONS TO UNDERGROUND STORAGE AND CONNECTION TO STORM DRAIN IN SOMERSET STREET. REFER TO SCHEDULES ON SHEETS C-3.10 THROUGH C-3.13.
  3. EXISTING MANHOLES AND CATCH BASINS TO BE EXAMINED IN THE FIELD TO DETERMINE THE SCOPE OF WORK TO RAISE THEM TO PROPOSED GRADES AND/OR CONNECT TO NEW STORM DRAIN LINES.
  4. THE SURFACE TREATMENT AND LIGHTING FOR THE AREA TO THE NORTH OF THE CURB LINE ARE SHOWN ON PLANS PREPARED BY MITCHELL & ASSOCIATES.
  5. TEL, ELEC & COMM TO BE PLACED (UNDERGROUND AND TO BE LOCATED ON THE NORTHERLY SIDE OF SOMERSET STREET.
  6. ELEVATIONS AND INVERTS FOR WATER QUALITY SYSTEMS ARE PROVIDED IN THE DRAINAGE SCHEDULES OF SHEET C-3.10, C-3.11, C-3.12, AND C-3.13.
  7. UNDERGROUND STORAGE FOR 'ISOLATOR ROW' ARE BASED UPON THE BRENTWOOD STORAGE SYSTEM. STORMTECH® SC 740 CHAMBERS ARE AN ACCEPTABLE ALTERNATIVE. IF THE STORMTECH® SC 740 CHAMBERS ARE USED, THE WEIR IN THE OVERFLOW CONTROL MANHOLE SHALL BE RAISED 6" ABOVE THE ELEVATION LISTED IN THE DRAINAGE SCHEDULES ON SHEETS C-3.10 THROUGH C-3.13.
  8. ALL BUILDING FOUNDATION DRAINS (IF REQUIRED) SHALL BE PIPED TO THE WQ UNIT 'ISOLATOR' ROWS. (MAY NOT BE SHOWN ON PLAN VIEW.)
  9. ALL ADA RAMP SHALL HAVE A MAXIMUM RUNNING SLOPE OF 1:12, MEET CURRENT LOCAL, STATE AND FEDERAL ADA STANDARDS. SEE DETAILS ON SHEET C-7.1 FOR RAMP CONFIGURATIONS.

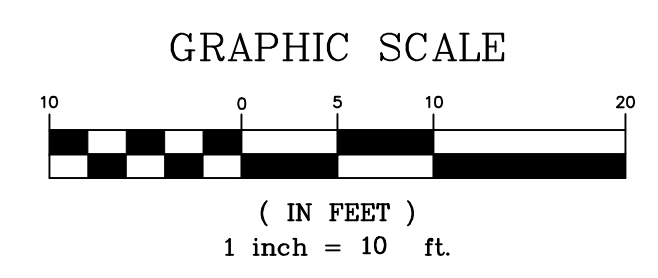

PRELIMINARY - NOT FOR CONSTRUCTION

			PROJECT <b>midtown</b> PORTLAND, MAINE	<b>FAY, SPOFFORD &amp; THORNDIKE</b> ENGINEERS • PLANNERS • SCIENTISTS 778 MAIN ST., SUITE 8, SOUTH PORTLAND, ME 04106 FORMERLY DELUCA-HOFFMAN ASSOCIATES
SHEET TITLE <b>PROPOSED SPOT GRADES FOR CHESTNUT STREET SOUTH</b>			DRAWN: LA DESIGNED: BEK CHECKED: SRB FILE NAME: 3062-GRADE	DATE: OCTOBER 2014 SCALE: 1" = 10' JOB NO. 195350127
CLIENT <b>FEDEQ DV001, LLC</b>			SHEET <b>C-3.6</b>	
REV DATE DESCRIPTION	REVISIONS	P.E. STEPHEN R. BUSHEY LIC. # 7429		