

No.	Date	Description

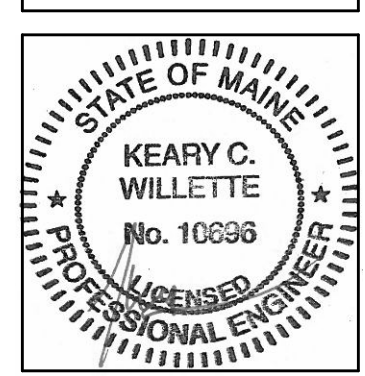

JOB NO.
195210863

DRWN: CHK:
ERD: KCW

SCALE:

ISSUE:
PERMIT SET - 95%
CONSTRUCTION
DOCUMENTS
04.12.16

TITLE:
PLUMBING
DOMESTIC WATER
LEVEL 2 NEW PLAN

SHEET
P103



Stantec Consulting Services Inc.
 482 Payne Road Scarborough Court
 Scarborough, ME 04074-8929
 Tel: (207) 883-3355 / Fax: (207) 883-3376
 www.stantec.com

NOTE:
 LIMIT UNRECIRCULATED DHW PIPING TO 16
 FEET OF PIPING FROM FIXTURE SUPPLY
 STOPS UNLESS OTHERWISE NOTED.

DHW DOWN WITHIN WALL
 CONNECT TO DHW WITHIN
 TWO FEET OF FIXTURE
 SUPPLY STOPS. PROVIDE
 BALANCING VALVE ABOVE
 CEILING IN AN ACCESSIBLE
 LOCATION.

DHW DOWN WITHIN WALL
 CONNECT TO DHW WITHIN TWO FEET OF FIXTURE
 SUPPLY STOPS. PROVIDE BALANCING
 VALVE ABOVE CEILING IN AN
 ACCESSIBLE LOCATION.

PROVIDE DOMESTIC
 COLD AND HOT WATER
 SUBMETERS FOR
 SECOND FLOOR.

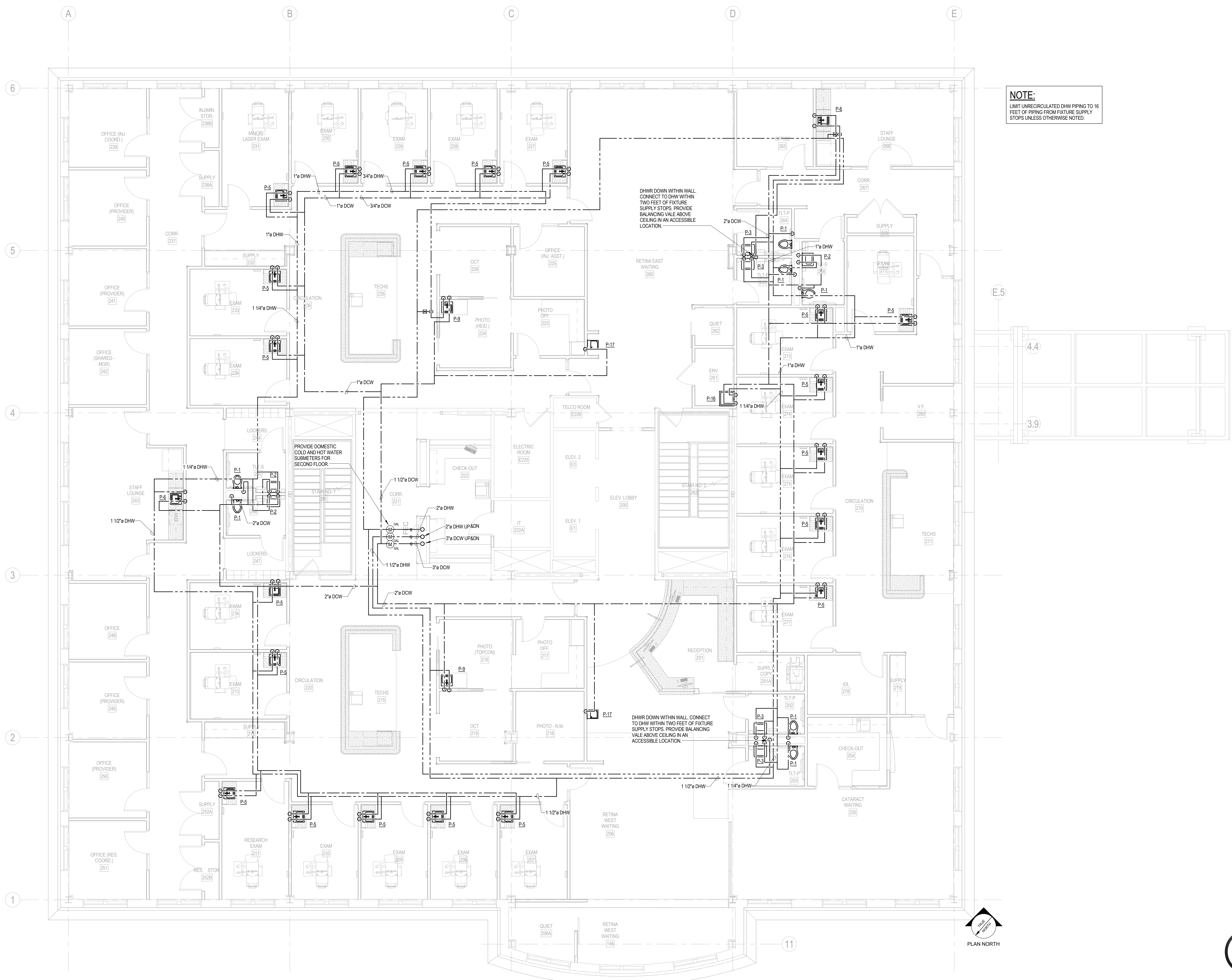

1 PLUMBING DOMESTIC WATER LEVEL 2 NEW PLAN
 3/16" = 1'-0"

