

Specialty Equipment Schedule						
Type mark	Family and Type	Type	DEPTH	WIDTH	HEIGHT	Count
	PDT Coat Hook - Single	60" Height				3
	Corner Guard: 1 1/2" Corner Guard	1 1/2" Corner Guard				116
	Corner Guard: 3" Corner Guard	3" Corner Guard				53
	Equipment - Endo: SOILED LINEN	SOILED LINEN	2'-5"	3'-11"	5'-6"	1
	Equipment - Endo: SOILED LINEN 2	SOILED LINEN 2	2'-5"	3'-2"	3'-0"	1
	Equipment - Endo: SUPPLY CART	SUPPLY CART	1'-10"	2'-8"	4'-10"	6
	Equipment - Endo: VAC CO	VAC CO	7"	1'-0"	6"	1
	Equipment - Pathology: Leica Slide Storage	Leica Slide Storage	1'-7"	1'-7"	3'-0"	2
	Furniture-Workstation-Mdmark-Care_Exchange-6201-002-MD3X-MM	MD3X-MM				14
	Medicine Cabinet: Sharps disposal	Sharps disposal				1
	Medicine Cabinet: Surface Mounted	Surface Mounted				5
	PT Dispenser - Recessed: Default	Default				1
	Television_Wall Mount_Panasonic: 24" tv	24" tv				6
	Television_Wall Mount_Panasonic: Medium TV	Medium TV				1
A	Equipment - Office: Bravo Capsule/Pill Cam	Bravo Capsule/Pill Cam	1'-3"	1'-4"	1'-0"	1
AA	Equipment - Endo: OLYMPUS MONITORS	OLYMPUS MONITORS	5"	1'-11 1/2"	1'-4"	5
BB	Equipment - Endo: PROP CART	PROP CART	1'-8"	3'-3"	3'-9"	1
CC	Equipment - Office: Fax Machine	Fax Machine	1'-3"	1'-4"	1'-0"	1
CC	Equipment - Endo: REPROSESOR	REPROSESOR	2'-6 1/4"	1'-6"	3'-2 1/2"	4
D	Equipment - Endo: TRASH	TRASH	1'-4"	1'-4"	3'-0"	1
DD	Equipment - Endo: Scope Cleaner TALL	Scope Cleaner TALL	1'-6"	3'-0"	7'-8"	5
E	Equipment - Office: Large Copier	Large Copier	2'-6"	2'-2"	2'-6"	2
EE	Equipment - Endo: SMART SINK	SMART SINK	9"	1'-3"	1'-1"	3
F	Equipment - Office: Mail Machine	Mail Machine	1'-7"	3'-6"	1'-3"	1
FE	Fire Extinguisher Cabinet: 9 1/2" x 4 1/2" x 24"	9 1/2" x 4 1/2" x 24"				1
FF	Equipment - Endo: ULTRASONIC CLEANER	ULTRASONIC CLEANER	1'-0"	1'-4"	1'-2 1/2"	3
G	Equipment - Office: Scanner	Scanner	1'-3"	1'-4"	1'-0"	6
GG	Equipment - Endo: WALL SUCTION	WALL SUCTION	7"	9"	1'-2"	5
HH	Equipment - Office: CONF. TRASH	CONF. TRASH	2'-0"	2'-0"	3'-4"	1
I	Equipment - Office: HICFA + UV PRINTER	HICFA + UV PRINTER	1'-4"	1'-4"	1'-4"	2
II	Equipment - Pathology: Leica Microscope DM2000	Leica Microscope DM2000	1'-3 21/32"	1'-1 1/16"	1'-8 1/8"	1
J	Equipment - Office: MAIL SORTER	MAIL SORTER	1'-0"	3'-0"	3'-2"	1
JA	Equipment - Office: Printer	Printer	1'-1 3/8"	1'-2 3/4"	1'-0"	3
JJ	Equipment - Pathology: Leica BondMax	Leica BondMax	2'-3 19/32"	2'-5 29/32"	2'-6 1/2"	1
K	Equipment - Endo: COMPUTER ON WHEELS	COMPUTER ON WHEELS	2'-9"	2'-8"	4'-10"	11
KK	Equipment - Pathology: AirFiltronic Corp - Fume Hood	AirFiltronic Corp - Fume Hood	2'-6"	2'-6"	2'-8 1/2"	1
L	Equipment - Endo: Autoclaves	Autoclaves	1'-6"	2'-0"	1'-6"	2
LL	Water_Cooler_-_Sunroc_Legend	Water_Cooler_-_Sunroc_Legend				2
M	Equipment - Endo: BLANKET WARMER	BLANKET WARMER	2'-0"	2'-6"	3'-0"	2
MM	Equipment - Endo: BLANKET WARMER INFUSION	BLANKET WARMER INFUSION	2'-0"	1'-4"	1'-9 1/8"	1
MM	Equipment - Pathology: ThermoScientific - Gross Lab. Jr.	ThermoScientific - Gross Lab. Jr.	2'-4"	4'-0"	6'-6 1/2"	1
N	Equipment - Endo: BLOOMFIELD COFFEE MAKER	BLOOMFIELD COFFEE MAKER	1'-2"	9"	1'-10"	1
NN	HP_Laser_Printer_-_Hewlett_Packard_DeskJet_2200	HP_Laser_Printer_-_Hewlett_Packard_DeskJet_2200	1'-3 15/16"	1'-3 11/32"	9 27/32"	2
O	Equipment - Endo: CODE CART AND ZOLL MACH.	CODE CART AND ZOLL MACH.	1'-10"	3'-2"	3'-2"	2
OO	Equipment - Pathology: Leica - Tissue Processor / ASP300S	Leica - Tissue Processor / ASP300S	2'-3"	2'-0"	4'-4"	1
P	Equipment - Endo: COLON CART	COLON CART	2'-5"	2'-1"	3'-8"	6
PP	Equipment - Pathology: Leica Paraffin Embedder	Leica Paraffin Embedder	2'-1 3/16"	1'-7 11/16"	1'-2 3/16"	2
Q	Equipment - Endo: CONFIDENTIAL DES. MINI CONSOLE	CONFIDENTIAL DES. MINI CONSOLE	1'-7 1/2"	1'-8 1/4"	2'-2"	2
QQ	Equipment - Pathology: Fisher Scientific Oven - 664 Isotemp	Fisher Scientific Oven - 664 Isotemp	11 1/2"	1'-4"	1'-4"	1
R	Equipment - Endo: DIRTY LINEN HAMPER	DIRTY LINEN HAMPER	1'-7"	1'-8"	3'-2"	1
RR	Equipment - Pathology: Leica Microtome RM2245 / 2440/08	Leica Microtome RM2245 / 2440/08	2'-0 11/32"	1'-4 1/4"	1'-0"	2
S	Equipment - Endo: EGD CART	EGD CART	2'-1"	2'-8"	3'-8"	6
SS	Equipment - Pathology: Leica - Cover Slipper CV 5030	Leica - Cover Slipper CV 5030	1'-11 5/8"	1'-2 19/32"	3'-2 19/32"	1
T	Equipment - Endo: ERBE MACHINE AND CART	ERBE MACHINE AND CART	2'-0"	2'-1"	3'-11"	1
TT	Equipment - Pathology: Leica Waterbath / H1210 / 10466/06/12	Leica Waterbath / H1210 / 10466/06/12	1'-0 3/16"	1'-1 25/32"	3 15/16"	2
U	Equipment - Endo: Hamper	Hamper	1'-9"	1'-9"	2'-8"	2
V	Equipment - Endo: HAMPER CLEAN AND DAMAGED	HAMPER CLEAN AND DAMAGED	2'-0"	1'-8"	3'-0"	3
VV	Equipment - Pathology: Leica - Stainer ST5020	Leica - Stainer ST5020	1'-9 21/32"	3'-5 23/32"	2'-5 15/16"	1
W	Equipment - Endo: Keurig 8542	Keurig 8542	1'-0 1/4"	9 1/2"	1'-1 1/4"	1
XX	Equipment - Endo: KYOCERA FS-1135nlp	KYOCERA FS-1135nlp	1'-5"	1'-7 1/2"	1'-6"	2
YY	Equipment - Endo: NURSE CODE CART	NURSE CODE CART	2'-8"	1'-7"	3'-3"	4
Z	Equipment - Endo: OLYMPUS CART	OLYMPUS CART	2'-10"	2'-9"	6'-3"	6

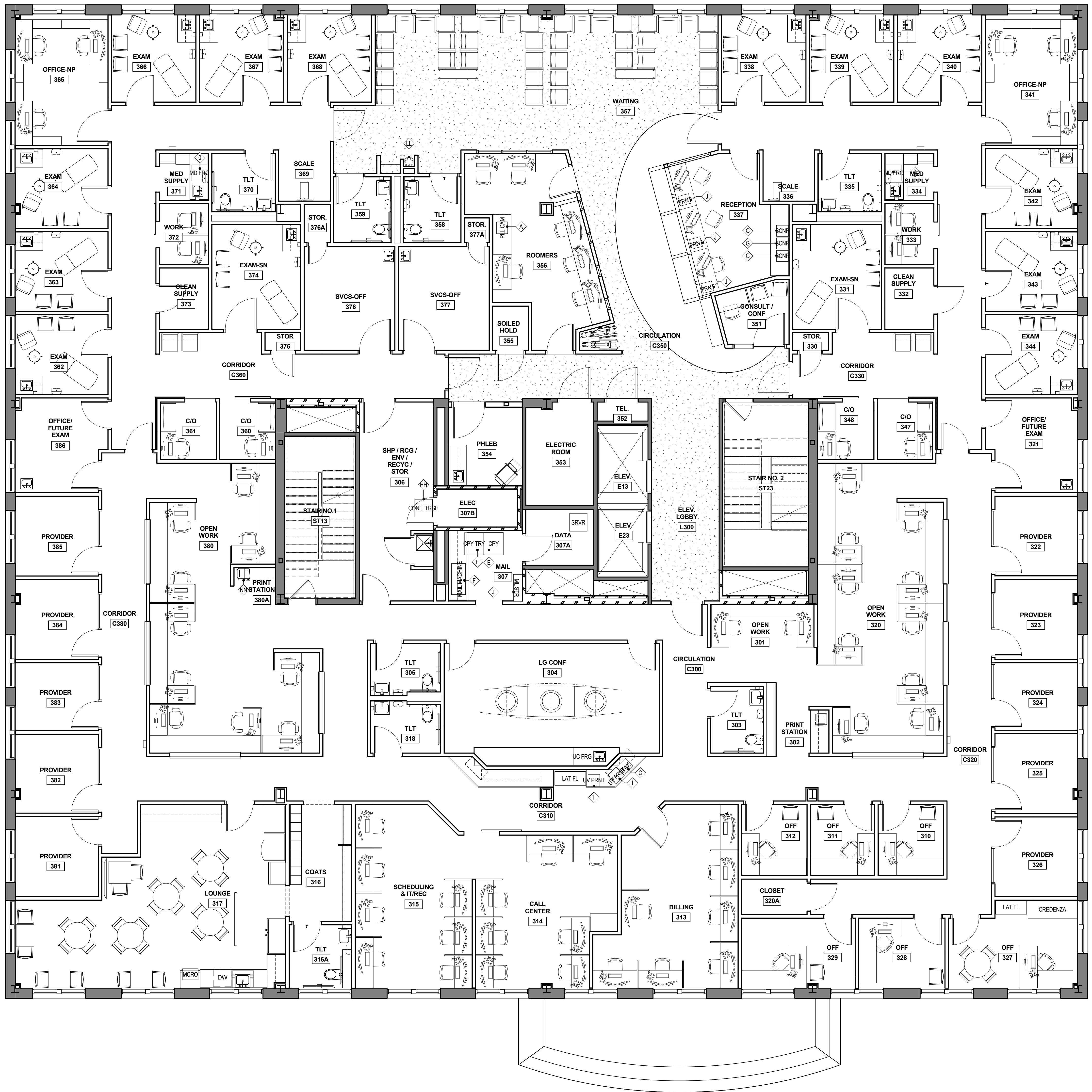

LEVEL 3 - EQUIPMENT AND FURNISHINGS
 3/16" = 1'-0"

