

CONSTRUCTION MANAGER:
CONSIGLI
 84 Middle Street
 Portland, Maine 04101
 Phone 207-773-3000
 Fax 207-773-2800

SITE/CIVIL ENGINEER:
 41 Hutchins Drive
 Portland, Maine 04102
 Phone 800-8428-4262
 Fax 207-774-4633

85 Cedar Street Suite 100
 Providence, Rhode Island 02903
 Phone 800-965-7997
 Fax 401-273-5087

HARRIMAN
 Architects + Engineers

123 Middle Street
 Portland, Maine 04101
 207.775.0053 tel
 207.775.0460 fax
 www.harriman.com
 c 2008

Project Title
**BAYCO LLC.
 BAYSIDE
 DEVELOPMENT**
 PORTLAND, MAINE

HA Project No. **08576**

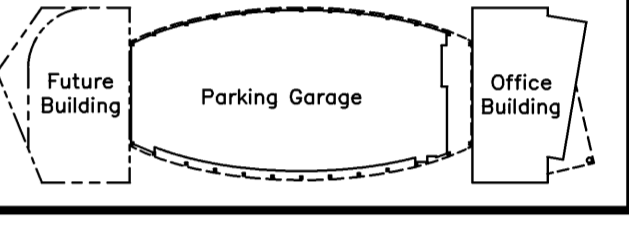
Key Plan

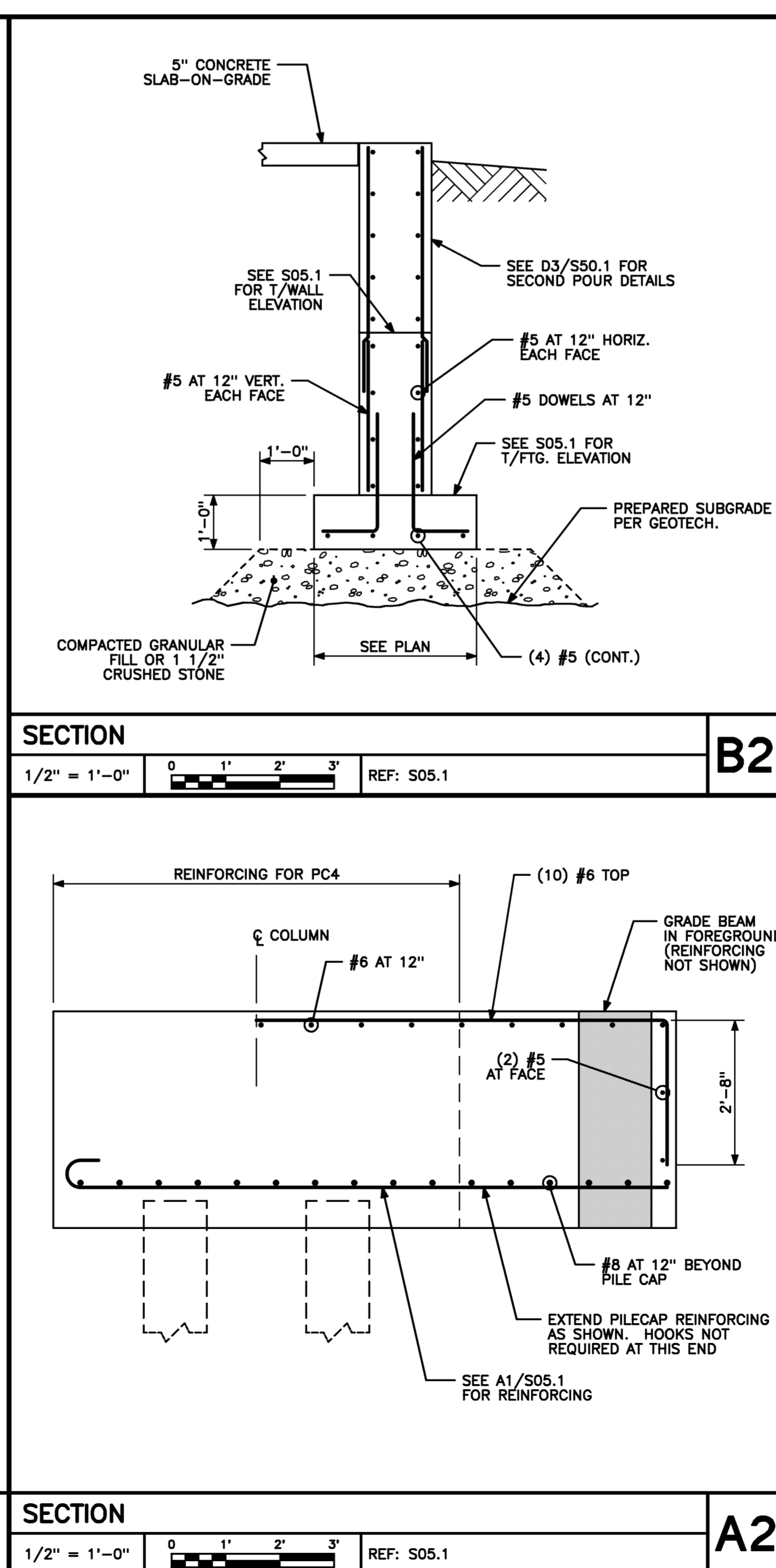
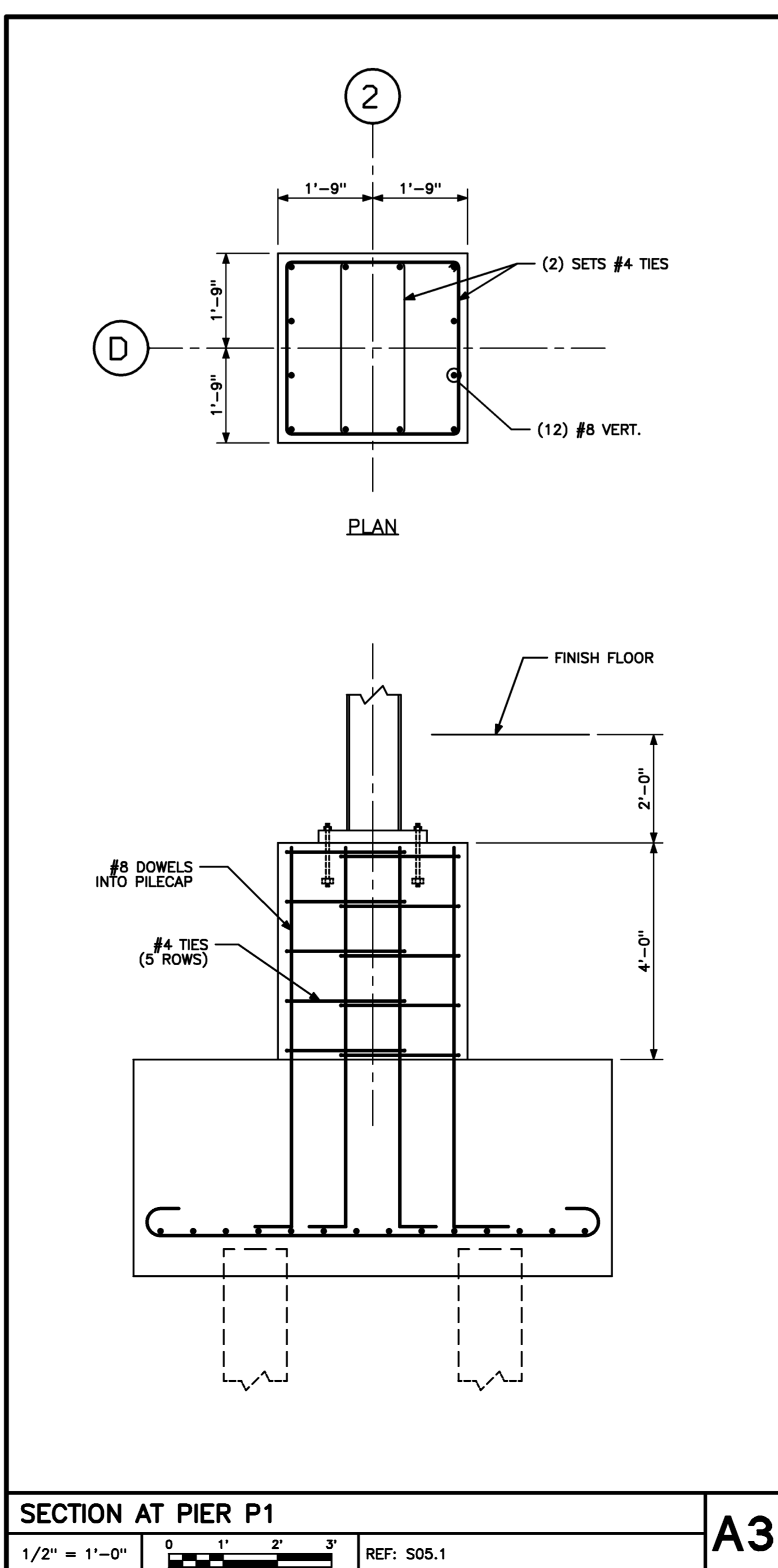

CONCRETE

- STRENGTH OF CONCRETE AT 28 DAYS TO BE 3,000 PSI (MIN) EXCEPT EXTERIOR SLABS TO BE 4,500 PSI.
- ALL EXTERIOR FOOTINGS, PILE CAPS AND GRADE BEAMS TO BE MIN. 4'-6" BELOW FINISH GRADE.
- TOP OF ALL INTERIOR FOOTINGS TO BE MIN. 8" BELOW BOTTOM OF SLAB ON GRADE UNLESS INDICATED OTHERWISE.
- BOTTOM OF ALL SOIL SUPPORTED FOOTINGS TO BE ON ADEQUATE SOIL BEARING AS INDICATED BY THE GEOTECHNICAL ENGINEER.
- ALL SLABS ON GRADE TO BE 5" THICK UNLESS SHOWN OTHERWISE.
- SEE SPECIFICATIONS FOR SPECIAL REQUIREMENTS FOR ARCHITECTURAL EXPOSED CONCRETE, ANCHORING OF MASONRY TO CONCRETE WALLS, AND CHAMFER OF EXTERNAL CORNERS OF CONCRETE WALLS.
- SEE ARCHITECTURAL AND MECHANICAL DRAWINGS AND SPECIFICATIONS FOR SIZE AND LOCATION OF DOOR FRAMES, THRESHOLDS, ETC., AND CONCRETE PADS, PIERS, PIPE SLEEVES, ETC.
- CONCRETE FILL FOR MASONRY LINTEL BLOCKS AND BOND BEAMS SHALL BE 3,000 PSI CONCRETE AT 28 DAYS.

CONCRETE REINFORCING

- ALL REINFORCING STEEL TO BE ASTM-A615 GRADE 60, DETAILED AND FABRICATED IN ACCORDANCE WITH THE "ACI MANUAL OF STANDARD PRACTICE" (ACI-315-LATEST EDITION).
- REINFORCEMENT TO HAVE MIN. CONCRETE COVER AS FOLLOWS:
 - CONCRETE DEPOSITED AGAINST GROUND, INCLUDING FOOTINGS----- 3"
 - CONCRETE EXPOSED TO EARTH OR WEATHER, INCLUDING WALKS, PIERS, WALLS, COLUMNS AND EXTERIOR SLABS----- 2"
 - CONCRETE NOT EXPOSED TO WEATHER OR IN CONTACT WITH GROUND
 - SLABS, WALLS AND JOISTS----- 3/4"
 - BEAMS AND COLUMNS, TIES, STIRRUPS, REINFORCEMENT----- 1-1/2"
- PROVIDE ADEQUATE KEYS AND DOWELS AT ALL WALL INTERSECTIONS AND CONSTRUCTION JOINTS.

GENERAL NOTES
 NO SCALE REF: NA

Mark	Date	Description
01-07-09		100% SITE ENABLING PACKAGE

Drawing Status

Drawing Title
**FOUNDATION NOTES
 AND DETAILS**

PA / PE: **BKB** Drawn By: **MRM**

Drawing Number

S50.2