

DISPLAY THIS CARD ON PRINCIPAL FRONTAGE OF WORK CITY OF PORTLAND

Please Read Application And Notes, If Any, Attached

BUILDING INSPECTION

PERMIT

PERMIT ISSUED

Permit Number: 070079

JAN 31 2007

CITY OF PORTLAND

This is to certify that BACK COVE COMPANY MILK ST/Construction Management

has permission to Remove existing cooler,refrigeration ca and s

AT 127 MARGINAL WAY L 025 A01400

provided that the person or persons firm or corporation accepting this permit shall comply with all of the provisions of the Statutes of this State and of the Ordinances of the City of Portland regulating the construction, maintenance and use of buildings and structures, and of the application on file in this department.

Apply to Public Works for street line and grade if nature of work requires such information.

Notification of inspection must be given and when permission procured before this building or part thereof is loaded or closed-in. 4 HOUR NOTICE IS REQUIRED.

A certificate of occupancy must be procured by owner before this building or part thereof is occupied.

OTHER REQUIRED APPROVALS

Fire Dept. Craig Cross
Health Dept. _____
Appeal Board _____
Other _____
Department Name

[Signature] 1/31/07
Director, Building & Inspection Services

PENALTY FOR REMOVING THIS CARD

City of Portland, Maine - Building or Use Permit Application

389 Congress Street, 04101 Tel: (207) 874-8703, Fax: (207) 874-8716

Permit No: 07-0079	Issue Date:	CBL: 025 A014001
-----------------------	-------------	---------------------

Location of Construction: 127 MARGINAL WAY	Owner Name: BACK COVE COMPANY 5 MILK	Owner Address: PO BOX 7525	Phone:
Business Name:	Contractor Name: Construction Management & Builde	Contractor Address: 6 Kimball Lane Lynnfield	Phone 9787714499
Lessee/Buyer's Name	Phone:	Permit Type: Interior Demo ONLY	Zone: B-7

Past Use: Commercial - <i>Whole Foods Grocer</i>	Proposed Use: Commercial remove existing cooler, refrigeration cases and soffit	Permit Fee:	Cost of Work: \$20,000.00	CEO District:	
		FIRE DEPT: <input checked="" type="checkbox"/> Approved <input type="checkbox"/> Denied <i>See conditions</i>	INSPECTION: Use Group: <i>A</i> Type: <i>Demo</i> <i>IBC 2003</i>		

Proposed Project Description: Remove existing cooler, refrigeration cases and soffit - <i>interior</i>	Signature: <i>Craig Clark</i>	Signature: <i>[Signature]</i>
PEDESTRIAN ACTIVITIES DISTRICT (P.A.D.)		
Action: <input type="checkbox"/> Approved <input type="checkbox"/> Approved w/Conditions <input type="checkbox"/> Denied		
Signature: _____ Date: _____		

Permit Taken By: dmartin	Date Applied For: 01/25/2007	Zoning Approval
-----------------------------	---------------------------------	------------------------

- This permit application does not preclude the Applicant(s) from meeting applicable State and Federal Rules.
- Building permits do not include plumbing, septic or electrical work.
- Building permits are void if work is not started within six (6) months of the date of issuance. False information may invalidate a building permit and stop all work..

Special Zone or Reviews	Zoning Appeal	Historic Preservation
<input type="checkbox"/> Shoreland	<input type="checkbox"/> Variance	<input checked="" type="checkbox"/> Not in District or Landmark
<input type="checkbox"/> Wetland	<input type="checkbox"/> Miscellaneous	<input type="checkbox"/> Does Not Require Review
<input type="checkbox"/> Flood Zone	<input type="checkbox"/> Conditional Use	<input type="checkbox"/> Requires Review
<input type="checkbox"/> Subdivision	<input type="checkbox"/> Interpretation	<input type="checkbox"/> Approved
<input type="checkbox"/> Site Plan	<input type="checkbox"/> Approved	<input type="checkbox"/> Approved w/Conditions
Maj <input type="checkbox"/> Minor <input type="checkbox"/> MM <input type="checkbox"/>	<input type="checkbox"/> Denied	<input type="checkbox"/> Denied
Date: <i>ok</i> <i>[Signature]</i> <i>1/25/07</i>	Date: _____	Date: <i>[Signature]</i>

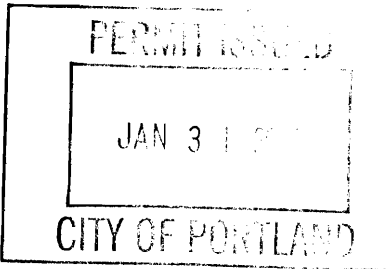

CERTIFICATION

I hereby certify that I am the owner of record of the named property, or that the proposed work is authorized by the owner of record and that I have been authorized by the owner to make this application as his authorized agent and I agree to conform to all applicable laws of this jurisdiction. In addition, if a permit for work described in the application is issued, I certify that the code official's authorized representative shall have the authority to enter all areas covered by such permit at any reasonable hour to enforce the provision of the code(s) applicable to such permit.

SIGNATURE OF APPLICANT	ADDRESS	DATE	PHONE
RESPONSIBLE PERSON IN CHARGE OF WORK, TITLE		DATE	PHONE

City of Portland, Maine - Building or Use Permit

389 Congress Street, 04101 Tel: (207) 874-8703, Fax: (207) 874-8716

Permit No: 07-0079	Date Applied For: 01/24/2007	CBL: 025 A014001
------------------------------	--	----------------------------

Location of Construction: 127 MARGINAL WAY	Owner Name: BACK COVE COMPANY 5 MILK	Owner Address: PO BOX 7525	Phone:
Business Name:	Contractor Name: Construction Management & Builde	Contractor Address: 6 Kimball Lane Lynnfield	Phone (978) 771-4499
Lessee/Buyer's Name	Phone:	Permit Type: Interior Demo ONLY	

Proposed Use: Commercial remove existing cooler, refrigeration cases and soffit - interior work	Proposed Project Description: Remove existing cooler,refrigeration cases and soffit - interior work
---	---

Dept: Zoning **Status:** Approved **Reviewer:** Marge Schmuckal **Approval Date:** 01/25/2007
Note: **Ok to Issue:**

Dept: Building **Status:** Approved with Conditions **Reviewer:** Tammy Munson **Approval Date:** 01/31/2007
Note: **Ok to Issue:**

- 1) Separate permits are required for any electrical, plumbing, or HVAC systems.
Separate plans may need to be submitted for approval as a part of this process.
- 2) This is a demolition ONLY permit. It does NOT authorize any construction activities.

Dept: Fire **Status:** Approved with Conditions **Reviewer:** Cptn Greg Cass **Approval Date:** 01/25/2007
Note: **Ok to Issue:**

- 1) All suppression, detection, and life safety systems shall remain in service.

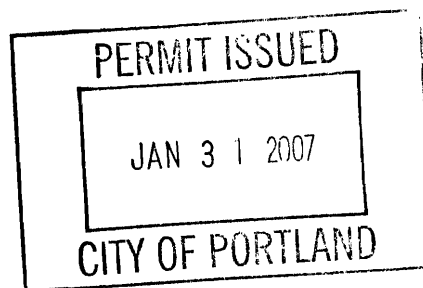



General Building Permit Application

If you or the property owner owes real estate or personal property taxes or user charges on any property within the City, payment arrangements must be made before permits of any kind are accepted.

Location/Address of Construction: <u>127 Marginal Way</u>		
Total Square Footage of Proposed Structure		Square Footage of Lot
Tax Assessor's Chart, Block & Lot Chart# Block# Lot# <u>25 A 014</u>	Owner: <u>FORE RIVER CO. 5 MILK STREET PORTLAND, ME 04112</u>	Telephone: <u>(207) 772-6404</u>
Lessee/Buyer's Name (If Applicable) <u>WHOLE FOODS MARKET 125 CAMBRIDGE PARK DR CAMBRIDGE, MA 02140</u>	Applicant name, address & telephone: <u>CONSTRUCTION MANAGER AND BUILDERS, INC. 6 KIMBALL LANE LYNNFIELD, MA 01940</u>	Cost Of Work: \$ <u>20,000</u> Fee: \$ <u>220.00</u> C of O Fee: \$ _____
Current Specific use: <u>FOOD STORE / Whole Grocer</u> If vacant, what was the previous use? _____ Proposed Specific use: _____		
Project description: <u>REMOVE EXISTING BEER COOLER, REFRIGERATED CASES, DISPLAY SHOWING AND MISCELLANEOUS STORE EQUIPMENT.</u>		
Contractor's name, address & telephone: <u>CONSTRUCTION MANAGER AND BUILDERS</u>		
Who should we contact when the permit is ready: <u>JOHN CHATFIELD</u> Mailing address: _____ Phone: <u>(603) 771-4449</u>		

Please submit all of the information outlined in the Commercial Application Checklist. Failure to do so will result in the automatic denial of your permit.

In order to be sure the City fully understands the full scope of the project, the Planning and Development Department may request additional information prior to the issuance of a permit. For further information visit us on-line at www.portlandmaine.gov, stop by the Building Inspections office, room 315 City Hall or call 874-8703.

I hereby certify that I am the Owner of record of the named property, or that the owner of record authorizes the proposed work and that I have been authorized by the owner to make this application as his/her authorized agent. I agree to conform to all applicable laws of this jurisdiction. In addition, if a permit for work described in this application is issued, I certify that the Code Official's authorized representative shall have the authority to enter all areas covered by this permit at any reasonable hour to enforce the provisions of the codes applicable to this permit.

Signature of applicant: [Signature] Date: 1/24/07

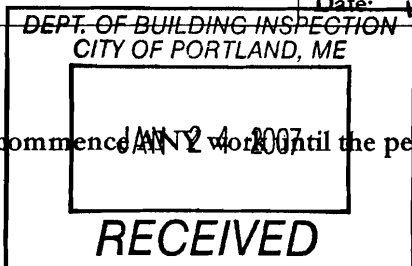

This is not a permit; you may not commence work until the permit is issued.

#CC

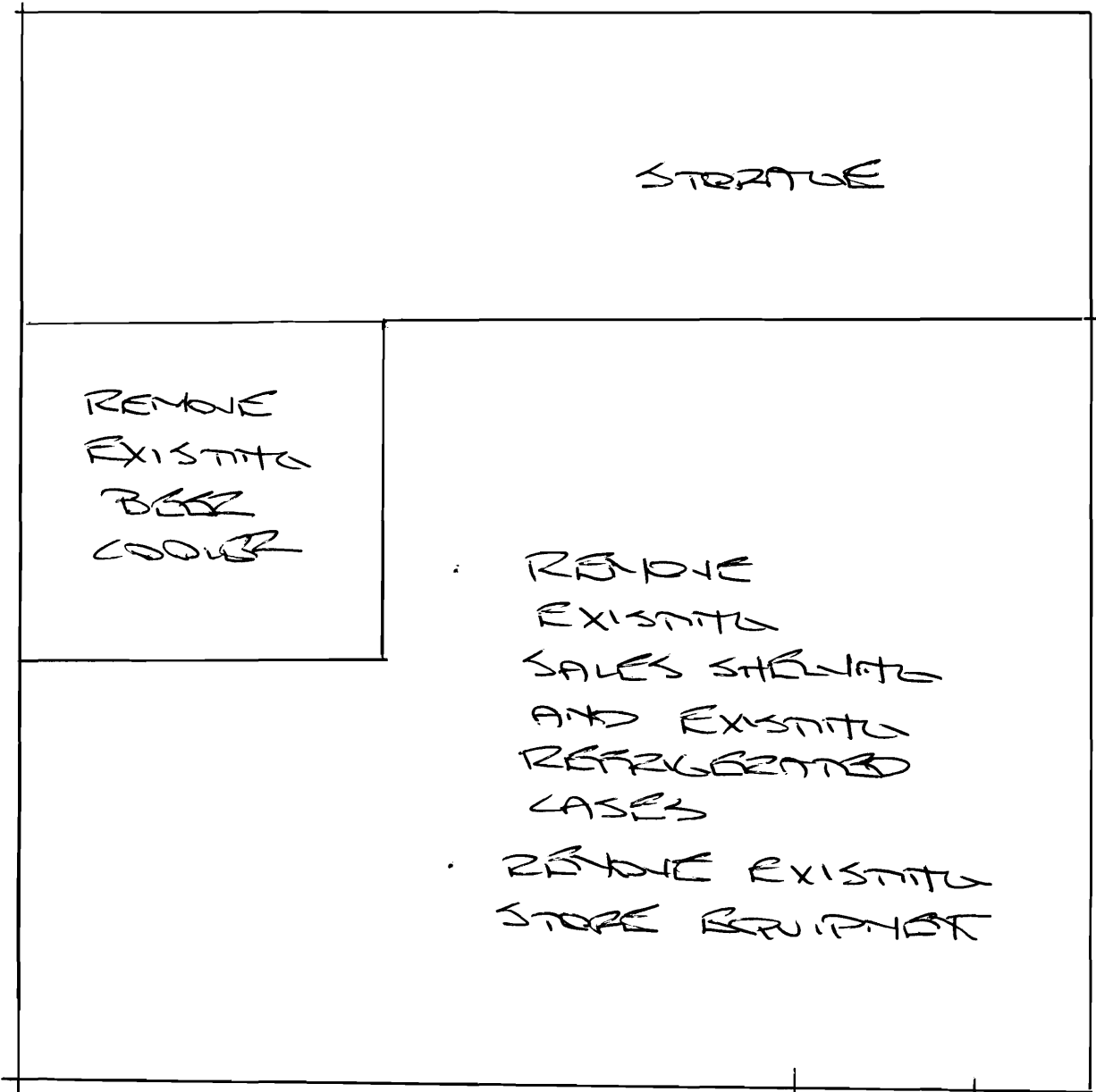

NTS

WHOLE GROCER
127 MARGINAL WAY
PORTLAND, ME

DEPT. OF BUILDING INSPECTION
CITY OF PORTLAND, ME

JAN 24 2007

RECEIVED