

**Proposed  
Parking Lot  
Improvements**

Whole Foods Market

Portland, Maine

MARK	DATE	DESCRIPTION
PROJECT NO:	W2011-39	
DATE:	2016/01/15	
FILE:	W2011_SITE.dwg	
DRAWN BY:	REP	
CHECKED:	KAM	
APPROVED:	GMM	

GRADING, DRAINAGE, AND  
EROSION CONTROL PLAN

SCALE: AS SHOWN

**LEGEND**

	PROPERTY LINE
	EXISTING FENCE
	PROPOSED FENCE
	EXISTING CONTOUR
	FINISHED GRADE
	EXISTING DRAINAGE
	PROPOSED DRAINAGE
	EXISTING CONCRETE/BITUMINOUS SIDEWALK
	PROPOSED CONCRETE/BITUMINOUS SIDEWALK
	EXISTING SIGN
	PROPOSED SIGN
	PROPOSED INLET PROTECTION
	APPROXIMATE LIMIT OF WORK

**GRADING AND DRAINAGE NOTES:**

- COMPACTION REQUIREMENTS:  
BELOW PAVED OR CONCRETE AREAS 95%  
TRENCH BEDDING MATERIAL AND SAND BLANKET BACKFILL 95%  
BELOW LOAM AND SEED AREAS 90%  
  
\* ALL PERCENTAGES OF COMPACTION SHALL BE OF THE MAXIMUM DRY DENSITY AT THE OPTIMUM MOISTURE CONTENT AS DETERMINED AND CONTROLLED IN ACCORDANCE WITH ASTM D-1557, METHOD C FIELD DENSITY TESTS SHALL BE MADE IN ACCORDANCE WITH ASTM D-1556 OR ASTM-2922.
- ALL STORM DRAINAGE PIPES SHALL BE HIGH DENSITY POLYETHYLENE (HANCOR HI-Q, ADS N-12 OR APPROVED EQUAL), UNLESS OTHERWISE SPECIFIED.
- ADJUST ALL MANHOLES, CATCHBASINS, CURB BOXES, ETC. WITHIN LIMITS OF WORK TO FINISH GRADE.
- CONTRACTOR SHALL PROVIDE A FINISH PAVEMENT SURFACE AND LAWN AREAS FREE OF LOW SPOTS AND PONDING AREAS. CRITICAL AREAS INCLUDE BUILDING ENTRANCES, EXITS, RAMPS AND LOADING DOCK AREAS ADJACENT TO THE BUILDING.
- CONTRACTOR SHALL THOROUGHLY CLEAN ALL CATCHBASINS AND DRAIN LINES, WITHIN THE LIMIT OF WORK, OF SEDIMENT IMMEDIATELY UPON COMPLETION OF CONSTRUCTION.
- ALL MATERIALS AND CONSTRUCTION SHALL CONFORM WITH APPLICABLE FEDERAL, STATE AND LOCAL CODES.
- ALL DISTURBED AREAS NOT TO BE PAVED OR OTHERWISE TREATED SHALL RECEIVE 6" LOAM, SEED FERTILIZER AND MULCH.
- ALL STORM DRAIN CONSTRUCTION SHALL BE IN ACCORDANCE WITH THE MEDOT. STANDARD SPECIFICATIONS, LATEST EDITION.
- ALL PROPOSED CATCHBASINS SHALL BE EQUIPPED WITH OIL/GAS SEPARATOR HOODS AND 4" SUMPS.
- ALL MATERIALS AND CONSTRUCTION SHALL CONFORM WITH APPLICABLE FEDERAL, STATE AND CITY OF PORTLAND DEPARTMENT OF PUBLIC WORKS AND CONSTRUCTION SPECIFICATIONS, LATEST REVISIONS.
- CONTRACTOR TO SUBMIT AS-BUILT PLANS ON REPRODUCIBLE MYLARS AND IN DIGITAL FORMAT (.DWG FILE) ON DISK TO THE OWNER AND ENGINEER UPON COMPLETION OF THE PROJECT. AS-BUILTS SHALL BE PREPARED AND CERTIFIED BY A MAINE LICENSED LAND SURVEYOR OR PROFESSIONAL ENGINEER.

**EROSION CONTROL NOTES:**

- PRIOR TO ANY WORK OR SOIL DISTURBANCE COMMENCING ON THE SUBJECT PROPERTY, INCLUDING MOVING OF EARTH, THE APPLICANT SHALL INSTALL ALL EROSION AND SILTATION MITIGATION AND CONTROL MEASURES AS REQUIRED BY STATE AND LOCAL PERMITS AND APPROVALS.
- PROVIDE INLET PROTECTION AROUND ALL EXISTING AND PROPOSED CATCHBASIN INLETS WITHIN THE WORK LIMITS. MAINTAIN FOR THE DURATION OF THE PROJECT UNTIL PAVEMENT HAS BEEN INSTALLED.
- INSPECT INLET PROTECTION AND SILT FENCES DAILY AND AFTER EACH RAIN STORM OF 0.25 INCH OR GREATER. REPAIR/MODIFY PROTECTION AS NECESSARY TO MAXIMIZE EFFICIENCY OF FILTER. REPLACE ALL FILTERS WHEN SEDIMENT IS 1/3 THE FILTER HEIGHT.
- ALL DISTURBED AREAS NOT TO BE PAVED OR OTHERWISE TREATED SHALL RECEIVE 6" LOAM, SEED, FERTILIZER AND MULCH.
- CONTRACTOR SHALL BE RESPONSIBLE TO CONTROL DUST AND WIND EROSION THROUGHOUT THE CONSTRUCTION PERIOD. DUST CONTROL MEASURES SHALL INCLUDE, BUT NOT LIMITED TO, SPRINKLING WATER ON UNSTABLE SOILS SUBJECT TO ARID CONDITIONS.
- THE CONTRACTOR SHALL REMOVE AND PROPERLY DISPOSE OF ALL TEMPORARY EROSION CONTROL DEVICES UPON COMPLETION OF CONSTRUCTION.
- ALL CATCHBASIN SUMPS AND PIPING SHALL BE THOROUGHLY CLEANED TO REMOVE ALL SEDIMENT AND DEBRIS AFTER THE PROJECT HAS BEEN PAVED.
- TEMPORARY SOIL STOCKPILE SHALL BE SURROUNDED BY SILT FENCE AND SHALL BE STABILIZED BY TEMPORARY EROSION CONTROL SEEDING.

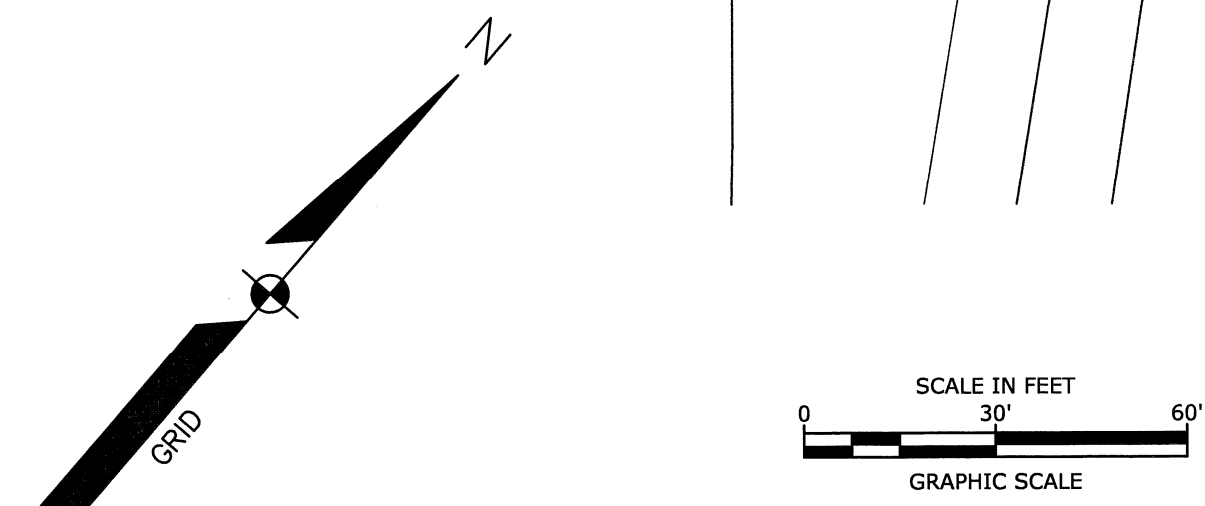
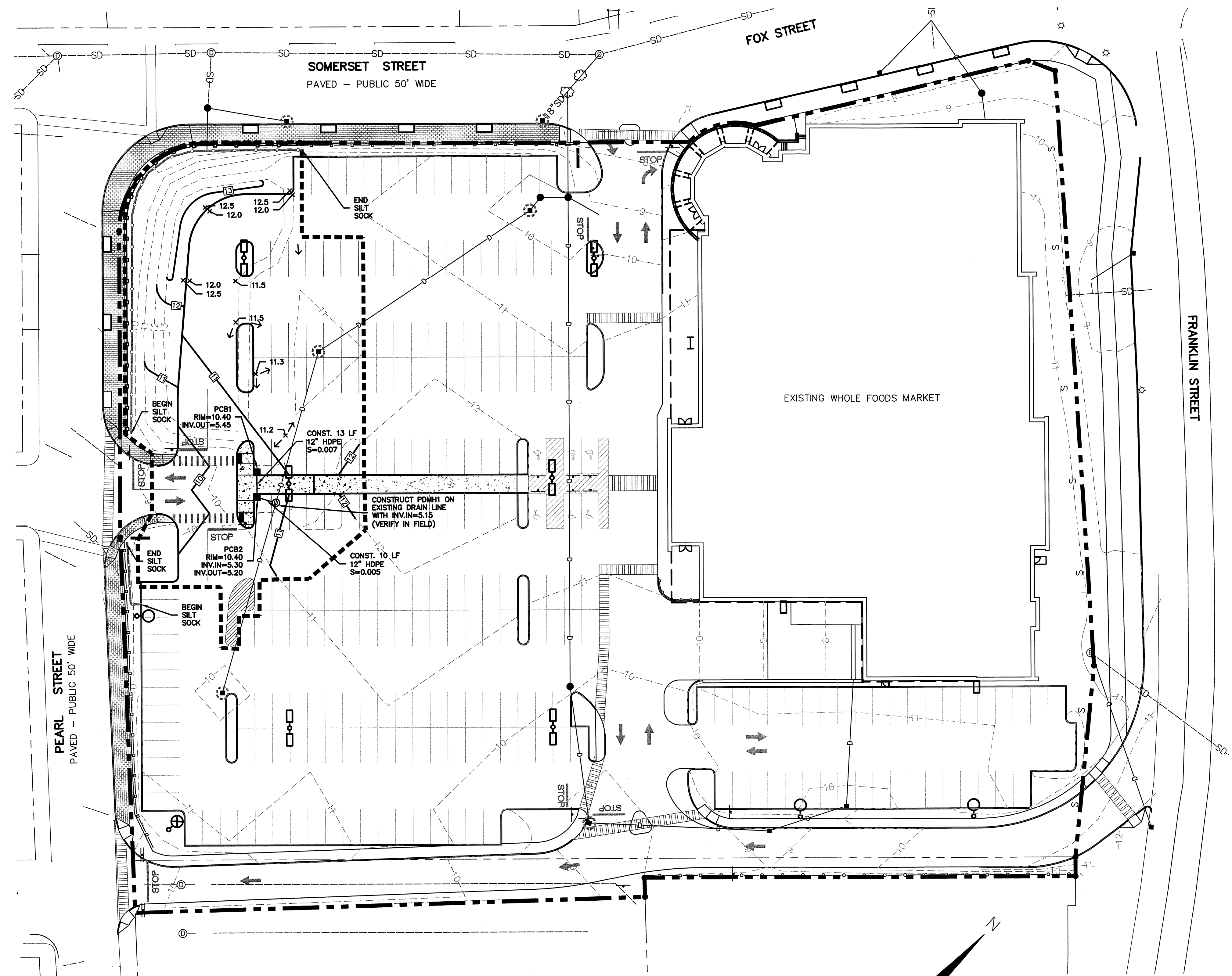

Last Saved: 1/15/2016 1:40pm By: KAM  
 Plotted On: Jan 15, 2016 1:40pm By: KAM  
 Tighe & Bond: \\svr\Projects\W2011\Whole Foods\W2011-39\Portland ME\DWG\CAD\DESIGN\W2011\_SITE.dwg