

1 ENLARGED FLOOR PLAN - SOUTHEAST CORNER

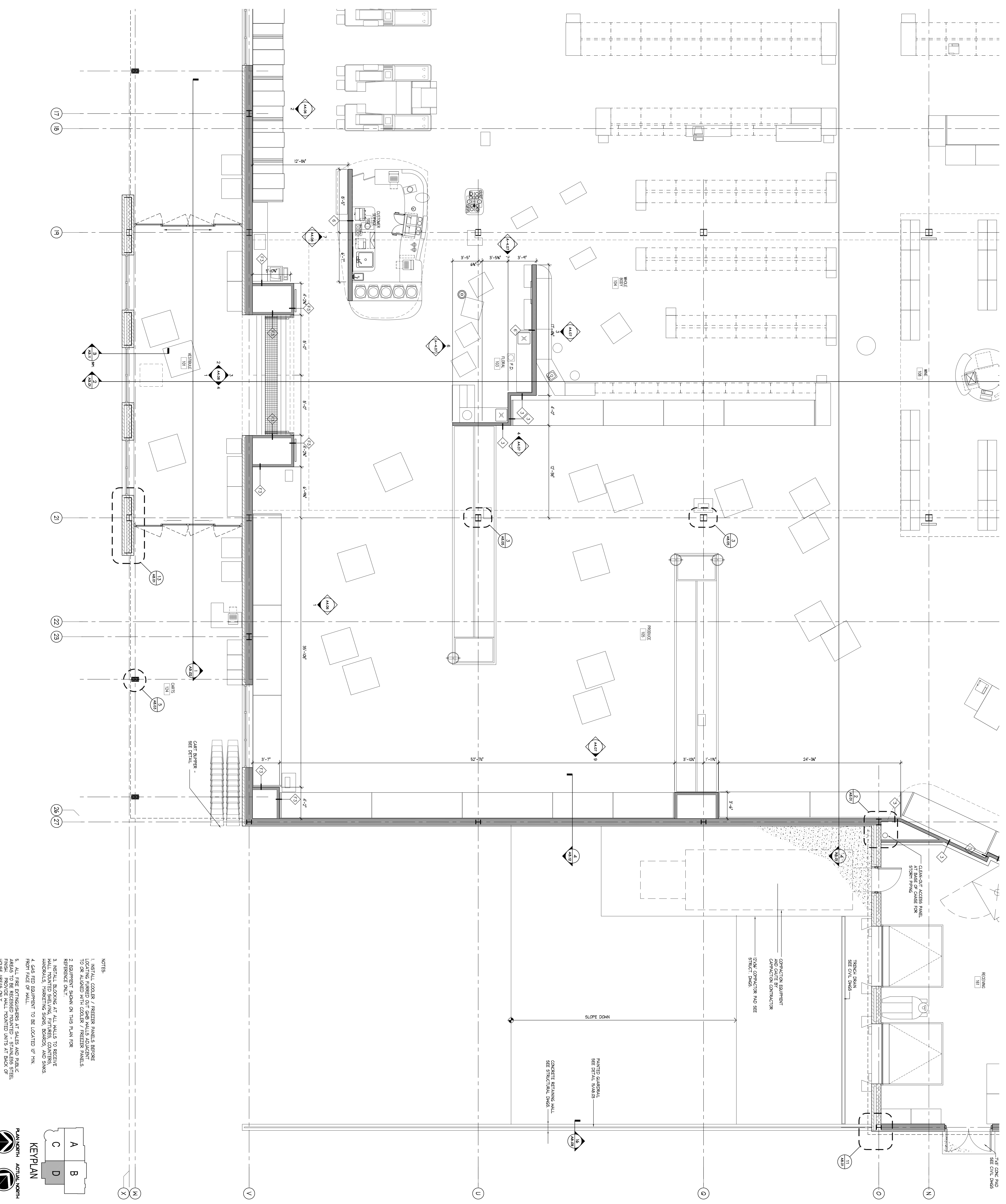

NOTES

1. INSTALL COOLER / FREEZER PANELS BEFORE LOCKING RIBBED OUT CURB WALLS ADJACENT TO OR AHEAD FROM COOLERS / FREEZER PANELS.
2. EQUIPMENT SPOON ON THIS PLAN FOR REFERRED WALL.
3. INSTALL BLOCKING AT ALL WALLS TO RECEIVE HANDRAILS, MARKETING SIGNS, BOARDS, AND SINKS FROM FACE OF WALL.
4. GAS FID EQUIPMENT TO BE LOCATED BY MN.
5. ALL FIRE EXTINGUISHERS AT SALES AND SERVICE AREAS TO BE RECESSED MOUNTED - STAINLESS STEEL HOSES AND/OR ONLY.

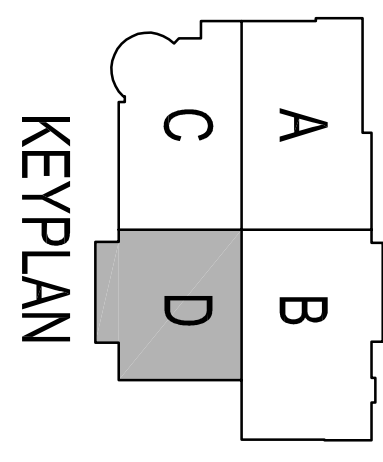

PLAN NORTH ACTUAL NORTH

A4.04

THE
LARGED
FLOOR PLAN
SOUTHEAST CORNER

Revised	Date	By	Checked

PROJECT NO. AS NOTED
DATE 04/20/06
SCALE 1/8" = 1'-0"

No.	Date	Desc.

Author	Checker	Designer	Drawn

PROPOSED GROCERY STORE
2 SOMERSET STREET
PORTLAND, CUMBERLAND COUNTY, MAINE

ISSUED FOR
CONSTRUCTION

WHOLE FOODS COMPANIES
ARCHITECTURE
PLANNING
INTERIORS

300 Summer Street
Portland, ME 04103
Tel: 603.761.1400
Fax: 603.761.1401